



July 8, 2022

Josh Harlow
Harlow Construction, LLC
199 Chase Street
Cameron, NC 28326
Email: joshaharlow@gmail.com

Reference: Engineering Services
55 Wessex Court
Cameron, NC 28326
TE&D Project No.: 2201-020599

To Whom It May Concern;

As requested, a representative of Tyndall Engineering & Design, PA (TE&D) was on-site to observe the following item(s):

- 1) Observation of notched rafters at roof overhang for rear screened-in porch.

The following conclusions and recommendations were noted:

- 1) We observed the 2 x 6 at 16" o.c. rafters as having been notched up to 2-1/2" where the rafters bear at the left and right exterior walls. Based on our observations and analysis, the notched rafters are adequate to support the anticipated loading conditions. No action needed.

We appreciate being able to assist you during this phase of the project. If you need further assistance or require additional information, please do not hesitate to contact us.

Sincerely,
Tyndall Engineering & Design

Tripp Amos
PT III | 2201-020599

Prentice Tyndall Jr., P.E.

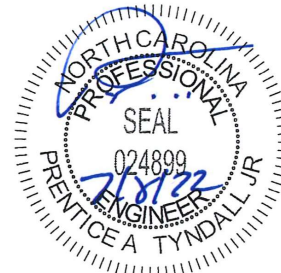

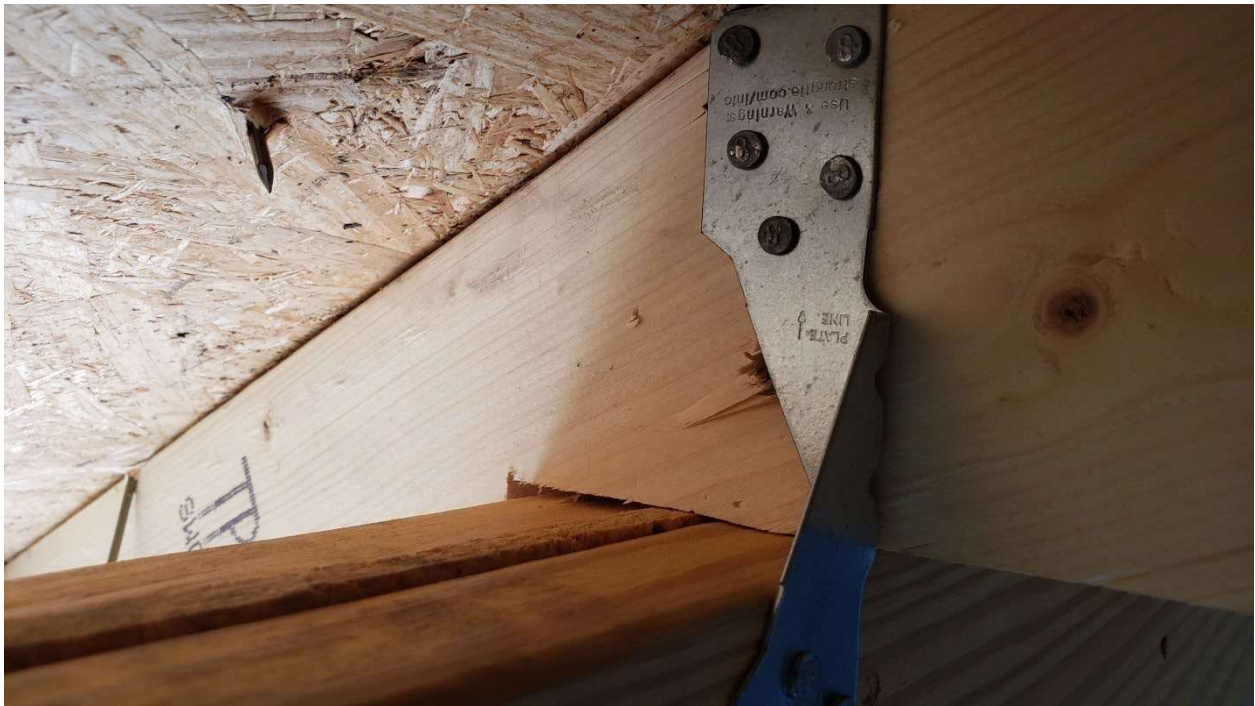

Example of notched rafters