

Milagros Berrios
20 Wood Run
Sandford, NC 27332

ORDER NO: 3762
ITEM: 1
DATE: 04/18/22

Floor Plan

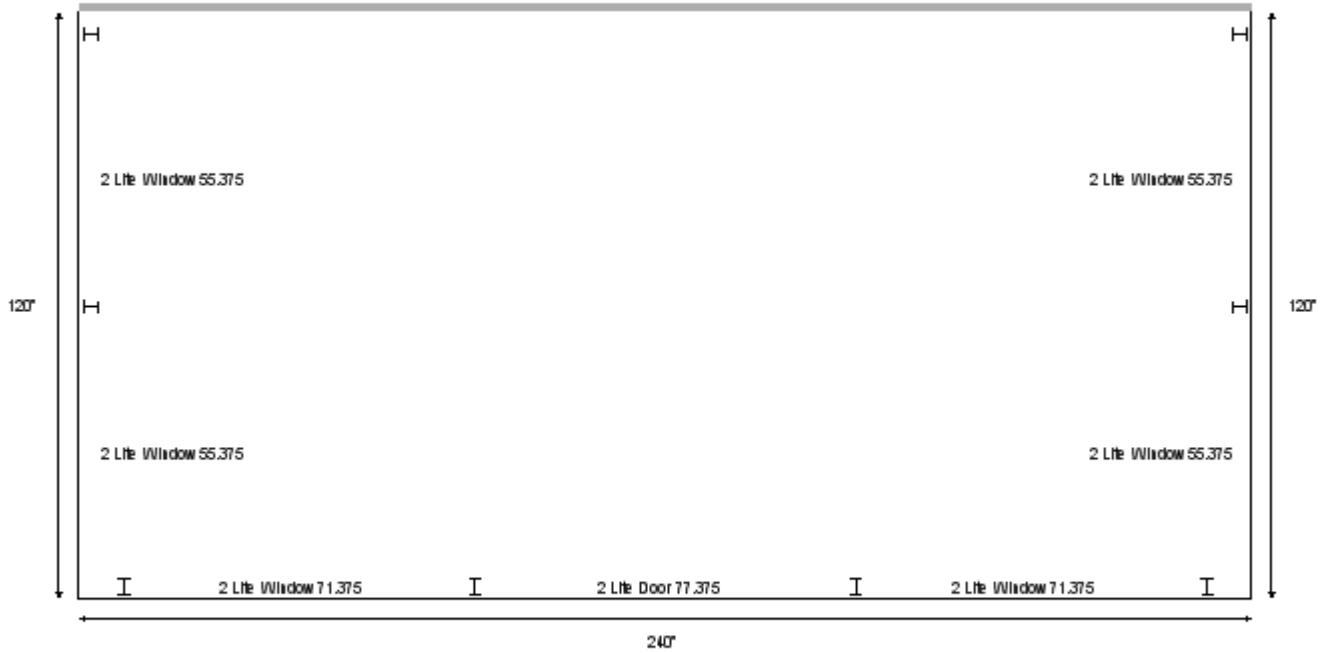

Dimensions

Attachment Height: 96 "
B Wall Height: 82.875 "
B Wall Width: 240 "
A Wall Width: 120 "
C Wall Width: 120 "
Roof Overhang: 10 "

Milagros Berrios
20 Wood Run
Sandford, NC 27332

ORDER NO: 3762
ITEM: 1
DATE: 04/18/22

A Wall

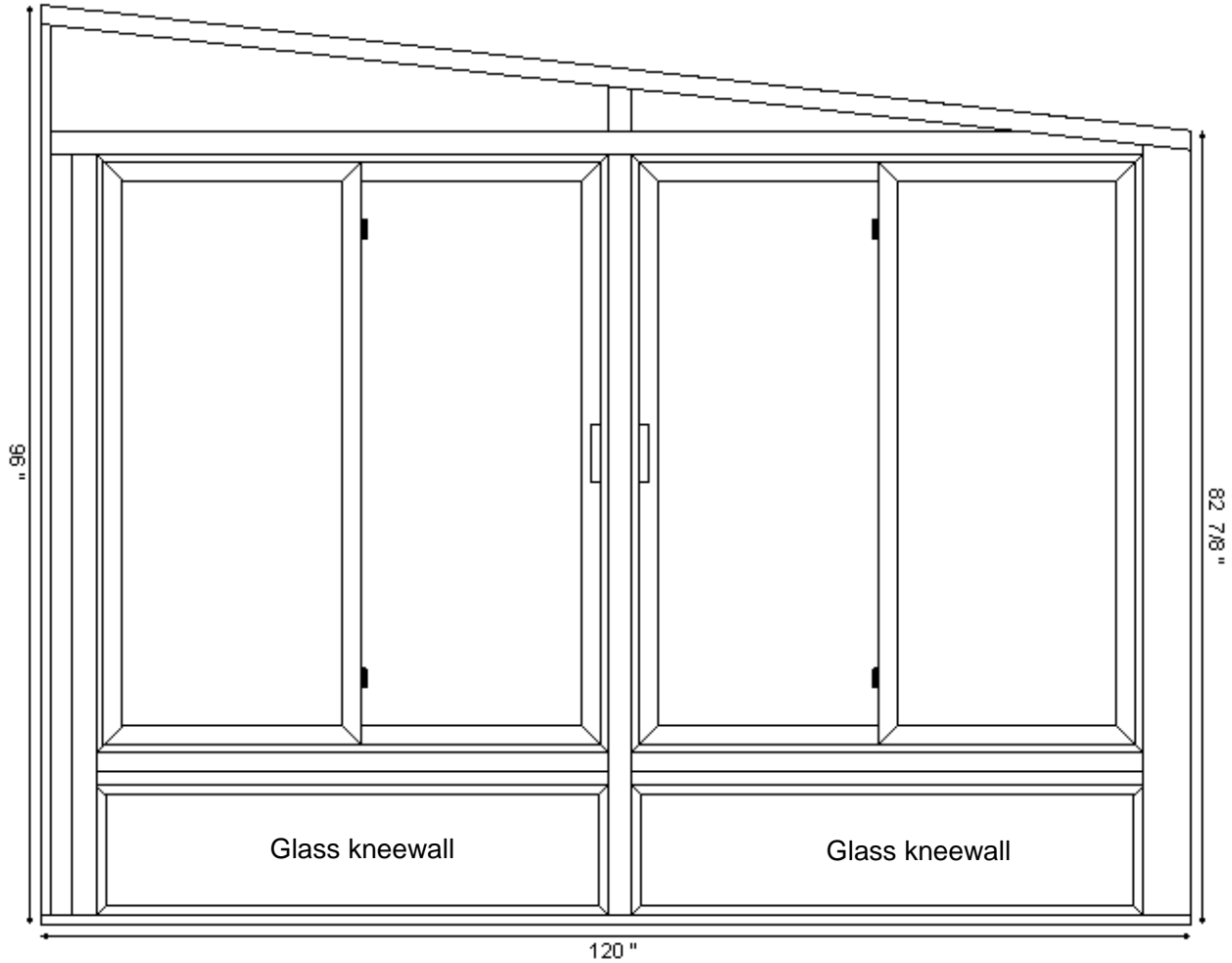

Dimensions

Attachment Height: 96 "
B Wall Height: 82.875 "
A Wall Width: 120 "
Roof Overhang: 10 "

Layout

0" (Fascia) + 4.25" (Foam) + 0.5" (THERMAL H) + 55.375" (2 Lite Window) + 0.5" (THERMAL H) +
55.375" (2 Lite Window) + 4" (Corner Post)

Milagros Berrios
20 Wood Run
Sandford, NC 27332

ORDER NO: 3762
ITEM: 1
DATE: 04/18/22

B Wall

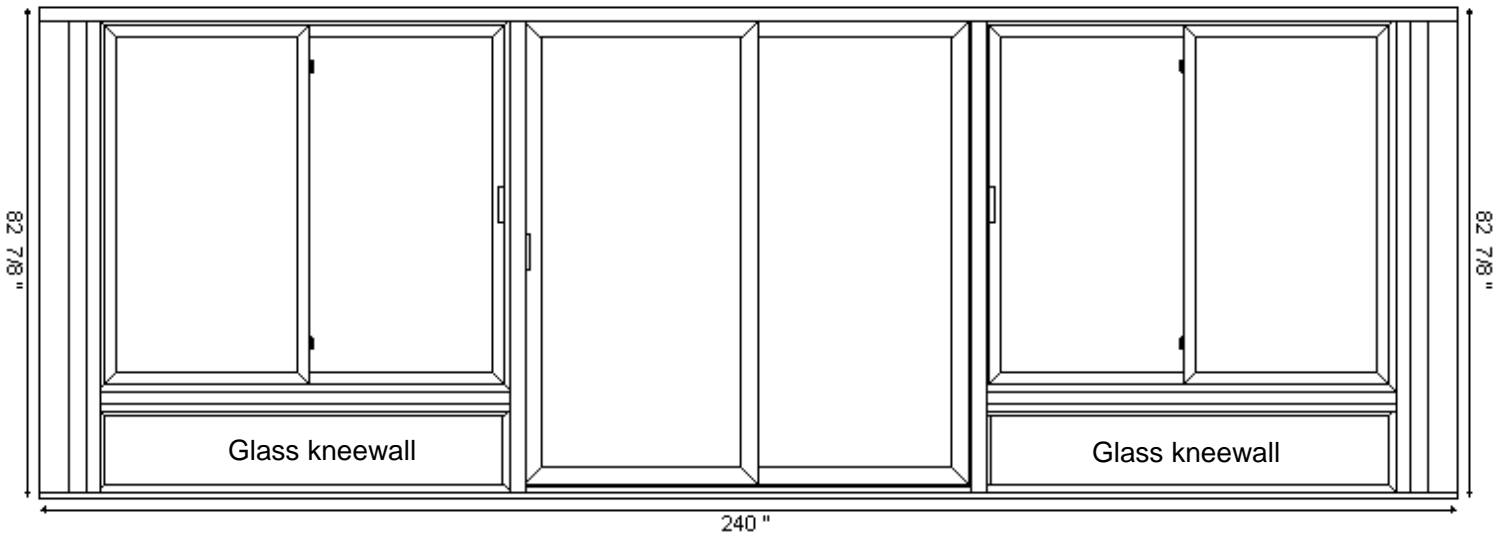

Dimensions

Attachment Height: 96 "
B Wall Height: 82.875 "
B Wall Width: 240 "
Roof Overhang: 10 "

Layout

4" (Corner Post) + 4.9375" (Foam) + 0.5" (THERMAL H) + 71.375" (2 Lite Window) + 0.5" (THERMAL H) +
77.375" (2 Lite Door) + 0.5" (THERMAL H) + 71.375" (2 Lite Window) + 0.5" (THERMAL H) + 4.9375"
(Foam) + 4" (Corner Post)

C Wall

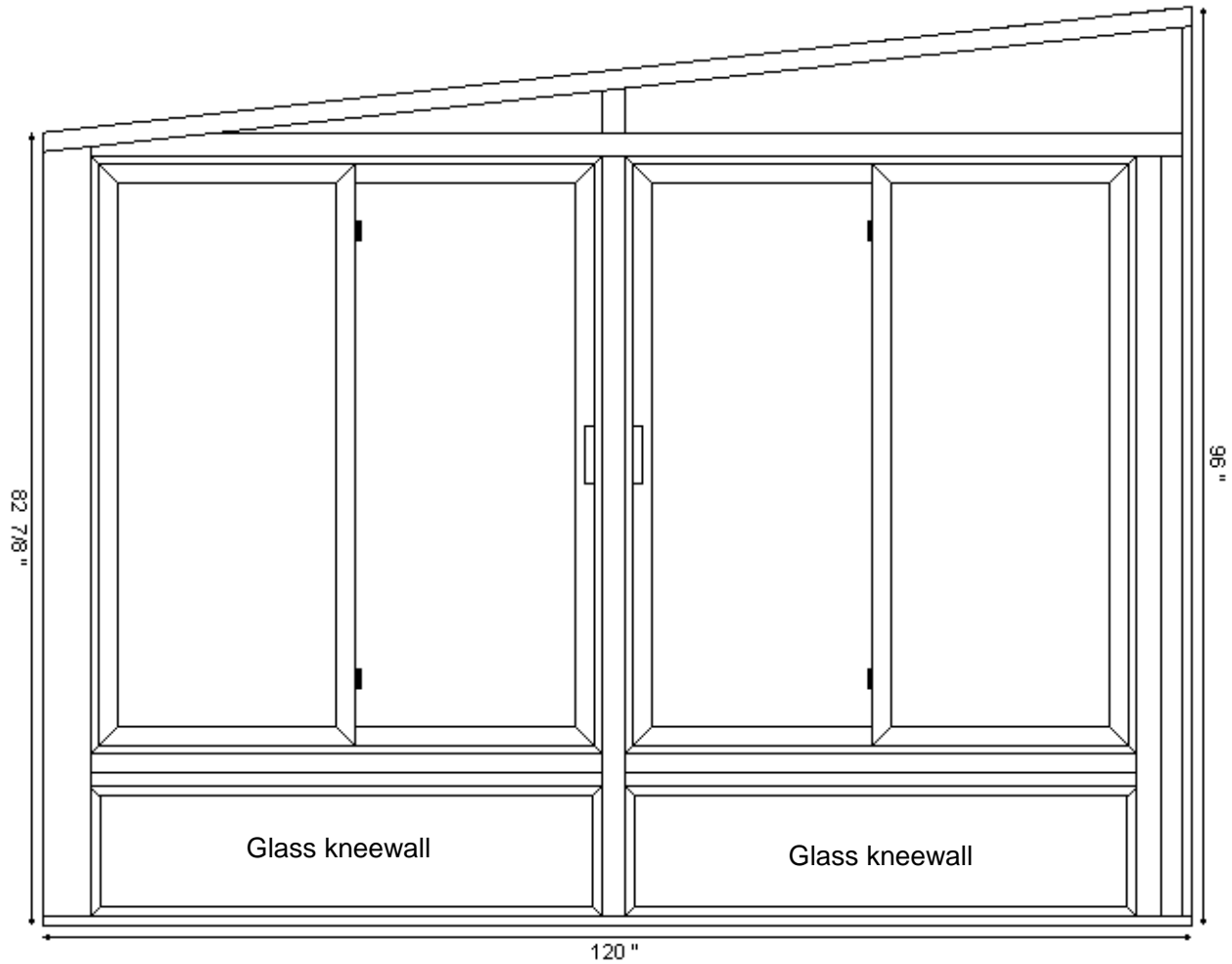

Dimensions

Attachment Height: 96 "
B Wall Height: 82.875 "
C Wall Width: 120 "
Roof Overhang: 10 "

Layout

4" (Corner Post) + 55.375" (2 Lite Window) + 0.5" (THERMAL H) + 55.375" (2 Lite Window) + 0.5" (THERMAL H) + 4.25" (Foam) + 0" (Fascia)

Milagros Berrios
20 Wood Run
Sandford, NC 27332

ORDER NO: 3762
ITEM: 1
DATE: 04/18/22

Roof

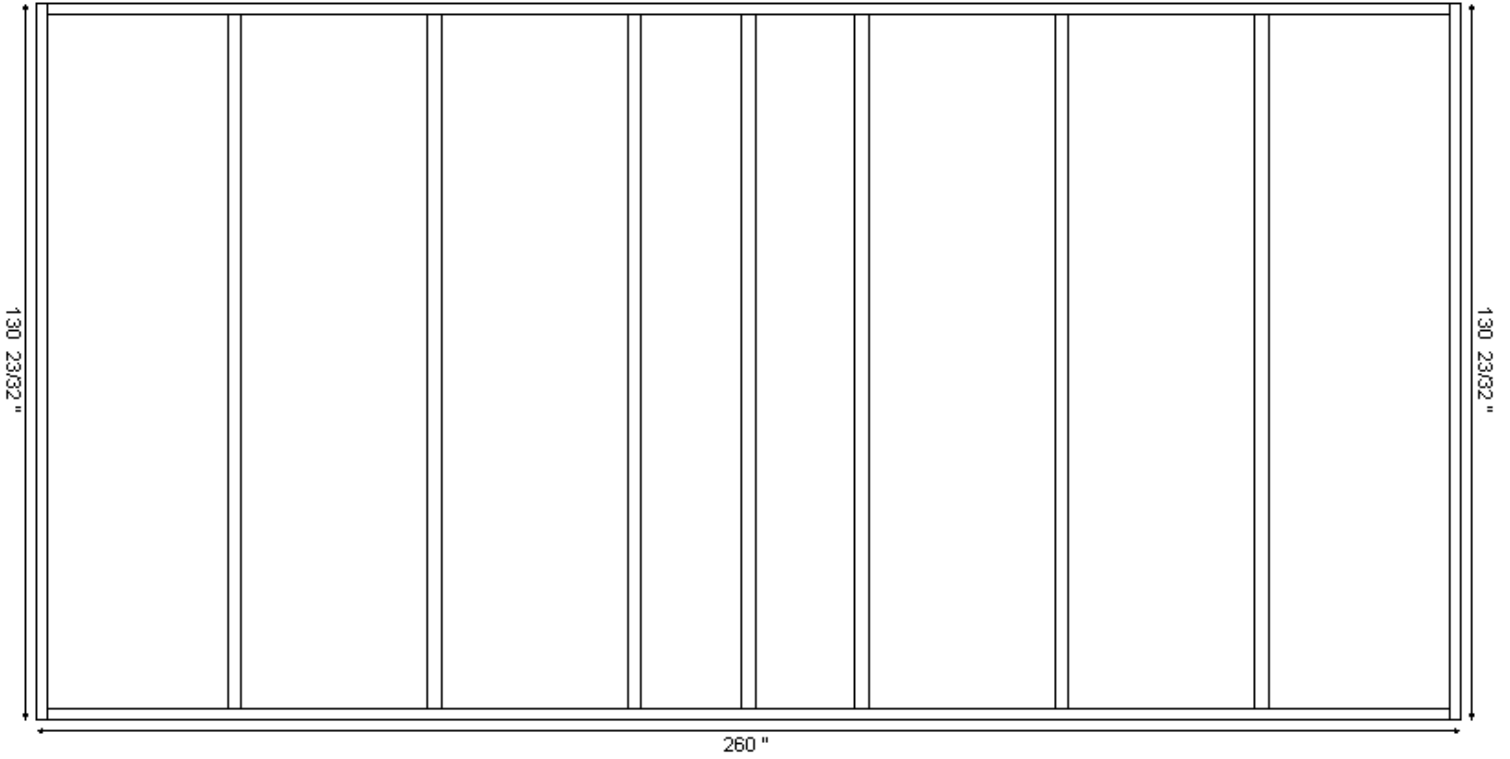

Dimensions

Attachment Height: 96 "
B Wall Height: 82.875 "
B Wall Width: 240 "
A Wall Width: 120 "
C Wall Width: 120 "
Roof Overhang: 10 "