

Harnett County Department of Public Health

PERMIT # B222204-0074

Operation Permit

Relocation SL2215
 New Installation Septic Tank Nitrification Line Repair Expansion

PROPERTY LOCATION: 135 FARLAW SHEA WAY (HARDETT CENTRAL RD)

Name: (owner) NICK SALISBURY SUBDIVISION BRIAN KEITH MEADOWS LOT # 3

System Installer: EASTMAN SEPTIC - SHARIZ MCDONALD

Basement with plumbing: Garage Number of Bedrooms 3

Type of Water Supply: Community Public Well Distance from well NA feet

System Type: 256 EXTENSION SYSTEM IIIg Types V and VI Systems expire in 5 years.

(In accordance with Table V a) Owner must contact Health Department 6 months prior to expiration for permit renewal.

This system has been installed in compliance with applicable North Carolina General Statutes, Rules for Sewage Treatment and Disposal, and all conditions of the Improvement Permit and Construction Authorization.

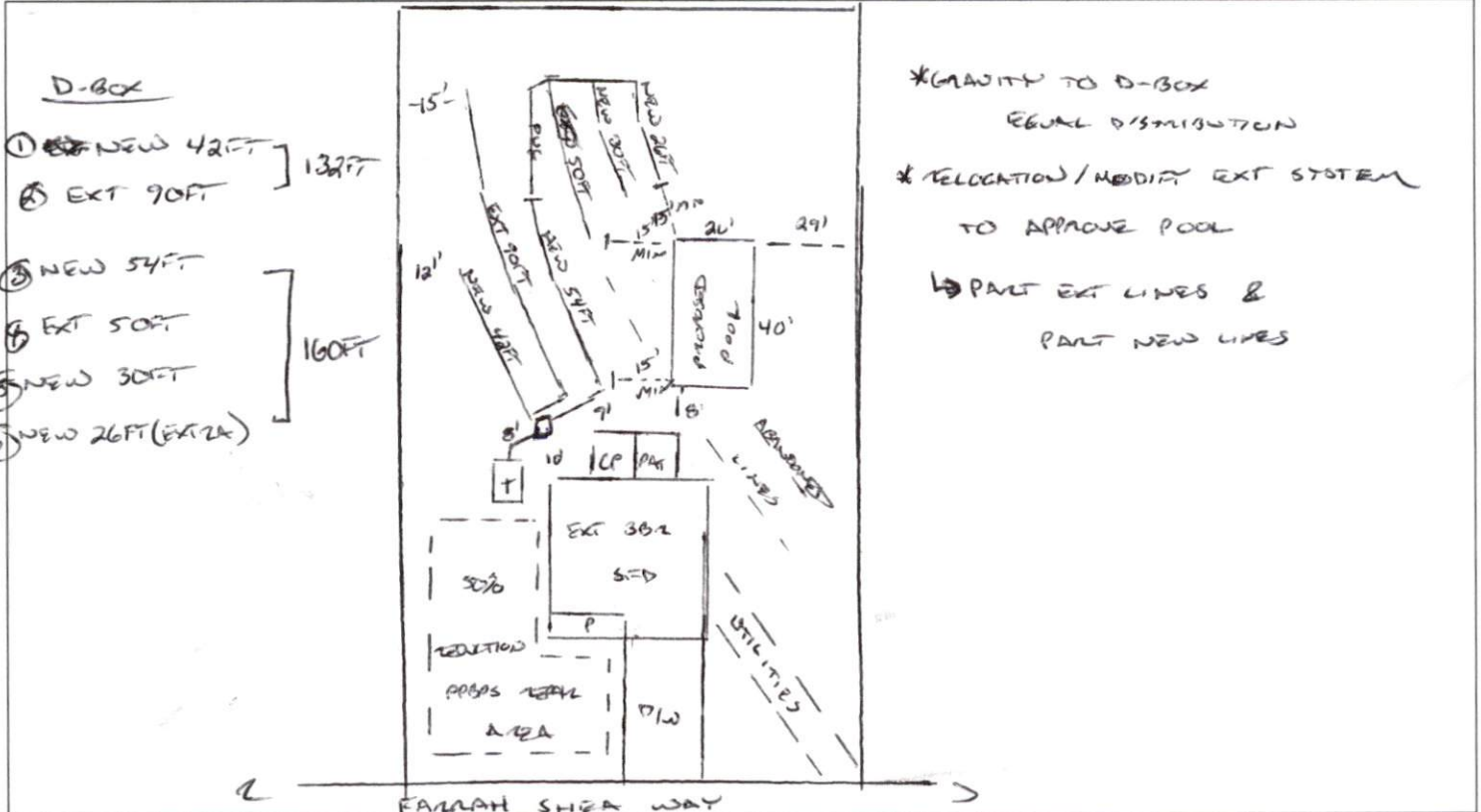

PERMIT CONDITIONS:

- I. Performance: System shall perform in accordance with Rule .1961.
- II. Monitoring: As required by Rule .1961.
- III. Maintenance: As required by Rule .1961. Other: _____
 Subsurface system operator required? Yes No
 If yes, see attached sheet for additional operation conditions, maintenance and reporting.
- IV. Operation: _____
- V. Other: _____

D-Box Pump Alarm H2O Line PWR Line

Following are the specifications for the sewage disposal system on the above captioned property.

Type of system: Conventional Other CHAMBER IIIg Septic Tank: EXT (1000) gallons Pump Tank: _____ gallons
 Subsurface No. of exact length 132, 160 width of depth of
 Drainage Field ditches 2 of each ditch _____ feet ditches 3 feet ditches 18-20 inches
 French Drain Required: _____ Linear feet

Authorized State Agent [Signature] Date 06/30/2022