

CERTIFICATE OF COMPLETION / OPERATIONAL PERMIT

Name: (owner) Cummi Builders Inc New Installation Septic Tank
 Property Location: SR# 1446 Repairs Nitrification Line
 Subdivision Wenford Lot # 4
 TAX ID# _____ Quadrant # _____
 Contractor: Pd Cummi Registration # 34

Basement with Plumbing: Garage:
 Water Supply: Well Public Community
 Distance From Well: 50+ ft.

Following are the specifications for the sewage disposal system on above captioned property.

Type of system: Conventional Other _____
 Size of tank: Septic Tank: 1000 gallons Pump Tank: _____ gallons
 Subsurface Drainage Field No. of ditches 4 exact length of each ditch 100 ft. width of ditches 3 ft. depth of ditches 12" in.
 French Drain: _____ Linear feet

PERMIT NO. 09956 Date: 5-9-55
 Inspected by: James E. Mark
 Environmental Health Specialist

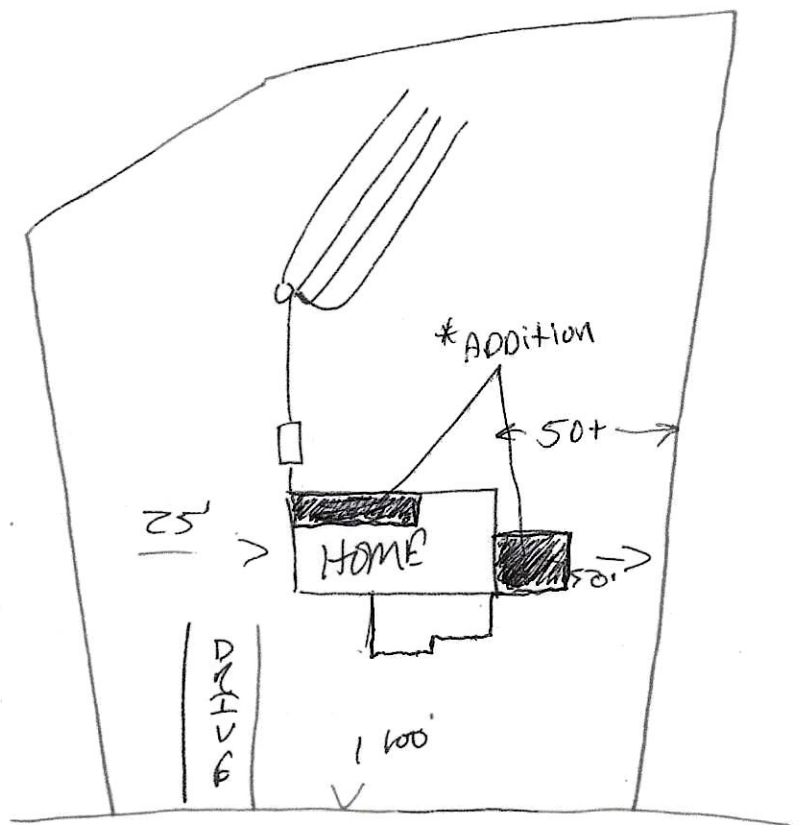

SR 1446