

B225 2204 - 0048

**SOIL/SITE EVALUATION  
 for ON-SITE WASTEWATER SYSTEM**

Owner: - Applicant: JUSTIN DANFROOT  
 Address: 296 STEWART ROAD Date Evaluated: 05/19/2022  
 Proposed Facility: 300 MOD Design Flow (.1949): 360 GPD Property Size:  
 Location of Site: 300 MOD Property Recorded:  
 Water Supply:  Public  Individual  Well  Spring  Other  
 Evaluation Method:  Auger Boring  Pit  Cut  
 Type of Wastewater:  Sewage  Industrial Process  Mixed

P R O F I L E #	.1940 Landscape Position/ Slope %	Horizon Depth (In.)	SOIL MORPHOLOGY .1941		OTHER PROFILE FACTORS				Profile Class & LTAR
			.1941 Structure/ Texture	.1941 Consistence Mineralogy	.1942 Soil Wetness/ Color	.1943 Soil Depth (IN.)	.1956 Sapro Class	.1944 Restr Horiz	
1,2	L 3/0	0-12	GL LS	VH NSMP					PS
		12-36	BL SLL	FL SC	7.5% LF, @ 36"	36			0.375
3,4	L 3/0	0-12	GL LS	VH NSMP					PS
		12-36	BL SLL	VFL SC	7.5% LF, @ 34"	36			0.375

Description	Initial System	Repair System	Other Factors (.1946):
Available Space (.1945)	✓	✓	Site Classification (.1948): PROVISIONALLY SUITABLE
System Type(s)	25/0 MOD	50/0 MOD	Evaluated By: ANDREW CORUN, REHS
Site LTAR	0.375	0.375	Others Present:

COMMENTS: \_\_\_\_\_

LANDSCAPE POSITIONS	GROUP	TEXTURES	.1955 LTAR	CONSISTENCE MOIST	WET
R-RIDGE	I	S-SAND	1.2 - 0.8	VFR-VERY FRIABLE	NS-NON-STICKY
S-SHOULDER SLOPE		LS-LOAMY SAND		FR-FRIABLE	SS-SLIGHTLY STICKY
L-LINEAR SLOPE				FI-FIRM	S-STICKY
FS-FOOT SLOPE	II	SL-SANDY LOAM	0.8 - 0.6	VFI-VERY FIRM	VS-VERY STICKY
N-NOSE SLOPE		L-LOAM		EFI-EXTREMELY FIRM	NP-NON-PLASTIC
H-HEAD SLOPE					SP-SLIGHTLY STICKY
CC-CONCLAVE SLOPE	III	SI-SILT	0.6 - 0.3		P-PLASTIC
CV-CONVEX SLOPE		SIL-SILT LOAM			VP-VERY PLASTIC
T-TERRACE		CL-CLAY LOAM			
FP-FLOOD PLAN		SCL-SANDY CLAY LOAM			
	IV	SIC-SILTY CLAY	0.4 - 0.1		
		C-CLAY			
		SC-SANDY CLAY			
STRUCTURE		MINERALOGY			
SG-SINGLE GRAIN		SLIGHTLY EXPANSIVE			
M- MASSIVE					
CR-CRUMB		EXPANSIVE			
GR-GRANULAR					
SBK-SUBANGULAR BLOCKY					
ABK-ANGULAR BLOCKY					
PL-PLATY					
PR-PRISMATIC					

Show profile locations and other site features (dimensions, references or benchmark, and North)

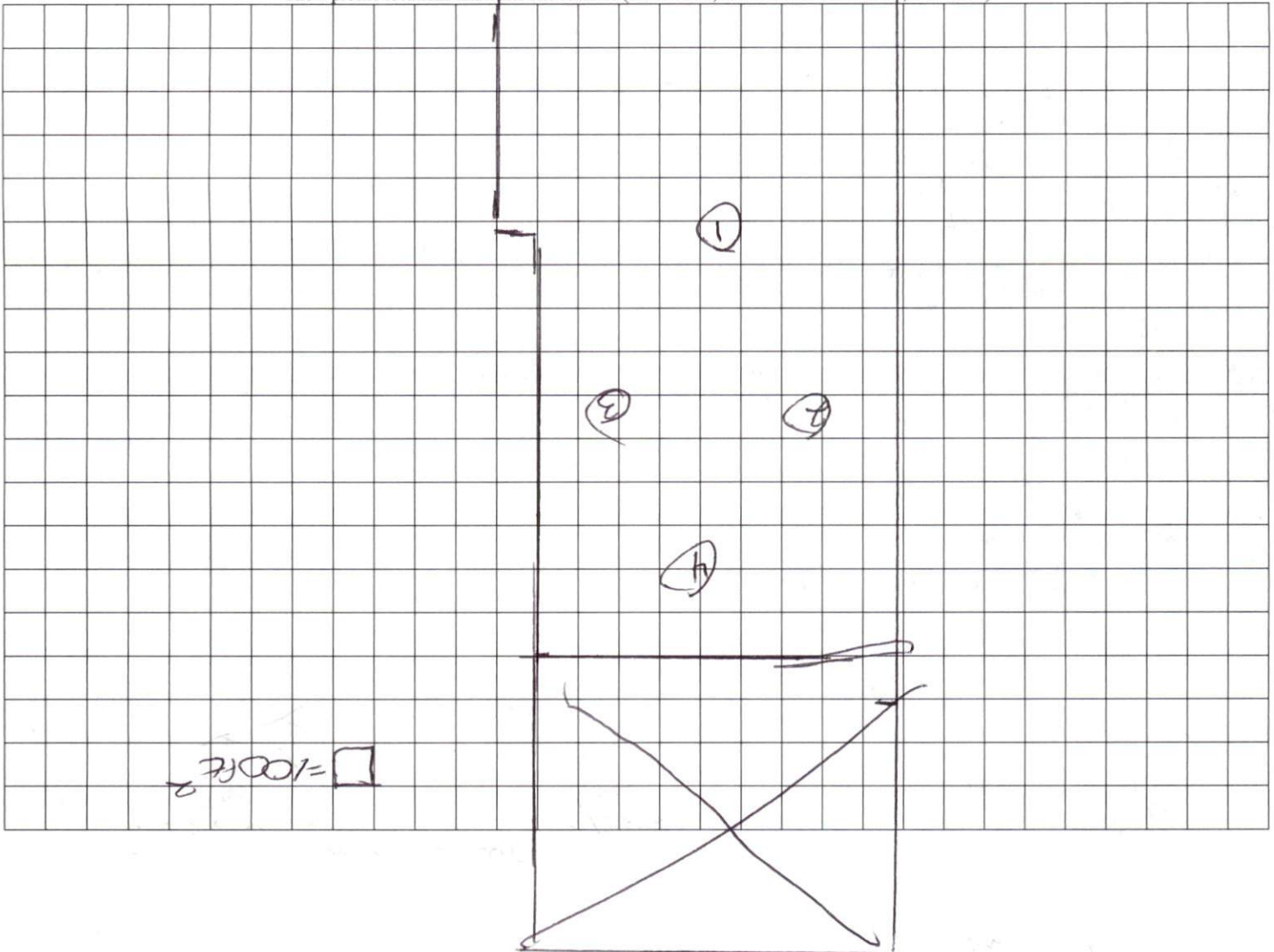

# Harnett GIS

NOT FOR LEGAL USE



Harnett County GIS, Harnett County Public Utilities



GIS/E-911 Addressing  
May 17, 2022

- Surrounding County Boundaries
- City Limits
- Address Numbers
- Airport

- MajorRoads**
- Interstate
  - NC
  - US
  - Roads
- COX*

- Mile\_Markers**
- Mile\_Markers
  - Railroad
  - Parcels
  - CapeFearRiver

*54 12-36 SW*  
*12-36 SW*  
*0-12 SW*

