



Structural Engineering by:
Mark E. Jones, PE

6425 Glen Dean Court
Raleigh, NC 27603
Phone: (919) 395-5618

*Engineers seal applies only to structural components on this document. Seal does not include construction means, methods, techniques, sequences, procures or safety precautions.
*Any deviations or discrepancies on plans are to be brought to the immediate attention of Mark E. Jones, PE. Failure to do so will void Mark E. Jones, PE liability.
Structural analysis based on NCResidential Building Code 2018.

Project No. 22-009

BAILEY RESIDENCE



Mark E. Jones

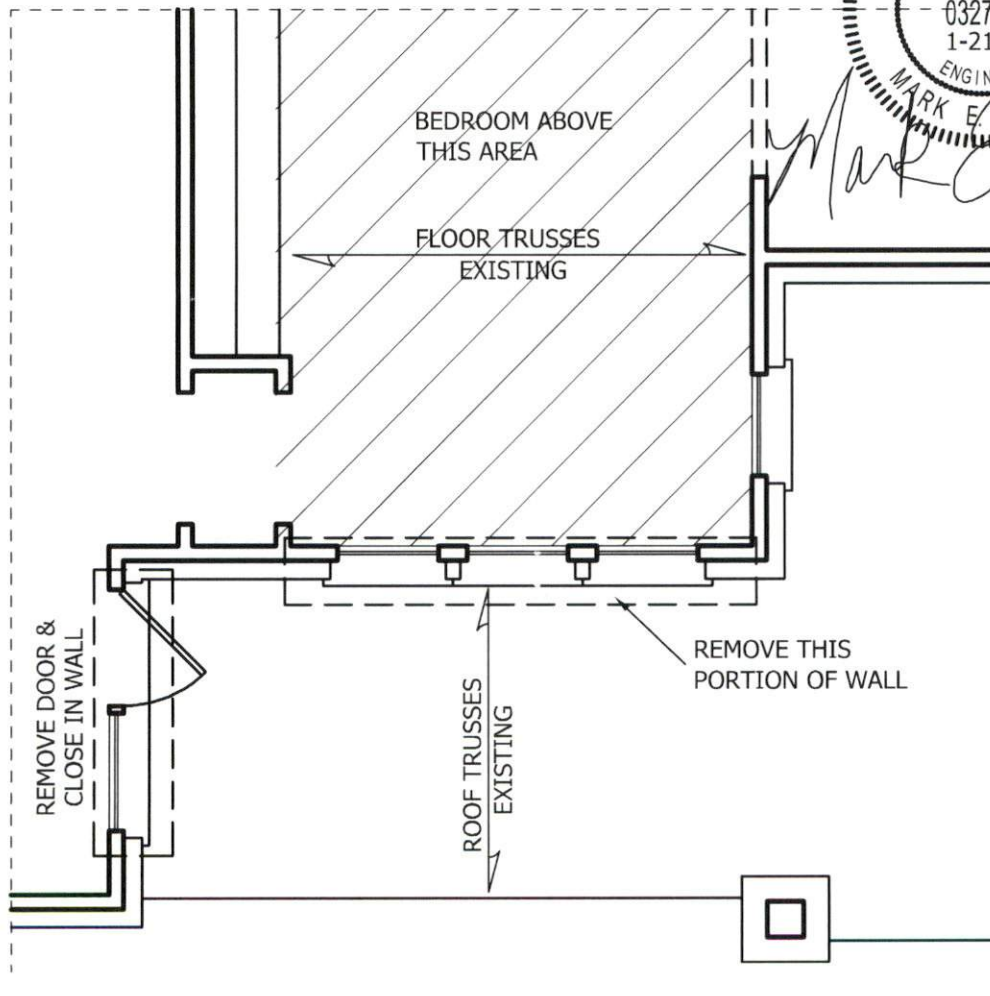

EXISTING FLOOR PLAN

SCALE: 1/4"=1'-0"



Structural Engineering by:
Mark E. Jones, PE

6425 Glen Dean Court
Raleigh, NC 27603
Phone: (919) 395-5618

*Engineers seal applies only to structural components on this document. Seal does not include construction means, methods, techniques, sequences, procures or safety precautions.

*Any deviations or discrepancies on plans are to be brought to the immediate attention of Mark E. Jones, PE. Failure to do so will void Mark E. Jones, PE liability.
Structural analysis based on NCResidential Building Code 2018.

Project No. 22-009

BAILEY RESIDENCE

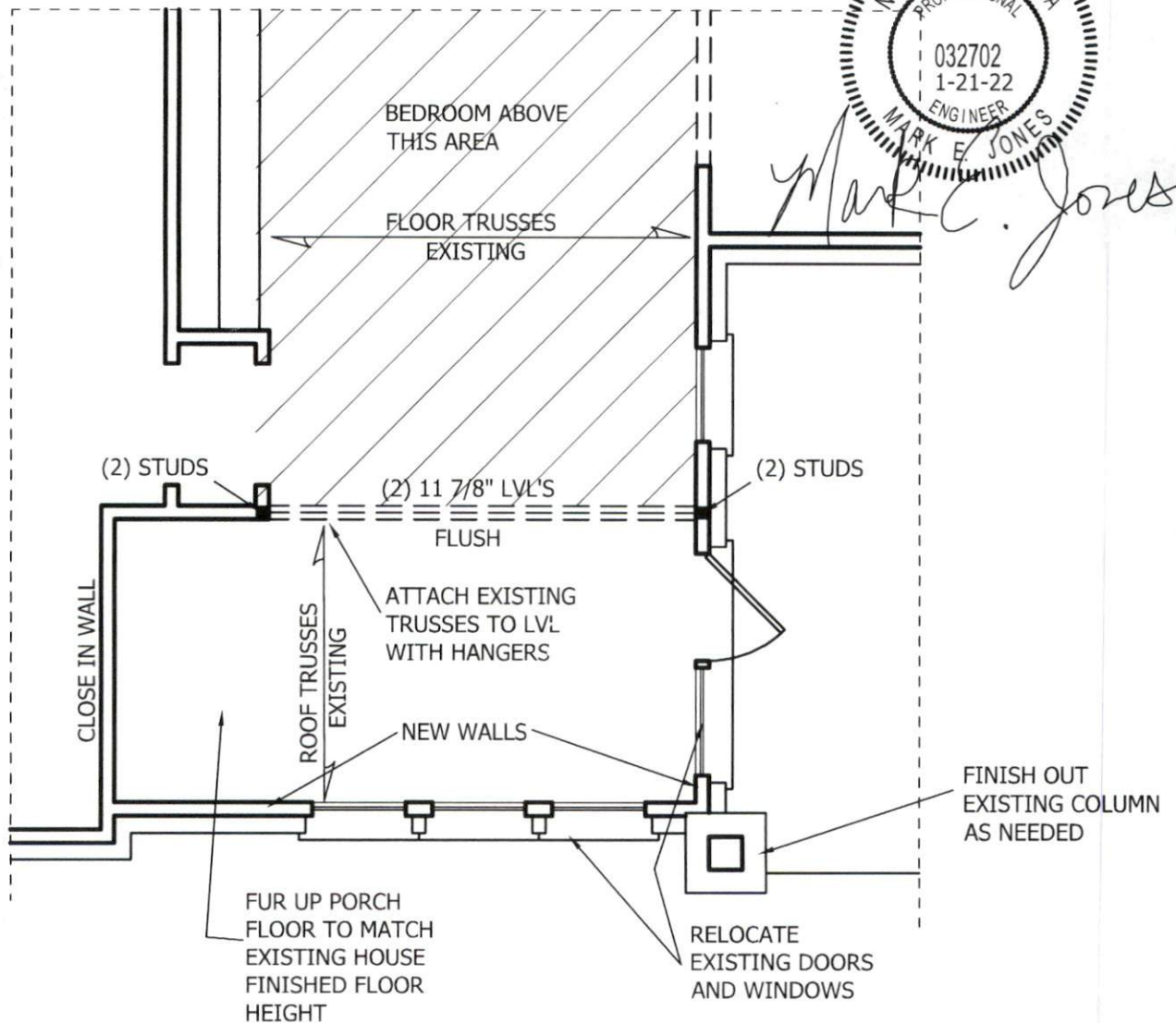

PROPOSED FLOOR PLAN

SCALE: 1/4"=1'-0"