

DEED REFERENCE:

Deed Book 3750, Page 686  
Map # 2019-220

ZONED: RA-30

MINIMUM SETBACK REQUIREMENT

Front -----35'  
Side-----10'  
Rear-----25'  
Corner-----20'

LEGEND:

FIP..... Found Iron Pipe  
CP .....Computed Point  
\* .....Control Corner  
FRB..... Found Rebar

LINE LEGEND:

Subject Tract Surveyed  
Lines Not Surveyed  
Setback Line  
Surveyed Lines, R/W or Tie Line  
Not to Scale

SITE PLAN FOR:  
RP WELLONS LAND &  
DEVELOPMENT, LLC

P.O. Box 730, Dunn NC 28334

JEFF & DIANE RESER

AVERASBORO TWP HARNETT CO NC

AUGUST 16, 2021



1" = 100'

PIN: 151-83-5363.000 PID: 02151612140013 10

PRELIMINARY

Not For Sales, Conveyances, or Recordation

Map # 2019-220



DRAWN BY:

J. SCOTT WALKER, PLS

835 ABATTOIR RD, COATS NC 27521  
(910) 897-5753

This is Not to Be Considered  
a Certified Document

③  
KIMBERLY BREEDEN  
Deed Book 3965, Page 749  
Map # 2019-220

HOUSE DETAIL:  
Scale: 1"=60'

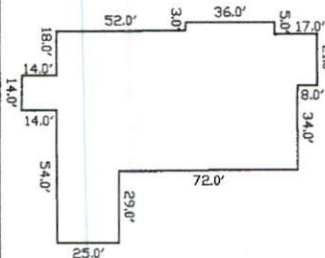

4' Ditch  
To Be Filled

Farm Path  
To Be Relocated

SR 1793

POPE RD

60' R/W

S 06°53'58" W 200.00'

S 06°53'08" W 115.42'

S 06°57'14" W 157.7'

N 86°37'51" W 640.15'

N 86°24'17" W 594.78'

N 06°06'51" W 200.00'

②  
2.81 Acres

①  
ANTHONEY G. MOSCONI  
Deed Book 3833, Page 301  
Map # 2019-220

SITE ADDRESS

1426 POPE RD  
DUNN, NC 28334

PENTECOSTAL FWBC Inc  
Deed Book 1974, Page 435