

HTE # 04-5-10954

OPERATIONS PERMIT

Name: (owner) Robbce + Ann Wilkens New Installation Septic Tank Repair

Property Location: SR# 1450 Ball RD Nitrification Line Expansion

Subdivision _____ Lot # 2 Tax ID # _____ Quadrant # _____

Contractor: Jason Matthews Registration # _____

Basement with Plumbing: Garage:

Water Supply: Well Public Community

Distance From Well: 50' ft.

Following are the specifications for the sewage disposal system on above captioned property.

Type of system: Conventional Other _____

Size of tank: Septic Tank: 1000 gallons Pump Tank: _____ gallons

Subsurface Drainage Field No. of ditches 4 exact length of each ditch 100 ft. width of ditches 3 ft. depth of ditches 22-28 in.

French Drain Required: - Linear feet

Date: 6-30-05

PERMIT NO. 21391

Inspected by James E. Markant III P.E.

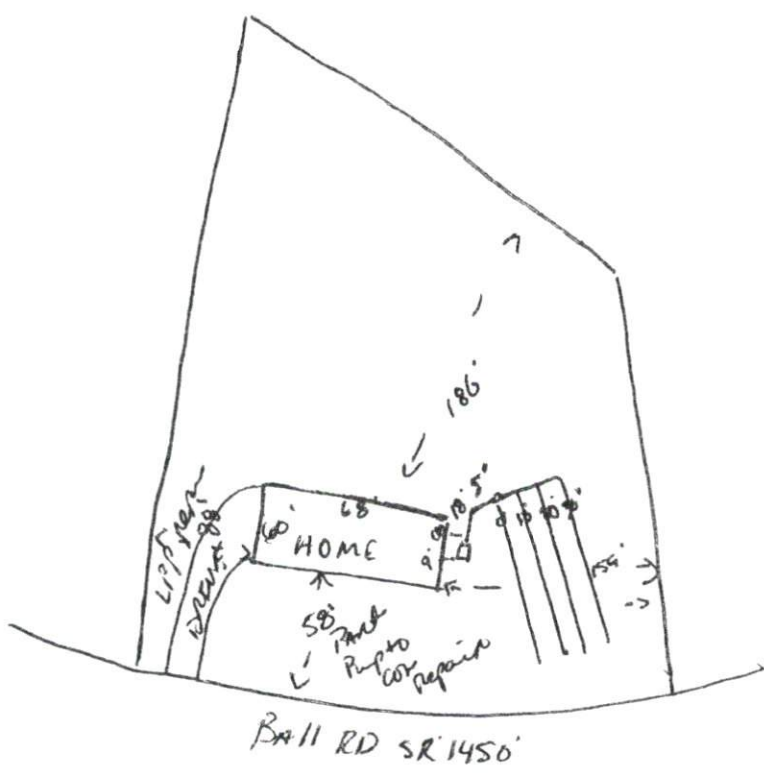

HARNETT COUNTY HEALTH DEPARTMENT

HTE 04-5-10954

IMPROVEMENT PERMIT

21391

Be it ordained by the Harnett County Board of Health as follows: Section III, Item B. "No Person shall begin construction of any building at which a septic tank system is to be used for disposal of sewage without first obtaining a written permit from the Harnett County Health Department."

Name: (owner) ROBBIE + ANN WELKENS

New Installation

Septic Tank

Property Location: SR# 1450 BALL RD

Repairs

Nitrification Line

Subdivision _____ Lot # 2

Tax ID # _____ Quadrant # _____

Number of Bedrooms Proposed: 3 Lot Size: 1.81

Basement with Plumbing: Garage:

Water Supply: Well Public Community

Distance From Well: _____ ft.

Following is the minimum specifications for sewage disposal system on above captioned property. Subject to final approval.

Type of system: Conventional Other _____

Size of tank: Septic Tank: 1000 gallons Pump Tank: _____ gallons

Subsurface Drainage Field No. of ditches 4 exact length of each ditch 100 ft. width of ditches 3 ft. depth of man ditches 22-18 in.

French Drain Required: - Linear feet

Date: 1-5-09

This permit is subject to revocation if site plans or intended use change.

Signed: James E. Markant
Environmental Health Specialist

