

GENERAL NOTES

1. CONSULT LOCAL BUILDING OFFICES FOR BUILDING CODES, ZONING AND PERMITS BEFORE STARTING WORK.
2. ALL MATERIALS SHALL BE OF QUALITY AND SHALL BE APPROVED BY THE LOCAL BUILDING OFFICE.
3. FOUNDATION SHALL BE CONCRETE ON GRADE OR AS SPECIFIED.
4. ALL ROOFING SHALL BE AS SPECIFIED.
5. ROOFING SHALL BE 1/2" OSB OR 5/8" GYP BOARD OVER 1/2" OSB OR 5/8" GYP BOARD.
6. ROOFING SHALL BE 1/2" OSB OR 5/8" GYP BOARD OVER 1/2" OSB OR 5/8" GYP BOARD.
7. ALL INTERIORS SHALL BE UNFINISHED UNLESS OTHERWISE SPECIFIED.
8. ALL EXTERIORS SHALL BE UNFINISHED UNLESS OTHERWISE SPECIFIED.
9. DOOR AND WINDOW OPENINGS SHALL BE AS SPECIFIED.
10. ALL CONNECTIONS SHALL BE AS SPECIFIED.
11. ALL MATERIALS SHALL BE APPROVED BY THE LOCAL BUILDING OFFICE.
12. ALL MATERIALS SHALL BE APPROVED BY THE LOCAL BUILDING OFFICE.
13. ALL MATERIALS SHALL BE APPROVED BY THE LOCAL BUILDING OFFICE.
14. ALL MATERIALS SHALL BE APPROVED BY THE LOCAL BUILDING OFFICE.
15. ALL MATERIALS SHALL BE APPROVED BY THE LOCAL BUILDING OFFICE.
16. ALL MATERIALS SHALL BE APPROVED BY THE LOCAL BUILDING OFFICE.
17. ALL MATERIALS SHALL BE APPROVED BY THE LOCAL BUILDING OFFICE.
18. ALL MATERIALS SHALL BE APPROVED BY THE LOCAL BUILDING OFFICE.
19. ALL MATERIALS SHALL BE APPROVED BY THE LOCAL BUILDING OFFICE.
20. ALL MATERIALS SHALL BE APPROVED BY THE LOCAL BUILDING OFFICE.



PROJECT: 12' x 16' SHED
STYLE: GAMBREL STYLE
SCALE: 1/4" = 1'-0"

DESIGN #: 5608-021
SCALE AS NOTED
5/18/20
A.I.I.

PLAN: REFER TO SHEET 12' x 16' SHED

ELEVATIONS AND PLANS: REFER TO SHEET 12' x 16' SHED

BUILDING SECTION: REFER TO SHEET 12' x 16' SHED

DETAILS AND NOTES: REFER TO SHEET 12' x 16' SHED

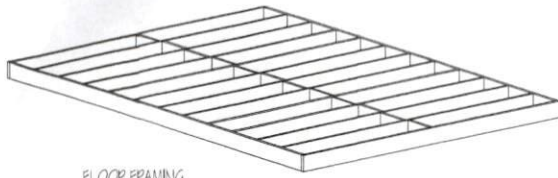

FLOOR FRAMING

N.T.S.

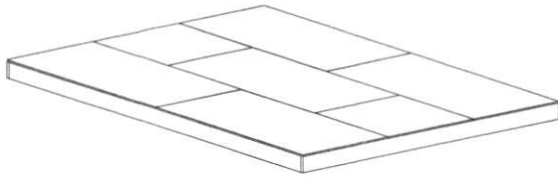

SUBFLOOR INSTALLED

N.T.S.

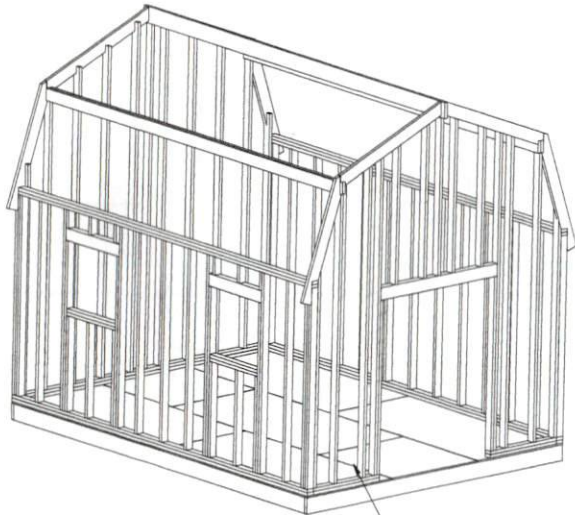

WALLS - RIDGE - GAMBREL BEAM

N.T.S.

FRAMING WALL SECTION OF FLOOR JOIST - SHOWN
IF ALL JOIST BEARS FLOOR JOIST LEVELS.

ATTACH JOIST TO FRAMING TO MAINTAIN SCENE
AND PREVENT SWAYING - BEFORE FINISHING FLOOR.

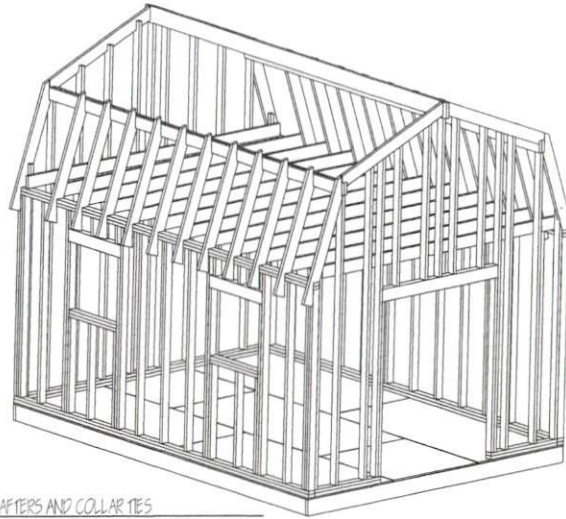

SIDE RAFTERS AND COLLAR TIES

N.T.S.

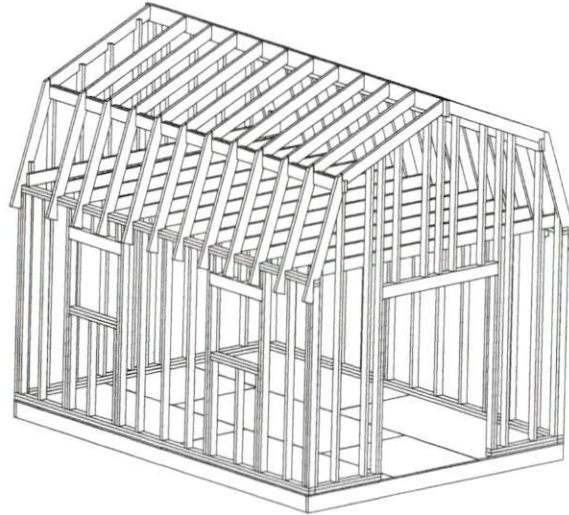

TOP RAFTERS INSTALLED

N.T.S.

FRAMING ILLUSTRATION NOTES:

IF JOIST IS NOT SEEN AT WALLS, IT IS TO BE SET IN PLACE AT WALLS. IT IS TO BE HELD IN PLACE BY BRACKETS AT WALLS.

IF JOIST IS NOT SEEN AT WALLS, IT IS TO BE SET IN PLACE AT WALLS. IT IS TO BE HELD IN PLACE BY BRACKETS AT WALLS.

FRAMING ILLUSTRATIONS ARE FOR INFORMATION ONLY. THEY ARE NOT TO BE USED AS A BASIS FOR CONSTRUCTION. THE CONTRACTOR IS RESPONSIBLE FOR VERIFYING DIMENSIONS OF ALL STRUCTURE CODES AND LOCAL ORDINANCES FOR THE LOCAL AREA. SEE THE BUILDING CODE.

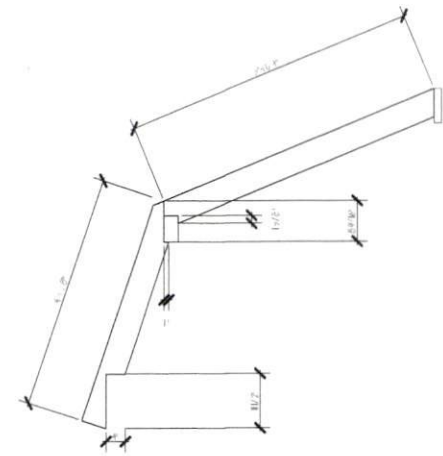

RAFTER DIAGRAM

SCALE 1" = 1'-0"

THIS DRAWING IS THE PROPERTY OF THE ARCHITECT. IT IS TO BE USED ONLY FOR THE PROJECT AND SITE SPECIFICALLY IDENTIFIED. ANY REUSE OR MODIFICATION OF THIS DRAWING WITHOUT THE ARCHITECT'S WRITTEN PERMISSION IS STRICTLY PROHIBITED. THE ARCHITECT ASSUMES NO LIABILITY FOR ANY ERRORS OR OMISSIONS. THE CONTRACTOR IS RESPONSIBLE FOR VERIFYING DIMENSIONS OF ALL STRUCTURE CODES AND LOCAL ORDINANCES FOR THE LOCAL AREA. SEE THE BUILDING CODE.

PROJECT NO. 5008-02



DATE: 5/18/20

PROJECT: 12' x 16' SHED GAMBREL STYLE

FRAMING ILLUSTRATIONS

DESIGN # 5008-02

SCALE AS NOTED

5/18/20

A1.2

12 FT X 16 FT GAMBREL SHED

by PLANS/BUILD

SLAB or WOOD FLOOR FRAMING

4 YARDS GOOD GRAVEL

3.96 YARDS 2,500 PSI CONCRETE (SLAB)

(15) 1/2" DIA X 12" ANCHOR BOLTS W/ NUT & WASHER

OR

(12) 8" X 16" X 4" SOLID CONCRETE BLOCKS

(15) 2 X 8, 12 FT (P-T JOIST & BLOCKING)

(2) 2 X 8, 16 FT (P-T RIM JOIST "LONG SIDE")

(6) SHT 4 X 8 , 3/4" P-T PLYWOOD

WALLS - FRAMING

56 L.FT. 2 X 4 (P-T SILLS)

56 L.FT. 2 X 4 (#2 S-P-F SILLS)

64 L.FT. 2 X 4 (#2 S-P-F PLATES)

(30) 2 X 4, 8FT (#2 S-P-F STUDS)

(8) 2 X 4, 10FT (#2 S-P-F GABLE END STUDS)

(10) 2 X 4, 12FT (#2 S-P-F GABLE END STUDS)

(8) 2 X 4, 14FT (#2 S-P-F GABLE END STUDS)

(2) 2 X 6, 12FT (#2 S-P-F HEADERS)

(18) 4 X 8 PLYWOOD (1/2" CDX SHEATHING)

BUILDING PAPER (TYVEK) AS NEEDED

ROOF - FRAMING

(1) 2 X 8, 16 FT (#2 S-P-F RIDGE)

(30) 2 X 6, 10 FT (#2 S-P-F RAFTERS)

(4) 2 X 6, 16 FT (#2 S-P-F GAMBREL BEAMS)

(13) 2 X 6, 12 FT (#2 S-P-F COLLAR TIES)

(6) 2 X 6, 8 FT (#2 S-P-F TIES BELOW RIDGE)

(12) 4 X 8, 1/2" CDX PLYWOOD (ROOF SHEATHING)

OPTIONAL (6) 4 X 8, 3/4" CDX PLYWOOD (LOFT FLR.)

SIDING & TRIM

520 SQ.FT. 1 X 12 (#2 PINE BD AND BATTEN SIDING)

34 L.FT. 1X6 (#2 PINE BD. SOFFITS)

34 L.FT. 1X3 (#2 PINE BD. SOFFITS)

84 L.FT. 1 X 8 (#2 PINE BD. FASICA)

84 L.FT. 1 X 4 (#2 PINE BD. FASICA TRIM)

24 L.FT 1 X 12 (#2 PINE BD. MISC TRIM)

ROOFING

360 SQ. FT COVERAGE (ASPHALT SHINGLES)

34 LIN. FT. ICE & WATER SHIELD

ROOFING FELT AS NEEDED

80 L.FT. ALUM DRIP EDGE

(2) 84" ALUM. WINDOW FLASHING

WINDOWS & DOORS AS NOTED
ON PLANS

NAILS FRAMING -

16 D GALV. COMMON

10 D GALV. COMMON

NAILS PLYWOOD -

1 3/4" GALV. RING SHANK

NAILS SIDING / TRIM -

2" STAINLESS FOR SIDING

NAILS ROOFING -

1 1/4" GALV. ROOFING

CONSTRUCTION

ADHESIVE

EXTERIOR STAIN / PAINT

SELECTED BY OWNER