

**SOIL/SITE EVALUATION  
 for ON-SITE WASTEWATER SYSTEM**

Owner: *-* Applicant: *JEFFREY WALKER*  
 Address: *828 MITCHELL RD* Date Evaluated: *01/06/2022*  
 Proposed Facility: Design Flow (.1949): *360 GPD* Property Size:  
 Location of Site: *3 on 5* Property Recorded: *360 GPD*  
 Water Supply:  Public  Individual  Well  Spring  Other  
 Evaluation Method:  Auger Boring  Pit  Cut  
 Type of Wastewater:  Sewage  Industrial Process  Mixed

P R O F I L E #	.1940 Landscape Position/ Slope %	Horizon Depth (In.)	SOIL MORPHOLOGY .1941		OTHER PROFILE FACTORS				Profile Class & LTAR
			.1941 Structure/ Texture	.1941 Consistence Mineralogy	.1942 Soil Wetness/ Color	.1943 Soil Depth (IN.)	.1956 Sapro Class	.1944 Restr Horiz	
<i>112</i>	<i>L 4%</i>	<i>0-34</i>	<i>CL LS</i>	<i>VL NSNP</i>					<i>PS</i>
		<i>34-48</i>	<i>ML SL</i>	<i>FL SP</i>		<i>48</i>			<i>0.375</i>
<i>34</i>	<i>L 4%</i>	<i>0-24</i>	<i>CL LS</i>	<i>VL NSNP</i>					<i>PS</i>
		<i>24-46</i>	<i>ML SL</i>	<i>FL SP</i>	<i>7.5 to 7.0 44"</i>	<i>46</i>			<i>0.375</i>

Description	Initial System	Repair System	Other Factors (.1946): Site Classification (.1948): <i>PROVISIONALLY SUITABLE</i> Evaluated By: Others Present: <i>ANDREW CURRY, REHS</i>
Available Space (.1945)	<i>✓</i>	<i>✓</i>	
System Type(s)	<i>25% 10"</i>	<i>25% 10"</i>	
Site LTAR	<i>0.375</i>	<i>0.375</i>	

COMMENTS: \_\_\_\_\_

LANDSCAPE POSITIONS	GROUP	TEXTURES	.1955 LTAR	CONSISTENCE MOIST	WET
R-RIDGE S-SHOULDER SLOPE L-LINEAR SLOPE FS-FOOT SLOPE N-NOSE SLOPE H-HEAD SLOPE CC-CONCLAVE SLOPE CV-CONVEX SLOPE T-TERRACE FP-FLOOD PLAN	I	S-SAND LS-LOAMY SAND	1.2 - 0.8	VFR-VERY FRIABLE FR-FRIABLE	NS-NON-STICKY SS-SLIGHTLY STICKY
	II	SL-SANDY LOAM L-LOAM	0.8 - 0.6	FI-FIRM VFI-VERY FIRM EFI-EXTREMELY FIRM	S-STICKY VS-VERY STICKY NP-NON-PLASTIC SP-SLIGHTLY STICKY
	III	SI-SILT SIL-SILT LOAM CL-CLAY LOAM SCL-SANDY CLAY LOAM	0.6 - 0.3		P-PLASTIC VP-VERY PLASTIC
	IV	SIC-SILTY CLAY C-CLAY SC-SANDY CLAY	0.4 - 0.1		

**STRUCTURE**  
 SG-SINGLE GRAIN  
 M-MASSIVE  
 CR-CRUMB  
 GR-GRANULAR  
 SBK-SUBANGULAR BLOCKY  
 ABK-ANGULAR BLOCKY  
 PL-PLATY  
 PR-PRISMATIC

**MINERALOGY**  
 SLIGHTLY EXPANSIVE  
 EXPANSIVE

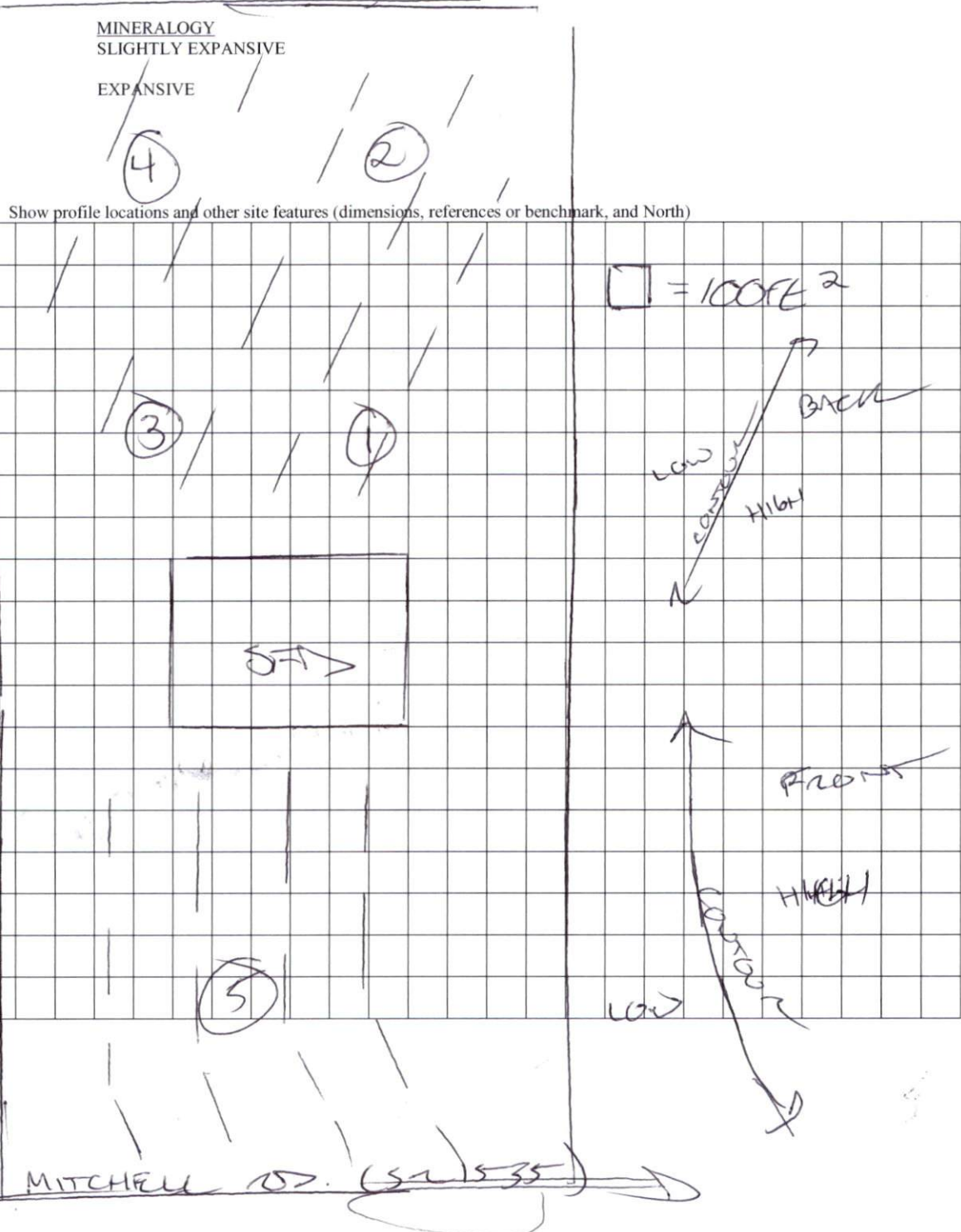

Show profile locations and other site features (dimensions, references or benchmark, and North)