

Harnett County Department of Public Health Improvement Permit

A building permit cannot be issued with only an Improvement Permit

PROPERTY LOCATION: 415 Sandstone Ln (NC 87 N)
 SUBDIVISION _____ LOT # _____

ISSUED TO: Julio Monterroso

NEW REPAIR EXPANSION

Type of Structure: 14'x68' SFD

Proposed Wastewater System Type: Tank Only

Projected Daily Flow: 360 GPD

Number of bedrooms: 3 Number of Occupants: 6 max

Basement Yes No

Pump Required: Yes No May be required based on final location and elevations of facilities

Type of Water Supply: Community Public Well Distance from well _____ feet

Permit valid for: Five years No expiration

Permit conditions: _____

Authorized State Agent: Moh D RETH Date: 06-03-22 SEE ATTACHED SITE SKETCH

The issuance of this permit by the Health Department in no way guarantees the issuance of other permits. The permit holder is responsible for checking with appropriate governing bodies in meeting their requirements. This site is subject to revocation if the site plan, plat, or the intended use changes. The Improvement Permit shall not be affected by a change in ownership of the site. This permit is subject to compliance with the provisions of the Laws and Rules for Sewage Treatment and Disposal and to conditions of this permit.

Construction Authorization (Required for Building Permit)

The construction and installation requirements of Rules .1950, .1952, .1954, .1955, .1956, .1957, .1958, and .1959 are incorporated by references into this permit and shall be met. Systems shall be installed in accordance with the attached system layout.

ISSUED TO: Julio Monterroso PROPERTY LOCATION: 415 Sandstone Ln (NC 87 N)
 SUBDIVISION _____ LOT # _____

Facility Type: 14'x68' SFD New Expansion Repair

Basement? Yes No Basement Fixtures? Yes No

Type of Wastewater System** Tank Only (Initial) Wastewater Flow: _____ GPD
 (See note below, if applicable) 25% reduction (Repair)

Installation Requirements/Conditions

Septic Tank Size <u>1000</u> gallons	Number of trenches _____	Exact length of each trench _____ feet	Trench Spacing: _____ Feet on Center
Pump Tank Size _____ gallons	Trenches shall be installed on contour at a	Maximum Trench Depth of: _____ inches	Soil Cover: _____ inches
	(Trench bottoms shall be level to +/-1/4" in all directions)	(Maximum soil cover shall not exceed 36" above the trench bottom)	

Pump Requirements: _____ ft. TDH vs. _____ GPM _____ inches below pipe

Aggregate Depth: _____ inches above pipe

Conditions: New Tank + reconnect to Existing Drain lines _____ inches total

**WATER LINES (INCLUDING IRRIGATION) MUST BE 10FT. FROM ANY PART OF SEPTIC SYSTEM OR REPAIR AREA.
 NO UTILITIES ALLOWED IN INITIAL OR REPAIR DRAIN FIELD AREA.**

**If applicable: I understand the system type specified is different from the type specified on the application. I accept the specifications of this permit.

Owner/Legal Representative Signature: _____ Date: _____

This Construction Authorization is subject to revocation if the site plan, plat, or the intended use changes. The Construction Authorization shall not be transferred when there is a change in ownership of the site. This Construction Authorization is subject to compliance with the provisions of the Laws and Rules for Sewage Treatment and Disposal and to the conditions of this permit. SEE ATTACHED SITE SKETCH

Authorized State Agent: Moh D RETH Date: 06-03-22
 Construction Authorization Expiration Date: 06-03-27

Application # BRES2112-0013

Harnett County Department of Public Health Site Sketch

Property Location: 415 Sandstone Ln (NC 87 N)

Issued To: Julio Monterroso

Subdivision _____

Lot # _____

Authorized State Agent: _____

Moh A RETH

Date: 06-03-22

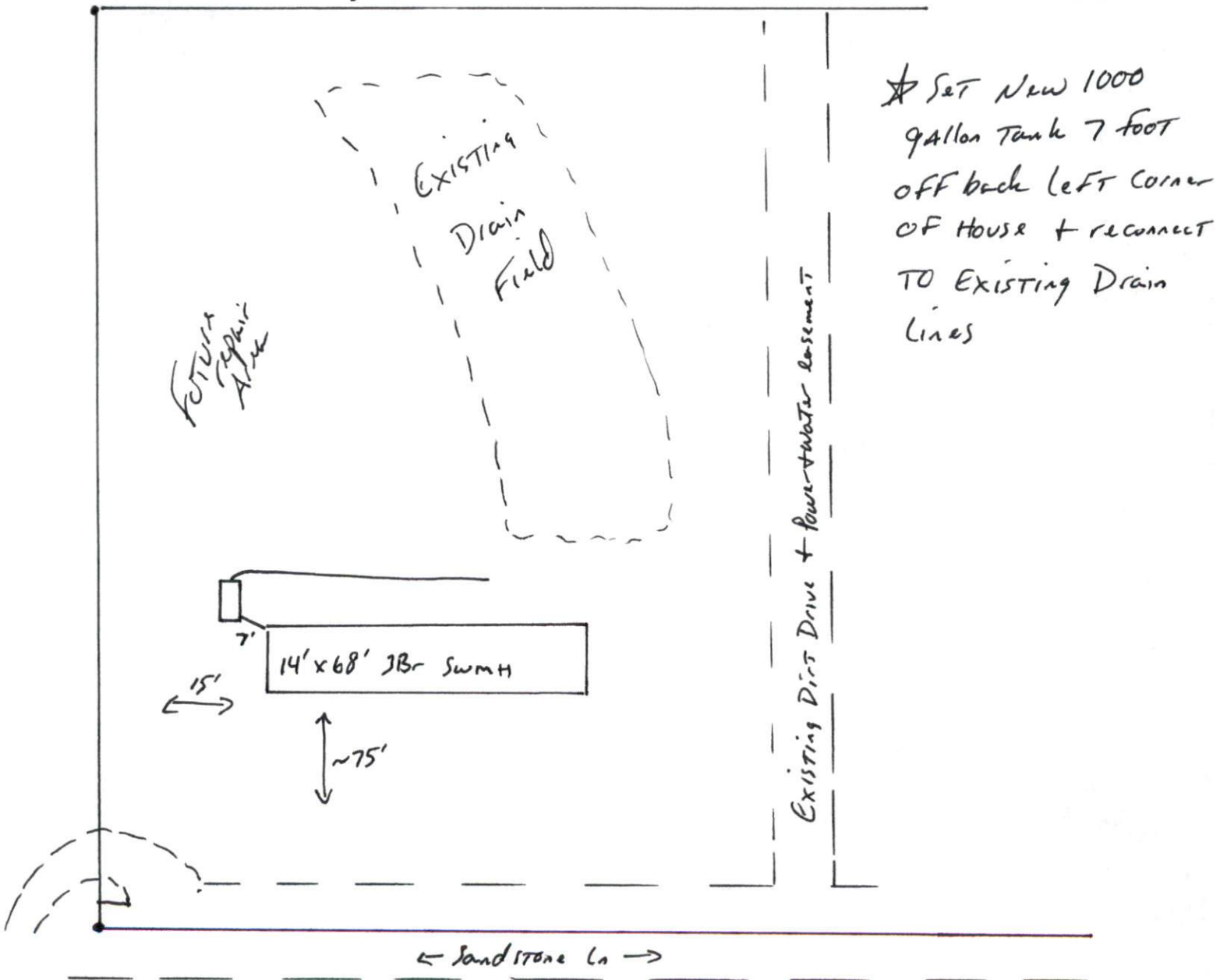

This drawing is for illustrative purposes only. System installation must meet all pertinent laws, rules, and regulations.