

# PLUMBING & SPECS.

| POOL SPECIFICATIONS   |                              |           |
|-----------------------|------------------------------|-----------|
| SHELL NAME            | 20'-0" x 40'-0"              |           |
| POOL DIMENSIONS       | 3'-4" x 8'-0"                |           |
| POOL DEPTHS           | 800 SF                       |           |
| POOL SURFACE AREA     | 119'                         |           |
| POOL PERIMETER        | 34,408 GALLONS               |           |
| POOL VOLUME           |                              |           |
| SPA SPECIFICATIONS    |                              |           |
| SHELL NAME            | ROYAL SPILLOVER              | (495 LBS) |
| SPA DIMENSIONS        | 7'-0" x 9'-0"                |           |
| SPA SURFACE AREA      | 63 SF                        |           |
| SPA PERIMETER         | 32'                          |           |
| SPA VOLUME            | 600 GALLONS                  |           |
| EQUIPMENT             |                              |           |
| CIRCULATION PUMP      | 2.7 HP / VARIABLE / ePUMP    |           |
| AUX. PUMP 1           | 460 CARTRIDGE                |           |
| FILTER                | 400,000 BTU NATURAL GAS      |           |
| HEATER                | FUSION SOFT 1400             |           |
| SANITATION CONTROLS   | RS-PS4 IAQUALINK             |           |
| JVA                   | (2)                          |           |
| SPA BLOWER            | YES                          |           |
| POOL RETURNS          | (3)                          |           |
| SPA THERAPIES         | (8)                          |           |
| ELECTRIC              |                              |           |
| POOL LIGHT            | (2) 24W COLOR LED            |           |
| SPA LIGHT             | (1) 12W COLOR LED            |           |
| STEEL & GUNITE        |                              |           |
| BENCHES & STEPS       | 80'                          |           |
| ROCK NOTCHES          | -                            |           |
| 6" RAISED WALL        | -                            |           |
| 12" RAISED WALL       | -                            |           |
| 18" RAISED WALL       | -                            |           |
| 24" RAISED WALL       | -                            |           |
| RAISED SPA SLEEVES    | 12" RAISED SPA               |           |
| WATER FEATURES        |                              |           |
| SHEER DESCENTS        | -                            |           |
| WOK POTS              | -                            |           |
| FOUNTAINS             | -                            |           |
| WATERFALLS            | -                            |           |
| PATIO                 |                              |           |
| PATIO MATERIAL        | CONCRETE PATIO               |           |
| PATIO COLOR           | SEE COLOR SELECTION SHEET    |           |
| COPING MATERIAL       | CONCRETE COPING              |           |
| COPING COLOR          | SEE COLOR SELECTION SHEET    |           |
| NEW PATIO (CONTRACT)  | 1,365 SF                     |           |
| NEW PATIO (PLAN)      | 1,446 SF                     |           |
| EXISTING PATIO AREA   | -                            |           |
| PATIO SLEEVES         | -                            |           |
| TILE                  |                              |           |
| RAISED WALL FACING    | STONE - SEE COLOR SELECTIONS |           |
| SPILLWAY TILE         | -                            |           |
| TILE INSERTS          | -                            |           |
| INTERIOR              |                              |           |
| INTERIOR FINISH TYPE  | VINYL                        |           |
| INTERIOR FINISH COLOR | PER SHELL CONTRACT           |           |
| MISCELLANEOUS         |                              |           |
| MISC.                 | -                            |           |
| MISC.                 | -                            |           |
| MISC.                 | -                            |           |
| BARRIERS              |                              |           |
| BARRIERS              | BY OWNERS                    |           |
| CLOSURES              | BY OWNERS                    |           |
| START UP              |                              |           |
| TOTAL VOLUME          | 35,008 GALLONS               |           |
| CLEANING SYSTEM       | VAC PORT ONLY                |           |
| POOL COVER            | -                            |           |
| INTERIOR BRUSHING     | N/A                          |           |
| POOL SERVICE          | 30 DAYS                      |           |

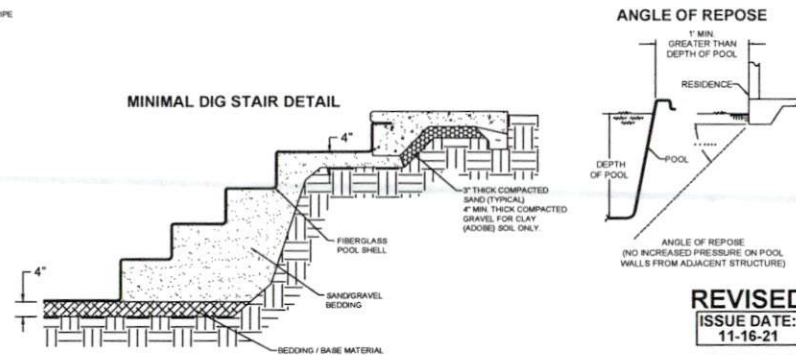
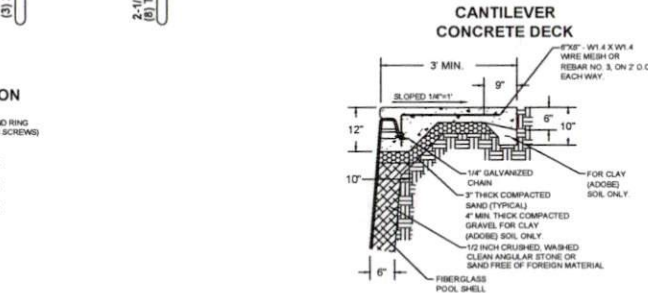
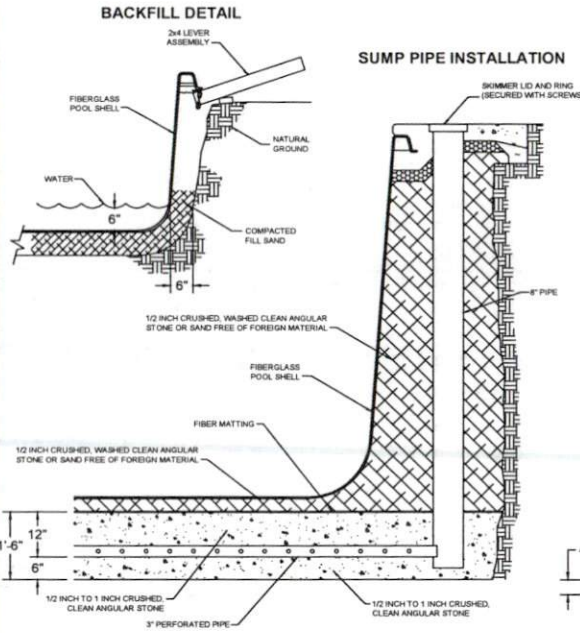
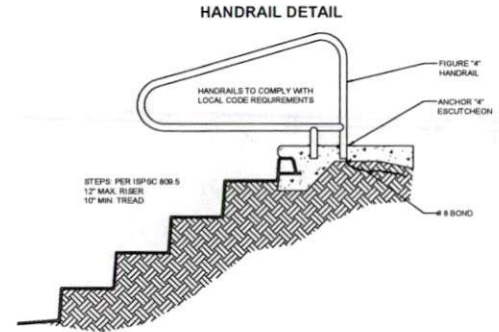
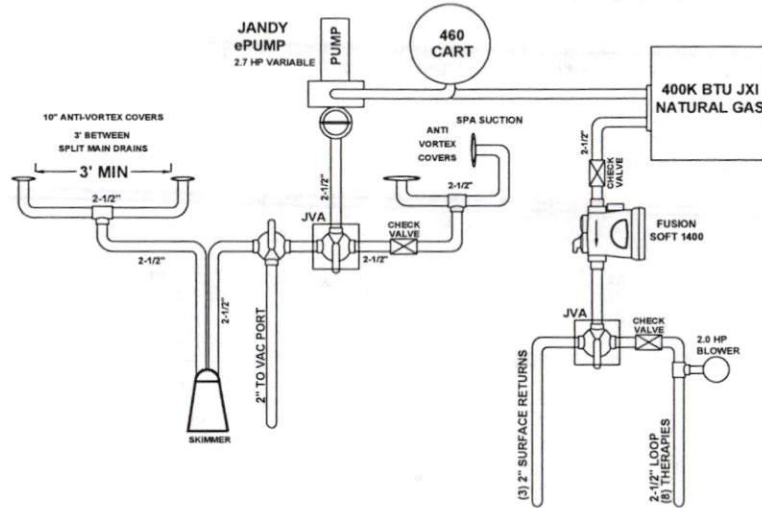

\*\*NOTE: PLANS ARE FOR REFERENCE, POOL TO BE INSTALLED ACCORDING TO MANUFACTURER'S INSTALLATION GUIDE\*\*

RALEIGH ROAD - SUITE 102  
DURHAM, NC 27703  
PHONE: (919) 400-1011  
FAX: (919) 400-1012  
NC LICENSE # 17473



NAME: \_\_\_\_\_  
ADDRESS: 10 SUTHER DR  
PHONE 1: \_\_\_\_\_  
CONSULTANT: DUANE HAIGHT  
SUPERVISOR: \_\_\_\_\_  
PHONE: \_\_\_\_\_  
CONTRACT DATE: 10/27/2021  
CUSTOMER SIGNATURE: \_\_\_\_\_

**REVISED**  
ISSUE DATE:  
11-16-21

JOB # 1356

