

# OPERATIONS PERMIT

01-5-1863

Name: (owner) Danny Morris

New Installation  Septic Tank

Property Location: SR# 9/108

Repairs  Nitrification Line

Subdivision Yorkshire Plantation

Lot # 36

TAX ID# \_\_\_\_\_

Quadrant # \_\_\_\_\_

Contractor: T. Brown

Registration # \_\_\_\_\_

Basement with Plumbing:  Garage:

Water Supply:  Well  Public  Community

Distance From Well: 50 ft.

Following are the specifications for the sewage disposal system on above captioned property.

Type of system:  Conventional  Other \_\_\_\_\_

Size of tank: Septic Tank: 1000 gallons Pump Tank: \_\_\_\_\_ gallons

Subsurface Drainage Field: No. of ditches 3 exact length of each ditch 70 ft. width of ditches 3 ft. depth of ditches 18 1/4 in.

French Drain: \_\_\_\_\_ Linear feet

Date: 8-13-01

PERMIT NO. 18230

Inspected by: [Signature]  
Environmental Health Specialist

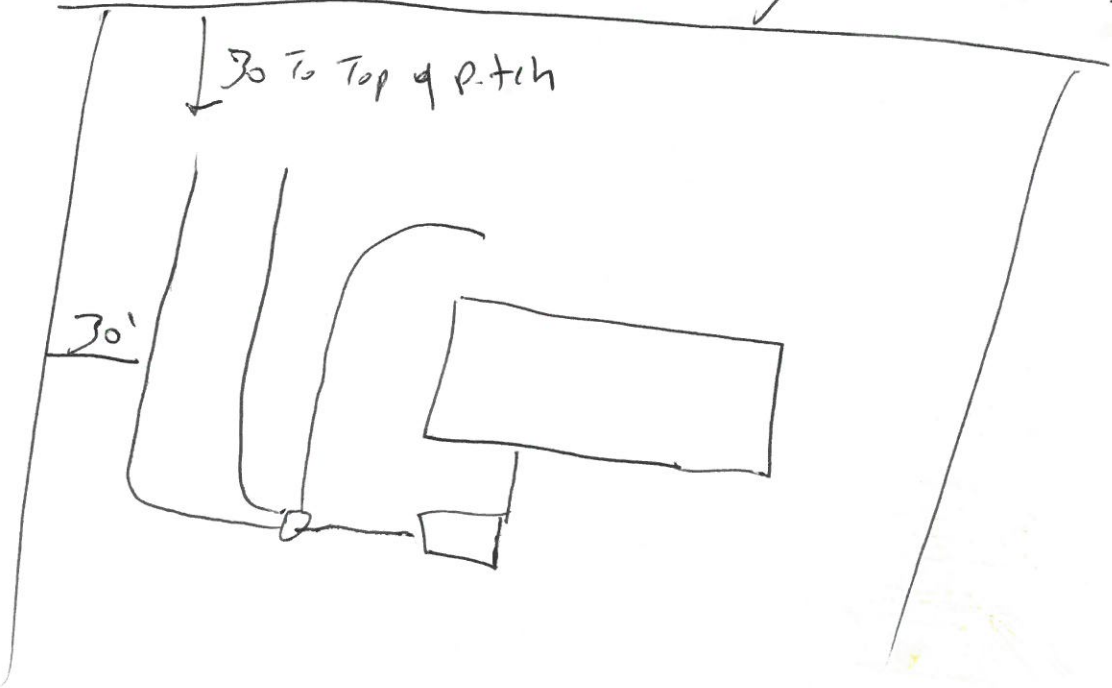

HARNETT COUNTY HEALTH DEPARTMENT

IMPROVEMENT PERMIT

No 18230

01-5-1860

Be it ordained by the Harnett County Board of Health as follows: Section III, Item B. "No Person shall begin construction of any building at which a septic tank system is to be used for disposal of sewage without first obtaining a written permit from the Harnett County Health Department."

Name: (owner) Danny Norris

New Installation  Septic Tank

Property Location: SR# 1108

Repairs  Nitrification Line

Subdivision Yorkshire Plantation Lot # 36

Tax ID # \_\_\_\_\_ Quadrant # \_\_\_\_\_

Number of Bedrooms Proposed: 3 (36x56) Lot Size: 1.34 A c

Basement with Plumbing:  Garage:

Water Supply:  Well  Public  Community

Distance From Well: 55 ft.

Following is the minimum specifications for sewage disposal system on above captioned property. Subject to final approval.

Type of system:  Conventional  Other \_\_\_\_\_

Size of tank: Septic Tank: 1000 gallons Pump Tank: \_\_\_\_\_ gallons

Subsurface Drainage Field No. of ditches 3 exact length of each ditch 70 ft. width of ditches 3 ft. depth of ditches 18-24 in.

French Drain Required: \_\_\_\_\_ Linear feet

<sup>49</sup>  
This permit is subject to revocation if site plans or intended use change.

Date: 5-11-02 54694

Signed: [Signature]  
Environmental Health Specialist

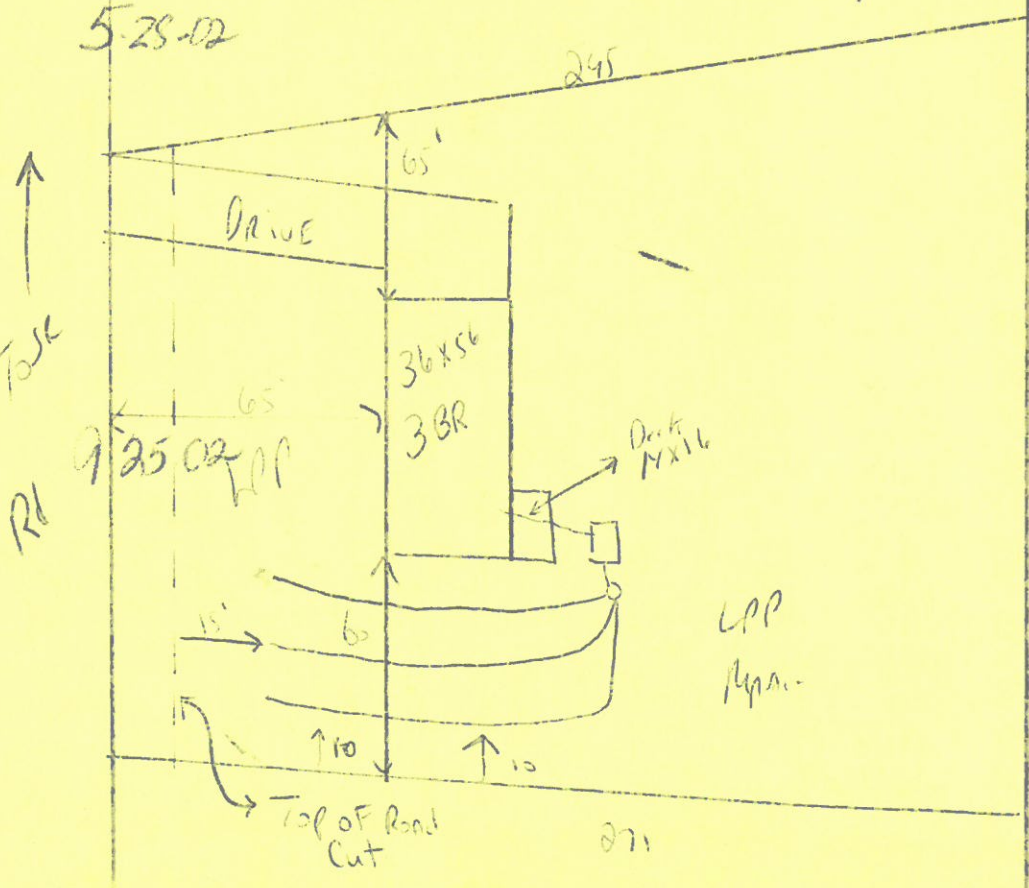

STUB out  
 plumbing shallow  
 18 to 24" Ditch  
 Depth  
 Follow set Backs  
 Keep Line 15' from  
 Top of Road Cut  
 Do not Drive  
 or park on  
 Septic system