

Harnett County Department of Public Health

Improvement Permit

A building permit cannot be issued with only an Improvement Permit

PROPERTY LOCATION: 371 Moores Chapel Rd (SR 1244)

ISSUED TO: Mauricus McLean

SUBDIVISION _____

LOT # _____

NEW REPAIR EXPANSION

Site Improvements required prior to Construction Authorization Issuance:

Type of Structure: 28' x 68' DWMH

MUST Clear the LOT and remove

Proposed Wastewater System Type: 25% reduction

debris, then call Environmental health

Projected Daily Flow: 480 GPD

for system layout

Number of bedrooms: 4 Number of Occupants: 8 max

Basement Yes No

Pump Required: Yes No May be required based on final location and elevations of facilities

Permit valid for: Five years
 No expiration

Type of Water Supply: Community Public Well Distance from well _____ feet

Permit conditions:

once lot is cleared and septic system is laid out, C.A. will be issued

Authorized State Agent: Moh RHE Date: 03-09-22

SEE ATTACHED SITE SKETCH

The issuance of this permit by the Health Department in no way guarantees the issuance of other permits. The permit holder is responsible for checking with appropriate governing bodies in meeting their requirements. This site is subject to revocation if the site plan, plat, or the intended use changes. The Improvement Permit shall not be affected by a change in ownership of the site. This permit is subject to compliance with the provisions of the Laws and Rules for Sewage Treatment and Disposal and to conditions of this permit.

Construction Authorization

(Required for Building Permit)

The construction and installation requirements of Rules .1950, .1952, .1954, .1955, .1956, .1957, .1958, and .1959 are incorporated by references into this permit and shall be met. Systems shall be installed in accordance with the attached system layout.

ISSUED TO: Mauricus McLean

PROPERTY LOCATION: 371 Moores Chapel Rd (SR 1244)

SUBDIVISION _____

LOT # _____

Facility Type: 28' x 68' DWMH New Expansion Repair

Basement? Yes No Basement Fixtures? Yes No

Type of Wastewater System** 25% reduction (Initial Wastewater Flow: 360 GPD)

(See note below, if applicable)

25% reduction (Repair)

Installation Requirements/Conditions

Number of trenches 1

Septic Tank Size 1000 gallons

Exact length of each trench 300 feet

Trench Spacing: 9 Feet on Center

Pump Tank Size _____ gallons

Trenches shall be installed on contour at a

Soil Cover: 6 inches

Maximum Trench Depth of: 12"-16" inches

(Maximum soil cover shall not exceed

(Trench bottoms shall be level to $\pm 1/4"$

36" above the trench bottom)

in all directions)

Pump Requirements: _____ ft. TDH vs. _____ GPM

Aggregate Depth: _____ inches below pipe

_____ inches above pipe

Conditions: MUST bring in 6" of Group II or Group III soil for cover over Drain Field

_____ inches total

**WATER LINES (INCLUDING IRRIGATION) MUST BE 10FT. FROM ANY PART OF SEPTIC SYSTEM OR REPAIR AREA.
NO UTILITIES ALLOWED IN INITIAL OR REPAIR DRAIN FIELD AREA.**

**If applicable: I understand the system type specified is different from the type specified on the application. I accept the specifications of this permit.

Owner/Legal Representative Signature: _____

Date: _____

This Construction Authorization is subject to revocation if the site plan, plat, or the intended use changes. The Construction Authorization shall not be transferred when there is a change in ownership of the site. This Construction Authorization is subject to compliance with the provisions of the Laws and Rules for Sewage Treatment and Disposal and to the conditions of this permit.

SEE ATTACHED SITE SKETCH

Authorized State Agent: Moh RHE

Date: 7-12-22

Construction Authorization Expiration Date: 7-12-27

Application # BRES2110-0051

Harnett County Department of Public Health Site Sketch

Property Location: 371 Moores Chapel Rd (SR 1244)

Issued To: Mauricus McLean Subdivision _____ Lot # _____

Authorized State Agent: *Mauricus McLean* REHS Date: 7-12-22

* MUST bring in 6" of Group II or Group III soil for cover over
Entire Drain field

* Make sure flags are still onsite before installing septic system

* Keep lines as shallow as possible to allow fall from
front to back of home

* Call IF you have
QUESTIONS

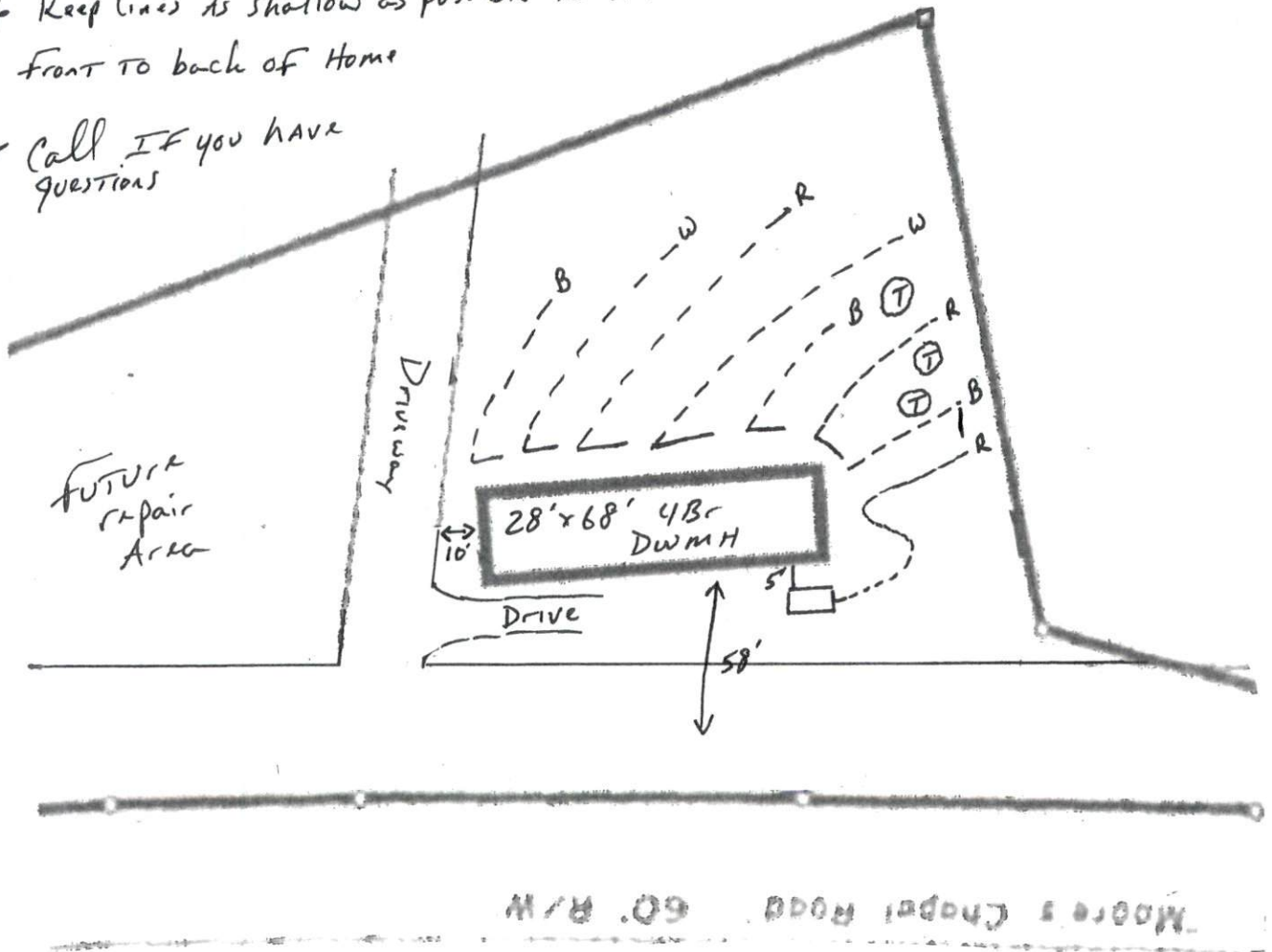

This drawing is for illustrative purposes only. System installation must meet all pertinent laws, rules, and regulations.