

Application # SFD 2022-0018

Harnett County Department of Public Health  
Site Sketch

Property Location: 730 Christian Light Road (SR 1412)

Used To: Welder Homes Inc

Subdivision: Fuller Farm

Lot: 5

Authorized State Agent: \_\_\_\_\_

Date: 03/11/2020

Proposed  
Shed

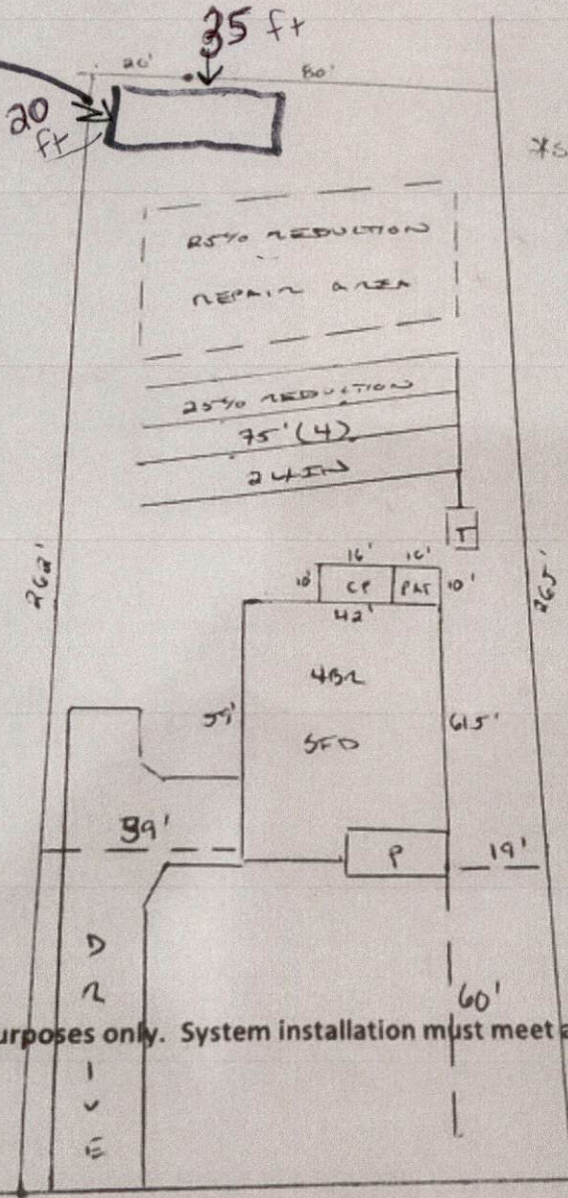

\*SIDEWALKS SHALL BE  
BE-DUCK AND SIDEWALKS  
SHALL BE TAKEN

**SITE PLAN APPROVAL**

**DISTRICT** RA30 **USE** 14x32

**#BEDROOMS** — pre fab  
shed

10-15-21 K.G.

**ZONING ADMINISTRATOR**

for illustrative purposes only. System installation must meet all pertinent laws, rules, and regulations.

CHRISTIAN LIGHT RD.  
(SR 1412)