



STANDARD CARPORT DETAILS 12 ft to 24 ft SPAN



CAROLINA CARPORTS INC.
P.O. BOX 1263
DOBSON, NC 27017
TOLL FREE 1-800-870-4262
LOCAL 336-367-6400
FAX 336-367-6410

This document is the property of Carolina Carports, Inc. Use of these plans without the permission of Carolina Carports is prohibited.

**TABLE 1
BOW/RAFTER FRAME, END POST, GROUND ANCHOR AND PANEL FASTENER SPACING SPECIFICATIONS**

WIND EXPOSURE CATEGORY	ULTIMATE WIND SPEED (MPH)	NOMINAL WIND SPEED (MPH)	MAXIMUM GROUND SNOW LOAD (PSF)	MAXIMUM POST/RAFTER SPACING (FEET)	AVERAGE FASTENER SPACING ON-CENTERS ALONG RAFTERS OR PURLINS, AND POSTS OR GIRTS (INCHES)	
					METAL PANELS	SPACING
B OR C	105 TO 140	85 TO 112	35	5.0	29 Gauge	8
			65	4.0		

NOTES: 1. Specifications applicable to 29 gauge metal panels fastened directly to 12 or 14 gauge steel tube bow frames.
2. Fasteners consist of #12 x 3" self-drilling screws with control seal washers.
3. Specifications applicable only for mean roof height of 24 feet or less and roof slopes of 7 to 27 degrees (1.5:12 to 6:12 pitch). Spacing requirements for other roof heights and/or slopes may vary.

**TABLE 1 (HIGH WIND REGION)
BOW/RAFTER FRAME, END POST, GROUND ANCHOR AND PANEL FASTENER SPACING SPECIFICATIONS**

WIND EXPOSURE CATEGORY	ULTIMATE WIND SPEED (MPH)	NOMINAL WIND SPEED (MPH)	MAXIMUM GROUND SNOW LOAD (PSF)	MAXIMUM POST/RAFTER SPACING (FEET)	AVERAGE FASTENER SPACING ON-CENTERS ALONG RAFTERS OR PURLINS, AND POSTS OR GIRTS (INCHES)	
					METAL PANELS	SPACING
B OR C	141 TO 150	113 TO 121	30	5.0	29 Gauge	8
			20	4.0	26 Gauge	6

NOTES: 1. Specifications applicable to 29 gauge and 26 gauge metal panels fastened directly to 12 or 14 gauge steel tube bow frames.
2. Fasteners consist of #12 x 3" self-drilling screws with control seal washer.
3. Specifications applicable only for mean roof height of 24 feet or less and roof slopes of 7 to 27 degrees (1.5:12 to 6:12 pitch). Spacing requirements for other roof heights and/or slopes may vary.

NOTE: USE \odot 2 1/2" x 2 1/2" 14 Ga.
 \odot 2 1/4" x 2 1/4" 12 Ga.
STEEL TUBE FOR ALL FRAME AND BASE RAIL MEMBERS UNLESS OTHERWISE SHOWN.

METAL CARPORT INSTALLATION PLANS AND DETAILS AND FRAMING AND FASTENER SPECIFICATIONS

CAROLINA CARPORTS, INC.
187 Cardinal Ridge Trail
DOBSON, NORTH CAROLINA 27017

THE OWNER IS RESPONSIBLE FOR OBTAINING A BUILDING PERMIT, IF NEEDED, AND FOR COMPLYING WITH ALL LOCAL BUILDING CODE REQUIREMENTS.

THIS IS TO CERTIFY THAT THE CALCULATIONS AND SPECIFICATIONS HEREIN HAVE BEEN PREPARED BY THE UNDERSIGNED PROFESSIONAL ENGINEER, AND ARE IN ACCORDANCE WITH THE REQUIREMENTS OF THE 2009, 2012, 2015 & 2018 INTERNATIONAL BUILDING CODES AND THE 2018 NORTH CAROLINA BUILDING CODE.

GENERAL NOTES:
THESE PLANS PERTAIN ONLY TO THE STRUCTURE, INCLUDING MAIN WIND FORCE RESISTING SYSTEM (MWFRS), COMPONENTS AND CLADDING, AND BASE RAIL ANCHORAGE. OTHER DESIGN ISSUES, INCLUDING, BUT NOT LIMITED TO, PLUMBING, ELECTRICAL, INGRESS/EGRESS, PROPERTY SET-BACKS, OR OTHER LOCAL ZONING REQUIREMENTS ARE THE RESPONSIBILITY OF OTHERS.
THESE STRUCTURES ARE DESIGNED AS UTILITY/STORAGE BUILDINGS CAPABLE OF SUPPORTING THE DEAD LOAD OF THE STRUCTURE AND APPLICABLE LIVE AND WIND LOADS. IMPROVEMENTS NOT SPECIFICALLY ADDRESSED HEREIN, WHICH EXERT ADDITIONAL LOADS ON THE STRUCTURE SHALL BE AT THE OWNER'S RISK. CAROLINA CARPORTS SHALL NOT BE RESPONSIBLE FOR STRUCTURAL DAMAGE OR FAILURE DUE TO THE APPLICATION OF ADDITIONAL LOADS.
ALL STEEL TUBING SHALL BE 55 KSI STEEL OR BETTER. ALL METAL PANELS SHALL BE 80 KSI STEEL OR BETTER.
FASTEN METAL ROOF AND WALL PANELS TO FRAMING WITH #12" x 3" SELF DRILLING FASTENERS WITH CONTROL SEAL WASHERS AT AN AVERAGE SPACING OF 8" FOR 29 GAUGE PANELS AND 6" FOR 26 GAUGE PANELS.
ALL FIELD CONNECTIONS SHALL BE #12 x 3" SELF DRILLING FASTENERS (SDF) UNLESS NOTED OTHERWISE.
ALL WELDED CONNECTIONS SHALL BE SHOP WELDED UNLESS NOTED OTHERWISE.
GROUND ANCHOR REQUIREMENTS: INSTALL HELICAL ANCHORS WITHIN 6" OF EACH CORNER POST AND AT A MAXIMUM SPACING OF 25' ALONG THE BASE RAIL. INSTALL GROUND RODS (#4 THREADED REBAR) BETWEEN THE HELICAL ANCHORS AT A MAXIMUM SPACING OF 5' AND A MINIMUM SPACING OF 4' ALONG THE BASE RAIL. HELICAL ANCHORS AND GROUND RODS ARE NOT REQUIRED FOR CONCRETE FOOTING AND/OR CONCRETE SLAB CONSTRUCTION.
CONCRETE EXPANSION ANCHORS SHALL BE ITW RAMSET/RED-HEAD TRIBOLT WEDGE ANCHOR, WEJ-IT ANKR-ITTE MODEL AT1252, OR SLEEVE ANCHOR MODEL HSA 1260, OR APPROVED EQUAL.
POST/RAFTER BRACING: BRACE ON EVERY POST/RAFTER CONNECTION, EXCEPT FOR END WALLS AND HEADERS.
GALVANIZATION: METAL ACCESSORIES FOR USE IN EXTERIOR WALL CONSTRUCTION AND NOT DIRECTLY EXPOSED TO THE WEATHER SHALL BE GALVANIZED IN ACCORDANCE WITH ASTM A 153, CLASS B-2. METAL PLATE CONNECTORS, SCREWS, BOLTS AND NAILS EXPOSED DIRECTLY TO THE WEATHER SHALL BE STAINLESS STEEL OR HOT DIPPED GALVANIZED.

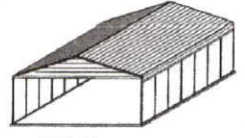

CONCRETE FOUNDATION AND DESIGN RECOMMENDATIONS:
CONCRETE SLAB AND FOUNDATION ARE BY OTHERS. COORDINATE CONCRETE STRENGTH AND FOUNDATION DEPTH REQUIREMENTS WITH THE LOCAL BUILDING CODE OFFICIALS. THE OWNER IS RESPONSIBLE FOR PROVIDING A SUITABLE FOUNDATION FOR THE PROPOSED STRUCTURE.
CONCRETE SHALL HAVE A MINIMUM SPECIFIED COMPRESSIVE STRENGTH OF 3000 PSI AT 28 DAYS OR AS REQUIRED BY LOCAL BUILDING CODE. THE USE OF HIGHER STRENGTH CONCRETE IS ACCEPTABLE.
COVER OVER REINFORCING STEEL: MINIMUM CONCRETE OVER REINFORCING BARS SHALL BE 3 INCHES WHERE CONCRETE IS CAST AGAINST AND PERMANENTLY IN CONTACT WITH THE EARTH OR EXPOSED TO THE EARTH OR WEATHER AND 1 1/2" ELSEWHERE.
REINFORCING STEEL: THE REINFORCING STEEL SHALL BE MINIMUM GRADE 40.

BUILDING CODE INFORMATION		DESIGN LOADS	
OCCUPANCY CATEGORY	I	MIN. DEAD LOAD	5 PSF
USE GROUP	U	MIN. FLOOR LIVE LOAD	100 PSF
CONSTRUCTION TYPE	3B	MIN. ROOF LIVE LOAD	20 PSF
		MIN. GROUND SNOW LOAD	
		MAX. GROUND SNOW LOAD	
		MIN. ULTIMATE WIND SPEED	SEE TABLE 1
		MAX. ULTIMATE WIND SPEED	
		EXPOSURE CATEGORY	
		SEISMIC RESPONSE COEFFICIENT	0.500

These plans have been provided for the purpose of obtaining a building permit for:

Name: **Timmy Wilson**
Address: **1344 Red Hill Church Rd**
City: **Dunn** State: **NC**
Zip: **28334**

Use of these plans by anyone else or for any other purpose is prohibited.

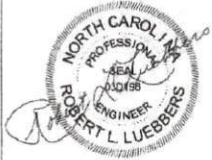

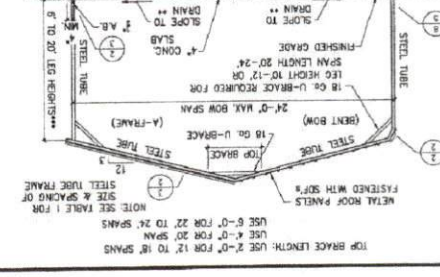
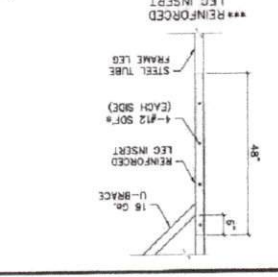
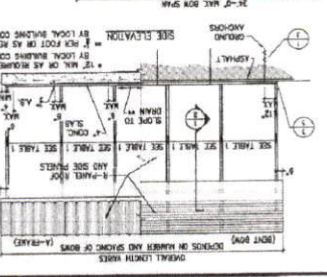
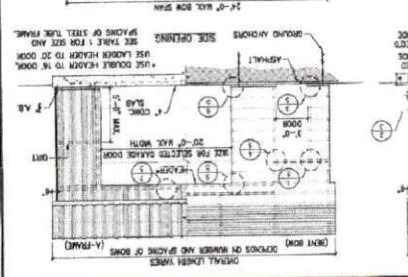
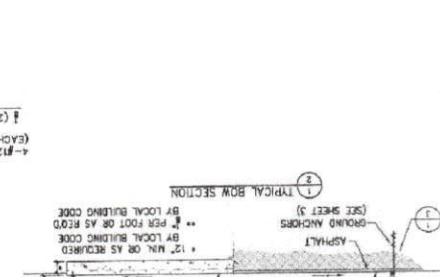
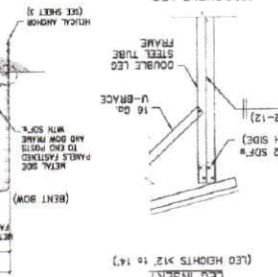
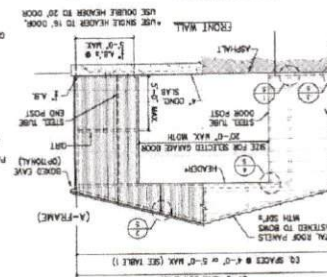
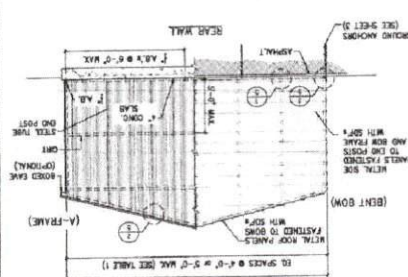
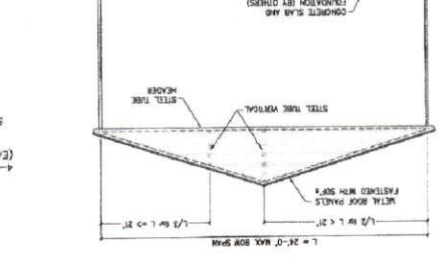
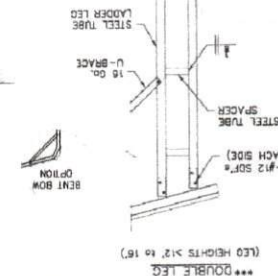
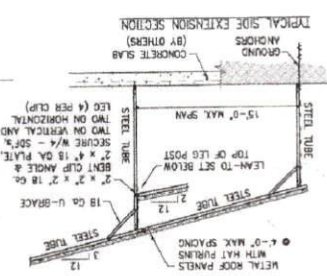
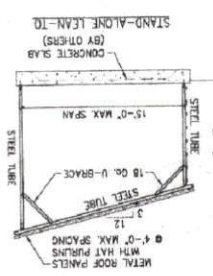

TOP BRACE LENGTH: USE 2'-0" FOR 12' TO 18' SPANS
 USE 6'-0" FOR 20' TO 24' SPANS
 NOTE: SEE TABLE 1 FOR
 SITE & SPACING OF
 METAL ROOF PANELS
 FASTENED WITH SOFS.
 (A-FRAME)
 STEEL TUBE
 18 GA. U-BRACE REQUIRED FOR
 LEG HEIGHT 10'-12' OR
 SPAN LENGTH 20'-24'
 FINISHED GRADE
 SLOPE TO DRAIN **
 + CONC. SLAB
 ** PER FOOT OR AS REQ'D
 BY LOCAL BUILDING CODE
 + 12" MIN. OR AS REQUIRED
 BY LOCAL BUILDING CODE
 ASPHALT
 GROUND ANCHORS
 (SEE SHEET 3)
 (LEO HEIGHTS 12' TO 14')

DOUBLE LEG (EACH SIDE)
 4-#12 SOF's
 16 GA. U-BRACE
 FRAME LEG
 STEEL TUBE
 (EACH SIDE)
 4-#12 SOF's
 REINFORCED LEG INSERT
 16 GA. U-BRACE
 48"

DOUBLE LEG (LEO HEIGHTS >12' TO 18')
 4-#12 SOF's
 16 GA. U-BRACE
 STEEL TUBE
 LADDER LEG
 16 GA. U-BRACE
 STEEL TUBE
 (LEO HEIGHTS 16' TO 20')

TYPICAL SIDE EXTENSION SECTION
 METAL ROOF PANELS WITH HAT PURLINS WITH MAX SPACING @ 4'-0" MAX SPACING
 18 GA. U-BRACE
 15'-0" MAX SPAN
 STEEL TUBE
 CONCRETE SLAB (BY OTHERS)
 STAND-ALONE LEAN-TO

TYPICAL SIDE EXTENSION SECTION
 METAL ROOF PANELS WITH HAT PURLINS WITH MAX SPACING @ 4'-0" MAX SPACING
 18 GA. U-BRACE
 15'-0" MAX SPAN
 STEEL TUBE
 CONCRETE SLAB (BY OTHERS)
 STAND-ALONE LEAN-TO

FRONT WALL
 ASPHALT
 5'-0" MAX
 18 GA. U-BRACE
 STEEL TUBE
 BENT BOW
 METAL ROOF PANELS FASTENED TO BOW WITH SOFS
 18 GA. U-BRACE
 15'-0" MAX SPAN
 STEEL TUBE
 CONCRETE SLAB (BY OTHERS)
 STAND-ALONE LEAN-TO

FRONT WALL
 ASPHALT
 5'-0" MAX
 18 GA. U-BRACE
 STEEL TUBE
 BENT BOW
 METAL ROOF PANELS FASTENED TO BOW WITH SOFS
 18 GA. U-BRACE
 15'-0" MAX SPAN
 STEEL TUBE
 CONCRETE SLAB (BY OTHERS)
 STAND-ALONE LEAN-TO

REINFORCED LEG INSERT
 16 GA. U-BRACE
 48"

DOUBLE LEG (LEO HEIGHTS >12' TO 18')
 4-#12 SOF's
 16 GA. U-BRACE
 STEEL TUBE
 LADDER LEG
 16 GA. U-BRACE
 STEEL TUBE
 (LEO HEIGHTS 16' TO 20')

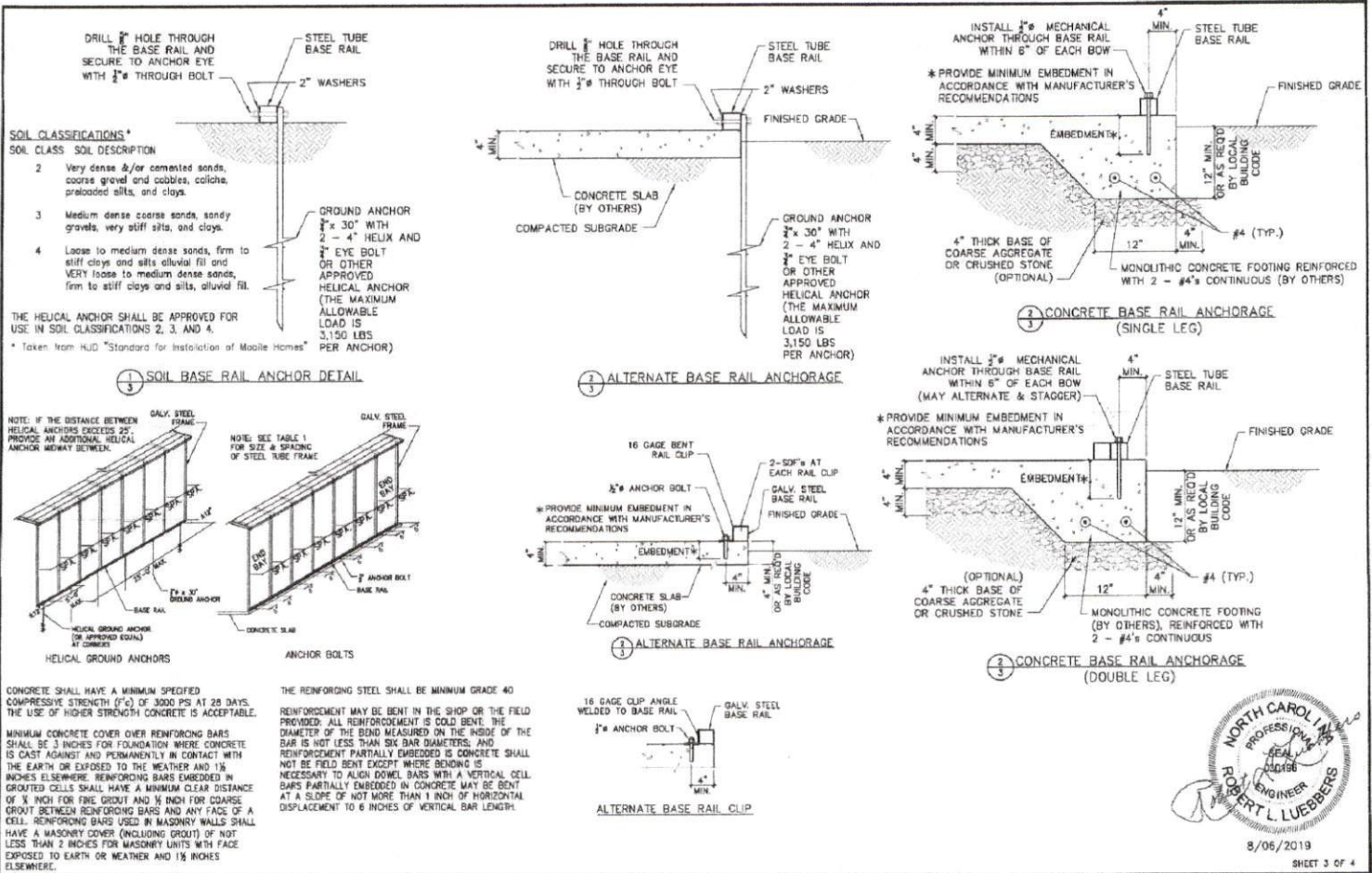

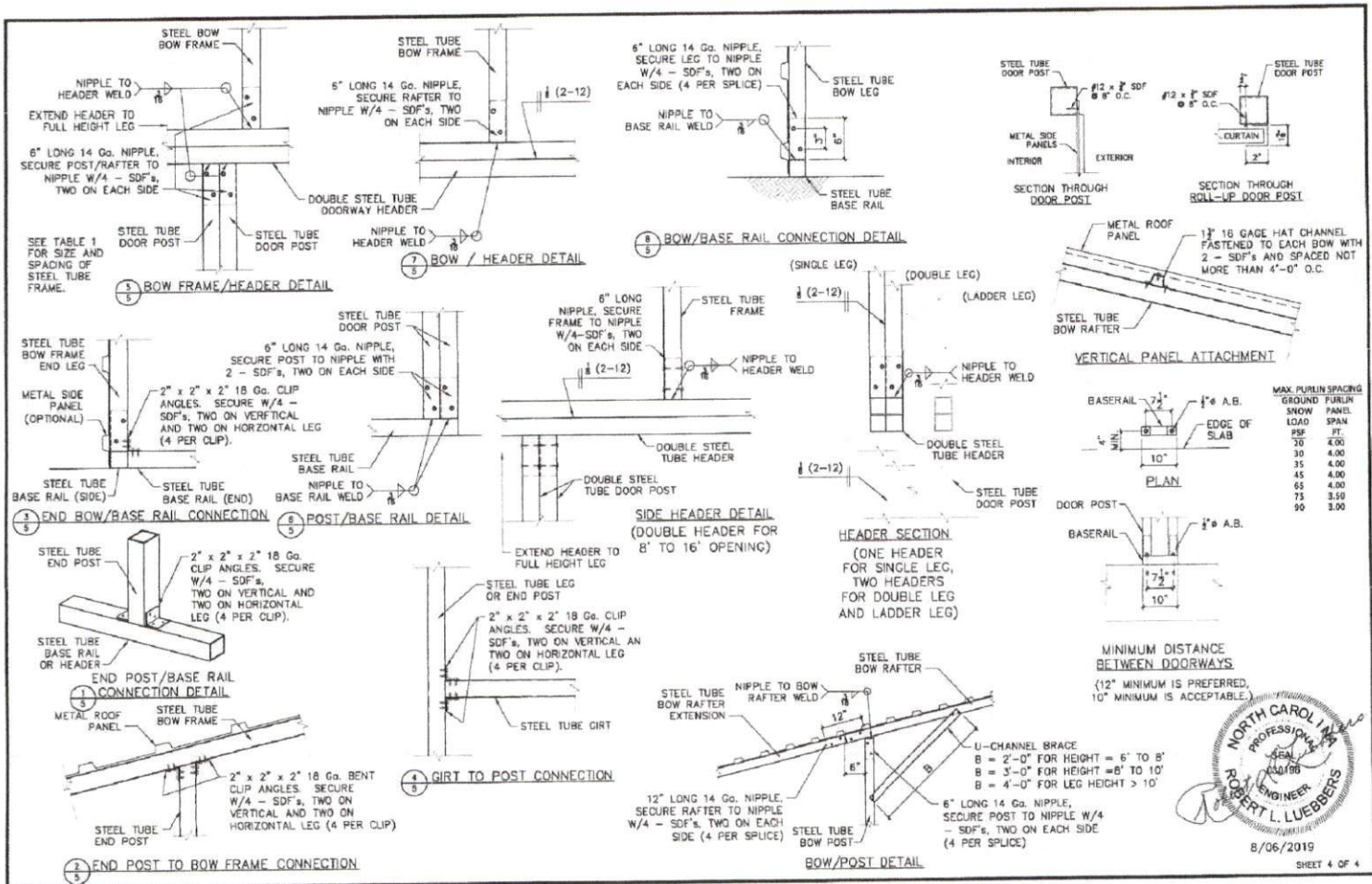

NORTH CAROLINA
 PROFESSIONAL ENGINEER
 ROBERT L. LUEBBERTS
 License No. 22120

Fwd: Carolina Carports - Timmy Wilson

From: Giovanni Gonzalez (giovanni.g@carolinacarports.com)
To: littleriverlillington@yahoo.com; slick1957@yahoo.com
Date: Thursday, October 7, 2021, 03:02 PM EDT

----- Forwarded message -----
From: **Giovanni Gonzalez** <giovanni.g@carolinacarports.com>
Date: Mon, Oct 4, 2021 at 1:55 PM
Subject: Carolina Carports - Timmy Wilson
To: <slick1957@yahoo.com>

Attached are the generic plans for your reference.

If your building is going to be installed on concrete, please be aware, these plans show a minimum of 4" anchor edge distance as well as 12" footer around the perimeter of the building (sheet 3 of 4) . The alternate base rail anchorage options are only to be used when you have an existing pad or the pad has been poured incorrectly. Additional charges do apply.

Once the site is ready for installation, please call our scheduling department at 1-800-670-4262 and ask for the scheduling dept for your state.

Thank you for choosing Carolina Carports!

--

Giovanni Gonzalez
Permitting Dept
1-800-670-4262
ext 2095

--

Giovanni Gonzalez
Permitting Dept
1-800-670-4262
ext 2095

Please do not print this email unless it is absolutely necessary..... Save Paper.....Spread Environmental Awareness..!!!

This e-mail including any attachments(s) are the property of Carolina Carports, Inc. and/or its affiliates and contains confidential and privileged material for the sole use of the intended recipient(s). That is protected by the attorney client or other legal privileges, and/or proprietary non public information. Any review, use, distribution, dissemination, or disclosure of this message and/or any of its attachments (if any) by unintended recipients is not authorized and may be unlawful and prohibited. If you are not the intended recipient, please contact the sender and delete all copies of the message from your system.



Timmy Wilson - NC.pdf
1MB