

Doggendorf - Pool Proposal  
 3-Bedroom Septic Relocation Proposal  
 104 Lonnie Betts Drive

\*Repair Area per existing permit with Harnett County Health Department is not impacted.

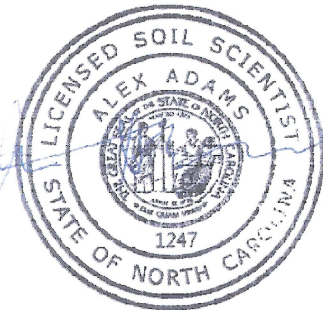

Existing System

System: Gravity  
 Lines: 1-2 (140')

Proposed Primary System Modification

Abandon existing trenches.  
 Add 2 new line as shown meeting all required setbacks.  
 0.4 LTAR  
 18" Trench Bottoms  
 2- 120' Trenches - Innovative Product

Lonnie Betts Drive

Pool:

- 25' from House
- 21' from septic lines
- 75' from property line

Shed:

- 16' x 32' Enclosed
- 10' x 32' covered porch area
- 15' from pool
- 34' from property line
- 17' from house

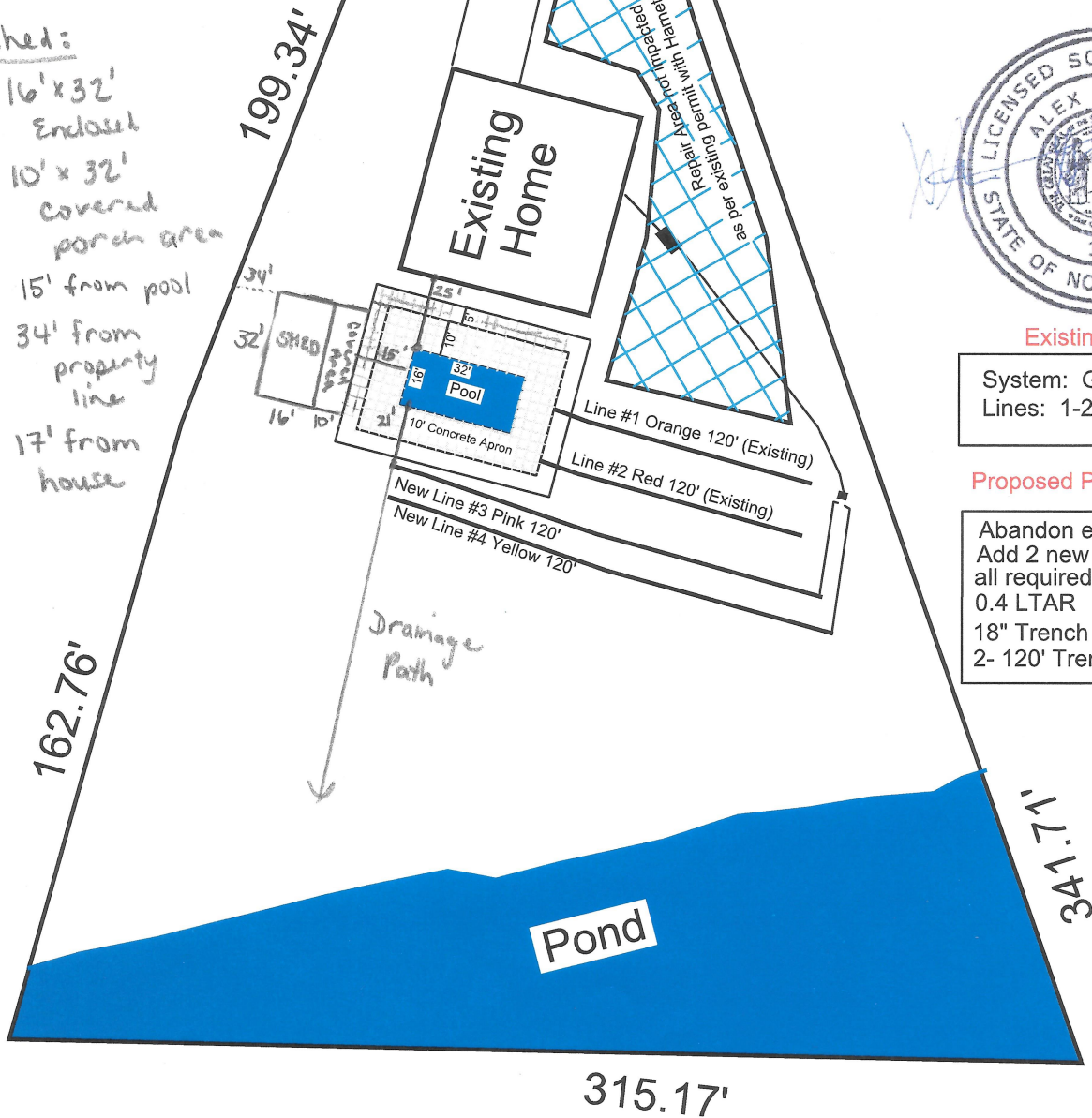

GRAPHIC SCALE  
 1" = 50'



Adams  
 Soil Consulting  
 919-414-6761  
 Job #830