

ISK
 House - 2560
 Drive = 2640
 walk
 Total = 5200
 pool patio = 800
 Proposed = 6000

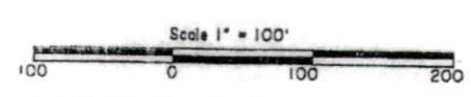
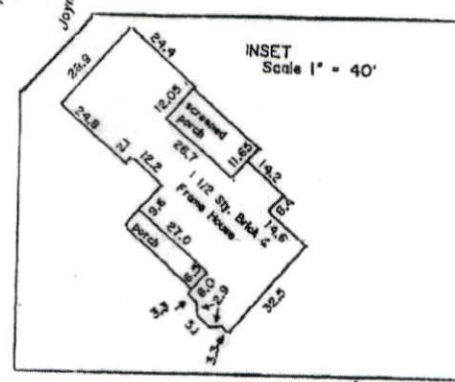

Lot 17, The Homestead
 Plat Cab. C, Slide 128-B
 Property of
**STEVEN D. SHIPE & WIFE,
 MARILEE S. SHIPE**

Black River Twp., Harnell Co., N. C.
 Scale 1\"/>

I, Thomas Lester Stonell, certify that this plot was drawn
 under my supervision from an actual survey made under
 my supervision and description recorded in bk. , Po.

TINGEN POOL

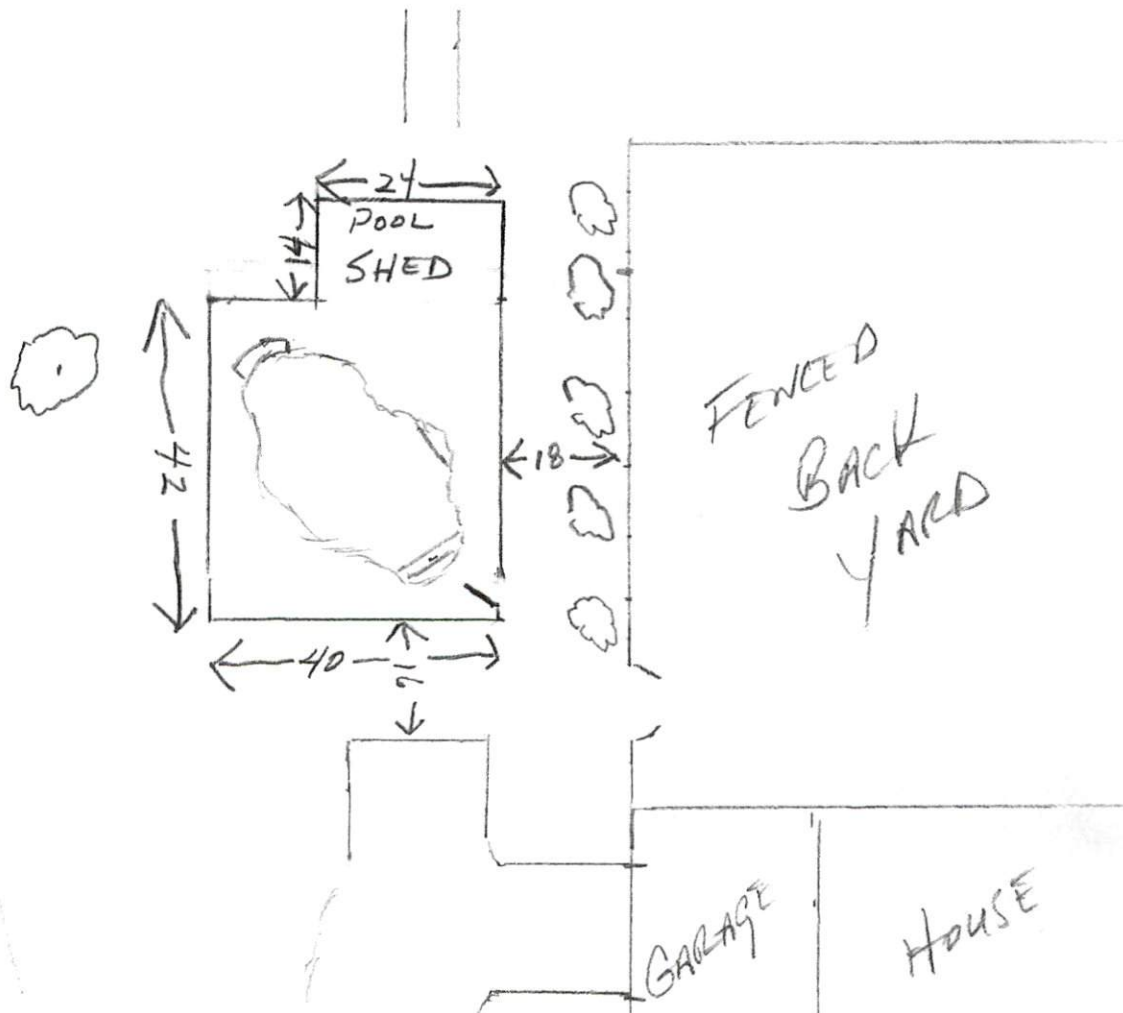

SCALE
10mm = 10 FT