



STRUCTURAL DESIGN

ENCLOSED BUILDING

MAXIMUM 24'- 0" WIDE X 17'- 0" EAVE HEIGHT-
BOX EAVE FRAME AND BOW FRAME

9 August 2019

Revision 0

M&A Project No. 19105S

Prepared for:

Carport Central, Inc.
737 South Main Street
Mount Airy, NC 27030

Prepared by:

Moore and Associates Engineering and Consulting, Inc.

1009 East Avenue
North Augusta, SC 29841

401 S. Main Street, Suite 200
Mount Airy, NC 27030



MOORE AND ASSOCIATES
ENGINEERING AND CONSULTING

		<p>I HAVE RESEARCHED THIS CHAPTER AND THE LOUISIANA STATE UNIFORM CONSTRUCTION CODE AND TO THE BEST OF MY KNOWLEDGE AND BELIEF, THESE DRAWINGS ARE IN COMPLIANCE THEREWITH. I TAKE FULL RESPONSIBILITY FOR THE CONTENTS OF THESE PLANS.</p>	

MOORE AND ASSOCIATES
ENGINEERING AND CONSULTING, INC.

DRAWN BY: LT

CHECKED BY: PDH

PROJECT MGR: WSH

CLIENT: CC

CARPENT CENTRAL, INC.
737 SOUTH MAIN STREET
MOUNT AIRY, NC 27030

24'-0" x 17'-0" ENCLOSED STRUCTURE

DATE: 8-9-19

SHT. 1

SCALE: NTS

DWG. NO: SK-3

JOB NO: 1910SS

REV: 0

THIS DOCUMENT IS THE PROPERTY OF MOORE AND ASSOCIATES ENGINEERING AND CONSULTING. THE UNAUTHORIZED REPRODUCTION, COPYING, OR OTHERWISE USE OF THIS DOCUMENT IS STRICTLY PROHIBITED AND ANY INFRINGEMENT THEREUPON MAY BE SUBJECT TO LEGAL ACTION.

	<p>Professional Certification. I hereby certify that these documents were prepared or approved by me, and that I am a duly licensed professional engineer under the laws of the State of Maryland, License No. 49744, Expiration Date 6/6/20</p>		

<p>MOORE AND ASSOCIATES ENGINEERING AND CONSULTING, INC.</p>	<p>DRAWN BY: LT CHECKED BY: PDH</p>	<p>CARPENTRAL, INC. 737 SOUTH MAIN STREET MOUNT AIRY, NC 27030 24'-0" x 17'-0" ENCLOSED STRUCTURE</p>	
<p><small>THIS DOCUMENT IS THE PROPERTY OF MOORE AND ASSOCIATES ENGINEERING AND CONSULTING. THE UNAUTHORIZED REPRODUCTION, COPYING, OR OTHERWISE USE OF THIS DOCUMENT IS STRICTLY PROHIBITED AND ANY INFRINGEMENT THEREUPON MAY BE SUBJECT TO LEGAL ACTION.</small></p>	<p>PROJECT MGR: VSM CLIENT: CC</p>	<p>DATE: 8-9-19 SHT. 1A</p>	<p>SCALE: NTS JOB NO: 191055 DVG NO: SK-3 REV: 0</p>

** CarportCentral Authorized Manufacturer Of Customer Use Only**

MOORE AND ASSOCIATES ENGINEERING AND CONSULTING, INC.	DRAWN BY: LT	CARPORT CENTRAL, INC. 737 SOUTH MAIN STREET MOUNT AIRY, NC 27030 24'-0" x 17'-0" ENCLOSED STRUCTURE		
	CHECKED BY: PDH	PROJECT MGR: VSM	DATE: 8-5-19	SCALE: NTS
THIS DOCUMENT IS THE PROPERTY OF MOORE AND ASSOCIATES ENGINEERING AND CONSULTING. THE UNAUTHORIZED REPRODUCTION, COPYING, OR OTHERWISE USE OF THIS DOCUMENT IS STRICTLY PROHIBITED AND ANY VIOLATION THEREUPON MAY BE SUBJECT TO LEGAL ACTION.	CLIENT: CC	SHT. 1B	DWG. NO: SK-3	REV: 0

DRAWING INDEX



SHEET 1	PE SEAL COVER SHEET (1 OF 3)
SHEET 1A	PE SEAL COVER SHEET (2 OF 3)
SHEET 1B	PE SEAL COVER SHEET (3 OF 3)
SHEET 2	DRAWING INDEX
SHEET 3	INSTALLATION NOTES AND SPECIFICATIONS
SHEET 4	TYPICAL SIDE AND END ELEVATIONS
SHEET 5	TYPICAL RAFTER/COLUMN END AND SIDE FRAMING SECTION (BOX EAVE RAFTER)
SHEET 5A	TYPICAL RAFTER/COLUMN END AND SIDE FRAMING SECTION (BOX EAVE RAFTER)
SHEET 5B	TYPICAL RAFTER/COLUMN END AND SIDE FRAMING SECTION (BOX EAVE RAFTER)
SHEET 5C	TYPICAL RAFTER/COLUMN END AND SIDE FRAMING SECTION (BOX EAVE RAFTER)
SHEET 6	COLUMN CONNECTION DETAILS
SHEET 7	TYPICAL RAFTER/COLUMN END AND SIDE FRAMING SECTION (BOW RAFTER)
SHEET 7A	TYPICAL RAFTER/COLUMN END AND SIDE FRAMING SECTION (BOW RAFTER)
SHEET 7B	TYPICAL RAFTER/COLUMN END AND SIDE FRAMING SECTION (BOW RAFTER)
SHEET 7C	TYPICAL RAFTER/COLUMN END AND SIDE FRAMING SECTION (BOW RAFTER)
SHEET 8	COLUMN CONNECTION DETAILS
SHEET 9	BASE RAIL ANCHORAGE OPTIONS
SHEET 9A	BASE RAIL ANCHORAGE OPTIONS
SHEET 10	TYPICAL END WALL AND SIDE WALL FRAMING SECTIONS (BOX EAVE RAFTER)
SHEET 11	TYPICAL END WALL AND SIDE WALL FRAMING SECTIONS (BOW RAFTER)
SHEET 12	CONNECTION DETAILS
SHEET 13	CONNECTION DETAILS
SHEET 14	LEAN-TO OPTIONS (BOX EAVE RAFTER)
SHEET 14A	LEAN-TO OPTIONS (BOX EAVE RAFTER)
SHEET 15	LEAN-TO OPTIONS (BOW RAFTER)
SHEET 16	VERTICAL ROOF OPTION END AND SIDE ELEVATION AND SECTION
SHEET 17	OPTIONAL BASE RAIL ON GRADE
SHEET 18	OPTIONAL BASE RAIL ON TIMBER BEAM
SHEET 19	OPTIONAL BASE RAIL ON TIMBER BEAM WITH SOIL NAIL
SHEET 20	OPTIONAL CONCRETE TRIP FOOTING
SHEET 21	OPTIONAL HEADER

** CarportCentral Authorized Manufacturer Of Customer Use Only**

MOORE AND ASSOCIATES ENGINEERING AND CONSULTING, INC.	DRAWN BY: LT	CARPORT CENTRAL, INC. 737 SOUTH MAIN STREET MOUNT AIRY, NC 27030 24'-0" x 17'-0" ENCLOSED STRUCTURE			
	CHECKED BY: PDH	PROJECT MGR: WSM	DATE: 8-5-19	SCALE: NTS	JOB NO: 1910SS
THIS DOCUMENT IS THE PROPERTY OF MOORE AND ASSOCIATES ENGINEERING AND CONSULTING. THE UNAUTHORIZED REPRODUCTION, COPYING, OR OTHERWISE USE OF THIS DOCUMENT IS STRICTLY PROHIBITED AND ANY INFRACTION THEREUPON MAY BE SUBJECT TO LEGAL ACTION.	CLIENT: CC	SHT. 2	DVG. NO: SK-3	REV: 0	

INSTALLATION NOTES AND SPECIFICATIONS

- 1 DESIGN IS FOR MAXIMUM 24'-0" WIDE x 17'-0" EAVE HEIGHT ENCLOSED STRUCTURES
- 2 DESIGN WAS DONE IN ACCORDANCE WITH THE 2018 NORTH CAROLINA BUILDING CODE, 2017 FLORIDA BUILDING CODE (FBC) 6TH EDITION 2005 INTERNATIONAL BUILDING CODE (IBC), 2009 IBC, 2012 IBC, 2015 IBC, AND 2018 IBC.
- 3 DESIGN LOADS ARE AS FOLLOWS
 - A) DEAD LOAD = 15 PSF
 - B) LIVE LOAD = 12 PSF
 - C) GROUND SNOW LOAD = 37 PSF AT 5'-0" OC SPACING
= 41 PSF AT 4'-0" OC SPACING

NOTE: UNBALANCED SNOW LOADS DUE TO DRIFTING HAVE NOT BEEN EVALUATED
- 4 ULTIMATE WIND SPEED 103 TO 127 MPH (NOMINAL WIND SPEED 82 TO 99 MPH)
MAXIMUM RAFTER/COLUMN AND END COLUMN SPACING = 5.0 FEET
- 5 ULTIMATE WIND SPEED 105 TO 140 MPH (NOMINAL WIND SPEED 82 TO 108 MPH)
MAXIMUM RAFTER/COLUMN AND END COLUMN SPACING = 4.0 FEET
- 6 END WALL COLUMN (POSTS) ARE SIMILAR TO SIDE WALL POSTS IN SIZE AND SPACING UNLESS NOTED OTHERWISE
- 7 RISK CATEGORY I
- 8 WIND EXPOSURE CATEGORY B
- 9 SPECIFICATIONS APPLICABLE TO 29 GAUGE METAL PANELS FASTENED DIRECTLY TO 2 1/4" x 2 1/4" - 14 GAUGE TUBE STEEL (TS) FRAMING MEMBERS (UNLESS NOTED OTHERWISE)
- 10 AVERAGE FASTENER SPACING ON-CENTERS ALONG RAFTERS OR HAT CHANNELS, AND COLUMNS (INTERIOR OR END) = 8 INCHES
- 11 FASTENERS CONSIST OF #12-14x3/4" (UNLESS OTHERWISE NOTED) SELF-DRILLING FASTENER (SDF) USE CONTACT SEAL WASHER WITH EXTERIOR FASTENERS. SPECIFICATIONS APPLICABLE ONLY FOR MEAN ROOF HEIGHT OF 20 FEET OR LESS, AND ROOF SLOPES OF 14° (3:12) PITCH OR LESS. SPACING REQUIREMENTS FOR OTHER ROOF HEIGHTS AND/OR SLOPES MAY VARY.
- 12 ANCHORS SHALL BE INSTALLED THROUGH BASE RAIL WITHIN 6" OF EACH COLUMN
- 13 STANDARD GROUND ANCHORS (SOIL NAILS) CONSIST OF #4 REBAR W/ WELDED NUT x 36" LONG. SOIL NAILS MAY BE USED FOR MAXIMUM WIND V = 145 MPH AND IN SUITABLE SOIL CONDITIONS. OPTIONAL ANCHORAGE MAY BE USED IN UNSUITABLE SOILS AND MUST BE USED FOR WIND V > 145 MPH AND/OR IN UNSUITABLE SOILS AS NOTED.
- 14 WIND FORCES GOVERN OVER SEISMIC FORCES. SEISMIC PARAMETERS ANALYZED ARE:
 SOIL SITE CLASS = D
 RISK CATEGORY I/II/III
 P = 325 I_m = 1.0
 S_{DS} = 2.039 g V = 0.1W
 S_M = 1.258 g
- 14 DOOR AND WINDOW PRESSURES APPLICABLE TO THE STATE OF FLORIDA

** CarportCentral Authorized Manufacturer Of Customer Use Only**

MOORE AND ASSOCIATES ENGINEERING AND CONSULTING, INC.	DRAWN BY: LT	CARPORT CENTRAL, INC. 737 SOUTH MAIN STREET MOUNT AIRY, NC 27030 24'-0" x 17'-0" ENCLOSED STRUCTURE		
	CHECKED BY: PDH	PROJECT MGR: WSM	DATE: 8-9-19	SCALE: NTS
THIS DOCUMENT IS THE PROPERTY OF MOORE AND ASSOCIATES ENGINEERING AND CONSULTING. THE UNAUTHORIZED REPRODUCTION, COPYING, OR OTHERWISE USE OF THIS DOCUMENT IS STRICTLY PROHIBITED AND ANY INFRINGEMENT THEREUPON MAY BE SUBJECT TO LEGAL ACTION.	CLIENT: CC	SHT. 3	DWG. NO: SK-3	JOB NO: 19105S REV: 0

BOX EAVE FRAME RAFTER STRUCTURE

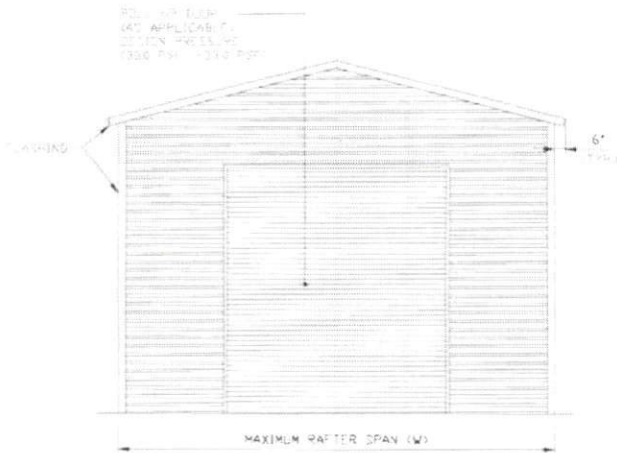

TYPICAL END ELEVATION-HORIZONTAL ROOF
SCALE: NTS

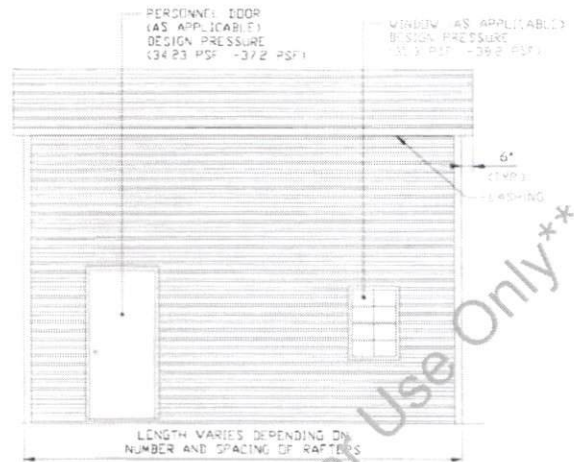

TYPICAL SIDE ELEVATION-HORIZONTAL ROOF
SCALE: NTS

BOX FRAME RAFTER STRUCTURE

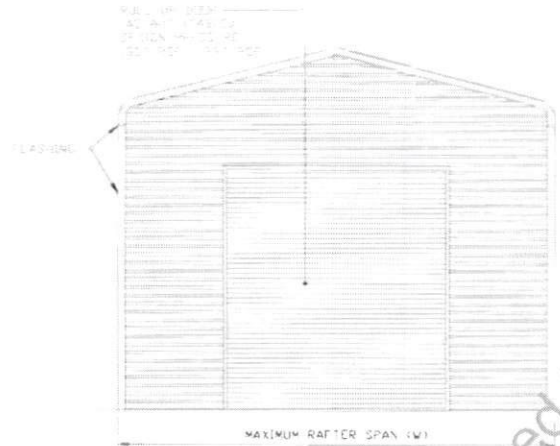

TYPICAL END ELEVATION
SCALE: NTS



TYPICAL SIDE ELEVATION
SCALE: NTS

**MOORE AND ASSOCIATES
ENGINEERING AND CONSULTING, INC.**

DRAWN BY: LT

CHECKED BY: PDH

PROJECT MGR: WSH

CLIENT: CC

CARPOT CENTRAL, INC.
737 SOUTH MAIN STREET
MOUNT AIRY, NC 27030
24'-0" x 17'-0" ENCLOSED STRUCTURE

DATE: 8-9-19

SHT. 4

SCALE: NTS

DWG. NO: SK-3

JOB NO: 191055

REV: 0

THIS DOCUMENT IS THE PROPERTY OF MOORE AND ASSOCIATES ENGINEERING AND CONSULTING. THE UNAUTHORIZED REPRODUCTION, COPYING, OR OTHERWISE USE OF THIS DOCUMENT IS STRICTLY PROHIBITED AND ANY INFRINGEMENT THEREUPON MAY BE SUBJECT TO LEGAL ACTION.

20'-0" < W ≤ 24'-0" SPAN

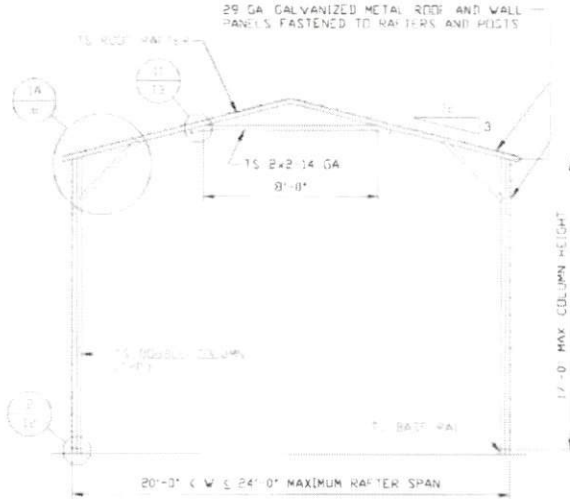

TYPICAL RAFTER/COLUMN END FRAME SECTION
SCALE: NTS

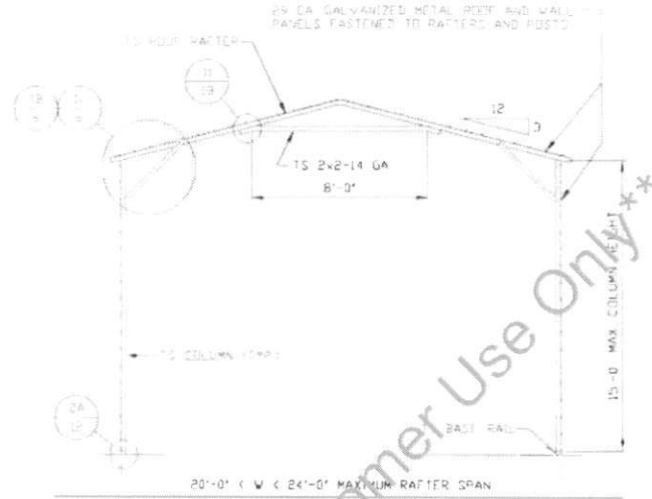

TYPICAL RAFTER/COLUMN END FRAME SECTION
SCALE: NTS

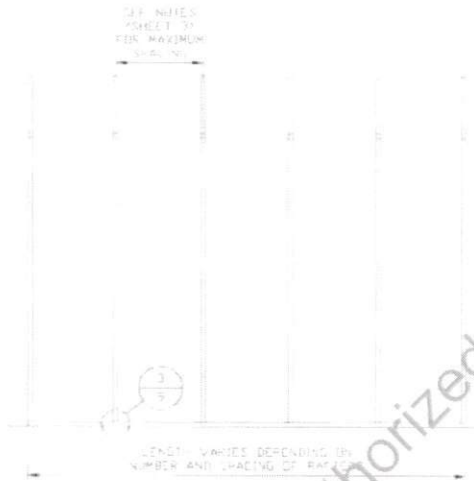

TYPICAL RAFTER/COLUMN SIDE FRAMING SECTION
SCALE: NTS

** CarportCentral Authorized Manufacturer Of Customer Use Only**

MOORE AND ASSOCIATES ENGINEERING AND CONSULTING, INC.	DRAWN BY: LT	CARPORT CENTRAL, INC 737 SOUTH MAIN STREET MOUNT AIRY, NC 27030 24'-0" x 17'-0" ENCLOSED STRUCTURE			
	CHECKED BY: PDH	PROJECT MGR: VSM	DATE: 8-9-19	SCALE: NTS	JOB NO: 1910SS
THIS DOCUMENT IS THE PROPERTY OF MOORE AND ASSOCIATES ENGINEERING AND CONSULTING. THE UNAUTHORIZED REPRODUCTION, COPYING, OR OTHERWISE USE OF THIS DOCUMENT IS STRICTLY PROHIBITED AND ANY OFFENSEMENT THEREUPON MAY BE SUBJECT TO LEGAL ACTION.	CLIENT: CC	SHT. 5	DWG. NO: SK-3	REV: 0	

18'-0" < W ≤ 20'-0" SPAN

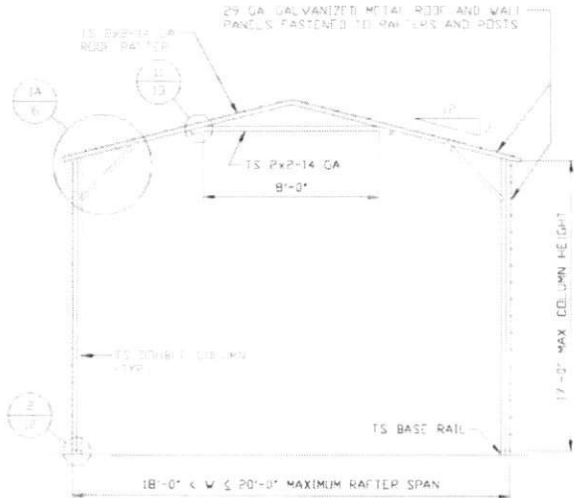

TYPICAL RAFTER/COLUMN END FRAME SECTION

SCALE: NTS

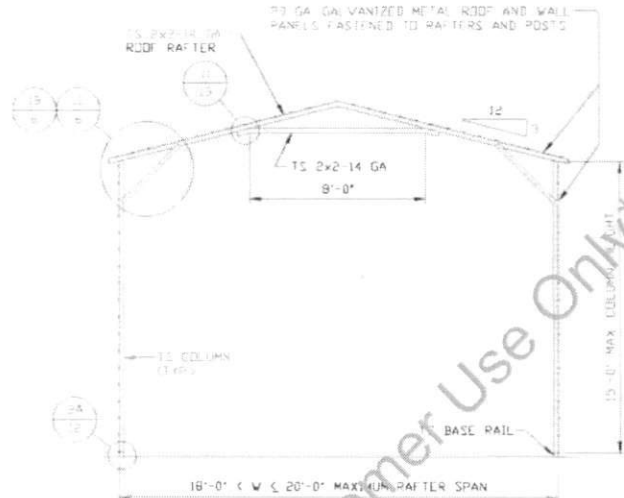

TYPICAL RAFTER/COLUMN END FRAME SECTION

SCALE: NTS

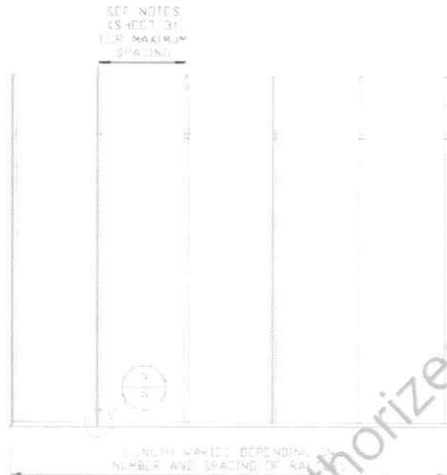

TYPICAL RAFTER/COLUMN SIDE FRAMING SECTION

SCALE: NTS

**** CarportCentral Authorized Manufacturer Of Customer Use Only****

**MOORE AND ASSOCIATES
ENGINEERING AND CONSULTING, INC.**

DRAWN BY: LT

CHECKED BY: PDH

PROJECT MGR: WSM

CLIENT: CC

CARPORIT CENTRAL, INC
737 SOUTH MAIN STREET
MOUNT AIRY, NC 27030

24'-0" x 17'-0" ENCLOSED STRUCTURE

DATE: 8-9-19

SHT. 5A

SCALE: NTS

DWG. NO: SK-3

JOB NO: 1910SS

REV: 0

THIS DOCUMENT IS THE PROPERTY OF MOORE AND ASSOCIATES ENGINEERING AND CONSULTING. THE UNAUTHORIZED REPRODUCTION, COPYING, OR OTHERWISE USE OF THIS DOCUMENT IS STRICTLY PROHIBITED AND ANY INFRINGEMENT THEREOF MAY BE SUBJECT TO LEGAL ACTION.

12'-0" < W ≤ 18'-0" SPAN

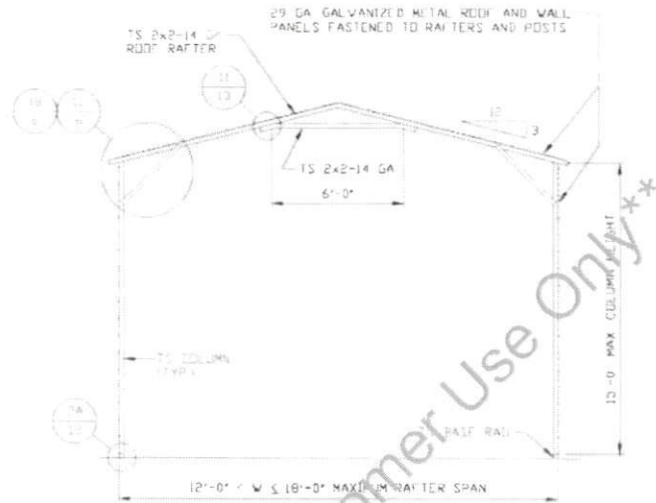
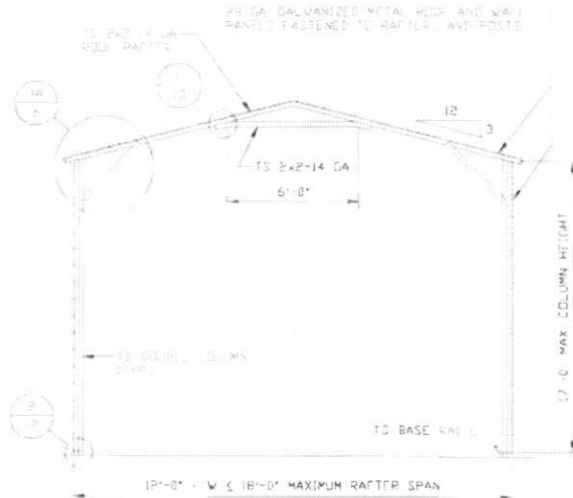

TYPICAL RAFTER/COLUMN END FRAME SECTION

TYPICAL RAFTER/COLUMN END FRAME SECTION

SCALE: NTS

SCALE: NTS

NOTE:
OPTIONAL 18GA U CHANNEL PEAK BRACE CAN BE UTILIZED IN LIEU OF TUBE STEEL.

NOTE:
OPTIONAL 18GA U CHANNEL PEAK BRACE CAN BE UTILIZED IN LIEU OF TUBE STEEL.

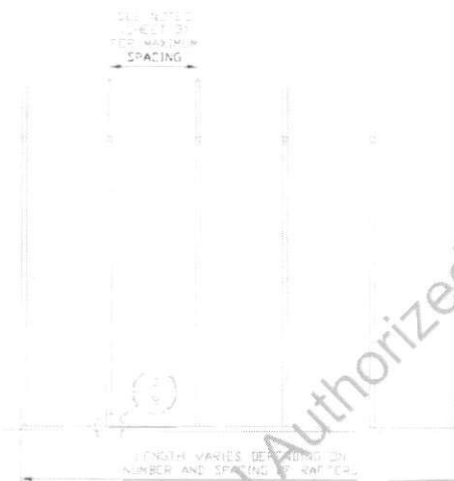

TYPICAL RAFTER/COLUMN SIDE FRAMING SECTION

SCALE: NTS

**MOORE AND ASSOCIATES
ENGINEERING AND CONSULTING, INC.**

DRAWN BY: LT

CHECKED BY: PDH

CARPOT CENTRAL, INC
737 SOUTH MAIN STREET
MOUNT AIRY, NC 27030
24'-0" x 17'-0" ENCLOSED STRUCTURE

THIS DOCUMENT IS THE PROPERTY OF MOORE AND ASSOCIATES ENGINEERING AND CONSULTING. THE UNAUTHORIZED REPRODUCTION, COPYING, OR OTHERWISE USE OF THIS DOCUMENT IS STRICTLY PROHIBITED AND ANY INFRINGEMENT THEREUPON MAY BE SUBJECT TO LEGAL ACTION.

PROJECT MGR: WSM

CLIENT: CC

DATE: 8-9-19

SHT. 5B

SCALE: NTS

DWG. NO: SK-3

JOB NO: 19105S

REV: 0

W ≤ 12'-0" SPAN

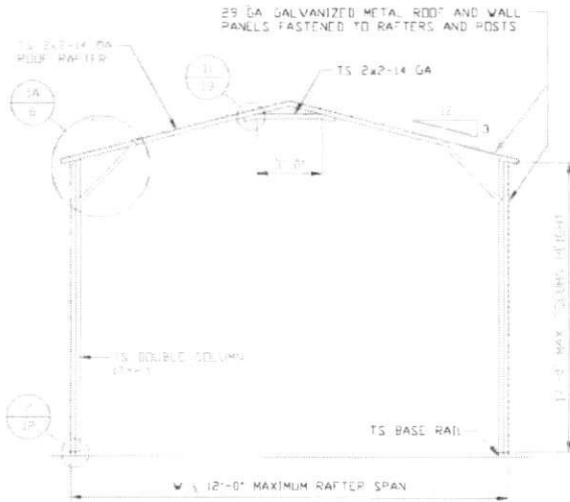

TYPICAL RAFTER/COLUMN END FRAME SECTION

SCALE: NTS

NOTE:
OPTIONAL 18GA U CHANNEL PEAK BRACE CAN BE UTILIZED IN LIEU OF TUBE STEEL

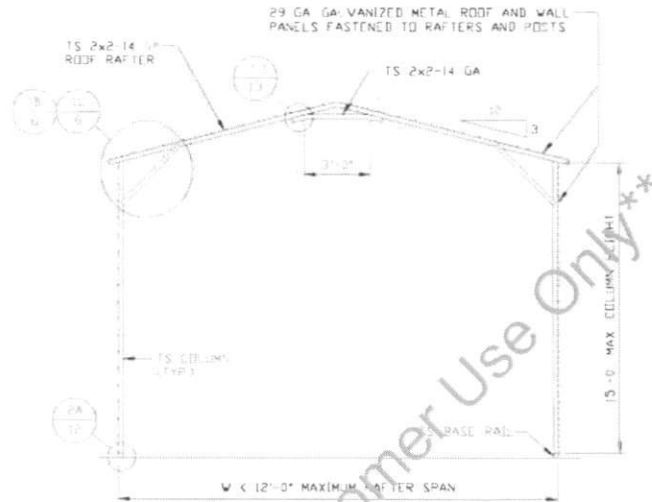

TYPICAL RAFTER/COLUMN END FRAME SECTION

SCALE: NTS

NOTE:
OPTIONAL 18GA U CHANNEL PEAK BRACE CAN BE UTILIZED IN LIEU OF TUBE STEEL

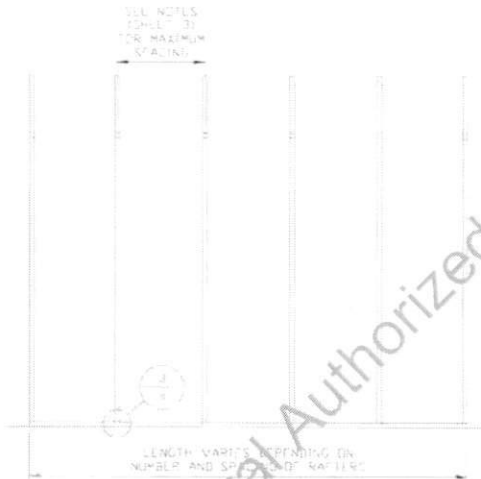

TYPICAL RAFTER/COLUMN SIDE FRAMING SECTION

SCALE: NTS

MOORE AND ASSOCIATES
ENGINEERING AND CONSULTING, INC.

DRAWN BY: LT

CHECKED BY: PDH

PROJECT MGR: WSM

CLIENT: CC

CARPORT CENTRAL, INC
737 SOUTH MAIN STREET
MOUNT AIRY, NC 27030
24'-0" x 17'-0" ENCLOSED STRUCTURE

DATE: 8-9-19

SHT. 5C

SCALE: NTS

DWG. NO: SK-3

JOB NO: 191096

REV: 0

THIS DOCUMENT IS THE PROPERTY OF MOORE AND ASSOCIATES ENGINEERING AND CONSULTING. THE UNAUTHORIZED REPRODUCTION, COPYING, OR OTHERWISE USE OF THIS DOCUMENT IS STRICTLY PROHIBITED AND ANY INFRINGEMENT THEREUPON MAY BE SUBJECT TO LEGAL ACTION.

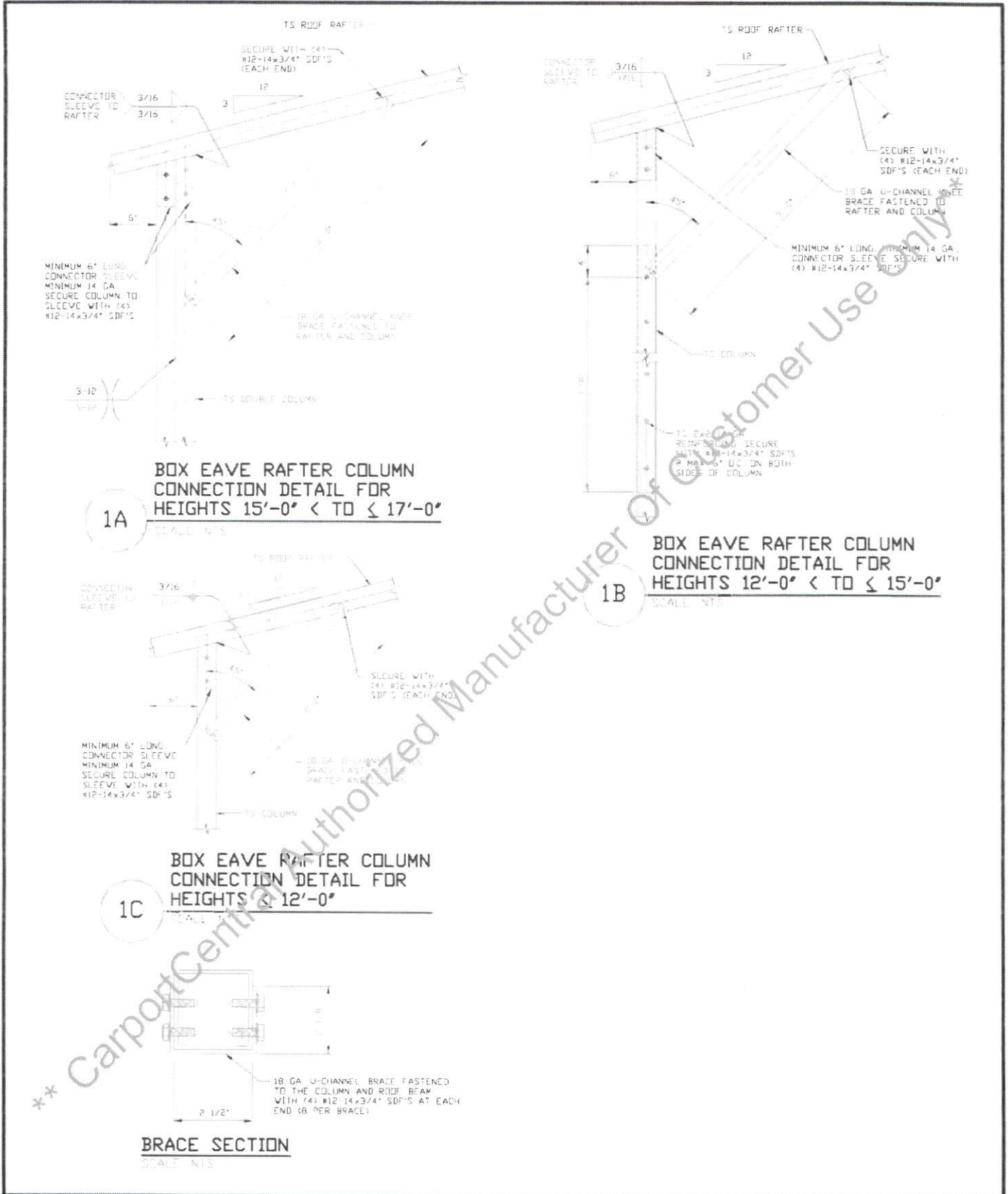

MOORE AND ASSOCIATES
ENGINEERING AND CONSULTING, INC.

DRAWN BY: LT
CHECKED BY: PDH
PROJECT MGR: WSM
CLIENT: CC

CARPOT CENTRAL, INC.
737 SOUTH MAIN STREET
MOUNT AIRY, NC 27030
24'-0" x 17'-0" ENCLOSED STRUCTURE
DATE: 8-9-19
SCALE: NTS
JOB NO: 1910SS
SHT. 6
DWG. NO: SK-3
REV: 0

THIS DOCUMENT IS THE PROPERTY OF MOORE AND ASSOCIATES ENGINEERING AND CONSULTING, INC. UNAUTHORIZED REPRODUCTION, COPYING, OR OTHERWISE USE OF THIS DOCUMENT IS STRICTLY PROHIBITED AND ANY INFRINGEMENT THEREUPON MAY BE SUBJECT TO LEGAL ACTION.

20'-0" < W ≤ 24'-0" SPAN

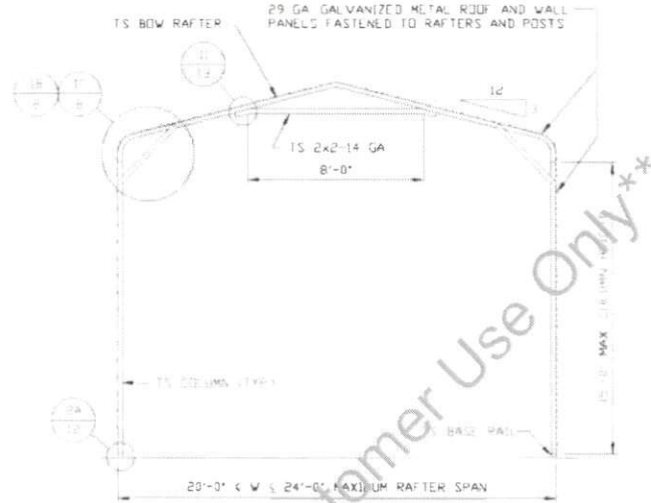
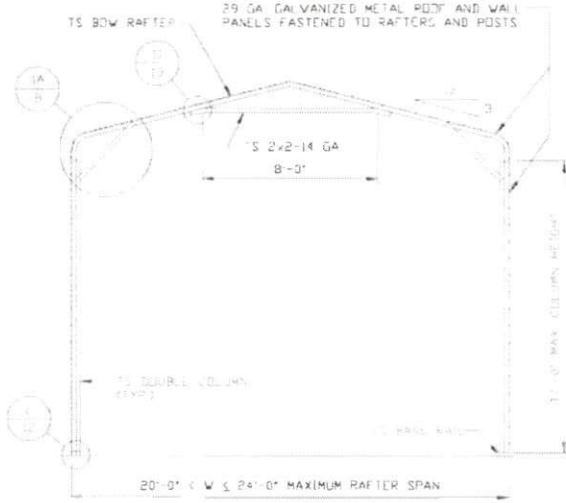

TYPICAL RAFTER/COLUMN END FRAME SECTION
SCALE: NTS

TYPICAL RAFTER/COLUMN END FRAME SECTION
SCALE: NTS

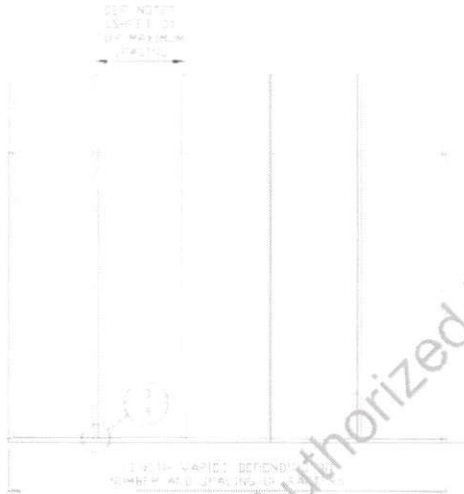

TYPICAL RAFTER/COLUMN FRAMING SIDE SECTION
SCALE: NTS

**** CarportCentral Authorized Manufacturer Of Customer Use Only****

**MOORE AND ASSOCIATES
ENGINEERING AND CONSULTING, INC.**

DRAWN BY: LT

CHECKED BY: PDH

PROJECT MGR: WSM

CLIENT: CC

CARPOT CENTRAL, INC.
737 SOUTH MAIN STREET
MOUNT AIRY, NC 27030
24'-0" x 17'-0" ENCLOSED STRUCTURE

DATE: 8-9-19

SHT. 7

SCALE: NTS

DWG. NO: SK-3

JOB NO: 191055

REV: 0

THIS DOCUMENT IS THE PROPERTY OF MOORE AND ASSOCIATES ENGINEERING AND CONSULTING. THE UNAUTHORIZED REPRODUCTION, COPYING, OR OTHERWISE USE OF THIS DOCUMENT IS STRICTLY PROHIBITED AND ANY INFRACTION THEREUPON MAY BE SUBJECT TO LEGAL ACTION.

18'-0" < W ≤ 20'-0" SPAN

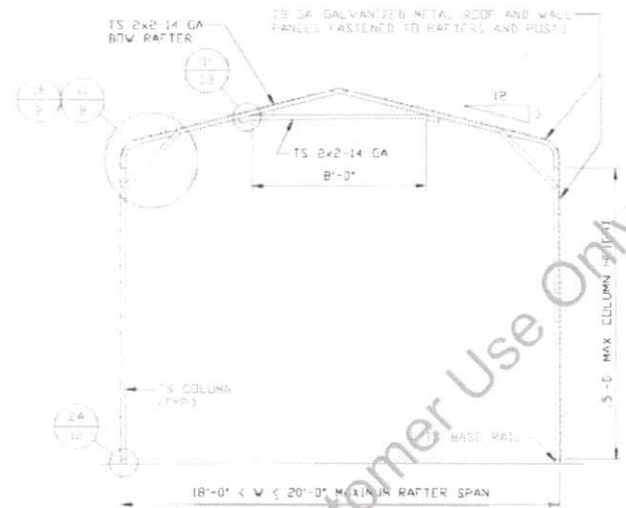
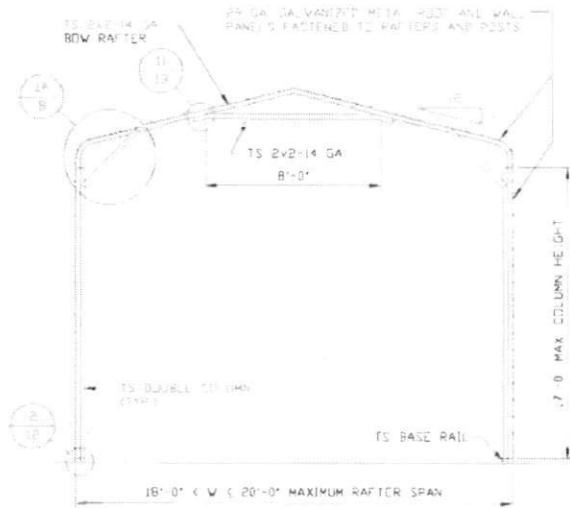

TYPICAL RAFTER/COLUMN END FRAME SECTION
SCALE: NTS

TYPICAL RAFTER/COLUMN END FRAME SECTION
SCALE: NTS

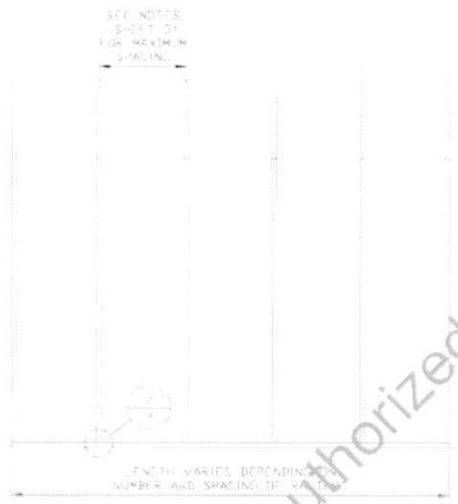

TYPICAL RAFTER/COLUMN FRAMING SIDE SECTION
SCALE: NTS

** CarportCentral Authorized Manufacturer Of Customer Use Only **

MOORE AND ASSOCIATES ENGINEERING AND CONSULTING, INC.	DRAWN BY: LT	CARPORT CENTRAL, INC. 737 SOUTH MAIN STREET MOUNT AIRY, NC 27030 24'-0" x 17'-0" ENCLOSED STRUCTURE		
	CHECKED BY: PDH	PROJECT MGR: VSM	DATE: 8-9-19	SCALE: NTS
THIS DOCUMENT IS THE PROPERTY OF MOORE AND ASSOCIATES ENGINEERING AND CONSULTING, INC. UNAUTHORIZED REPRODUCTION, COPYING, OR OTHERWISE USE OF THIS DOCUMENT IS STRICTLY PROHIBITED AND ANY INFRACTION THEREUPON MAY BE SUBJECT TO LEGAL ACTION.	CLIENT: CC	SHT. 7A	DWG. NO: SK-3	JOB NO: 19105S REV: 0

12'-0" < W ≤ 18'-0" SPAN

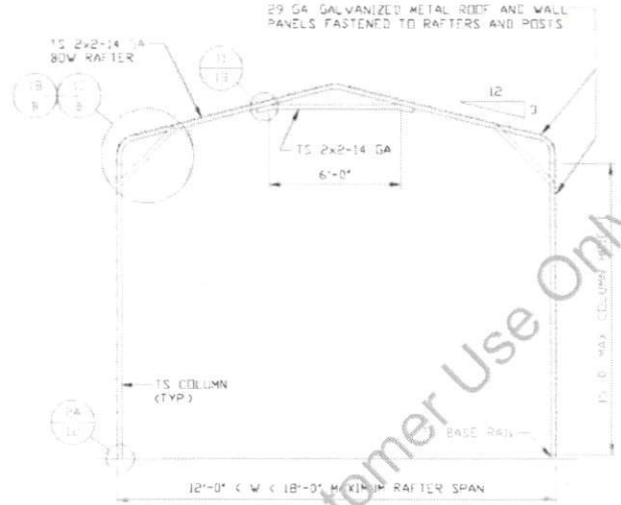
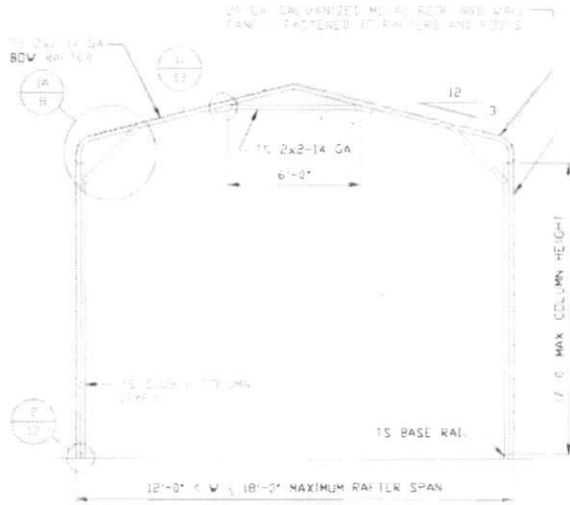

TYPICAL RAFTER/COLUMN END FRAME SECTION

SCALE: NTS

NOTE

OPTIONAL 18GA U CHANNEL PEAK BRACE CAN BE UTILIZED IN LIEU OF TUBE STEEL

TYPICAL RAFTER/COLUMN END FRAME SECTION

SCALE: NTS

NOTE

OPTIONAL 18GA U CHANNEL PEAK BRACE CAN BE UTILIZED IN LIEU OF TUBE STEEL



TYPICAL RAFTER/COLUMN FRAMING SIDE SECTION

SCALE: NTS

*** CarportCentral Authorized Manufacturer Of Customer Use Only***

MOORE AND ASSOCIATES
ENGINEERING AND CONSULTING, INC.

DRAWN BY: LT

CHECKED BY: PDH

PROJECT MGR: VSM

CLIENT: CC

CARPORT CENTRAL, INC
737 SOUTH MAIN STREET
MOUNT AIRY, NC 27030
24'-0" x 17'-0" ENCLOSED STRUCTURE

DATE: 8-9-19

SHT. 7B

SCALE: NTS

DWG. NO: SK-3

JOB NO: 191055

REV: 0

THIS DOCUMENT IS THE PROPERTY OF MOORE AND ASSOCIATES ENGINEERING AND CONSULTING. THE UNAUTHORIZED REPRODUCTION, COPYING, OR OTHERWISE USE OF THIS DOCUMENT IS STRICTLY PROHIBITED AND ANY INFRACTION THEREUPON MAY BE SUBJECT TO LEGAL ACTION.

W ≤ 12'-0" SPAN

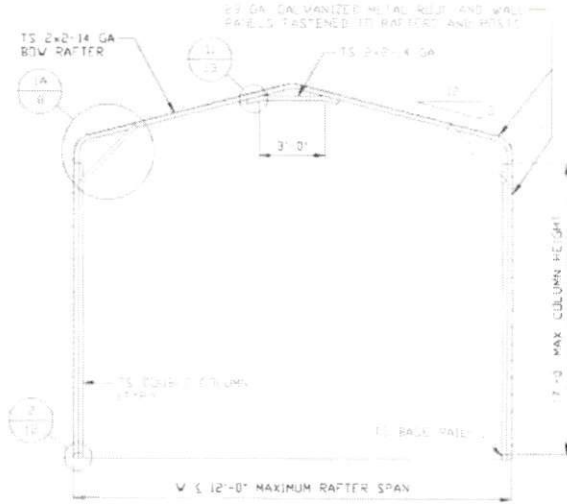

TYPICAL RAFTER/COLUMN END FRAME SECTION

SCALE: NTS

NOTE

OPTIONAL 18GA U CHANNEL PEAK BRACE CAN BE UTILIZED IN LIEU OF TUBE STEEL

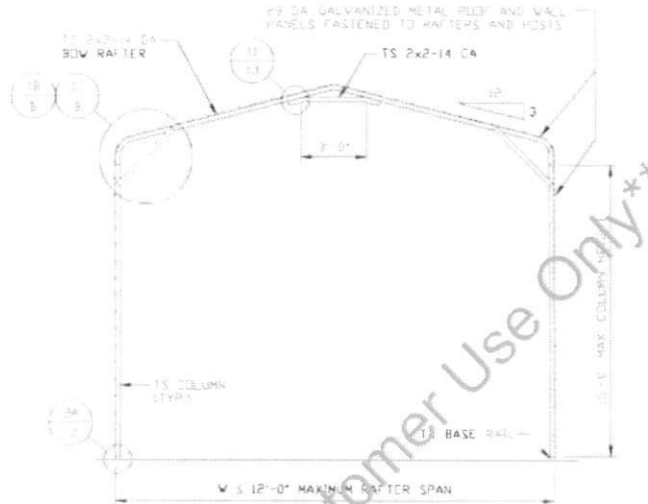

TYPICAL RAFTER/COLUMN END FRAME SECTION

SCALE: NTS

NOTE

OPTIONAL 18GA U CHANNEL PEAK BRACE CAN BE UTILIZED IN LIEU OF TUBE STEEL

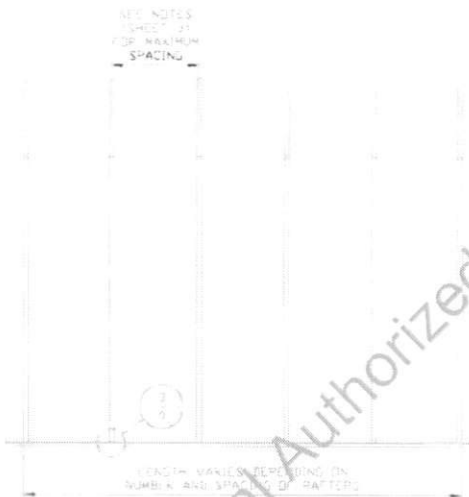

TYPICAL RAFTER/COLUMN FRAMING SIDE SECTION

SCALE: NTS

**MOORE AND ASSOCIATES
ENGINEERING AND CONSULTING, INC.**

DRAWN BY: LT

CHECKED BY: PDH

PROJECT MGR: VSM

CLIENT: CC

CARPOT CENTRAL, INC
737 SOUTH MAIN STREET
MOUNT AIRY, NC 27030
24'-0" x 17'-0" ENCLOSED STRUCTURE

DATE: 8-9-19

SHT. 7C

SCALE: NTS

DWG. NO: SK-3

JOB NO: 1910SS

REV: 0

THIS DOCUMENT IS THE PROPERTY OF MOORE AND ASSOCIATES ENGINEERING AND CONSULTING. THE UNAUTHORIZED REPRODUCTION, COPYING, OR OTHERWISE USE OF THIS DOCUMENT IS STRICTLY PROHIBITED AND ANY INFRINGEMENT THEREUPON MAY BE SUBJECT TO LEGAL ACTION.

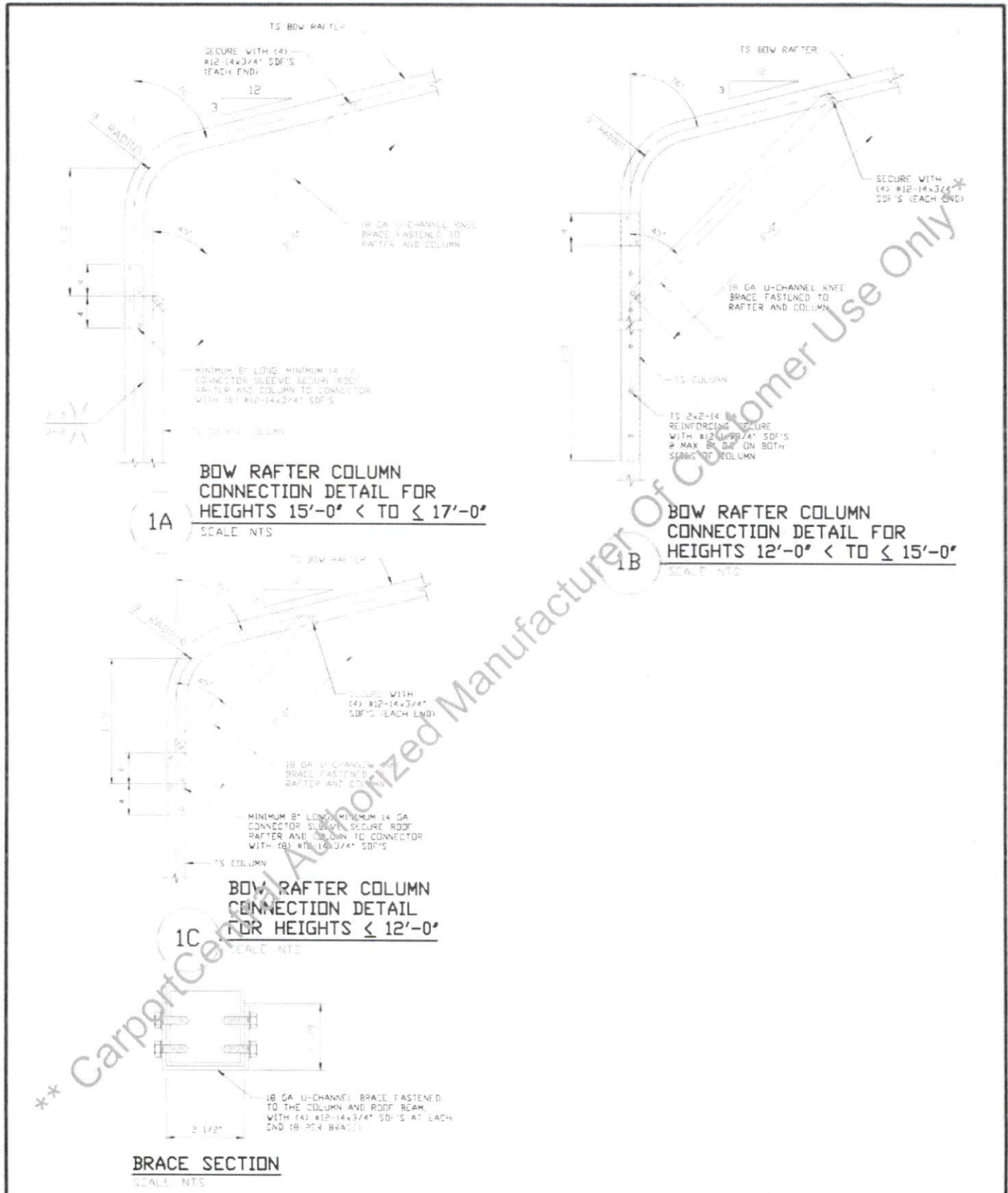

MOORE AND ASSOCIATES
ENGINEERING AND CONSULTING, INC.

DRAWN BY: LT
CHECKED BY: PDH

CARPORT CENTRAL, INC
737 SOUTH MAIN STREET
MOUNT AIRY, NC 27030
24'-0"x17'-0" ENCLOSED STRUCTURE

THIS DOCUMENT IS THE PROPERTY OF MOORE AND ASSOCIATES ENGINEERING AND CONSULTING, INC. CONSULTING THE UNAUTHORIZED REPRODUCTION, COPYING, OR OTHERWISE USE OF THIS DOCUMENT IS STRICTLY PROHIBITED AND ANY INFRINGEMENT THEREUPON MAY BE SUBJECT TO LEGAL ACTION.

PROJECT MGR: WSH	DATE: 8-9-19	SCALE: NTS	JOB NO: 191055
CLIENT: CC	SHT. 8	DWG. NO: SK-3	REV: 0

BASE RAIL ANCHORAGE OPTIONS

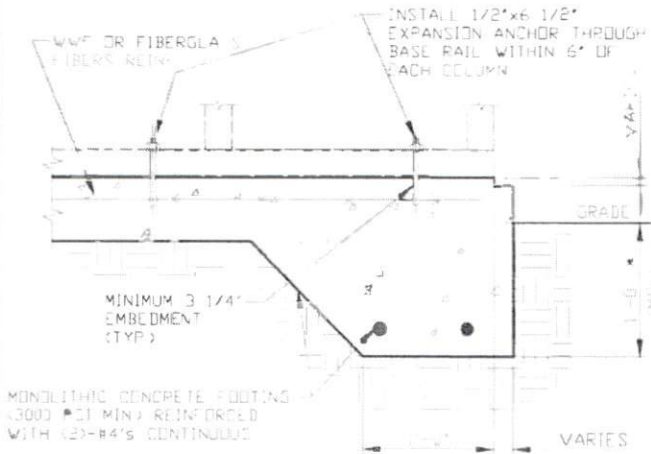

3A CONCRETE MONOLITHIC SLAB BASE RAIL ANCHORAGE
SCALE: NTS
MINIMUM ANCHOR EDGE DISTANCE IS 4"
* COORDINATE WITH LOCAL CODES/ORD.

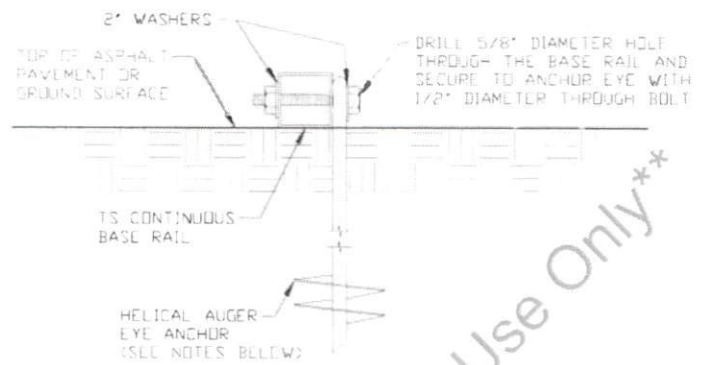

3B HELICAL AUGER ANCHORAGE
SCALE: NTS (CAN BE USED FOR ASPHALT)

GENERAL NOTES

NOTE: CONCRETE MONOLITHIC SLAB DESIGN BASED ON MINIMUM SOIL BEARING CAPACITY OF 1,500 PSF.

CONCRETE:

CONCRETE SHALL HAVE A MINIMUM SPECIFIED COMPRESSIVE STRENGTH OF 3,000 PSI AT 28 DAYS.

COVER OVER REINFORCING STEEL:

FOR FOUNDATIONS, MINIMUM CONCRETE COVER OVER REINFORCING BARS SHALL BE PER ACI-318.

3" IN FOUNDATIONS WHERE THE CONCRETE IS CAST AGAINST AND PERMANENTLY IN CONTACT WITH THE EARTH OR EXPOSED TO THE EARTH OR WEATHER, AND 1 1/2" ELSEWHERE.

REINFORCING STEEL:

THE TURNDOWN REINFORCING STEEL SHALL BE ASTM A615 GRADE 60. THE SLAB REINFORCEMENT SHALL BE WELDED WIRE FABRIC MEETING ASTM A185 OR FIBERGLASS FIBER REINFORCEMENT.

REINFORCEMENT MAY BE BENT IN THE SHOP OR THE FIELD PROVIDED:

1. REINFORCEMENT TO BE BENT COLD.
2. THE DIAMETER OF THE BEND, MEASURED ON THE INSIDE OF THE BAR, IS NOT LESS THAN SIX-BAR DIAMETERS.
3. REINFORCEMENT PARTIALLY EMBEDDED IN CONCRETE SHALL NOT BE FIELD BENT.

HELICAL AUGER ANCHOR NOTES:

1. FOR VERY DENSE AND/OR COMPACTED SANDS, COARSE GRAVEL AND COBBLES, CALICHE, PRELOADED SILTS AND CLAYS, USE MINIMUM (2) 4" HELICES WITH MINIMUM 30' EMBEDMENT OR SINGLE 6" HELIX WITH MINIMUM 50' EMBEDMENT.
2. FOR CORAL USE MINIMUM (2) 4" HELICES WITH MINIMUM 30' EMBEDMENT OR SINGLE 6" HELIX WITH MINIMUM 50' EMBEDMENT.
3. FOR MEDIUM DENSE COARSE SANDS, SANDY GRAVELS, VERY STIFF SILTS AND CLAYS USE MINIMUM (2) 4" HELICES WITH MINIMUM 30' EMBEDMENT OR SINGLE 6" HELIX WITH MINIMUM 50' EMBEDMENT.
4. FOR LOOSE TO MEDIUM DENSE SANDS, FIRM TO STIFF CLAYS AND SILTS, ALLUVIAL FILL, USE MINIMUM (2) 6" HELICES WITH MINIMUM 50' EMBEDMENT.
- * 5. FOR VERY LOOSE TO MEDIUM DENSE SANDS, FIRM TO STIFFER CLAYS AND SILTS, ALLUVIAL FILL, USE MINIMUM (2) 8" HELICES WITH MINIMUM 50' EMBEDMENT.

**MOORE AND ASSOCIATES
ENGINEERING AND CONSULTING, INC.**

DRAWN BY: LT

CHECKED BY: PDH

PROJECT MGR: WSM

CLIENT: CC

CARPORT CENTRAL, INC.
737 SOUTH MAIN STREET
MOUNT AIRY, NC 27030
24'-0" x 17'-0" ENCLOSED STRUCTURE

DATE: 8-9-19

SHT. 9

SCALE: NTS

DWG. NO: SK-3

JOB NO: 191055

REV: 0

THIS DOCUMENT IS THE PROPERTY OF MOORE AND ASSOCIATES ENGINEERING AND CONSULTING. THE UNAUTHORIZED REPRODUCTION, COPYING, OR OTHERWISE USE OF THIS DOCUMENT IS STRICTLY PROHIBITED AND ANY INFRACTION THEREUPON MAY BE SUBJECT TO LEGAL ACTION.

BASE RAIL ANCHORAGE OPTIONS

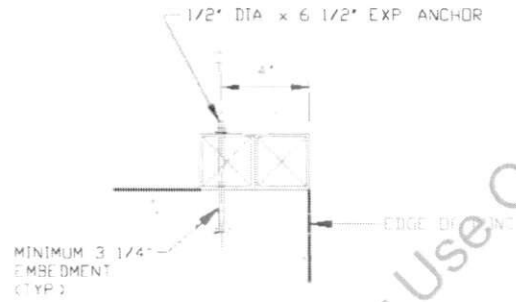
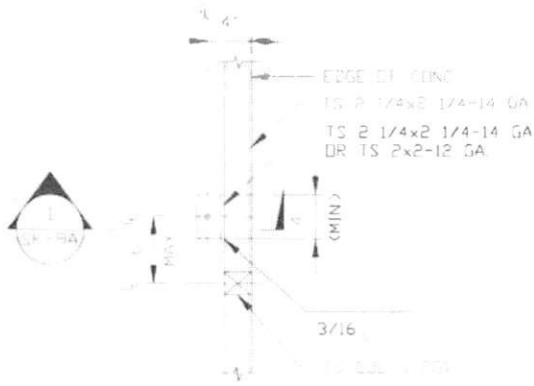

SECTION 1
SCALE: NTS
SK-3A

TYPICAL ANCHOR DETAIL WHEN BASE RAIL IS NEAR EDGE OF CONCRETE

SCALE: NTS

*** CarportCentral Authorized Manufacturer Of Customer Use Only***

MOORE AND ASSOCIATES
ENGINEERING AND CONSULTING, INC.

DRAWN BY: LT

CHECKED BY: PDH

PROJECT MGR: WSH

CLIENT: CC

CARPORT CENTRAL, INC
737 SOUTH MAIN STREET
MOUNT AIRY, NC 27030
24'-0" x 17'-0" ENCLOSED STRUCTURE

DATE: 8-9-19

SHT. 9A

SCALE: NTS

DWG. NO: SK-3

JOB NO: 191096

REV: 0

THIS DOCUMENT IS THE PROPERTY OF MOORE AND ASSOCIATES ENGINEERING AND CONSULTING. THE UNAUTHORIZED REPRODUCTION, COPYING, OR OTHERWISE USE OF THIS DOCUMENT IS STRICTLY PROHIBITED AND ANY INFRINGEMENT THEREUPON MAY BE SUBJECT TO LEGAL ACTION.

BOX EAVE RAFTER END WALL AND SIDE WALL OPENINGS

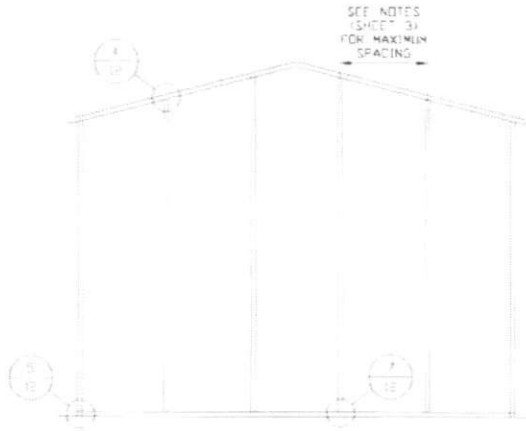

**TYPICAL BOX EAVE RAFTER
END WALL FRAMING SECTION**

SCALE: NTS

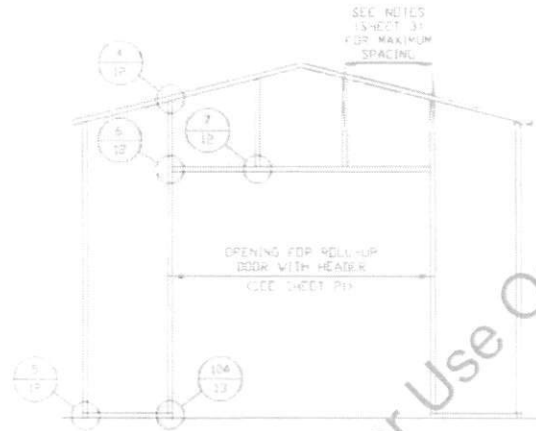

**TYPICAL BOX EAVE RAFTER END
WALL OPENINGS FRAMING SECTION**

SCALE: NTS

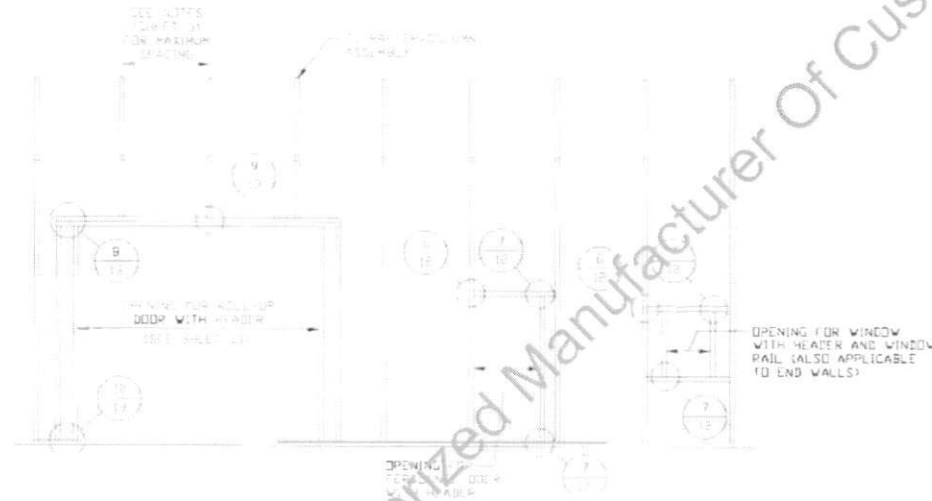

**TYPICAL BOX EAVE RAFTER
SIDE WALL OPENINGS FRAMING SECTION**

SCALE: NTS

**** CarportCentral Authorized Manufacturer Of Customer Use Only****

**MOORE AND ASSOCIATES
ENGINEERING AND CONSULTING, INC.**

DRAWN BY: LT

CHECKED BY: PDH

PROJECT MGR: VSM

CLIENT: CC

CARPOT CENTRAL, INC.
737 SOUTH MAIN STREET
MOUNT AIRY, NC 27030
24'-0" x 17'-0" ENCLOSED STRUCTURE

DATE: 8-9-19

SHT. 10

SCALE: NTS

DWG. NO: SK-3

JOB NO: 191055

REV: 0

THIS DOCUMENT IS THE PROPERTY OF MOORE AND ASSOCIATES ENGINEERING AND CONSULTING, INC. UNAUTHORIZED REPRODUCTION, COPYING, OR OTHERWISE USE OF THIS DOCUMENT IS STRICTLY PROHIBITED AND ANY INFRACTION THEREOF MAY BE SUBJECT TO LEGAL ACTION.

BOW RAFTER END WALL AND SIDE WALL OPENINGS

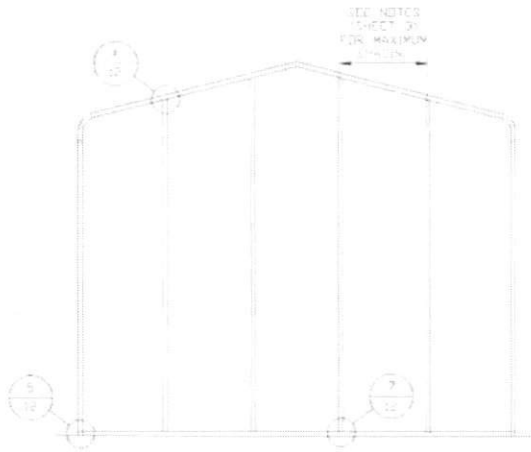

**TYPICAL BOW RAFTER
END WALL FRAMING SECTION**

SCALE: NTS

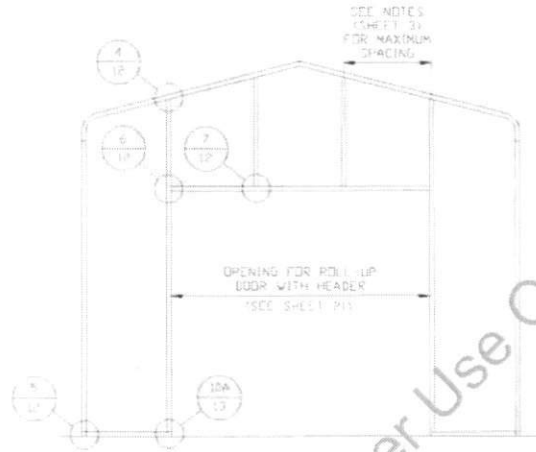

**TYPICAL BOW RAFTER END
WALL OPENINGS FRAMING SECTION**

SCALE: NTS

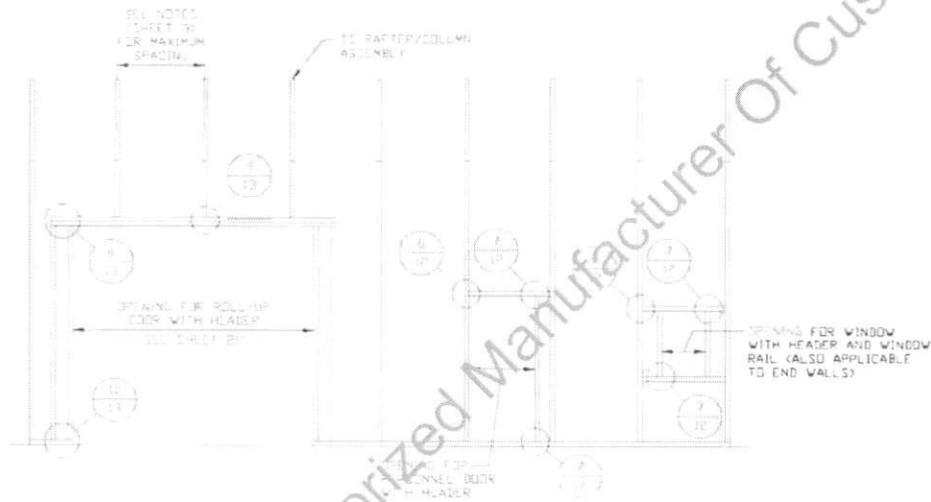

**TYPICAL BOW RAFTER SIDE
WALL OPENINGS FRAMING SECTION**

SCALE: NTS

*** CarportCentral Authorized Manufacturer Of Customer Use Only***

**MOORE AND ASSOCIATES
ENGINEERING AND CONSULTING, INC.**

DRAWN BY: LT

CHECKED BY: PDH

PROJECT MGR: WSM

CLIENT: CC

CARPOT CENTRAL, INC.
737 SOUTH MAIN STREET
MOUNT AIRY, NC 27030
24'-0" x 17'-0" ENCLOSED STRUCTURE

DATE: 8-9-19

SHT. 11

SCALE: NTS

DWG. NO: SK-3

JOB NO: 191055

REV: 0

THIS DOCUMENT IS THE PROPERTY OF MOORE AND ASSOCIATES ENGINEERING AND CONSULTING, INC. UNAUTHORIZED REPRODUCTION, COPYING, OR OTHERWISE USE OF THIS DOCUMENT IS STRICTLY PROHIBITED AND ANY INFRACTION THEREUPON MAY BE SUBJECT TO LEGAL ACTION.

CONNECTION DETAILS



2
**RAFTER COLUMN/
BASE RAIL
CONNECTION DETAIL**
SCALE: NTS

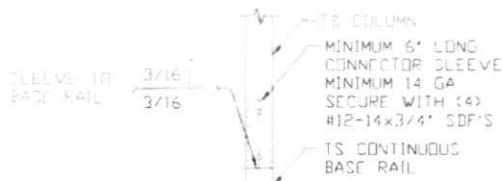

2A
**RAFTER COLUMN/
BASE RAIL
CONNECTION DETAIL**
SCALE: NTS

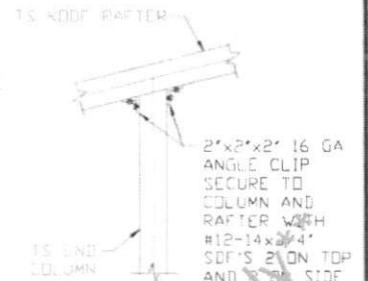

4
**END COLUMN/RAFTER
CONNECTION DETAIL**
SCALE: NTS

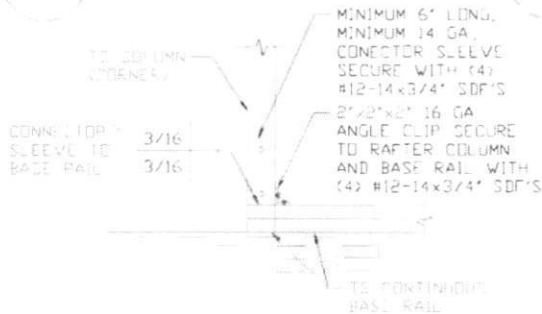

5
**END COLUMN/BASE RAIL
CONNECTION DETAIL**
SCALE: NTS

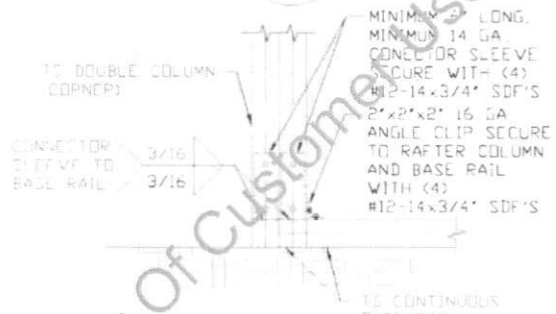

5A
**END COLUMN/BASE RAIL
CONNECTION DETAIL**
SCALE: NTS

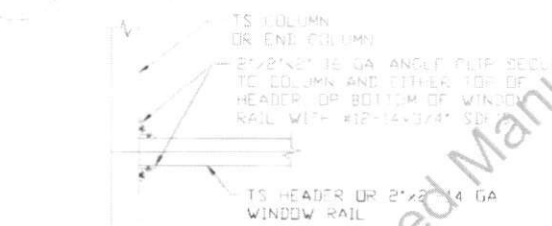

6
**COLUMN OR WINDOW
RAIL TO POST
CONNECTION DETAIL**
SCALE: NTS

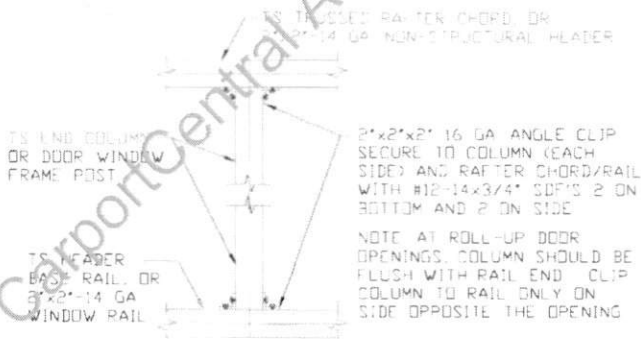

7
**COLUMN TO HEADER, BASE RAIL, OR
WINDOW RAIL CONNECTION DETAIL**
SCALE: NTS

**MOORE AND ASSOCIATES
ENGINEERING AND CONSULTING, INC.**

DRAWN BY: LT

CHECKED BY: PDH

PROJECT MGR: WSH

CLIENT: CC

CARPOT CENTRAL, INC
737 SOUTH MAIN STREET
MOUNT AIRY, NC 27030

24'-0" x 17'-0" ENCLOSED STRUCTURE

DATE: 8-9-19

SHT. 12

SCALE: NTS

DWG. NO: SK-3

JOB NO: 191055

REV: 0

THIS DOCUMENT IS THE PROPERTY OF MOORE AND ASSOCIATES ENGINEERING AND CONSULTING. THE UNAUTHORIZED REPRODUCTION, COPYING, OR OTHERWISE USE OF THIS DOCUMENT IS STRICTLY PROHIBITED AND ANY INFRACTION THEREUPON MAY BE SUBJECT TO LEGAL ACTION.

CONNECTION DETAILS

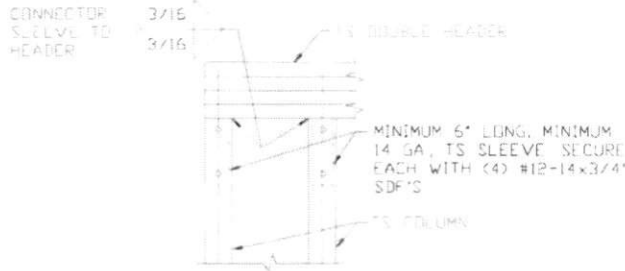

8 DOUBLE HEADER/COLUMN CONNECTION DETAIL

SCALE: NTS

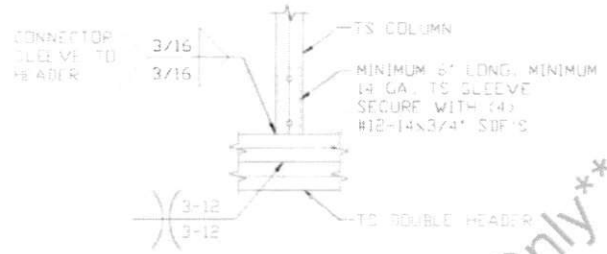

9 COLUMN/DOUBLE HEADER CONNECTION DETAIL

SCALE: NTS

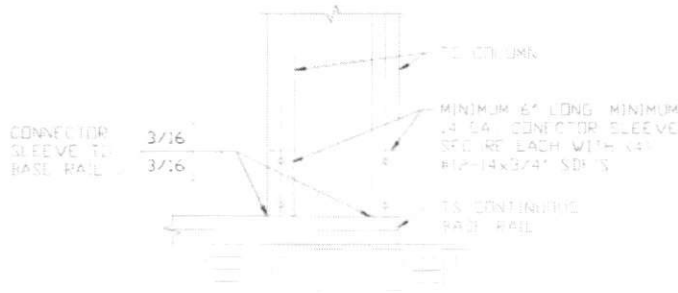

10 COLUMN/BASE RAIL CONNECTION DETAIL

SCALE: NTS

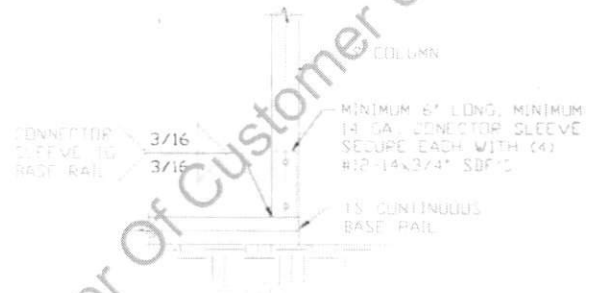

10A COLUMN/BASE RAIL CONNECTION DETAIL

SCALE: NTS

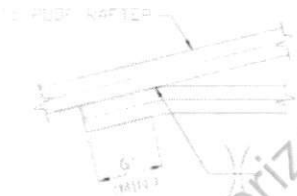

11 COLLAR TIE CONNECTION DETAIL

SCALE: NTS

**MOORE AND ASSOCIATES
ENGINEERING AND CONSULTING, INC.**

DRAWN BY: LT

CHECKED BY: PDH

PROJECT MGR: WSM

CLIENT: CC

**CARPOT CENTRAL, INC
737 SOUTH MAIN STREET
MOUNT AIRY, NC 27030**

24'-0" x 17'-0" ENCLOSED STRUCTURE

DATE: 8-9-19

SHT. 13

SCALE: NTS

DWG. NO: SK-3

JOB NO: 191055

REV: 0

THIS DOCUMENT IS THE PROPERTY OF MOORE AND ASSOCIATES ENGINEERING AND CONSULTING. THE UNAUTHORIZED REPRODUCTION, COPYING, OR OTHERWISE USE OF THIS DOCUMENT IS STRICTLY PROHIBITED AND ANY INFRINGEMENT THEREUPON MAY BE SUBJECT TO LEGAL ACTION.

*** CarportCentral Authorized Manufacturer Of Customer Use Only***

BOX EAVE RAFTER LEAN-TO OPTIONS

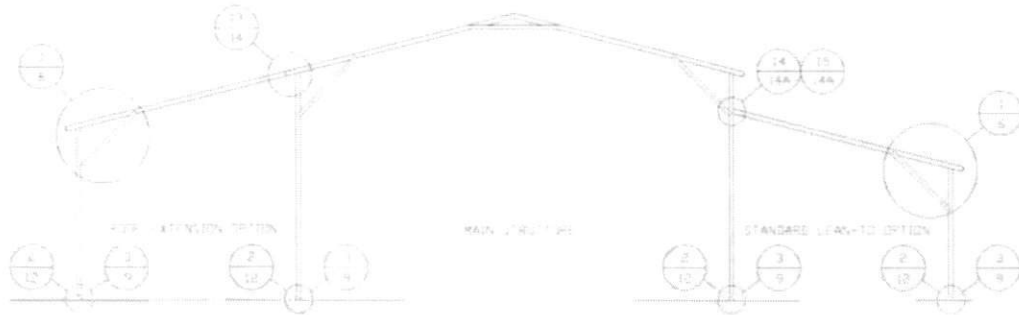

TYPICAL BOX EAVE RAFTER LEAN-TO OPTIONS FRAMING SECTION (BOTH OPTIONS SHOWN)

SCALE: NTS

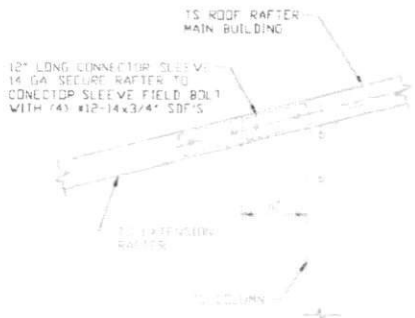

**13 SIDE EXTENSION RAFTER/COLUMN
DETAIL FOR SPAN $\le 10'-0''$**

SCALE: NTS

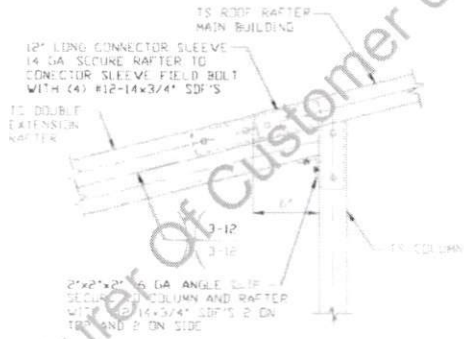

**13A SIDE EXTENSION RAFTER/COLUMN
DETAIL FOR SPAN $10'-0'' < L \le 16'-0''$**

SCALE: NTS

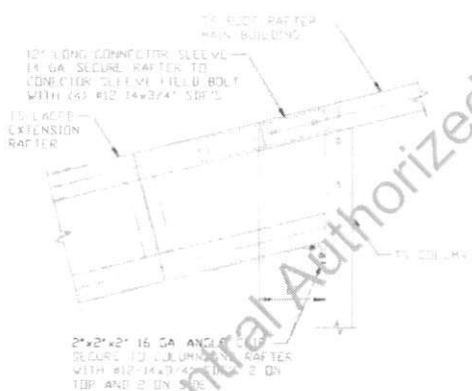

**13B SIDE EXTENSION RAFTER/COLUMN
DETAIL FOR SPAN $16'-0'' < L \le 25'-0''$**

SCALE: NTS

**** Carport Central Authorized Manufacturer of Customer Use Only ****

MOORE AND ASSOCIATES ENGINEERING AND CONSULTING, INC.	DRAWN BY: LT	CARPORT CENTRAL, INC 737 SOUTH MAIN STREET MOUNT AIRY, NC 27030 24'-0" x 17'-0" ENCLOSED STRUCTURE		
	CHECKED BY: PDH	PROJECT MGR: VSM	DATE: 8-9-19	SCALE: NTS
THIS DOCUMENT IS THE PROPERTY OF MOORE AND ASSOCIATES ENGINEERING AND CONSULTING. THE UNAUTHORIZED REPRODUCTION, COPYING, OR OTHERWISE USE OF THIS DOCUMENT IS STRICTLY PROHIBITED AND ANY INFRACTION THEREUPON MAY BE SUBJECT TO LEGAL ACTION.	CLIENT: CC	SHT. 14	DWG. NO: SK-3	JOB NO: 191055 REV: 0

LEAN-TO OPTIONS

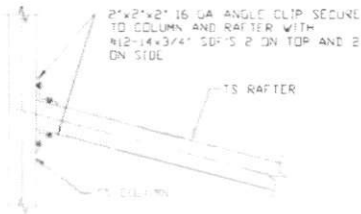

LEAN-TO RAFTER TO RAFTER COLUMN CONNECTION DETAIL FOR SPAN $\le 10'-0''$

14

SCALE: NTS

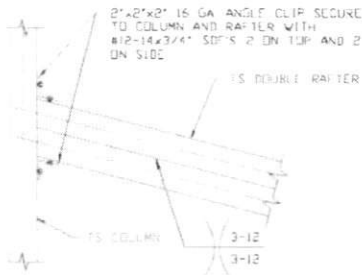

LEAN-TO RAFTER TO RAFTER COLUMN CONNECTION DETAIL FOR SPAN $10'-0'' < L \le 16'-0''$

14A

SCALE: NTS

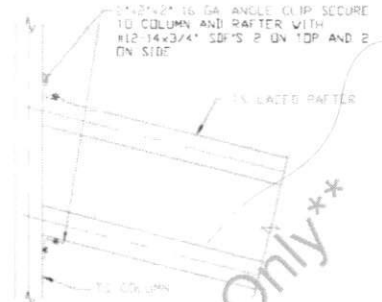

LEAN-TO RAFTER TO RAFTER COLUMN CONNECTION DETAIL FOR SPAN $16'-0'' < L \le 25'-0''$

14B

SCALE: NTS

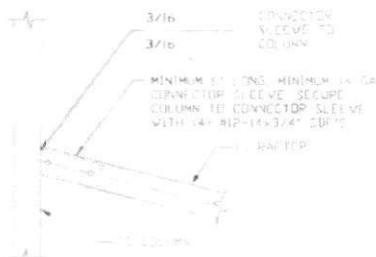

LEAN-TO RAFTER TO RAFTER COLUMN CONNECTION DETAIL FOR SPAN $\le 10'-0''$

15

SCALE: NTS



LEAN-TO RAFTER TO RAFTER COLUMN CONNECTION DETAIL FOR SPAN $10'-0'' < L \le 16'-0''$

15A

SCALE: NTS



LEAN-TO RAFTER TO RAFTER COLUMN CONNECTION DETAIL FOR SPAN $16'-0'' < L \le 25'-0''$

*15B

SCALE: NTS

MOORE AND ASSOCIATES
ENGINEERING AND CONSULTING, INC.

DRAWN BY: LT

CHECKED BY: PDH

PROJECT MGR: VSM

CLIENT: CC

CARPORT CENTRAL, INC.
737 SOUTH MAIN STREET
MOUNT AIRY, NC 27030
24'-0\"/>

DATE: 8-9-19

SHT. 14A

SCALE: NTS

DWG. NO: SK-3

JOB NO: 1910SS

REV: 0

THIS DOCUMENT IS THE PROPERTY OF MOORE AND ASSOCIATES ENGINEERING AND CONSULTING. THE UNAUTHORIZED REPRODUCTION, COPYING, OR OTHERWISE USE OF THIS DOCUMENT IS STRICTLY PROHIBITED AND ANY INFRINGEMENT THEREUPON MAY BE SUBJECT TO LEGAL ACTION.

BOW RAFTER LEAN-TO OPTION

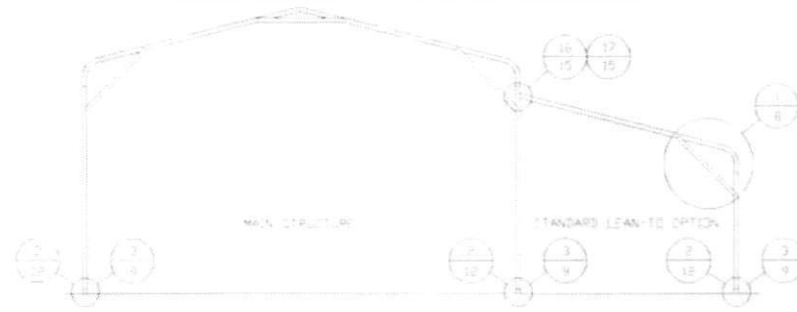

TYPICAL BOW RAFTER LEAN-TO OPTION FRAMING SECTION

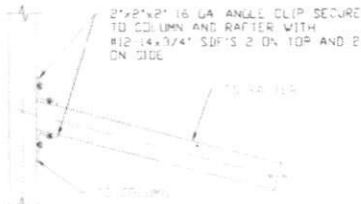

LEAN-TO RAFTER TO RAFTER COLUMN CONNECTION DETAIL FOR SPAN $\leq 10'-0"$

16



LEAN-TO RAFTER TO RAFTER COLUMN CONNECTION DETAIL FOR SPAN $10'-0" < L \leq 16'-0"$

16A

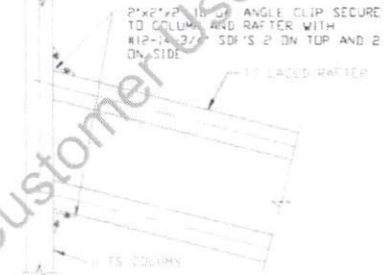

LEAN-TO RAFTER TO RAFTER COLUMN CONNECTION DETAIL FOR SPAN $16'-0" < L \leq 25'-0"$

16B

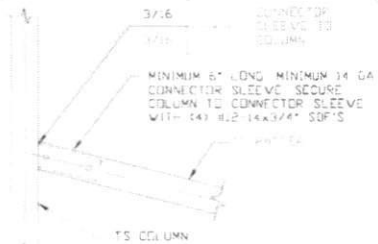

LEAN-TO RAFTER TO RAFTER COLUMN CONNECTION DETAIL FOR SPAN $\leq 10'-0"$

17



LEAN-TO RAFTER TO RAFTER COLUMN CONNECTION DETAIL FOR SPAN $10'-0" < L \leq 16'-0"$

17A



LEAN-TO RAFTER TO RAFTER COLUMN CONNECTION DETAIL FOR SPAN $16'-0" < L \leq 25'-0"$

17B

MOORE AND ASSOCIATES
ENGINEERING AND CONSULTING, INC.

DRAWN BY: LT

CHECKED BY: PDH

PROJECT MGR: WSM

CLIENT: CC

CARPORT CENTRAL, INC
737 SOUTH MAIN STREET
MOUNT AIRY, NC 27030
24'-0" x 17'-0" ENCLOSED STRUCTURE

DATE: 8-9-19

SHT. 15

SCALE: NTS

DWG. NO: SK-3

JOB NO: 1910SS

REV: 0

THIS DOCUMENT IS THE PROPERTY OF MOORE AND ASSOCIATES ENGINEERING AND CONSULTING. THE UNAUTHORIZED REPRODUCTION, COPYING, OR OTHERWISE USE OF THIS DOCUMENT IS STRICTLY PROHIBITED AND ANY INFINGEMENT THEREUPON MAY BE SUBJECT TO LEGAL ACTION.

BOX EAVE RAFTER VERTICAL ROOF OPTION

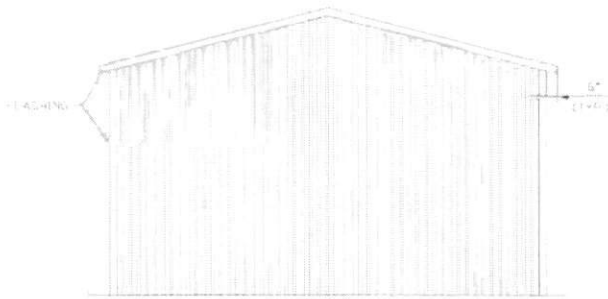

**TYPICAL END ELEVATION
VERTICAL ROOF**

SCALE: NTS

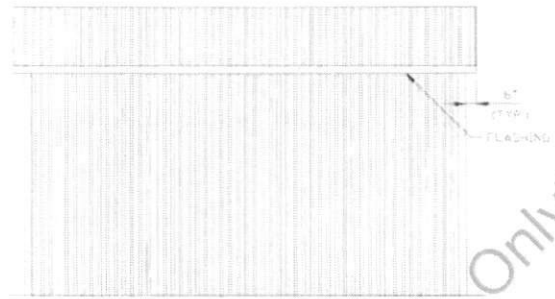

**TYPICAL SIDE ELEVATION
VERTICAL ROOF**

SCALE: NTS

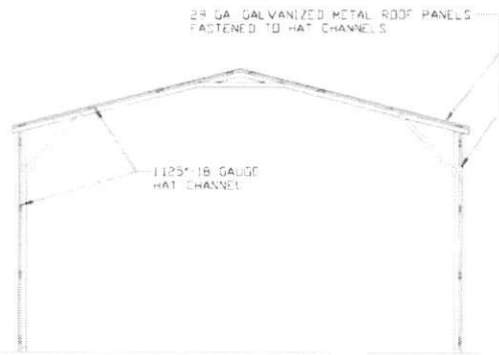

**TYPICAL SECTION
VERTICAL ROOF OPTION**

SCALE: NTS



**TYPICAL FRAMING SECTION
VERTICAL ROOF OPTION**

SCALE: NTS

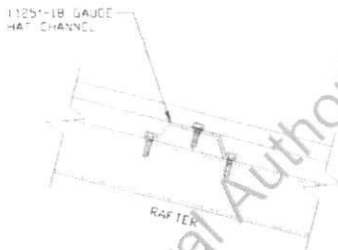

PANEL ATTACHMENT

ALTERED FOR VERTICAL ROOF PANELS
SCALE: NTS

**** CarportCentral Authorized Manufacturer of Customer Use Only ****

MOORE AND ASSOCIATES
ENGINEERING AND CONSULTING, INC.

DRAWN BY: LT

CHECKED BY: PDH

PROJECT MGR: WSM

CLIENT: CC

CARPORT CENTRAL, INC.
737 SOUTH MAIN STREET
MOUNT AIRY, NC 27030
24'-0" x 17'-0" ENCLOSED STRUCTURE

DATE: 8-9-19

SHT. 16

SCALE: NTS

DWG. NO: SK-3

JOB NO: 1910SS

REV: 0

THIS DOCUMENT IS THE PROPERTY OF MOORE AND ASSOCIATES ENGINEERING AND CONSULTING. THE UNAUTHORIZED REPRODUCTION, COPYING, OR OTHERWISE USE OF THIS DOCUMENT IS STRICTLY PROHIBITED AND ANY INFRACTION THEREUPON MAY BE SUBJECT TO LEGAL ACTION.

OPTIONAL BASE RAIL ON GRADE APPLICATION

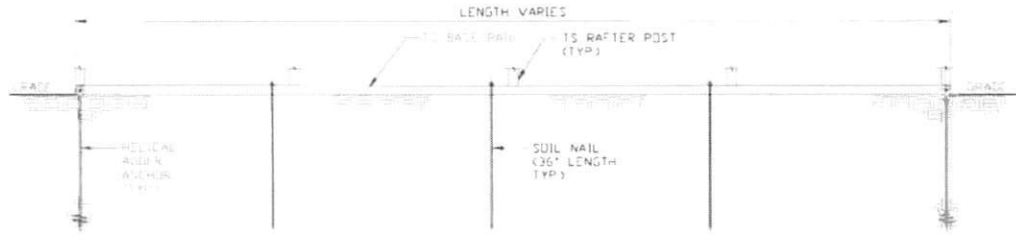

SECTION 1
SCALE: NTS



SECTION 2
SCALE: NTS

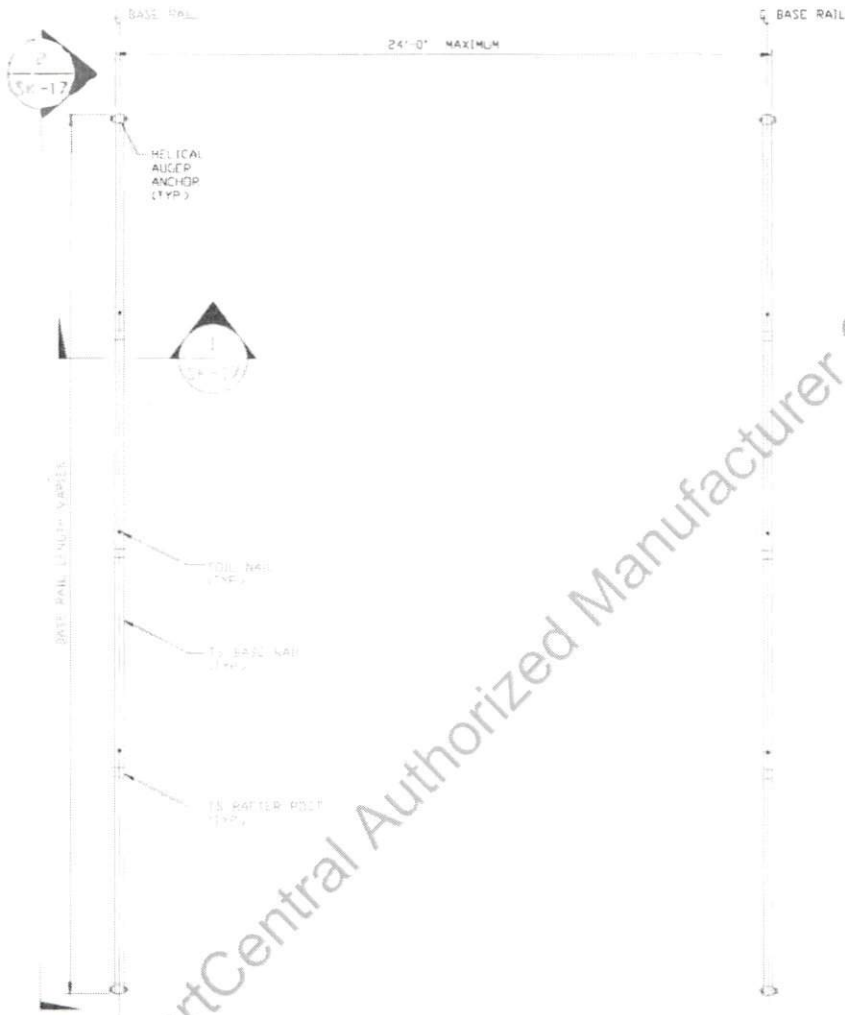

BASE RAIL PLAN
SCALE: NTS

HELIX ANCHOR	
SIDE LENGTH	SPACING
20'-0"	20'-0"
25'-0"	25'-0"
30'-0"	15'-0"

**MOORE AND ASSOCIATES
ENGINEERING AND CONSULTING, INC.**

DRAWN BY: LT

CHECKED BY: PDH

PROJECT MGR: WSM

CLIENT: CC

CARPORT CENTRAL, INC.
737 SOUTH MAIN STREET
MOUNT AIRY, NC 27030
24'-0" x 17'-0" ENCLOSED STRUCTURE

DATE: 8-9-19

SHT. 17

SCALE: NTS

DWG. NO: SK-3

JOB NO: 191096

REV: 0

THIS DOCUMENT IS THE PROPERTY OF MOORE AND ASSOCIATES ENGINEERING AND CONSULTING. THE UNAUTHORIZED REPRODUCTION, COPYING, OR OTHERWISE USE OF THIS DOCUMENT IS STRICTLY PROHIBITED AND ANY INFINGEMENT THEREUPON MAY BE SUBJECT TO LEGAL ACTION.

OPTIONAL BASE RAIL ON TIMBER BEAM

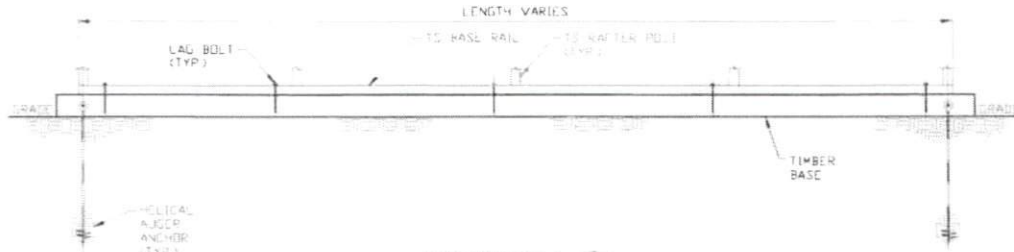

SECTION 1
SCALE: NTS 1/4" = 1'-0"

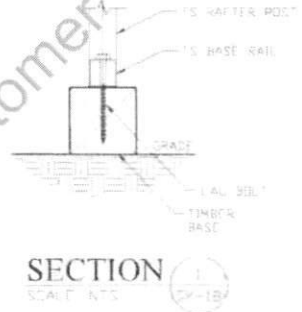
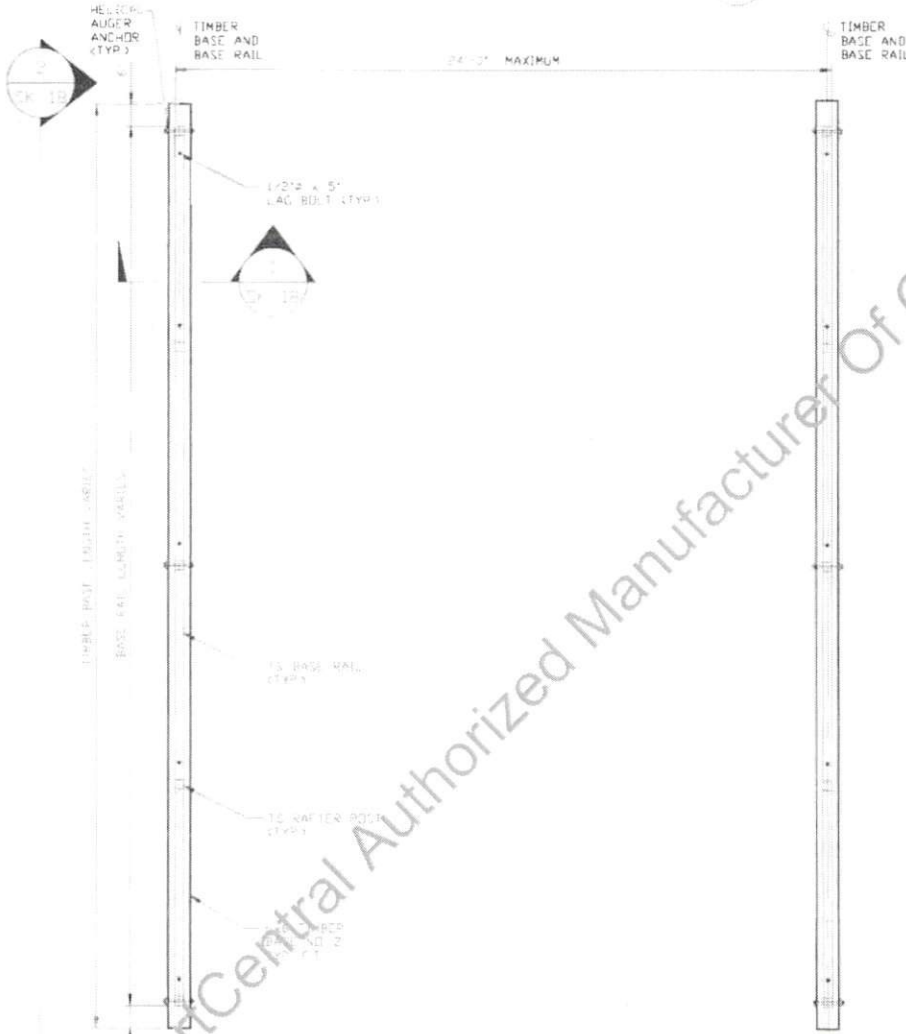

TIMBER FOOTING PLAN
SCALE: NTS

HELIX ANCHOR	
SIDE LENGTH	SPACING
20'-0"	12'-0"
25'-0"	12'-6"
30'-0"	15'-0"

NOTES
1. INSTALLATION OF SOIL NAILS OR EXPANSION ANCHORS ALSO APPLY TO END WALLS.

MOORE AND ASSOCIATES
ENGINEERING AND CONSULTING, INC.

DRAWN BY: LT

CHECKED BY: PDH

CARPOT CENTRAL, INC.
737 SOUTH MAIN STREET
MOUNT AIRY, NC 27030
24'-0" x 17'-0" ENCLOSED STRUCTURE

THIS DOCUMENT IS THE PROPERTY OF MOORE AND ASSOCIATES ENGINEERING AND CONSULTING. THE UNAUTHORIZED REPRODUCTION, COPYING, OR OTHERWISE USE OF THIS DOCUMENT IS STRICTLY PROHIBITED AND ANY INFRACTION THEREUPON MAY BE SUBJECT TO LEGAL ACTION.

PROJECT MGR: VSM

CLIENT: CC

DATE: 8-9-19

SHT. 1B

SCALE: NTS

DWG. NO: SK-3

JOB NO: 19105S

REV: 0

OPTIONAL BASE RAIL ON TIMBER BEAM WITH SOIL NAIL

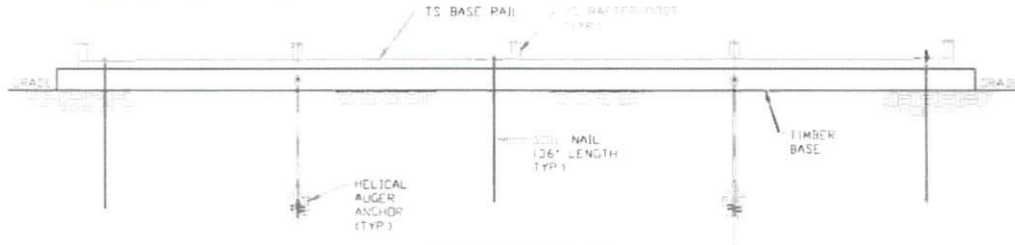

SECTION 2
SCALE: NTS
SK-19

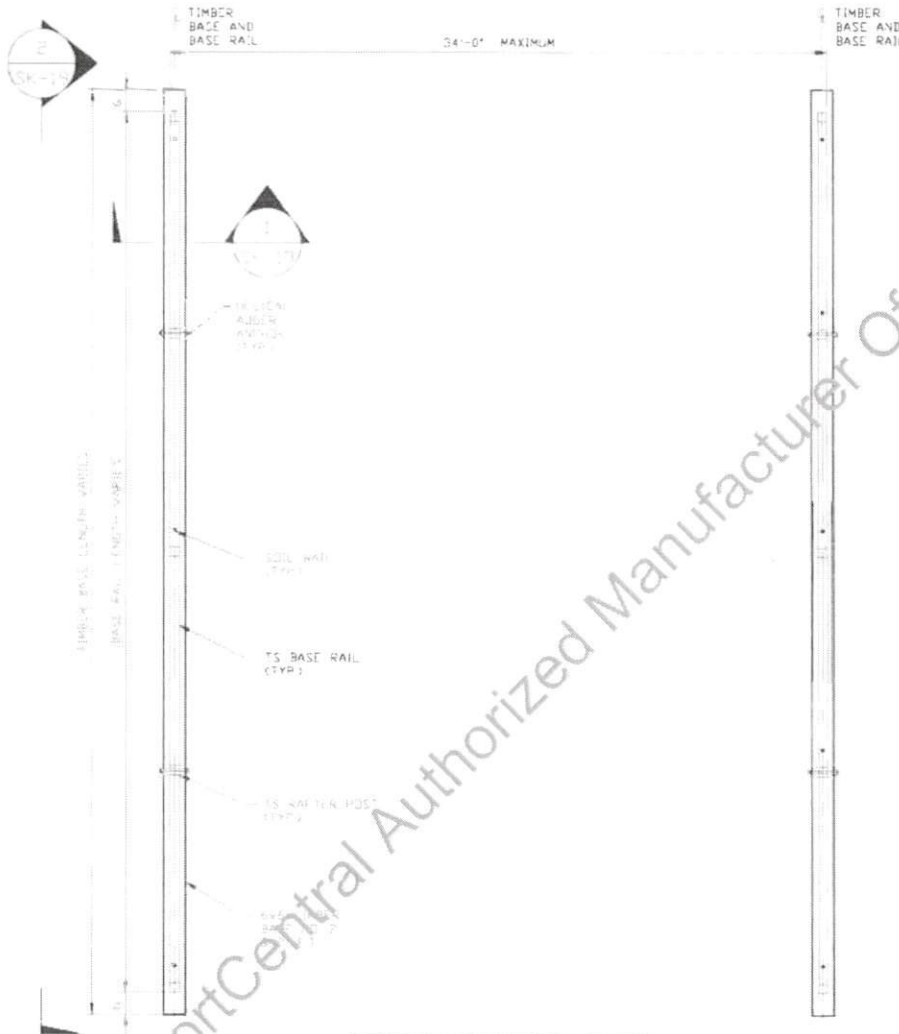

SECTION 1
SCALE: NTS
SK-19

TIMBER FOOTING PLAN
SCALE: NTS

HELIX ANCHOR	
** SIDE LENGTH	SPACING
20'-0"	20'-0"
25'-0"	25'-0"
30'-0"	15'-0"

NOTES
1. INSTALLATION OF SOIL NAILS OR EXPANSION ANCHORS ALSO APPLY TO END WALLS.

MOORE AND ASSOCIATES
ENGINEERING AND CONSULTING, INC.

DRAWN BY: LT

CHECKED BY: PDH

PROJECT MGR: VSM

CLIENT: CC

CARPORT CENTRAL, INC
737 SOUTH MAIN STREET
MOUNT AIRY, NC 27030
24'-0" x 17'-0" ENCLOSED STRUCTURE

DATE: 8-9-19

SHT. 19

SCALE: NTS

DWG. NO: SK-3

JOB NO: 1910SS

REV: 0

THIS DOCUMENT IS THE PROPERTY OF MOORE AND ASSOCIATES ENGINEERING AND CONSULTING. THE UNAUTHORIZED REPRODUCTION, COPYING, OR OTHERWISE USE OF THIS DOCUMENT IS STRICTLY PROHIBITED AND ANY INFREEMENT THEREUPON MAY BE SUBJECT TO LEGAL ACTION.

OPTIONAL CONCRETE STRIP FOOTING

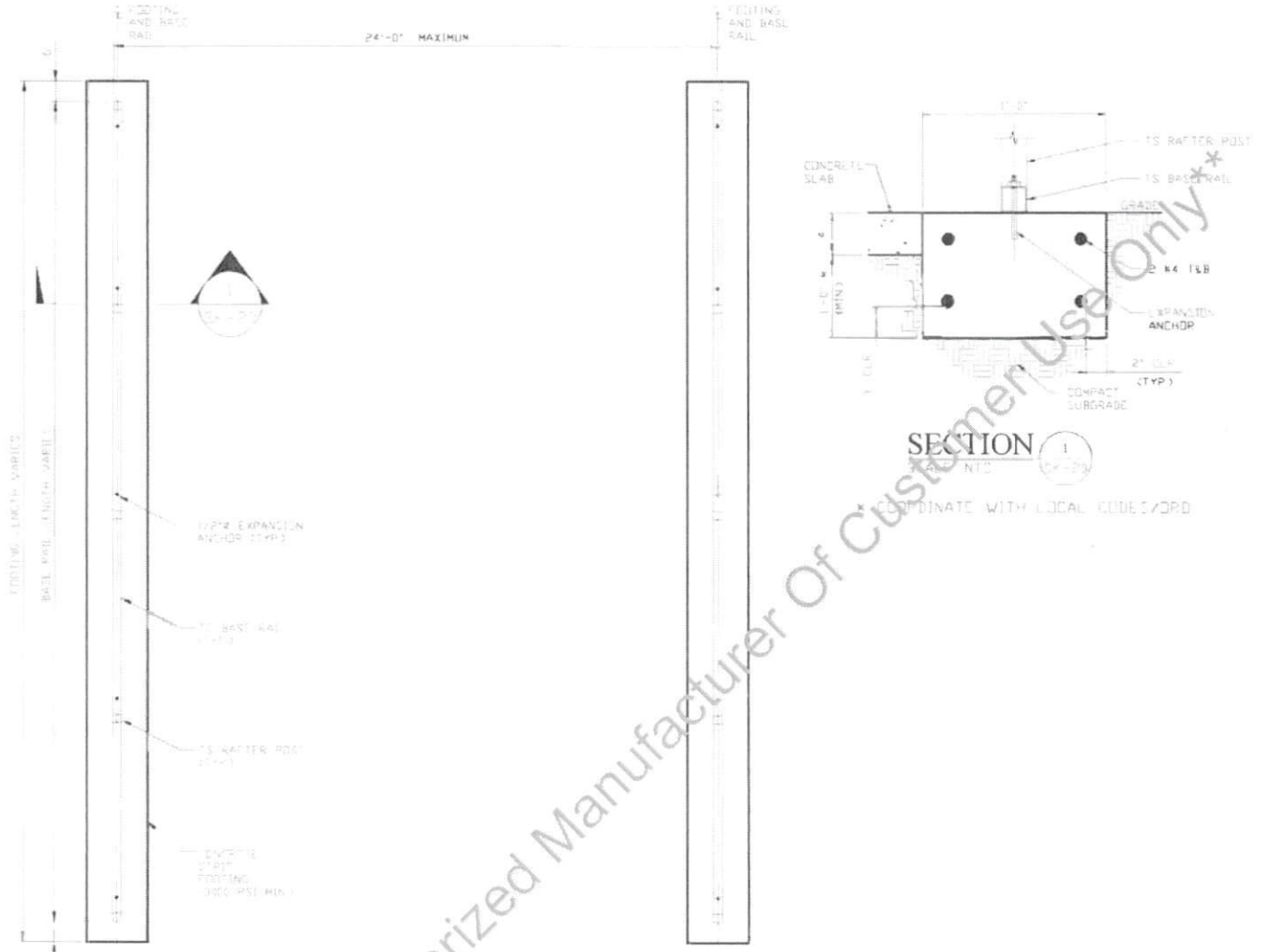

CONCRETE STRIP FOOTING PLAN
SCALE: NTS

SECTION 1
SCALE: NTS

COORDINATE WITH LOCAL CODES/ORD

*** CarportCentral Authorized Manufacturer Of Customer Use Only ***

MOORE AND ASSOCIATES ENGINEERING AND CONSULTING, INC.	DRAWN BY: LT	CARPORT CENTRAL, INC. 737 SOUTH MAIN STREET MOUNT AIRY, NC 27030 24'-0" x 17'-0" ENCLOSED STRUCTURE		
	CHECKED BY: PDH	PROJECT MGR: WSM	DATE: 8-9-19	SCALE: NTS
THIS DOCUMENT IS THE PROPERTY OF MOORE AND ASSOCIATES ENGINEERING AND CONSULTING. THE UNAUTHORIZED REPRODUCTION, COPYING, OR OTHERWISE USE OF THIS DOCUMENT IS STRICTLY PROHIBITED AND ANY INFRINGEMENT THEREUPON MAY BE SUBJECT TO LEGAL ACTION.	CLIENT: CC	SHT. 20	DWG. NO: SK-3	JOB NO: 191055 REV: 0

OPTIONAL HEADER

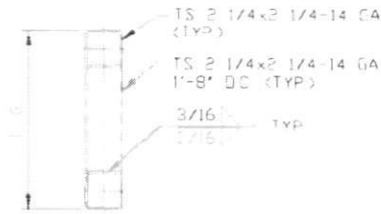

HEADER DETAIL FOR SIDE WALL DOOR
OPENINGS 11'-0" < LENGTH ≤ 20'-0"
SCALE: NTS

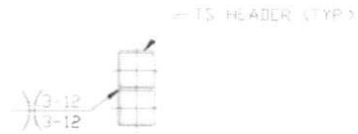

HEADER DETAIL FOR END WALL DOOR
OPENINGS 12'-0" < LENGTH ≤ 20'-0"
SCALE: NTS

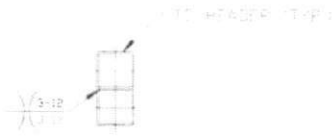

HEADER DETAIL FOR SIDE WALL DOOR
OPENINGS 6'-0" < LENGTH ≤ 11'-0"
SCALE: NTS



HEADER DETAIL FOR END WALL DOOR
OPENINGS ≤ 12'-0"
SCALE: NTS



HEADER DETAIL FOR SIDE WALL DOOR
OPENINGS ≤ 6'-0"
SCALE: NTS

** CarportCentral Authorized Manufacturer of Customer Use Only**

MOORE AND ASSOCIATES
ENGINEERING AND CONSULTING, INC.

DRAWN BY: LT

CHECKED BY: PDH

PROJECT MGR: WSH

CLIENT: CC

CARPOT CENTRAL, INC.
737 SOUTH MAIN STREET
MOUNT AIRY, NC 27030

24'-0" x 17'-0" ENCLOSED STRUCTURE

DATE: 8-9-19

SHT. 21

SCALE: NTS

DWG. NO: SK-3

JOB NO: 191055

REV: 0

THIS DOCUMENT IS THE PROPERTY OF MOORE AND ASSOCIATES ENGINEERING AND CONSULTING. THE UNAUTHORIZED REPRODUCTION, COPYING, OR OTHERWISE USE OF THIS DOCUMENT IS STRICTLY PROHIBITED AND ANY INFRACTION THEREUPON MAY BE SUBJECT TO LEGAL ACTION.