

**SOIL/SITE EVALUATION
 for ON-SITE WASTEWATER SYSTEM**

Owner: *Gropper* Applicant:
 Address: *50 McKay Tower Rd* Date Evaluated: *08-31-21*
 Proposed Facility: *SFD* Design Flow (.1949):
 Location of Site: Property Recorded: Property Size:
 Water Supply: Public Individual Well Spring Other
 Evaluation Method: Auger Boring Pit Cut
 Type of Wastewater: Sewage Industrial Process Mixed

P R O F I L E #	.1940 Landscape Position/ Slope %	Horizon Depth (In.)	SOIL MORPHOLOGY .1941		OTHER PROFILE FACTORS				Profile Class & LTAR
			.1941 Structure/ Texture	.1941 Consistence Mineralogy	.1942 Soil Witness/ Color	.1943 Soil Depth (IN.)	.1956 Sapro Class	.1944 Restr Horiz	
<i>1, 2 3, 4</i>	<i>L</i>	<i>0-8</i>	<i>LS(A) Gr</i>	<i>Fr/w/np/nd</i>	<i>>48"</i>	<i>>48"</i>	<i>-</i>	<i>-</i>	<i>S. 6</i>
	<i>5-7 1/2</i>	<i>8-32</i>	<i>L1 Gr</i>	<i>Fr/w/np/nd</i>					<i>Group II</i>
		<i>32-48</i>	<i>SL Gr</i>	<i>Fr/w/np/nd</i>					
<i>5</i>	<i>Bury pit Area</i>								
	<i>6-18" in ground was digging up branches w/green pine needles</i>								

Description	Initial System	Repair System	Other Factors (.1946): Site Classification (.1948): <i>S</i> Evaluated By: <i>MHL RCH</i> Others Present:
Available Space (.1945)	<i>✓</i>	<i>✓</i>	
System Type(s)	<i>25% md</i>	<i>25% md</i>	
Site LTAR	<i>-6</i>	<i>-6</i>	

COMMENTS: _____

LANDSCAPE POSITIONS	GROUP	TEXTURES	.1955 LTAR	CONSISTENCE MOIST	WET
R-RIDGE	I	S-SAND	1.2 - 0.8	VFR-VERY FRIABLE	NS-NON-STICKY
S-SHOULDER SLOPE		LS-LOAMY SAND		FR-FRIABLE	SS-SLIGHTLY STICKY
L-LINEAR SLOPE	II	SL-SANDY LOAM	0.8 - 0.6	FI-FIRM	S-STICKY
FS-FOOT SLOPE		L-LOAM		VFI-VERY FIRM	VS-VERY STICKY
N-NOSE SLOPE	III	SI-SILT	0.6 - 0.3	EFI-EXTREMELY FIRM	NP-NON-PLASTIC
H-HEAD SLOPE		SIL-SILT LOAM		SP-SLIGHTLY STICKY	
CC-CONCLAVE SLOPE		CL-CLAY LOAM		P-PLASTIC	
CV-CONVEX SLOPE		SCL-SANDY CLAY LOAM		VP-VERY PLASTIC	
T-TERRACE	IV	SIC-SILTY CLAY	0.4 - 0.1		
FP-FLOOD PLAN		C-CLAY			
		SC-SANDY CLAY			

STRUCTURE

- SG-SINGLE GRAIN
- M- MASSIVE
- CR-CRUMB
- GR-GRANULAR
- SBK-SUBANGULAR BLOCKY
- ABK-ANGULAR BLOCKY
- PL-PLATY
- PR-PRISMATIC

MINERALOGY

- SLIGHTLY EXPANSIVE
- EXPANSIVE

Show profile locations and other site features (dimensions, references or benchmark, and North)

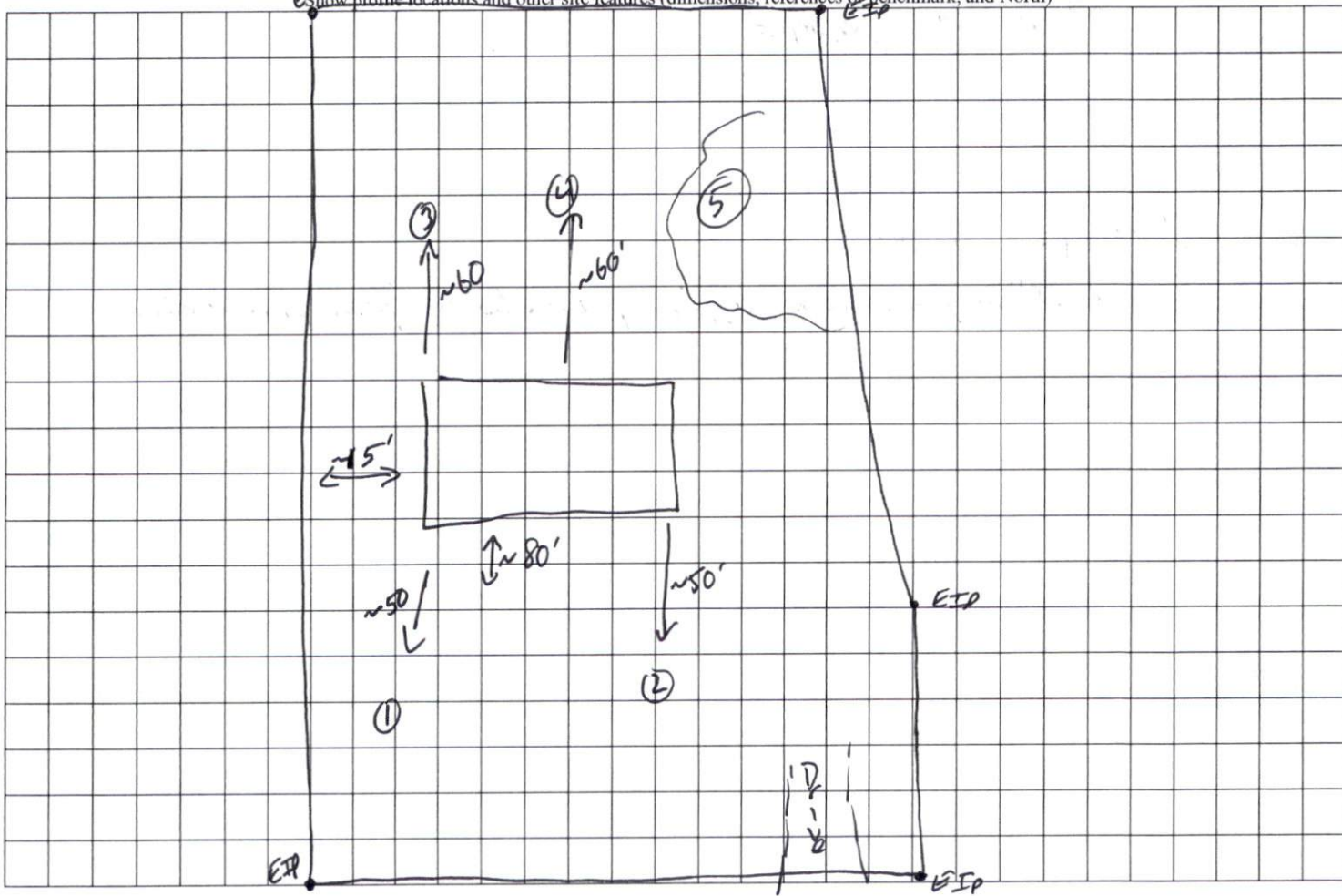

← McHoy town Rd →