

# Harnett County Department of Public Health

PERMIT # Brw 2107-0039

## Operation Permit

New Installation    Septic Tank    Nitrification Line    Repair    Expansion

PROPERTY LOCATION: 31 Georgie Dr (SR 1273)

Name: (owner) Josh Bryant      SUBDIVISION \_\_\_\_\_      LOT # \_\_\_\_\_

System Installer: Larry Sharpe

Basement with plumbing:     Garage     Number of Bedrooms 3

Type of Water Supply:  Community    Public    Well    Distance from well \_\_\_\_\_ feet

System Type: Type III 9      Types V and VI Systems expire in 5 years.

(In accordance with Table V a)      Owner must contact Health Department 6 months prior to expiration for permit renewal.

This system has been installed in compliance with applicable North Carolina General Statutes, Rules for Sewage Treatment and Disposal, and all conditions of the Improvement Permit and Construction Authorization.

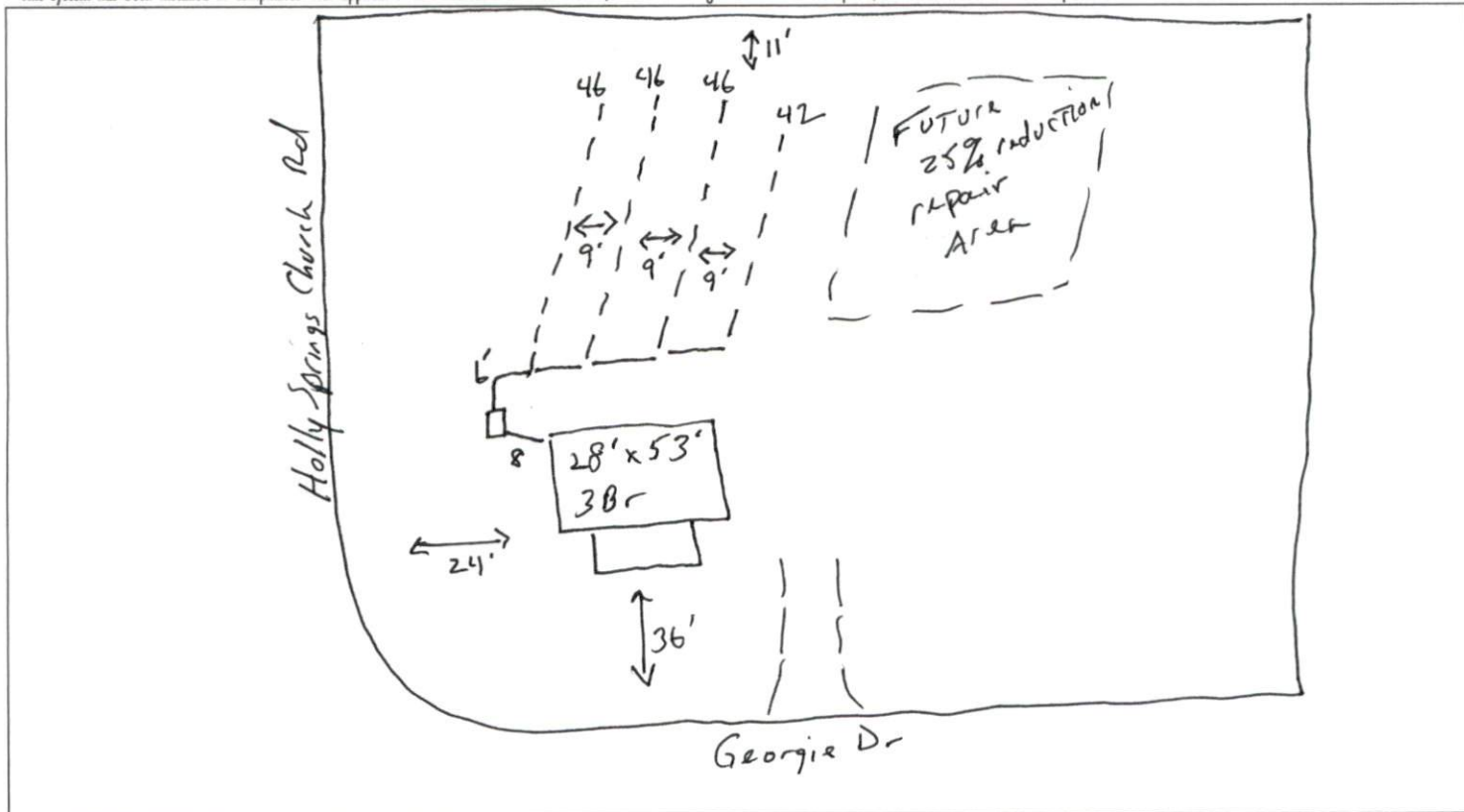

**PERMIT CONDITIONS:**

- I. Performance: System shall perform in accordance with Rule .1961.
- II. Monitoring: As required by Rule .1961.
- III. Maintenance: As required by Rule .1961. Other: \_\_\_\_\_  
 Subsurface system operator required? Yes  No   
 If yes, see attached sheet for additional operation conditions, maintenance and reporting.
- IV. Operation: \_\_\_\_\_
- V. Other: \_\_\_\_\_

\_\_\_\_\_ D-Box    \_\_\_\_\_ Pump    \_\_\_\_\_ Alarm    \_\_\_\_\_ H2O Line    \_\_\_\_\_ PWR Line

Following are the specifications for the sewage disposal system on the above captioned property.

Type of system:  Conventional    Other 25% reduction (EG4)    Septic Tank: 1000 gallons    Pump Tank: \_\_\_\_\_ gallons  
 Subsurface      No. of      exact length      width of      depth of  
 Drainage Field      ditches 1      of each ditch 180 feet      ditches 3 feet      ditches 24 inches  
 French Drain Required: \_\_\_\_\_ Linear feet

Authorized State Agent Malcolm REHS      Date 7-21-22