

App# BRES2107-0039

Harnett County Department of Public Health Improvement Permit

Revised
For ST
Placement
+ Back Deck
LOT #

A building permit cannot be issued with only an Improvement Permit

PROPERTY LOCATION 31 Georgie Dr (SR1273)
SUBDIVISION _____

Site Improvements required prior to Construction Authorization Issuance.

ISSUED TO Josh Bryant

NEW REPAIR EXPANSION

Type of Structure 53' x 28' Modular

Proposed Wastewater System Type 25% reduction

Projected Daily Flow 360 GPD

Number of bedrooms 3 Number of Occupants 6 max

Basement Yes No

Pump Required Yes No May be required based on final location and elevations of facilities

Type of Water Supply Community Public Well Distance from well _____ feet

Permit valid for Five years
 No expiration

Permit conditions: _____

Authorized State Agent Moh A. RCH

Date 7-12-22

SEE ATTACHED SITE SKETCH

The issuance of this permit by the Health Department in no way guarantees the issuance of other permits. The permit holder is responsible for checking with appropriate governing bodies concerning their requirements. This permit is subject to revocation if the site plan, plat or the intended use change. The Improvement Permit shall not be affected by a change in ownership of the site. This permit is subject to compliance with the provisions of the Laws and Rules for Sewage Treatment and Disposal and to conditions of this permit.

Construction Authorization

(Required for Building Permit)

The construction and installation requirements of Rules 1950, 1952, 1954, 1955, 1956, 1957, 1958 and 1959 are incorporated by reference into this permit and shall be met. Systems shall be installed in accordance with the attached system design.

ISSUED TO Josh Bryant

PROPERTY LOCATION 31 Georgie Dr (SR1273)

SUBDIVISION _____ LOT # _____

Facility Type 53' x 28' Modular New Expansion Repair

Basement? Yes No Basement fixtures? Yes No

Type of Wastewater System** 25% reduction (Initial) Wastewater Flow 360 GPD

(See note below, if applicable) 25% reduction (Repair)

Installation Requirements/Conditions Number of trenches 4

Septic Tank Size 1000 gallons Exact length of each trench 45 feet Trench Spacing: 9 Feet on Center

Pump Tank Size _____ gallons Trenches shall be installed on contour at a Maximum Trench Depth of 18" - 24" inches Soil Cover: 6 inches

(Trench bottoms shall be level to $\pm 1/4"$ in all directions) (Maximum soil cover shall not exceed 36" above the trench bottom)

Pump Requirements ft. TDH vs GPM _____ inches below pipe Aggregate Depth _____ inches above pipe _____ inches total

Conditions: _____

WATER LINES (INCLUDING IRRIGATION) MUST BE 10FT. FROM ANY PART OF SEPTIC SYSTEM OR REPAIR AREA
NO UTILITIES ALLOWED IN INITIAL OR REPAIR DRAIN FIELD AREA.

**If applicable, I understand the system type specified is different from the type specified on the application, I accept the specifications of this permit.

Owner/Legal Representative Signature _____

Date _____

The Construction Authorization shall not be issued until all conditions are met. The Construction Authorization shall not be transferred when there is a change in ownership of the site. This Construction Authorization is subject to compliance with the provisions of the Laws, Rules, Regulations and Disposal and to the conditions of this permit. SEE ATTACHED SITE SKETCH

Authorized State Agent Moh A. RCH

Date _____

7-12-22

Construction Authorization Expiration Date _____

7-12-27

Application # BRES2107-0039 *Revised*

Harnett County Department of Public Health Site Sketch

Property Location: 31 Georgie Dr (SR1273)

Issued To: Josh Bryant Subdivision _____ Lot # _____

Authorized State Agent: *M. R. R. R. R.* Date: 7-12-22

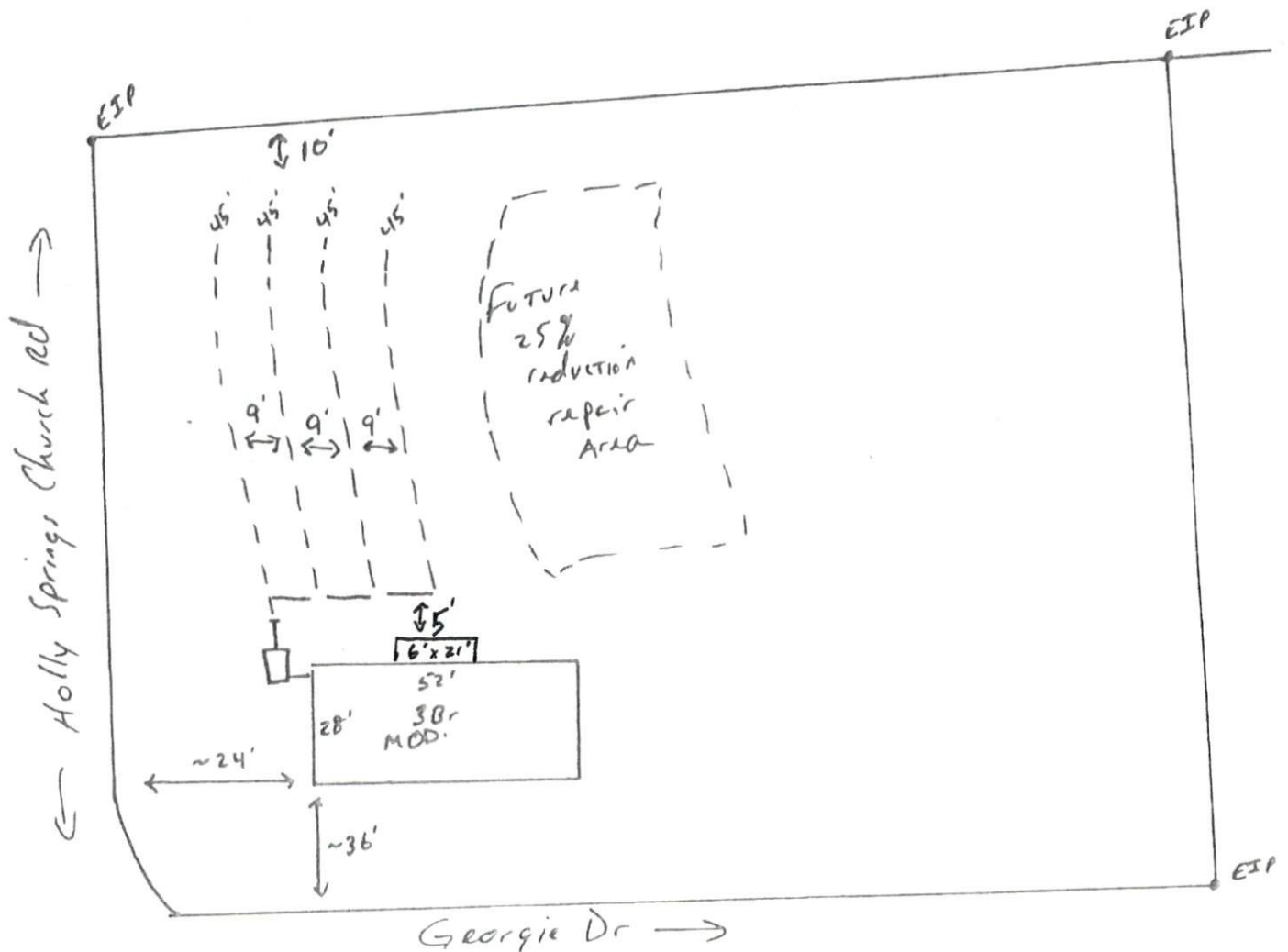

This drawing is for illustrative purposes only. System installation must meet all pertinent laws, rules, and regulations.