

Revised

Harnett County Department of Public Health

Improvement Permit

A building permit cannot be issued with only an Improvement Permit

PROPERTY LOCATION 120 Mickey Rouse (SR2432)

SUBDIVISION _____

LOT # _____

ISSUED TO Lashonda Thomas

NEW REPAIR EXPANSION

Site Improvements required prior to Construction Authorization Issuance

Type of Structure 76' x 44' SFD

Proposed Wastewater System Type 25% reduction

Projected Daily Flow 720 GPD

Number of bedrooms 6 Number of Occupants 12 max

Basement Yes No

Pump Required Yes No May be required based on final location and elevations of facilities

Type of Water Supply Community Public Well Distance from well _____ feet

Permit valid for: five years No expiration

Permit conditions _____

Authorized State Agent: Mohammed RETH

Date: 10-18-22

SEE ATTACHED SITE SKETCH

The issuance of this permit by the Health Department in no way guarantees the issuance of other permits. The permit holder is responsible for checking with appropriate governing bodies if meeting their requirements. This permit is subject to revocation if the site plan, plat, or the intended use changes. The Improvement Permit shall not be affected by a change in ownership of the site. This permit is subject to compliance with the provisions of the Laws and Rules for Sewage Treatment and Disposal and to conditions of the permit.

Construction Authorization

(Required for Building Permit)

The construction and installation requirements of Rules 1950, 1952, 1954, 1955, 1956, 1957, 1958 and 1959 are incorporated by references into this permit and shall be met. Systems shall be installed in accordance with the attached system layout.

ISSUED TO Lashonda Thomas

PROPERTY LOCATION: 120 Mickey Rouse (SR2432)

SUBDIVISION _____

LOT # _____

Facility Type: 76' x 44' SFD New Expansion Repair

Basement? Yes No Basement fixtures? Yes No

Type of Wastewater System** 25% reduction

(Initial) Wastewater flow: 720 GPD

(See note below, if applicable)

25% reduction (Repair)

Installation Requirements/Conditions

Septic Tank Size 1500 gallons

Pump Tank Size _____ gallons

Number of trenches 1

Exact length of each trench 300 feet

Trenches shall be installed on contour at a

Maximum Trench Depth of 22" inches

(Trench bottoms shall be level to $\pm 1/4"$

in all directions)

Trench Spacing 9 Feet on Center

Soil Cover: 6 inches

(Maximum soil cover shall not exceed

36" above the trench bottom)

Pump Requirements _____ ft TDH vs _____ GPM

Aggregate Depth: _____ inches below pipe

_____ inches above pipe

_____ inches total

Conditions: * Moved SEPTIC TANK TO FIT Shed Addition and Hose size changed

WATER LINES (INCLUDING IRRIGATION) MUST BE 10FT. FROM ANY PART OF SEPTIC SYSTEM OR REPAIR AREA.
NO UTILITIES ALLOWED IN INITIAL OR REPAIR DRAIN FIELD AREA

**If applicable, I understand the system type specified is different from the type specified on the application. I accept the specifications of this permit.

Owner/Legal Representative Signature _____

Date _____

The Construction Authorization is subject to revocation if the site plan, plat, or the intended use changes. The Construction Authorization shall not be transferred when there is a change in ownership of the site. This Construction Authorization is subject to compliance with the provisions of the Laws and Rules for Sewage Treatment and Disposal and to the conditions of this permit.

SEE ATTACHED SITE SKETCH

Authorized State Agent: Mohammed RETH

Date: 10-18-22

Construction Authorization Expiration Date: 10-18-27

Application # BRES2107-0028 *Revised*

Harnett County Department of Public Health Site Sketch

Property Location: 120 Mickey Rouse (SR2432)
Issued To: Lashonda Thomas Subdivision _____ Lot # _____
Authorized State Agent: Meh [Signature] REHS Date: 10-18-22

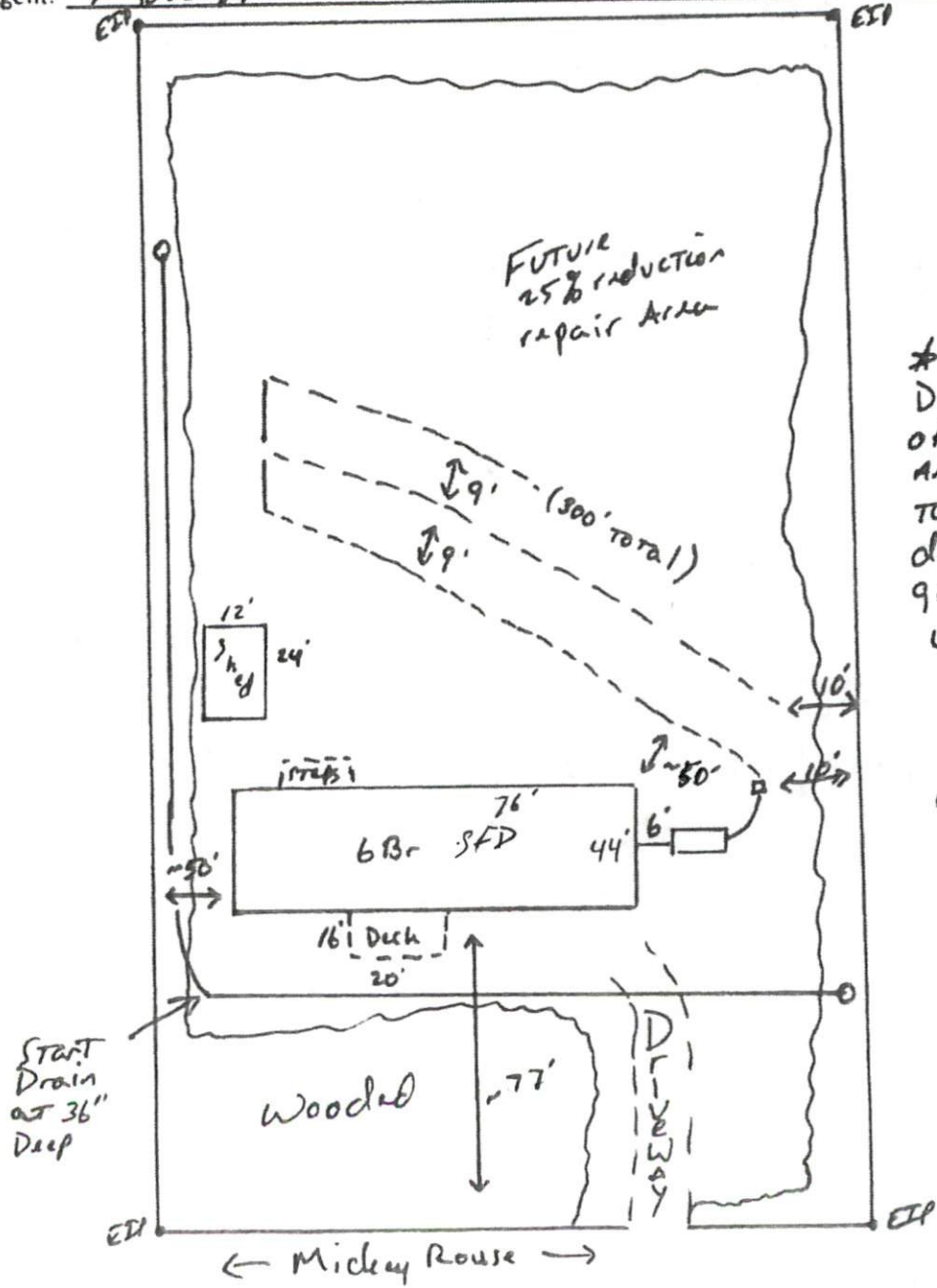

* Add A CURTAIN
Drain upslope
OF THE HOUSE.
AND DRAIN LINE
TO CATCH AND
DIVERT LATERAL
GROUND WATER
↳ Daylight
both ends of
The CURTAIN
Drain
↳ Hard pipe C
Drain under
The Drive

This drawing is for illustrative purposes only. System installation must meet all pertinent laws, rules, and regulations.