

Bres 2106-0055

**SOIL/SITE EVALUATION
 for ON-SITE WASTEWATER SYSTEM**

Owner: *Justin Carbasal* Applicant:

Address:
 Proposed Facility: *28'x56'*

Date Evaluated: *7-2-21*
 Design Flow (.1949): *480 GPD*
 Property Recorded:

Property Size:

Water Supply: Public Individual Well Spring Other
 Evaluation Method: Auger Boring Pit Cut
 Type of Wastewater: Sewage Industrial Process Mixed

P R O F I L E #	.1940 Landscape Position/ Slope %	Horizon Depth (In.)	SOIL MORPHOLOGY .1941		OTHER PROFILE FACTORS				Profile Class & LTAR
			.1941 Structure/ Texture	.1941 Consistence Mineralogy	.1942 Soil Wetness/ Color	.1943 Soil Depth (IN.)	.1956 Sapro Class	.1944 Restr Horiz	
<i>1,2</i>	<i>L</i>	<i>0-34</i>	<i>LS Gr</i>	<i>Vf/ls/np/np</i>	<i>>48"</i>	<i>>48"</i>	<i>—</i>	<i>—</i>	<i>S .6</i>
	<i>5-7%</i>	<i>34-48</i>	<i>SL Gr</i>	<i>Vf/ls/np/np</i>					<i>Group II</i>
<i>3</i>	<i>L</i>	<i>0-24</i>	<i>LS Gr</i>	<i>Vf/ls/np/np</i>	<i>10yr 2/i</i>	<i>>48"</i>	<i>—</i>	<i>—</i>	<i>PS .5</i>
	<i>5-7%</i>	<i>24-48</i>	<i>SL SSBk</i>	<i>Fc/ss/sp/np</i>	<i>≥ 40"</i>				<i>Group III</i>

Description	Initial System	Repair System	Other Factors (.1946): Site Classification (.1948): Evaluated By: <i>M. Orban R.E.H.</i> Others Present:
Available Space (.1945)	<i>✓</i>	<i>✓</i>	
System Type(s)	<i>258 rad</i>	<i>502 rad</i>	
Site LTAR	<i>.5</i>	<i>.5</i>	

COMMENTS: _____

LANDSCAPE POSITIONS	GROUP	TEXTURES	.1955 LTAR	CONSISTENCE MOIST	WET
R-RIDGE	I	S-SAND	1.2 - 0.8	VFR-VERY FRIABLE	NS-NON-STICKY
S-SHOULDER SLOPE		LS-LOAMY SAND			
L-LINEAR SLOPE	II	SL-SANDY LOAM	0.8 - 0.6	FR-FRIABLE	SS-SLIGHTLY STICKY
FS-FOOT SLOPE		L-LOAM			
N-NOSE SLOPE					
H-HEAD SLOPE	III	SI-SILT	0.6 - 0.3	FI-FIRM	S-STICKY
CC-CONCLAVE SLOPE		SIL-SILT LOAM			
CV-CONVEX SLOPE		CL-CLAY LOAM			
T-TERRACE		SCL-SANDY CLAY LOAM			
FP-FLOOD PLAN	IV	SIC-SILTY CLAY	0.4 - 0.1	VFI-VERY FIRM	VS-VERY STICKY
		C-CLAY			
		SC-SANDY CLAY			

- STRUCTURE
 SG-SINGLE GRAIN
 M-MASSIVE
 CR-CRUMB
 GR-GRANULAR
 SBK-SUBANGULAR BLOCKY
 ABK-ANGULAR BLOCKY
 PL-PLATY
 PR-PRISMATIC

- MINERALOGY
 SLIGHTLY EXPANSIVE
 EXPANSIVE

7-2-21
 NO Iron
 NO House Flags

Show profile locations and other site features (dimensions, references or benchmark, and North)

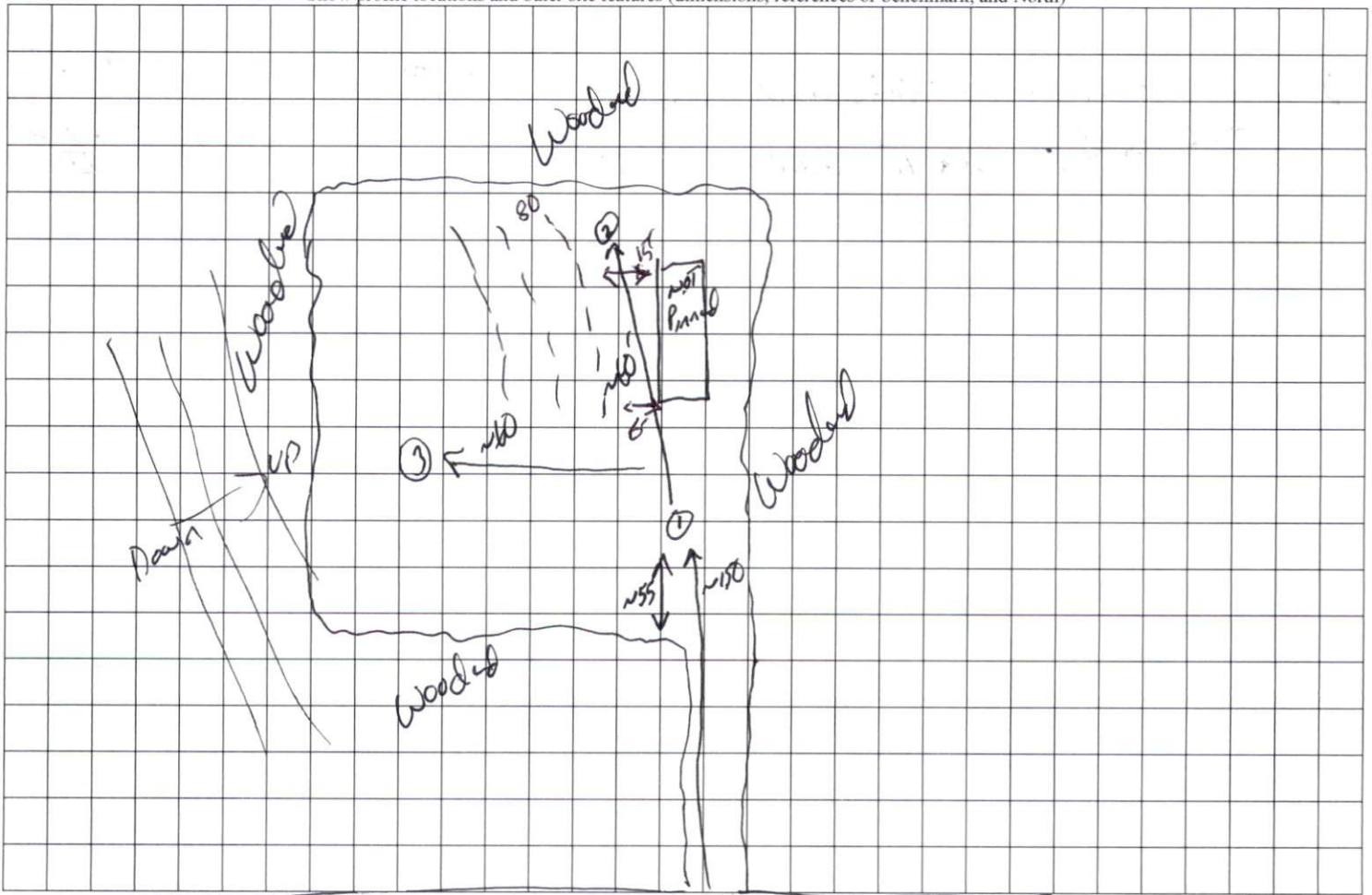

← Michy Rouse Ln →