

Revised

# Harnett County Department of Public Health

## Improvement Permit

A building permit cannot be issued with only an Improvement Permit

PROPERTY LOCATION 1599 NC-24

SUBDIVISION \_\_\_\_\_

LOT # \_\_\_\_\_

ISSUED TO Andre Grier

NEW  REPAIR  EXPANSION

Type of Structure 14' x 70' SWMH

Proposed Wastewater System Type 25% reduction

Projected Daily Flow 380 GPD

Number of bedrooms 3 Number of Occupants 6 max

Basement  Yes  No

Pump Required  Yes  No  May be required based on final location and elevations of facilities

Type of Water Supply  Community  Public  Well Distance from well \_\_\_\_\_ feet

Permit valid for.  Five years  
 No expiration

Permit conditions \_\_\_\_\_

Site Improvements required prior to Construction Authorization Issuance

Authorized State Agent: Moh R. REHS

Date 3-29-22

SEE ATTACHED SITE SKETCH

The issuance of this permit by the Health Department in no way guarantees the issuance of other permits. The permit holder is responsible for checking with appropriate governing bodies or meeting their requirements. This site is subject to revocation if the site plan, plat or the intended use changes. The Improvement Permit shall not be affected by a change in ownership of the site. This permit is subject to compliance with the provisions of the Laws and Rules for Sewage Treatment and Disposal and to conditions of this permit.

## Construction Authorization

(Required for Building Permit)

The construction and installation requirements of Rules 1950, 1952, 1954, 1955, 1956, 1957, 1958 and 1959 are incorporated by reference into this permit and shall be met. Systems shall be installed in accordance with the attached system layout.

ISSUED TO Andre Grier

PROPERTY LOCATION 1599 NC-24

SUBDIVISION \_\_\_\_\_

LOT # \_\_\_\_\_

Facility Type: 14' x 70' SWMH  New  Expansion  Repair

Basement?  Yes  No Basement Features?  Yes  No

Type of Wastewater System\*\* 25% reduction

(Initial) Wastewater flow: 240 GPD

(See note below, if applicable)

25% reduction (Repair)

Installation Requirements/Conditions

Septic Tank Size 1000 gallons

Pump Tank Size \_\_\_\_\_ gallons

Number of trenches 3

Exact length of each trench 70' feet

Trenches shall be installed on contour at a

Maximum Trench Depth of: 18" - 24" inches

(Trench bottoms shall be level to  $\pm 1/4"$

in all directions)

Trench Spacing: 9 feet on Center

Soil Cover: 6 inches

(Maximum soil cover shall not exceed

36" above the trench bottom)

Pump Requirements \_\_\_\_\_ ft TDH vs \_\_\_\_\_ GPM

Aggregate Depth: \_\_\_\_\_ inches below pipe

\_\_\_\_\_ inches above pipe

\_\_\_\_\_ inches total

Conditions \_\_\_\_\_

**WATER LINES (INCLUDING IRRIGATION) MUST BE 10FT. FROM ANY PART OF SEPTIC SYSTEM OR REPAIR AREA.  
NO UTILITIES ALLOWED IN INITIAL OR REPAIR DRAIN FIELD AREA.**

\*\*If applicable: I understand the system type specified is different from the type specified on the application. I accept the specifications of this permit.

Owner/Legal Representative Signature \_\_\_\_\_

Date \_\_\_\_\_

This Construction Authorization is subject to revocation if the site plan, plat or the intended use changes. The Construction Authorization shall not be transferred when there is a change in ownership of the site. This Construction Authorization is subject to compliance with the provisions of the Laws and Rules for Sewage Treatment and Disposal and to the conditions of this permit.

SEE ATTACHED SITE SKETCH

Authorized State Agent: Moh R. REHS

Date: 3-29-22

Construction Authorization Expiration Date: 3-29-27

Application # BRES2106-0044 *Revised*

### Harnett County Department of Public Health Site Sketch

Property Location: 1599 NC 24

Issued To: Andre Grier

Subdivision \_\_\_\_\_

Lot # \_\_\_\_\_

Authorized State Agent: *Mark Or* *REHS*

Date: 3-29-22

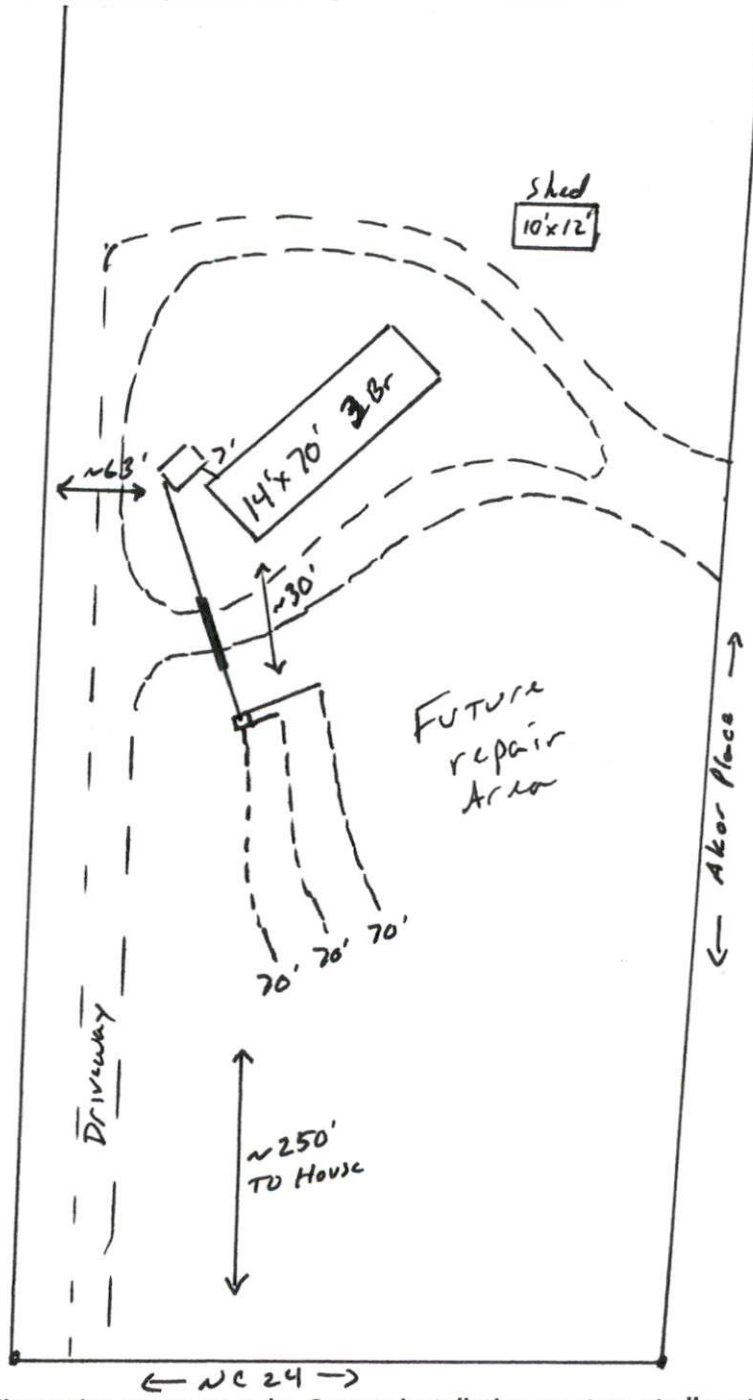

- \* Make sure Driveway is > 5' From Septic System
- \* Keep Future Fence > 5' From Septic Lines + repair Area
- \* Sleeve supply line under Driveway

This drawing is for illustrative purposes only. System installation must meet all pertinent laws, rules, and regulations.