



MAP NORTH
P.C. #2, Slide 141

Mary G. Stevens
D.B. 1153, Pg. 181; M.B. 7, Pg. 7
N 75°09'00"E 120.00'

ERB
(6" BG)

ERB at
Angle Iron
Pos
35FT.

35' MBL

0.75 Acre
(32,633 sq.ft.)

S 14°52'00"E
10' MBL
271.93'

Matthew R. LAWSON
D.B. 2838, Pg. 269
P.C. #2, Slide 141

Henry Clifton & Peggy Sewell Royd
D.B. 921, Pg. 459
P.C. #2, Slide 141

PP

MH



120.00'

NCSR 1746 60' R/W
"Old Post Road" (Public)

LEGEND

- Subject Boundary Line
- - - Adjoining Boundary Line
- - - R/W Right-of-Way Line
- - - MBL Minimum Building Line
- OHE - OHE Overhead Electric Line
- S - S Sanitary Sewer Line
- △ CP Calculated Point
- △ EIP/EIS Existing Iron Pipe/Stake
- ERB Existing Re-Bar
- ECM Existing Concrete Monument
- WM Water Meter
- PP Power Pole
- MH Manhole
- BG Below Grade

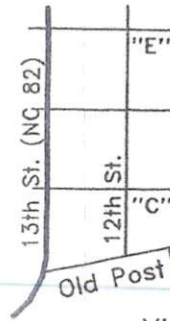

Old Post
VII
"402
Deed
Plat C

S
Prospect
Jan
Rebecca
Sellers: Dr
Duke

Scale: 1" = 5'

Surveye
STR
LAND SU
870 NC 55 W
910-897-7715

I hereby certify that the represented hereon was under my supervision in accordance with The Standards of Practice for Professional Surveying in North Carolina (N.C.A.C. 56.1600); that the precision meets Class A and there were no encroachments across surveyed property unless otherwise shown.

FEMA FLOOD HAZARD STATEMENT
Lots shown on this plat are not located within the FEMA 100 year Flood Hazard Area as shown on FEMA map No. 3720059700J Effective date: 10/3/2006

S 75°08'00"W 159.89' (tie)
S 72°26'26"W 140.03' (tie to Fire Hydrant)

ERB (disturbed)
Re-set



NOT FC

South 10th Street (Public)

R/W
ECM (disturbed)

S 75°08'00"W 120.00'
S 75°08'00"W

N 75°06'15"E 119.95' (tie)
R/W
R/W