

Bres-2105-00114

**SOIL/SITE EVALUATION  
 for ON-SITE WASTEWATER SYSTEM**

Owner: *Theresa Slade* Applicant:

Address: *368 Norrington Rd*

Date Evaluated: *5-28-21*

Proposed Facility: *SFS*

Design Flow (.1949): *480 GPD*

Property Size:

Location of Site:

Property Recorded:

Water Supply:  Public  Individual  Well  Spring  Other

Evaluation Method:  Auger Boring  Pit  Cut

Type of Wastewater:  Sewage  Industrial Process  Mixed

P R O F I L E #	.1940 Landscape Position/ Slope %	Horizon Depth (In.)	SOIL MORPHOLOGY		OTHER PROFILE FACTORS					Profile Class & LTAR
			.1941		.1942 Soil Wetness/ Color	.1943 Soil Depth (IN.)	.1956 Sapro Class	.1944 Restr Horiz		
			.1941 Structure/ Texture	.1941 Consistence Mineralogy						
1.3	L	0-8	LS	Gr	F <sub>o</sub> /U <sub>s</sub> /N <sub>p</sub> /N <sub>sp</sub>	10YR 8/1 ≤ 12"				U
	22%	8-				TO IS NOT @ ~8"	≥ 8"			
2.4	L	0-18	LS	Gr	F <sub>o</sub> /U <sub>s</sub> /N <sub>p</sub> /N <sub>sp</sub>	10YR 8/1 ≤ 12"				
	22%	18-				TO IS NOT @ ~18"	≥ 18"			U
5	L	0-6	LS	Gr	F <sub>o</sub> /U <sub>s</sub> /N <sub>p</sub> /N <sub>sp</sub>	10YR 8/1 ≤ 12"				
	22%	6-18	SC	S <sub>sh</sub>	F <sub>o</sub> /SS/SP/SXP					U
		18-				TO IS NOT @ ~18"				

Description	Initial System	Repair System	Other Factors (.1946): Site Classification (.1948):
Available Space (.1945)			Evaluated By: <i>MBhorn DEHS</i> Others Present: <i>J.M.</i>
System Type(s)			
Site LTAR			

COMMENTS: \_\_\_\_\_

LANDSCAPE POSITIONS	GROUP	TEXTURES	.1955 LTAR	CONSISTENCE MOIST	WET
R-RIDGE	I	S-SAND	1.2 - 0.8	VFR-VERY FRIABLE	NS-NON-STICKY
S-SHOULDER SLOPE		LS-LOAMY SAND		FR-FRIABLE	SS-SLIGHTLY STICKY
L-LINEAR SLOPE	II	SL-SANDY LOAM	0.8 - 0.6	FI-FIRM	S-STICKY
FS-FOOT SLOPE		L-LOAM		VFI-VERY FIRM	VS-VERY STICKY
N-NOSE SLOPE				EFI-EXTREMELY FIRM	NP-NON-PLASTIC
H-HEAD SLOPE	III	SI-SILT	0.6 - 0.3		SP-SLIGHTLY STICKY
CC-CONCLAVE SLOPE		SIL-SILT LOAM			P-PLASTIC
CV-CONVEX SLOPE		CL-CLAY LOAM			VP-VERY PLASTIC
T-TERRACE		SCL-SANDY CLAY LOAM			
FP-FLOOD PLAN	IV	SIC-SILTY CLAY	0.4 - 0.1		
		C-CLAY			
		SC-SANDY CLAY			

**STRUCTURE**  
 SG-SINGLE GRAIN  
 M-MASSIVE  
 CR-CRUMB  
 GR-GRANULAR  
 SBK-SUBANGULAR BLOCKY  
 ABK-ANGULAR BLOCKY  
 PL-PLATY  
 PR-PRISMATIC

**MINERALOGY**  
 SLIGHTLY EXPANSIVE  
 EXPANSIVE

*Site is unsuitable to soil wetness conditions, and client must get soil scientist to try to locate a suitable area on the lot for a septic system, as our office could not find any area for septic and repair.*

Show profile locations and other site features (dimensions, references or benchmark, and North)

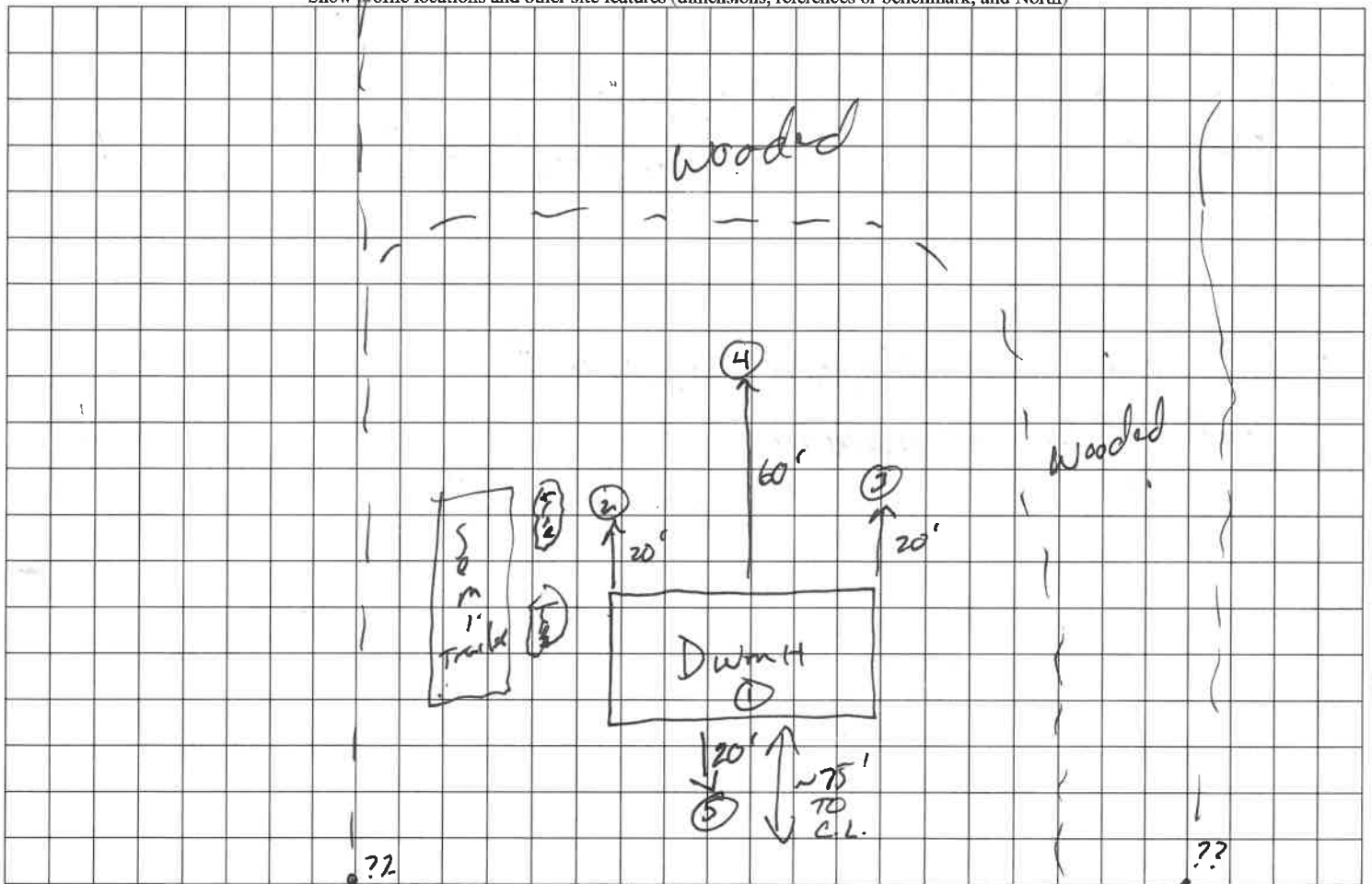

NORRINGTON RD

*- 08-2021 LSS Hal Owens called and stated he was unable to locate a site for a septic system and repair on the lot*