

Facing House

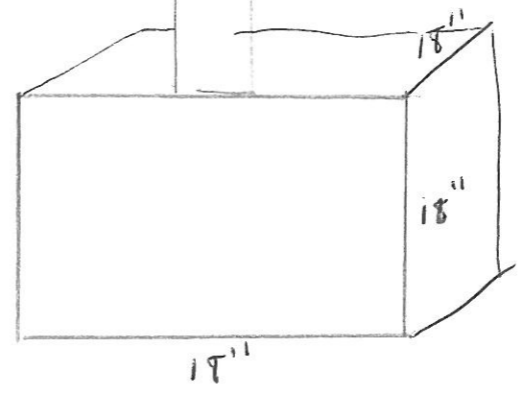
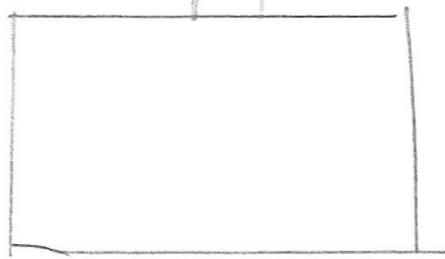
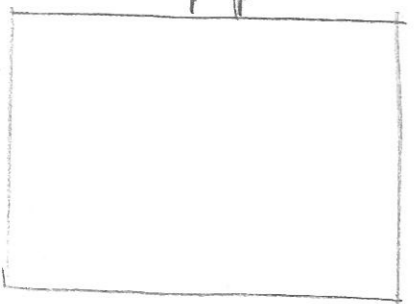
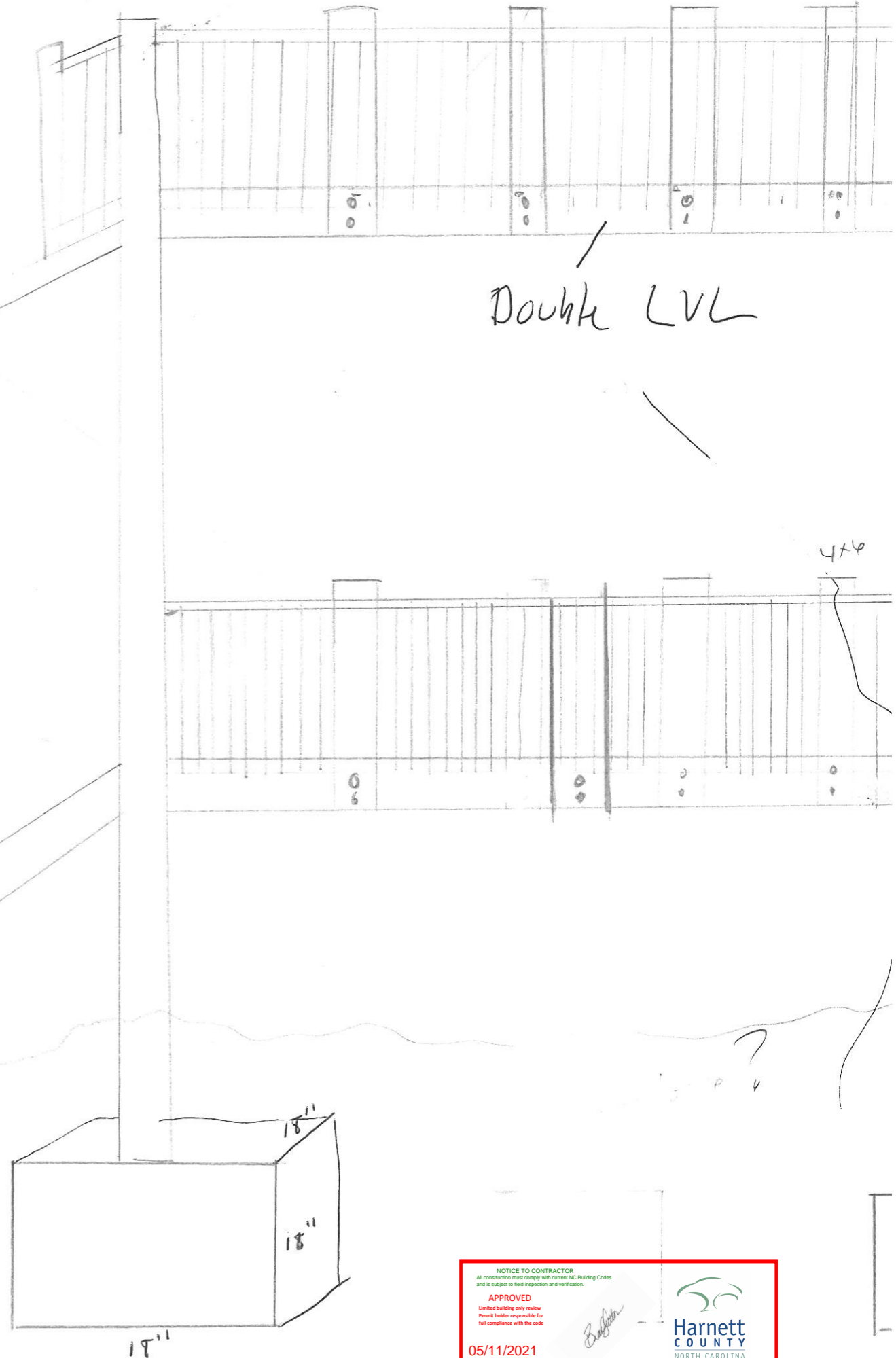
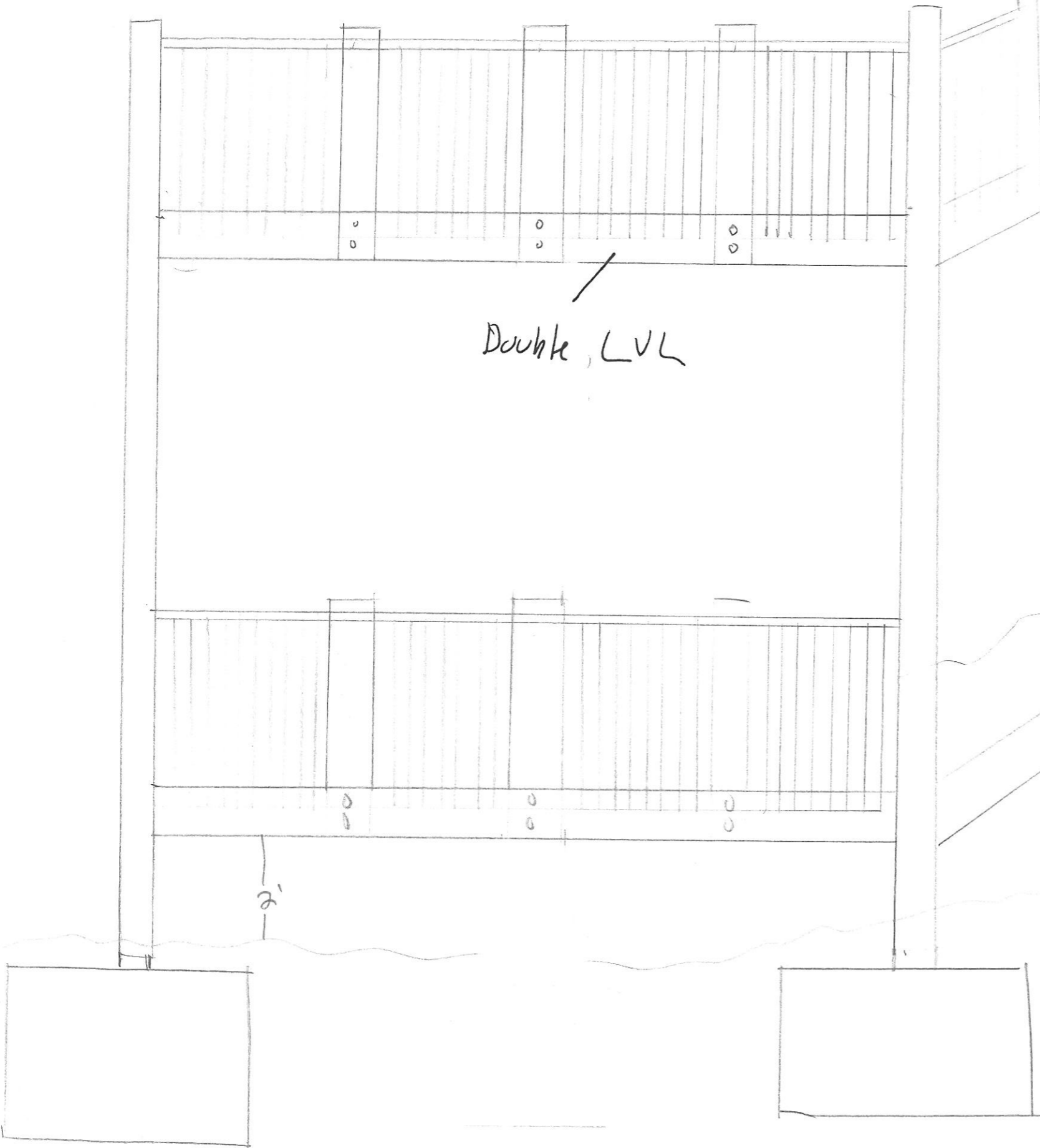

NOTICE TO CONTRACTOR
All construction must comply with current NC Building Codes
and is subject to field inspection and verification.

APPROVED
Limited building only review
Permit holder responsible for
full compliance with the code

05/11/2021



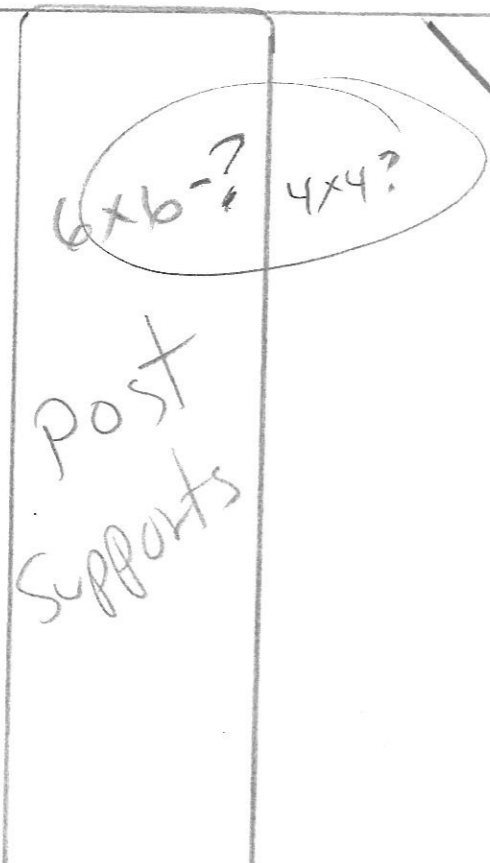
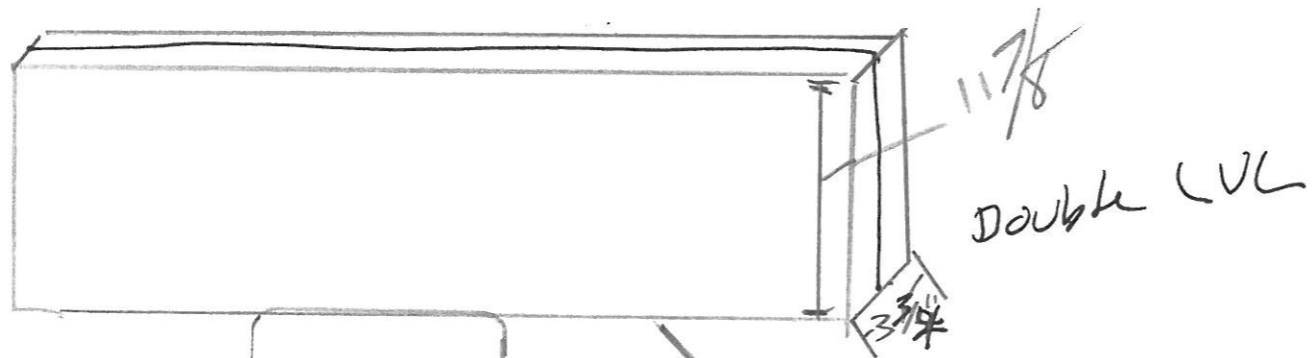
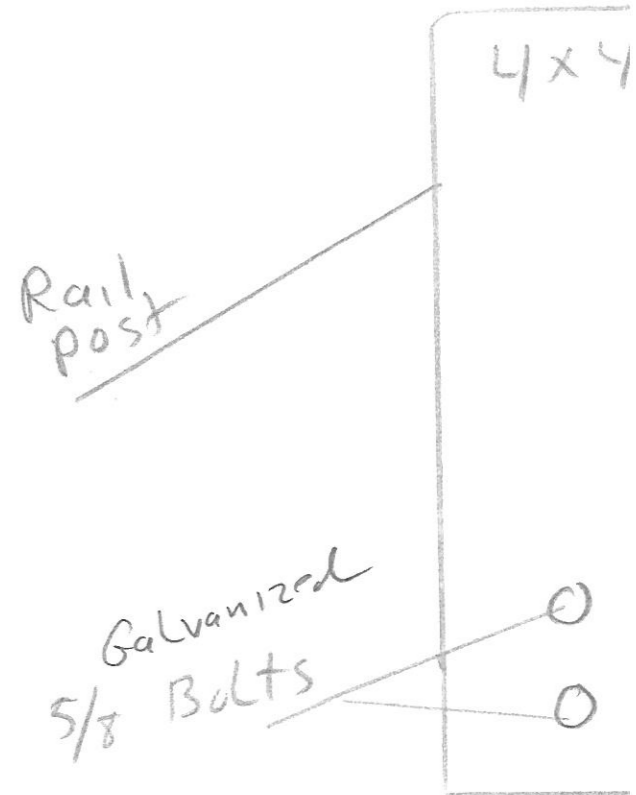
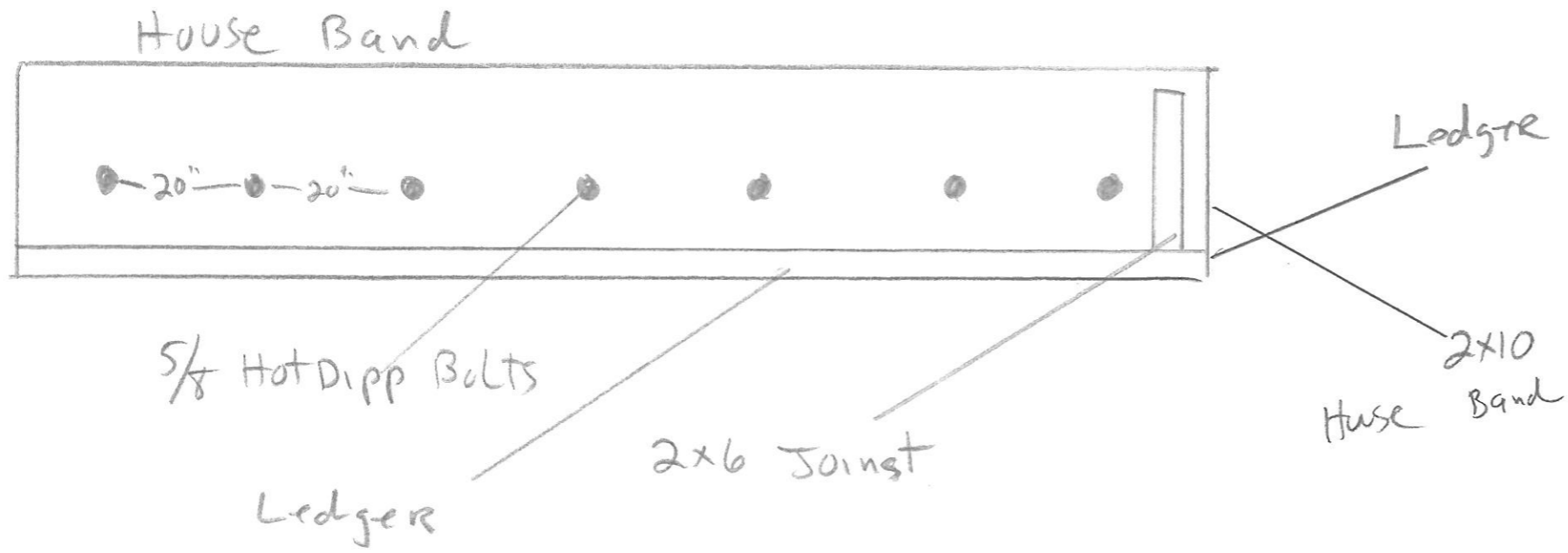

1 7/8 x 3 1/4 OR ?
LVL

Ground Level

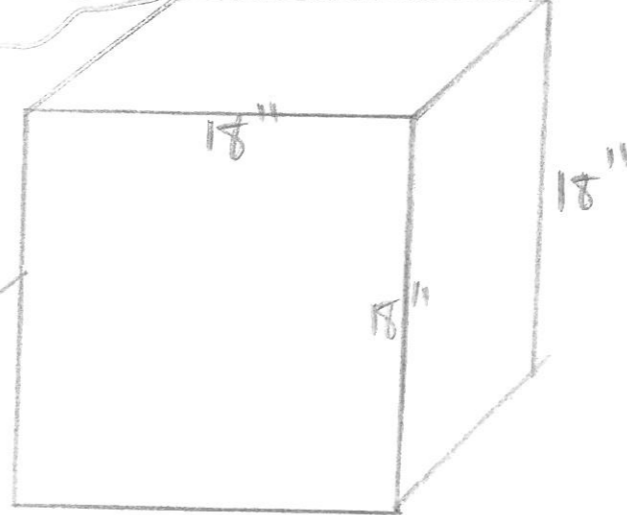

Concrete Footings

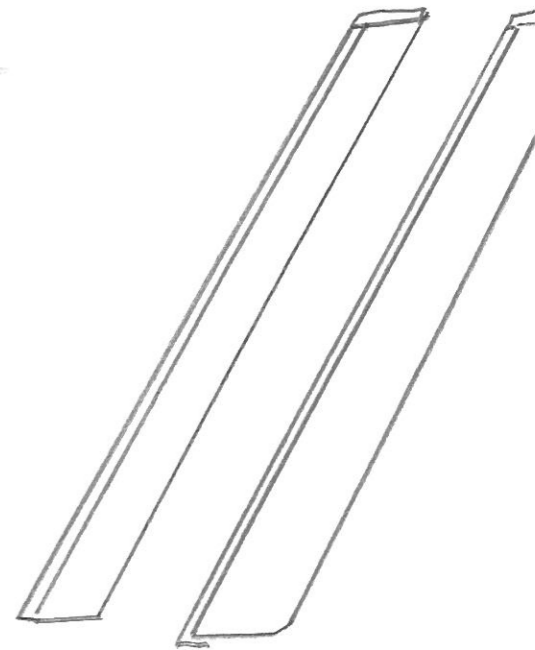

2x6x16 Joist

5/4 Decking Boards

House

Top View

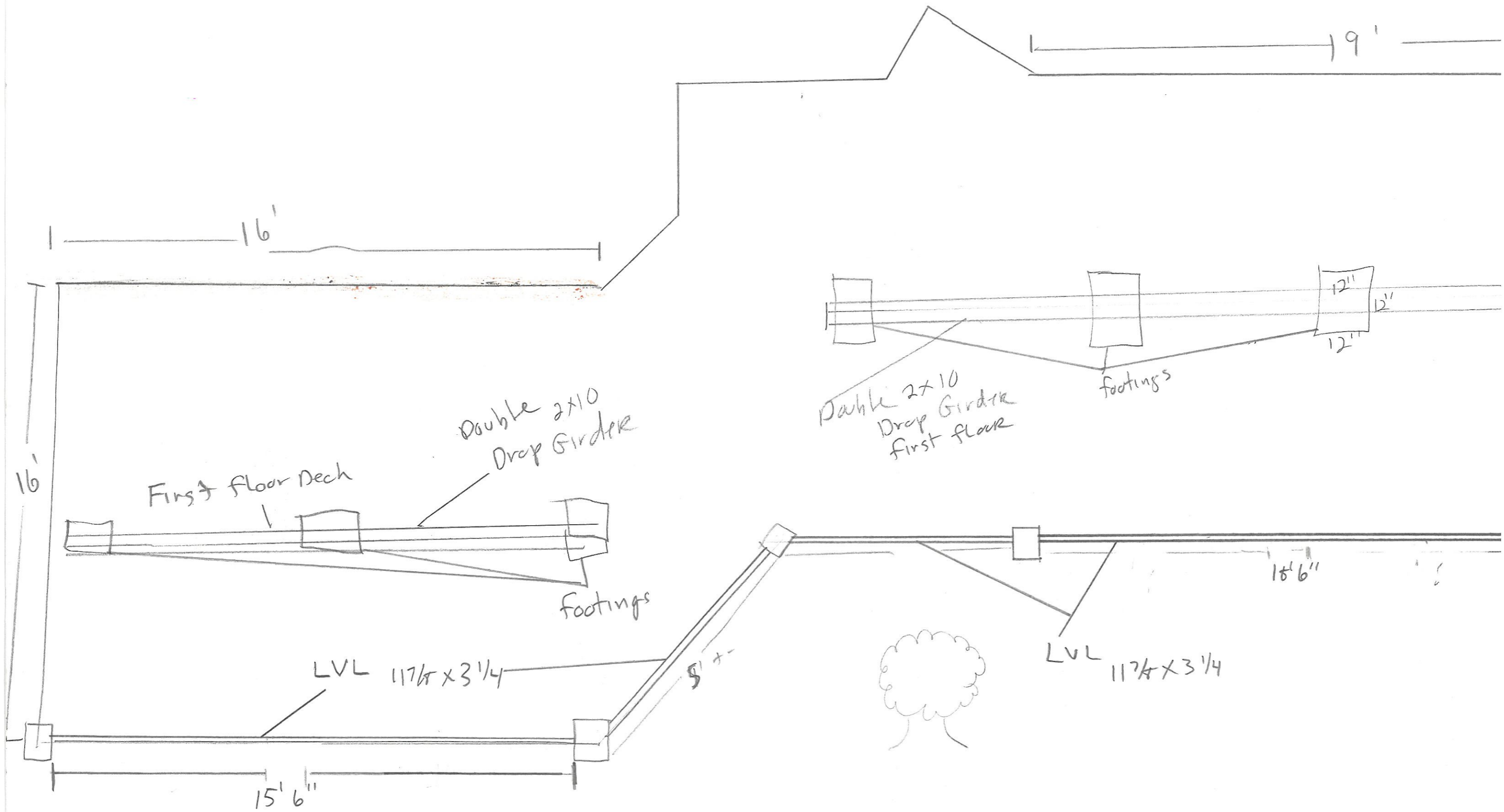

2"x12"

6x6

2"x12"

6x6

