

JC Constructions LLC

1317 Butterwood Cir.
Fayetteville, NC 28314
Phone: 910-992-9394
jccubas22@yahoo.com

557 Micahs Way, Spring Lake NC

Top View

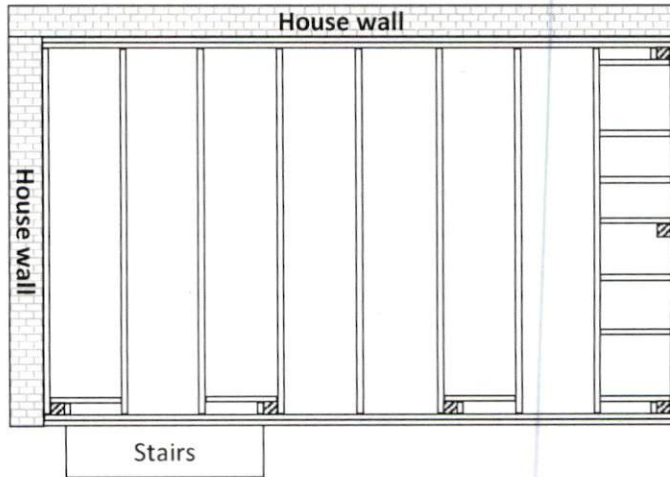

- 8'X12' Deck
- 7' high build on existing wall
- Joist 16" appart
- Joist 2"X10"
- Joist hangers
- Two 5/8" bolts per post
- Balusters 4" appart
- Steps 7" rise and 10" run
- Rails 36" tall
- Rails length 6' or less
- Posts 4X4
- 6' Tall lattice to the side of the deck

