

# Harnett County Department of Public Health

## Improvement Permit

A building permit cannot be issued with only an Improvement Permit

ISSUED TO: LILIANA ITELVA TLAZALO PROPERTY LOCATION: 501560 Festus RD LOT # \_\_\_\_\_

NEW  REPAIR  EXPANSION  SUBDIVISION \_\_\_\_\_

Type of Structure: DwM H Site Improvements required prior to Construction Authorization Issuance: \_\_\_\_\_

Proposed Wastewater System Type: 25% REDUCTION

Projected Daily Flow: 360 GPD

Number of bedrooms: 3 Number of Occupants: 6 max

Basement  Yes  No

Pump Required:  Yes  No  May be required based on final location and elevations of facilities

Type of Water Supply:  Community  Public  Well Distance from well 50' feet

Permit conditions: \_\_\_\_\_ Permit valid for:  Five years  No expiration

Authorized State Agent: James C. Manhart JR. PBHS Date: 4-4-23 SEE ATTACHED SITE SKETCH

The issuance of this permit by the Health Department in no way guarantees the issuance of other permits. The permit holder is responsible for checking with appropriate governing bodies in meeting their requirements. This site is subject to revocation if the site plan, plat, or the intended use changes. The Improvement Permit shall not be affected by a change in ownership of the site. This permit is subject to compliance with the provisions of the Laws and Rules for Sewage Treatment and Disposal and to conditions of this permit.

## Construction Authorization

(Required for Building Permit)

The construction and installation requirements of Rules .1950, .1952, .1954, .1955, .1956, .1957, .1958, and .1959 are incorporated by references into this permit and shall be met. Systems shall be installed in accordance with the attached system layout.

ISSUED TO: LILIANA ITELVA TLAZALO PROPERTY LOCATION: 501560 Festus RD LOT # \_\_\_\_\_

Facility Type: DwM H  New  Expansion  Repair

Basement?  Yes  No Basement Fixtures?  Yes  No

Type of Wastewater System\*\* 25% REDUCTION (Initial) Wastewater Flow: 360 GPD

(See note below, if applicable  25% REDUCTION (Repair))

**Installation Requirements/Conditions**

Septic Tank Size 1000 gallons Number of trenches 4

Pump Tank Size \_\_\_\_\_ gallons Exact length of each trench 60 feet Trench Spacing: 9 Feet on Center

Trenches shall be installed on contour at a Maximum Trench Depth of: 22-7/8 inches Soil Cover: 6 inches (Maximum soil cover shall not exceed 36" above the trench bottom)

(Trench bottoms shall be level to +/-1/4" in all directions)

Pump Requirements: \_\_\_\_\_ ft. TDH vs. \_\_\_\_\_ GPM Aggregate Depth: 6 inches below pipe 2 inches above pipe 12 inches total

Conditions: \_\_\_\_\_

**WATER LINES (INCLUDING IRRIGATION) MUST BE 10FT. FROM ANY PART OF SEPTIC SYSTEM OR REPAIR AREA. NO UTILITIES ALLOWED IN INITIAL OR REPAIR DRAIN FIELD AREA.**

\*\*If applicable: I understand the system type specified is different from the type specified on the application. I accept the specifications of this permit.

Owner/Legal Representative Signature: \_\_\_\_\_ Date: \_\_\_\_\_

This Construction Authorization is subject to revocation if the site plan, plat, or the intended use changes. The Construction Authorization shall not be transferred when there is a change in ownership of the site. This Construction Authorization is subject to compliance with the provisions of the Laws and Rules for Sewage Treatment and Disposal and to the conditions of this permit. SEE ATTACHED SITE SKETCH

Authorized State Agent: James C. Manhart JR. PBHS Date: 4-4-23

Construction Authorization Expiration Date: 4-4-28

Application # BCSS2105-0010

### Harnett County Department of Public Health Site Sketch

Property Location: SR 1560 Festus RD  
Issued To: CLEANA ITHUA TLAZALO Subdivision \_\_\_\_\_ Lot # \_\_\_\_\_  
Authorized State Agent: James C. Manhart ~~RE~~ REBAS Date: 4-4-23

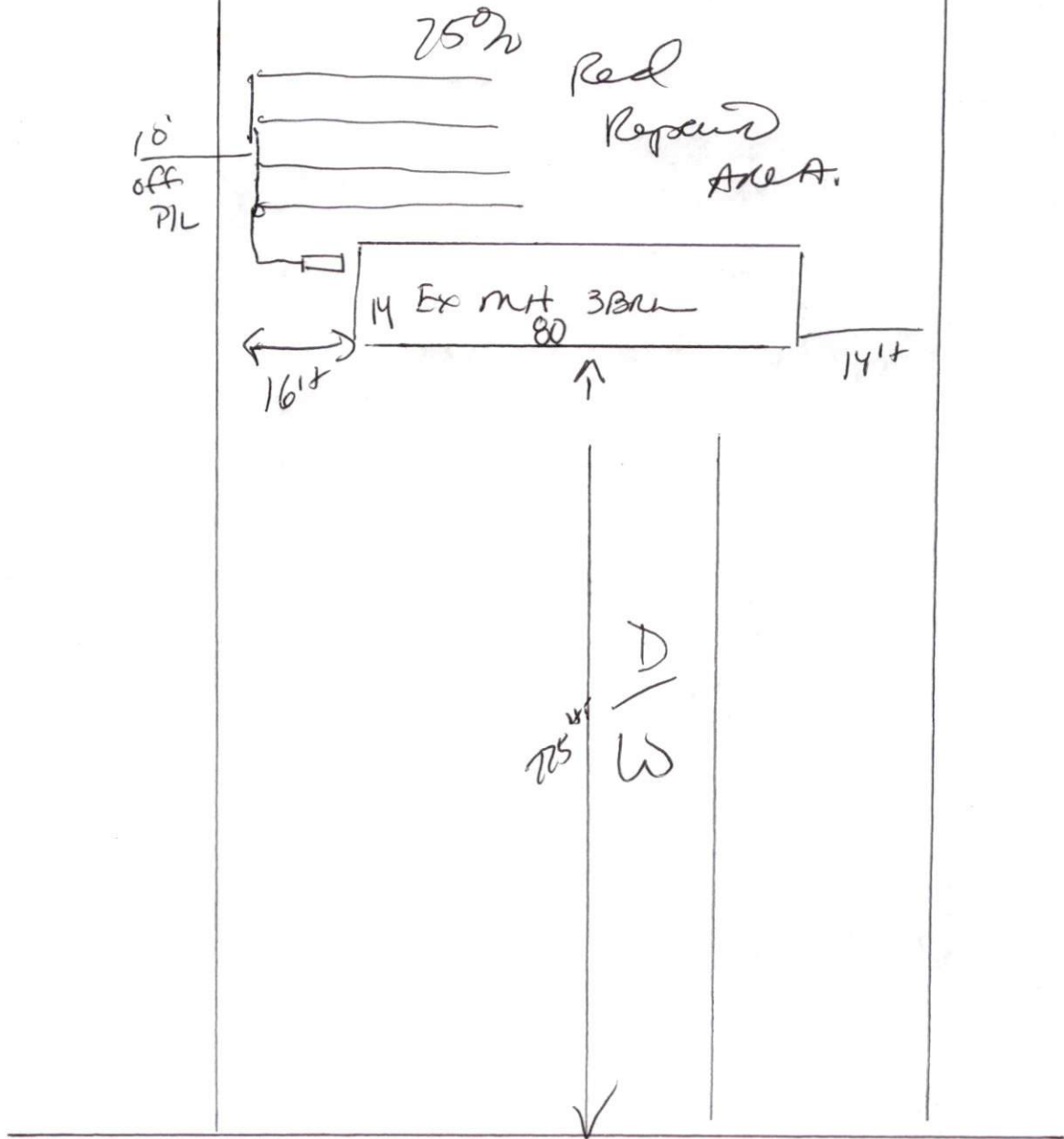

SR 1560 Festus RD

This drawing is for illustrative purposes only. System installation must meet all pertinent laws, rules, and regulations.