

David and Christy Tudor: 204 East K Street Erwin NC 28339 –  
Master Suite Addition

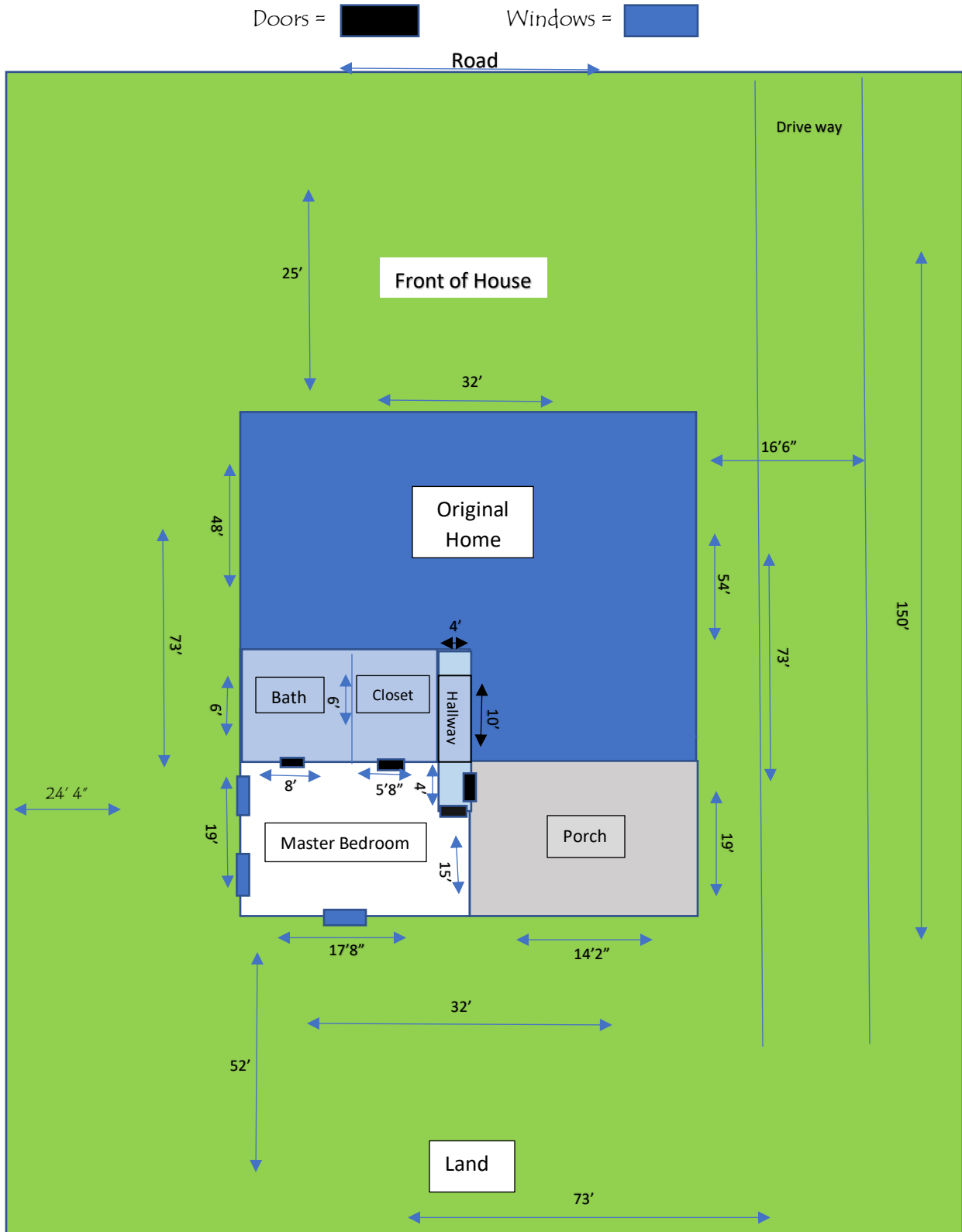

## Notes:

### Master Suite

Floor: 2x10 Framing 16" o/c

Walls: Typ 2x4 Framing 16" o/c

Headers: Typ 2x10 Headers with 1/2" ply between

Ceiling: Frame 2x10 16" o/c 18' span no storage

Roof: 2x8" Rafters and 2x10" Ridge A-Frame

Sheathing: 7/16" Ply wall and roof coverings

### Porch

Floor: Pressure Treated 2x10 Joists

2x10 pt band

Beams: 2x10 beams spf or syp

