

OPERATIONS PERMIT

Name: (owner) Lambert Homes
Property Location: SR# 1443 Lafayette
Subdivision South Ridge Lot # 63
TAX ID#
Contractor: Tommy Coley Registration #

Basement with Plumbing:
Garage:
Water Supply: Well Public Community
Distance From Well: 50 ft.

Following are the specifications for the sewage disposal system on above captioned property.

Type of system: Conventional Other
Size of tank: Septic Tank: 1000 gallons Pump Tank:
Subsurface Drainage Field: No. of ditches 2 exact length of each ditch 112 ft. width of ditches 3 ft. depth of ditches 18-20 in.
French Drain: Linear feet

PERMIT NO. 15994
Date: 4-23-85
Inspected by: James E. Matthe Environmental Health Specialist

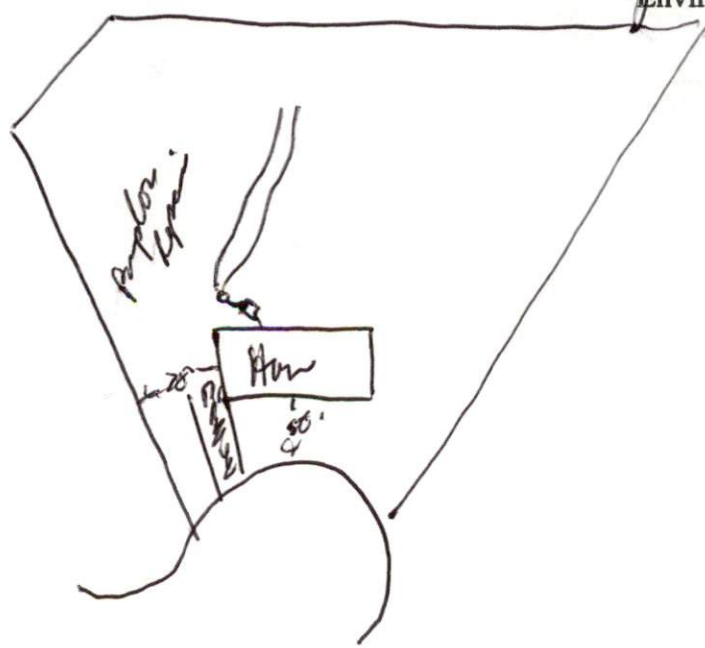

HARNETT COUNTY HEALTH DEPARTMENT

IN# 15994

IMPROVEMENT PERMIT

Be it ordained by the Harnett County Board of Health as follows: Section III, Item B. "No Person shall begin construction of any building at which a septic tank system is to be used for disposal of sewage without first obtaining a written permit from the Harnett County Health Department."

Name: (owner) Lambert Homes Inc.
Property Location: SR# 1443 Lafayette
New Installation
Septic Tank
Repairs
Nitrification Line

Subdivision South Ridge Farms Lot # 63

Tax ID # Quadrant #

Number of Bedrooms Proposed: 3 Lot Size: 82,148 sq FT

Basement with Plumbing: Garage:

Water Supply: Well Public Community

Distance From Well: 50 ft.

Following is the minimum specifications for sewage disposal system on above captioned property. Subject to final approval.

Type of system: Conventional Other EKF-722 City INWS-95-36

Size of tank: Septic Tank: 1000 gallons Pump Tank: gallons

Subsurface Drainage Field No. of ditches 3 exact length of each ditch 75 ft. width of ditches 3 ft. depth of ditches 18-20 in.

French Drain Required: Linear feet

Date: 2-17-99

This permit is subject to revocation if site plans or intended use change.

Signed: James E. Marshall R.S. Environmental Health Specialist
\* Maintain all setbacks

