

OPERATIONS PERMIT

Name: (owner) Tony & Darlene Currin

New Installation

Septic Tank

Property Location: SR# 1244 Moores Chapel Rd.

Repairs

Nitrification Line

Subdivision Tony & Darlene Currin

Lot # _____

TAX ID# _____

Quadrant # _____

Contractor: Mike Ray

Registration # _____

Basement with Plumbing:

Garage:

Water Supply: Well Public

Community

Distance From Well: 50 min ft.

Following are the specifications for the sewage disposal system on above captioned property.

Type of system: Conventional

Other _____

Size of tank: Septic Tank: 1000 gallons

Pump Tank: _____ gallons

Subsurface Drainage Field No. of ditches 1 exact length of each ditch 240 ft. width of ditches 3 ft. depth of ditches 18 2/4 in.

French Drain: _____ Linear feet

Date: 4/2/88

PERMIT NO. 12760

Inspected by: Bryce M. Givens
Environmental Health Specialist

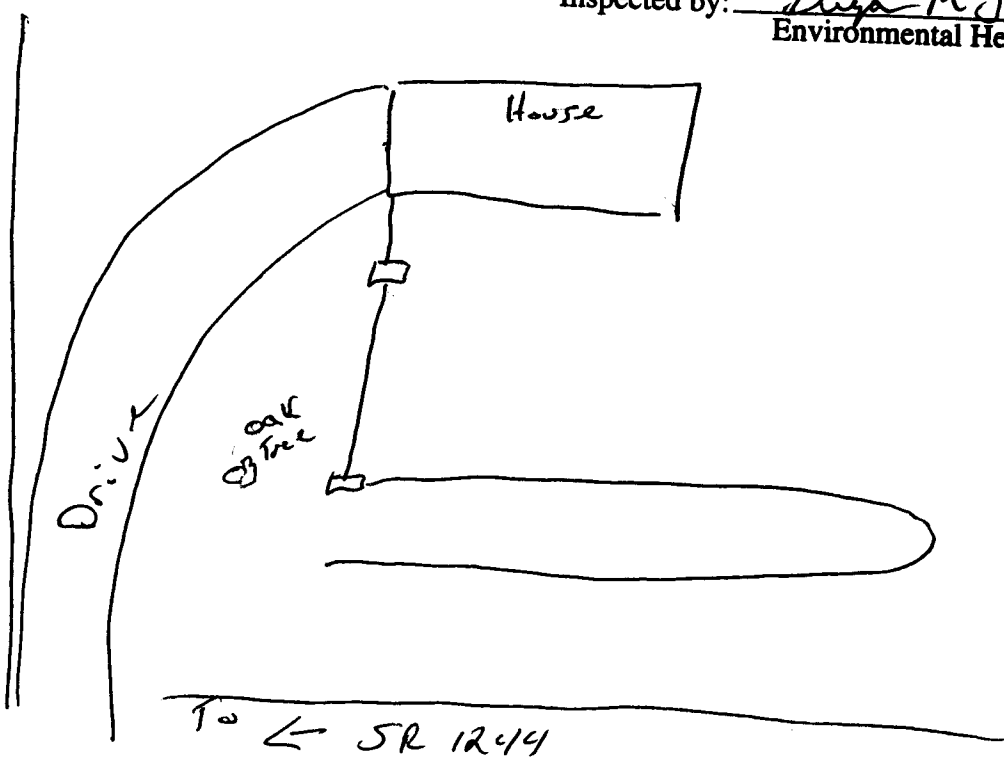

HARNETT COUNTY HEALTH DEPARTMENT IMPROVEMENT PERMIT

12760

Be it ordained by the Harnett County Board of Health as follows: Section III, Item B. "No Person shall begin construction of any building at which a septic tank system is to be used for disposal of sewage without first obtaining a written permit from the Harnett County Health Department."

Name: (owner) Tony & Darlene Curran New Installation Septic Tank
 Property Location: SR# 1244 MOORES Chapel Rd Repairs Nitrification Line

Subdivision Tony & Darlene Curran Lot # _____
 Tax ID # _____ Quadrant # _____

Number of Bedrooms Proposed: 3 Lot Size: 5.0 AC

Basement with Plumbing: Garage: MUST meet on site
 Water Supply: Well Public Community Before Installing
 Distance From Well: 50 min ft.

Following is the minimum specifications for sewage disposal system on above captioned property. Subject to final approval.

Type of system: Conventional Other _____
 Size of tank: Septic Tank: 1000 gallons Pump Tank: _____ gallons
 Subsurface Drainage Field No. of ditches 3 exact length 240 width of ditches 3 depth of ditches 18 1/4 in.
 French Drain Required: _____ Linear feet

This permit is subject to revocation if site plans or intended use change.

Date: 6-30-97
 Signed: J. W. AN
 Environmental Health Specialist

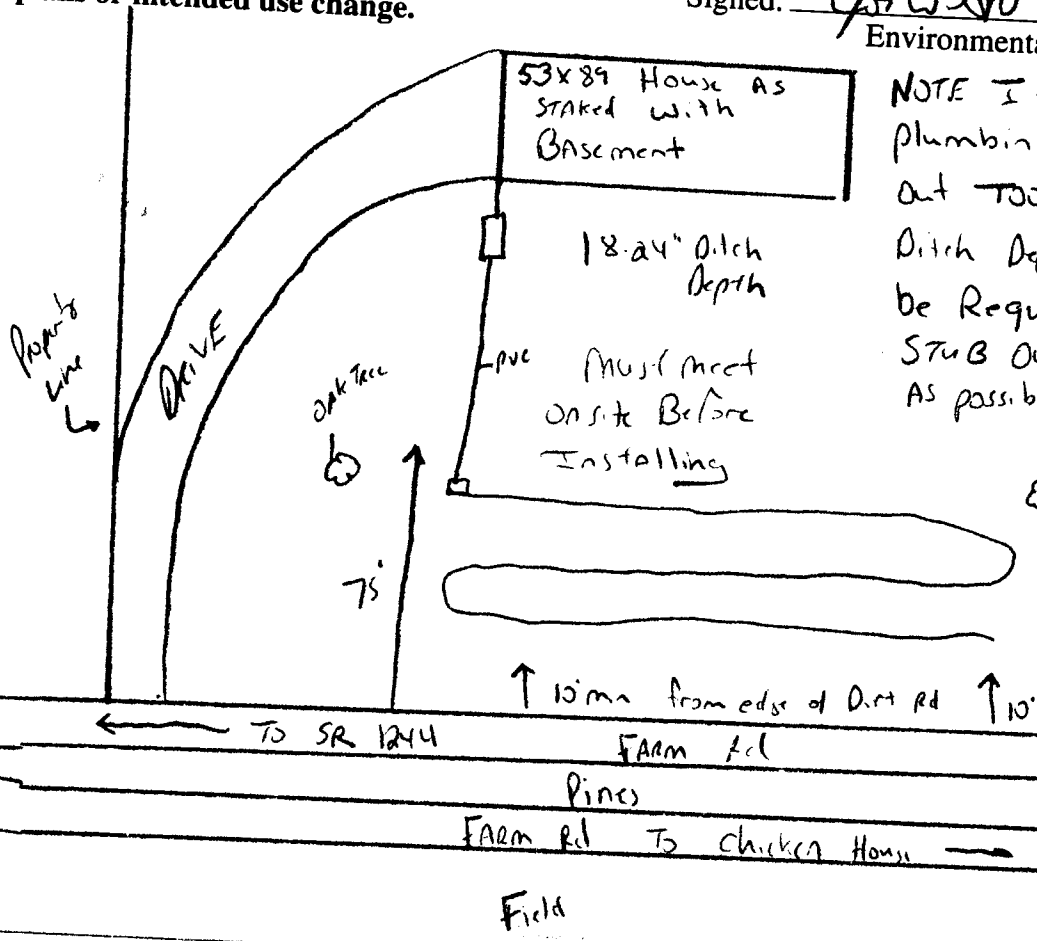

NOTE IF BASEMENT HAS plumbing & It is stubbed out TOO Deep for Required Ditch Depths Then Pump will be Required.
 STUB Out Plumbing shallow AS possible Follow contains maintain all Required set Back LPP Repair