

House Dimension: 36.4' x 35.9'

Proposed Deck Dimensions: 48.4' x 47.9'

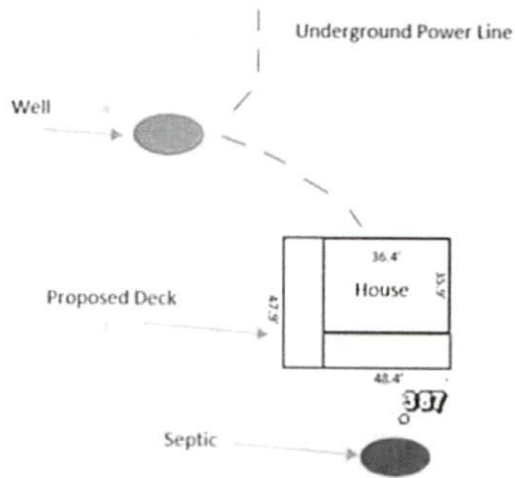

Replacing
existing deck
48.4 x 47.7

Building Setbacks

Front: 124'

Rear: 1,348'

Side: 151.9'

Side Corner: 129':

Open Space: 23.82 Acres within parcel. Adjacent parcel to front, right, and rear also owned by Joseph Fancher.

Scale: Harnett County GIS Google Map

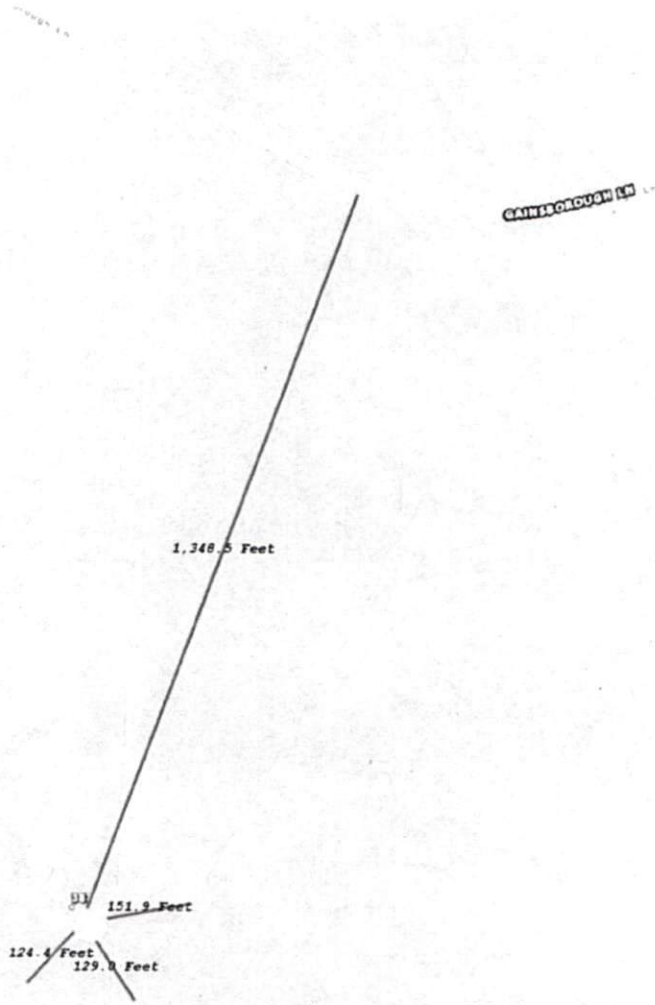



KIMBERLY S. HARGROVE
REGISTER OF DEEDS, HARNETT
305 W. CORNELIUS HARNETT BLVD
SUITE 200
LILLINGTON, NC 27546

PLEASE RETAIN YELLOW TRAILER PAGE

It is part of recorded document, and must be submitted with original for re-recording
and/or cancellation

Filed For Registration: 06/04/2004 02:35:52 PM
Book: PLAT 2004 Page: 516-517
Document No.: 2004010378
MAP 2 PGS \$21.00
Recorder: ELMIRA MCLEAN

State of North Carolina, County of Harnett

KIMBERLY S. HARGROVE, REGISTER OF DEEDS

By Elmira McLean
Deputy/Assistant Register of Deeds



2004010378