

# CERTIFICATE OF COMPLETION / OPERATIONAL PERMIT

Name: (owner) D. G. Langdon & Sons  New Installation  Septic Tank  
Property Location: SR# 1532  Repairs  Nitrification Line  
Subdivision Barclays Lot # 4  
TAX ID# \_\_\_\_\_ Quadrant # \_\_\_\_\_  
Contractor: Ricky Holland Registration # \_\_\_\_\_

Basement with Plumbing:  Garage:   
Water Supply:  Well  Public  Community  
Distance From Well: 100 ft.

Following are the specifications for the sewage disposal system on above captioned property.

Type of system:  Conventional  Other \_\_\_\_\_  
Size of tank: Septic Tank: 1000 gallons Pump Tank: \_\_\_\_\_ gallons  
Subsurface Drainage Field: No. of ditches 1 exact length of each ditch 330 ft. width of ditches 3 ft. depth of ditches 1824 in.  
French Drain: \_\_\_\_\_ Linear feet

PERMIT NO. 10061 Date: 3-18-96  
Inspected by: Thomas J. Boyer R.S.  
Environmental Health Specialist

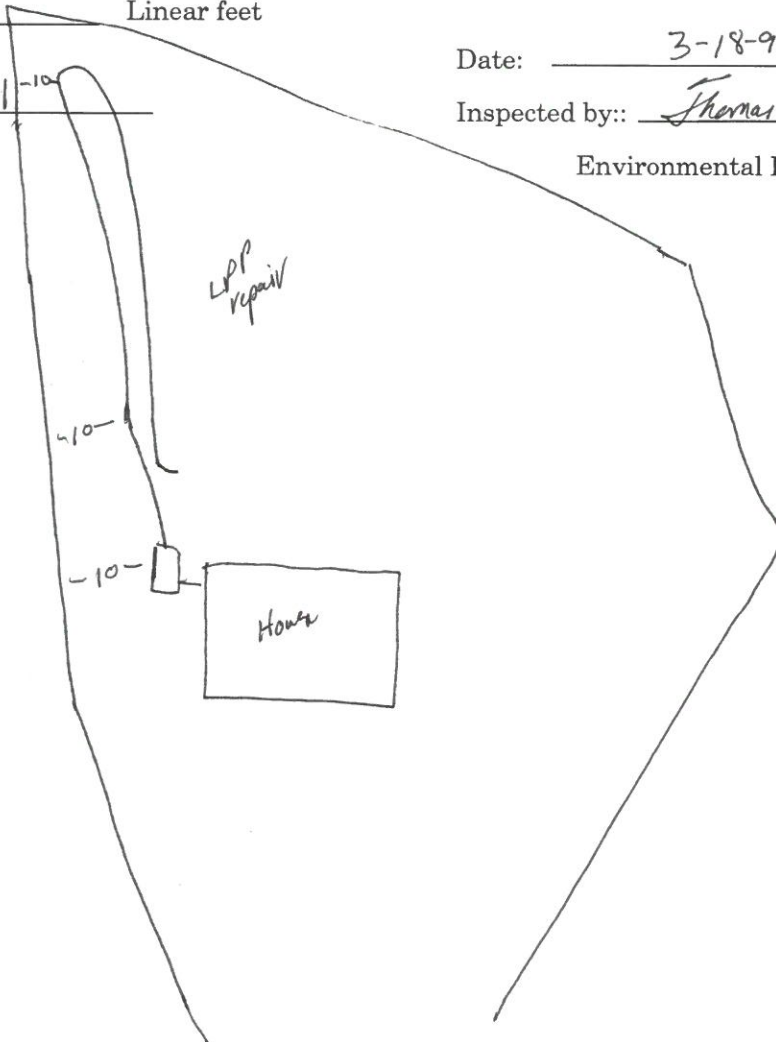

# IMPROVEMENT PERMIT

Be it ordained by the Harnett County Board of Health as follows: Section III, Item B. "No person shall begin construction of any building at which a septic tank system is to be used for disposal of sewage without first obtaining a written permit from the Harnett County Health Department".

Name: (owner) D.G. Karpman & Sons  New Installation  Septic Tank  
Property Location: SR# 1522  Repairs  Nitrification Line

Subdivision Borelays Lot # 6

Tax ID# \_\_\_\_\_ Quadrant # \_\_\_\_\_

Number of Bedrooms Proposed: 3 Lot Size: 1.37 ac

Basement with Plumbing:  Garage:   
Water Supply:  Well  Public  Community  
Distance From Well: 100 ft.

Following is the minimum specifications for sewage disposal system on above captioned property. Subject to final approval.

Type of system:  Conventional  Other \_\_\_\_\_  
Size of tank: Septic Tank: 1000 gallons Pump Tank: \_\_\_\_\_ gallons  
Subsurface Drainage Field No. of ditches 2 exact length of each ditch 150 ft. width of ditches 3 ft. depth of ditches 14-22 in.  
French Drain required: \_\_\_\_\_ Linear feet

This permit is subject to revocation if site plans or intended use change.

Date: 9-29-95  
Signed: Thomas J. Boyer R.S.  
Environmental Health Specialist

VOID AFTER 5 YEARS

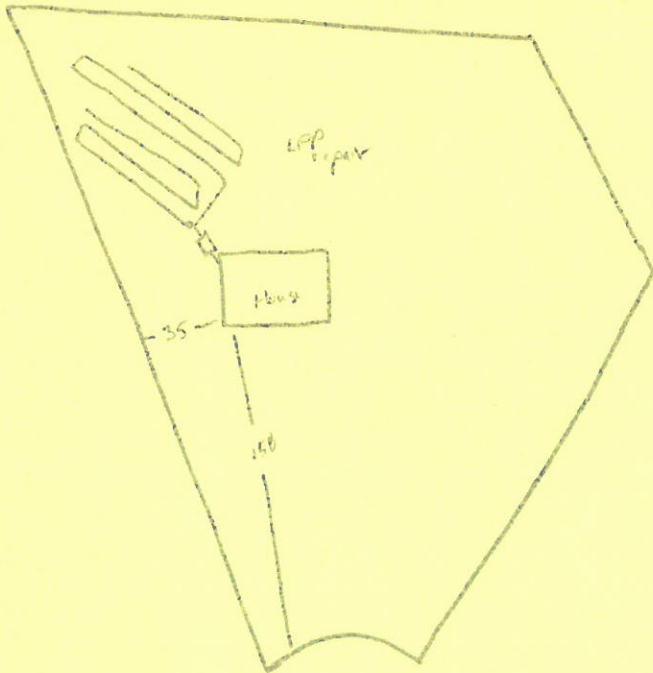

Maintain setbacks  
May require pump if ditch depths  
can not be maintained