

# OPERATIONS PERMIT

Name: (owner) Sharon Phellege  New Installation  Septic Tank  
 Property Location: SR# 1705 Fairground  Repairs  Nitrification Line  
 Subdivision Everdell sect 7 Lot # 4  
 TAX ID# \_\_\_\_\_ Quadrant # \_\_\_\_\_  
 Contractor: Harold Strickland Registration # \_\_\_\_\_

Basement with Plumbing:  Garage:   
 Water Supply:  Well  Public  Community  
 Distance From Well: 50' ft.

Following are the specifications for the sewage disposal system on above captioned property.

Type of system:  Conventional  Other \_\_\_\_\_

Size of tank: Septic Tank: 1000 gallons Pump Tank: \_\_\_\_\_ gallons

Subsurface No. of exact length width of depth of  
 Drainage Field ditches 4 of each ditch 75 ft. ditches 3 ft. ditches 18-20 in.

French Drain: \_\_\_\_\_ Linear feet

Date: 5-6-02

PERMIT NO. 18765

Inspected by: James E. Markham  
Environmental Health Specialist

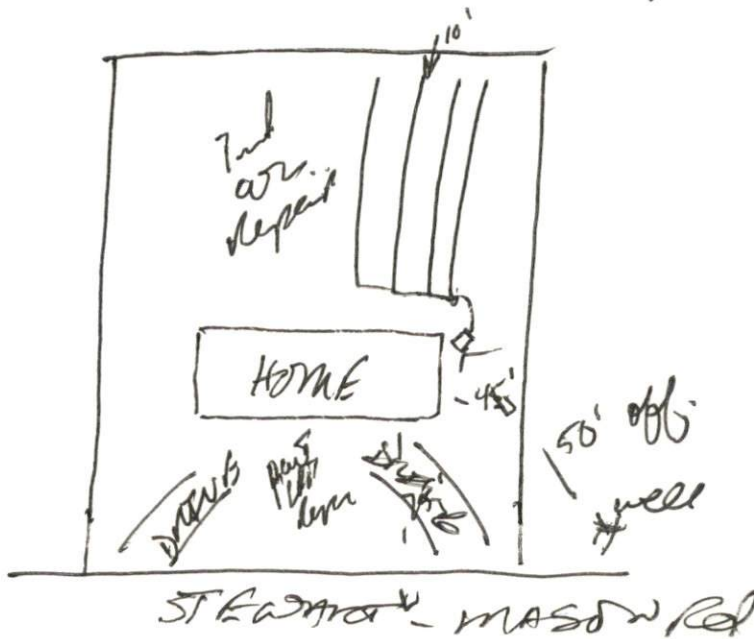

# 01-5-3710

HARNETT COUNTY HEALTH DEPARTMENT

No 18765

IMPROVEMENT PERMIT

Be it ordained by the Harnett County Board of Health as follows: Section III, Item B. "No Person shall begin construction of any building at which a septic tank system is to be used for disposal of sewage without first obtaining a written permit from the Harnett County Health Department."

Name: (owner) Sharon Phillippe

New Installation  Septic Tank

Property Location: SR# 1705 Fairwood

Repairs  Nitrification Line

Subdivision Ernest Lee Sub 2 Lot # 4

Tax ID # \_\_\_\_\_ Quadrant # \_\_\_\_\_

Number of Bedrooms Proposed: 3 Lot Size: 1 acre

Basement with Plumbing:  Garage:

Water Supply:  Well  Public  Community

Distance From Well: 50' ft.

Following is the minimum specifications for sewage disposal system on above captioned property. Subject to final approval.

Type of system:  Conventional  Other \_\_\_\_\_

Size of tank: Septic Tank: 1000 gallons Pump Tank: \_\_\_\_\_ gallons

Subsurface No. of exact length width of depth of  
Drainage Field ditches 4 of each ditch 75 ft. ditches 3 ft. ditches 18-20 in.

French Drain Required: \_\_\_\_\_ Linear feet

Date: 1-25-02

This permit is subject to revocation if site plans or intended use change.

Signed: James E. Marshall, M.D., P.E.  
Environmental Health Specialist

\* Maintain all setbacks 50'

