

Application # SFD2004-0029

# Harnett County Department of Public Health Site Sketch

Property Location: 485 River Ridge Dr (off SR 1267)

Issued To: Seth Mabus Subdivision \_\_\_\_\_ Lot # \_\_\_\_\_

Authorized State Agent: [Signature] REHS Date: 01-29-2021

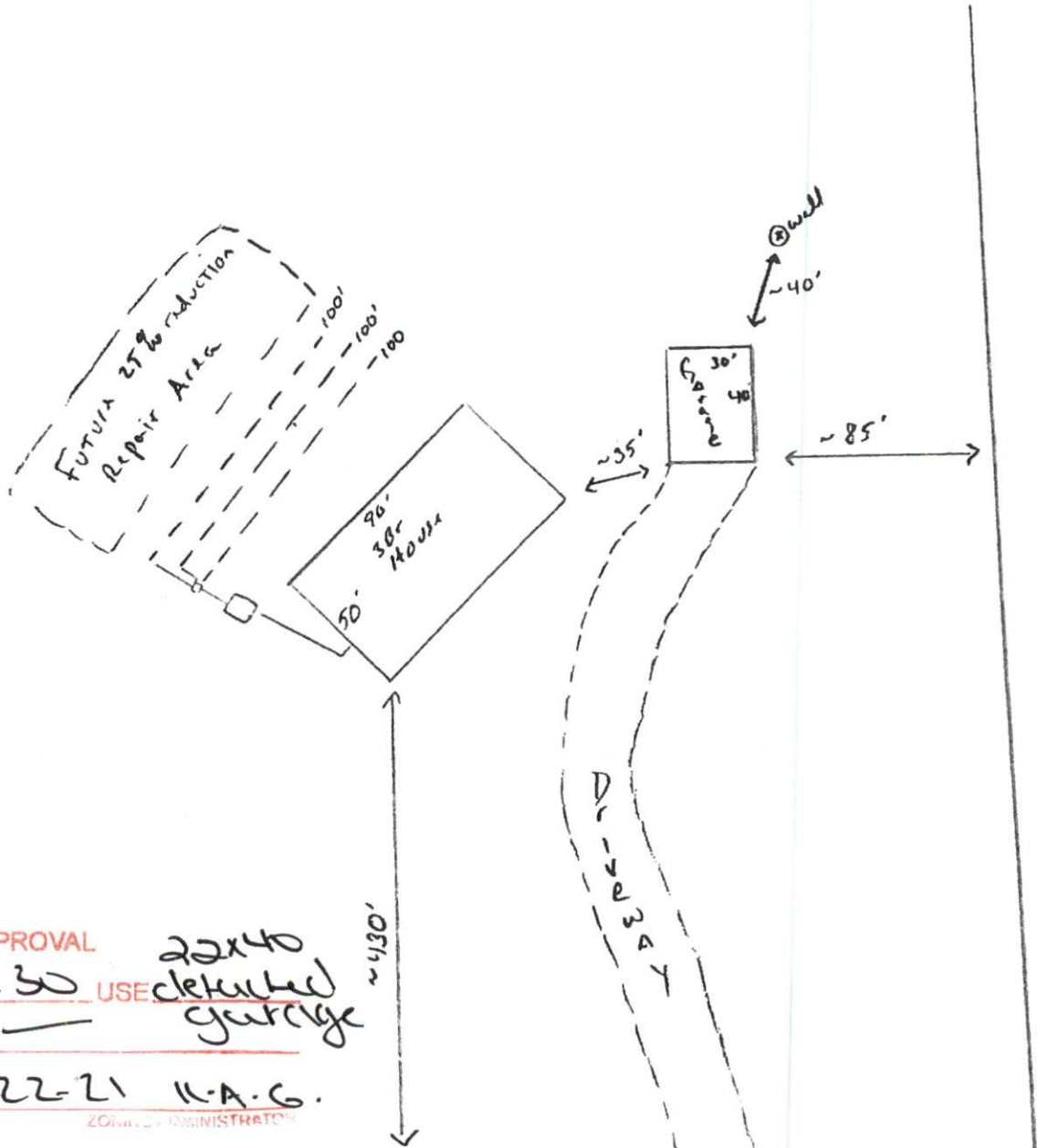

**SITE PLAN APPROVAL**  
DISTRICT: RA 30 USE detached garage  
#BEDROOMS: 2  
2-22-21 K.A.G.  
ZONING ADMINISTRATOR

This drawing is for illustrative purposes only. System installation must meet all pertinent laws, rules, and regulations.

← (TO SR1267) ← River Ridge Dr