

Bres 2012-0094

**SOIL/SITE EVALUATION
 for ON-SITE WASTEWATER SYSTEM**

Owner: Reyes Applicant:

Address: 126 Bradford Ln

Date Evaluated: 1-17-21

Design Flow (.1949): 4 PG GPD

Property Size:

Proposed Facility:
 Location of Site:

Property Recorded:

Water Supply:

Public Individual Well Spring Other

Evaluation Method: Auger Boring

Pit Cut

Type of Wastewater:

Sewage Industrial Process Mixed

P R O F I L E #	.1940 Landscape Position/ Slope %	Horizon Depth (In.)	SOIL MORPHOLOGY .1941		OTHER PROFILE FACTORS				Profile Class & LTAR
			.1941 Structure/ Texture	.1941 Consistence Mineralogy	.1942 Soil Wetness/ Color	.1943 Soil Depth (IN.)	.1956 Sapro Class	.1944 Restr Horiz	
1	L 2-5%	0-24	LS	Gr	10YR6/2 @ 30"	>48"			PS .4 Group III
		24-48	sci	SBk					
2	L 2-5%	0-20	LS	Gr	10YR6/2 @ 26"	>48"			PS .4 Group III
		20-48	sci	SBk					
3	L 2-5%	0-14	LS	Gr	10YR6/1 @ 28"	>48"			PS .4 Group III
		14-48	sci	SBk					
4	L 2-5%	0-20	LS	Gr	10YR6/2 @ 32"	>48"			PS .4 Group III
		20-48	sci	SBk					
5	L 2-5%	0-14	LS	Gr	10YR6/2 @ 30"	>48"			PS .4 Group III
		14-48	sci	SBk					

Description	Initial System	Repair System	Other Factors (.1946): Site Classification (.1948): PS Evaluated By: MDR EHS Others Present:
Available Space (.1945)	✓	✓	
System Type(s)	252 rwd	252 rwd	
Site LTAR	.4	.4	

COMMENTS: _____

LANDSCAPE POSITIONS	GROUP	TEXTURES	.1955 LTAR	CONSISTENCE MOIST	WET
R-RIDGE	I	S-SAND	1.2 - 0.8	VFR-VERY FRIABLE	NS-NON-STICKY
S-SHOULDER SLOPE		LS-LOAMY SAND		FR-FRIABLE	SS-SLIGHTLY STICKY
L-LINEAR SLOPE	II	SL-SANDY LOAM	0.8 - 0.6	FI-FIRM	S-STICKY
FS-FOOT SLOPE		L-LOAM		VFI-VERY FIRM	VS-VERY STICKY
N-NOSE SLOPE		SI-SILT		EFI-EXTREMELY FIRM	NP-NON-PLASTIC
H-HEAD SLOPE	III	SIL-SILT LOAM	0.6 - 0.3	CL-CLAY LOAM	SP-SLIGHTLY STICKY
CC-CONCLAVE SLOPE		CL-CLAY LOAM		P-PLASTIC	
CV-CONVEX SLOPE		SCL-SANDY CLAY LOAM		VP-VERY PLASTIC	
T-TERRACE					
FP-FLOOD PLAN	IV	SIC-SILTY CLAY	0.4 - 0.1	C-CLAY	
		SC-SANDY CLAY			

STRUCTURE
 SG-SINGLE GRAIN
 M-MASSIVE
 CR-CRUMB
 GR-GRANULAR
 SBK-SUBANGULAR BLOCKY
 ABK-ANGULAR BLOCKY
 PL-PLATY
 PR-PRISMATIC

MINERALOGY
 SLIGHTLY EXPANSIVE
 EXPANSIVE

Show profile locations and other site features (dimensions, references or benchmarks, and North)

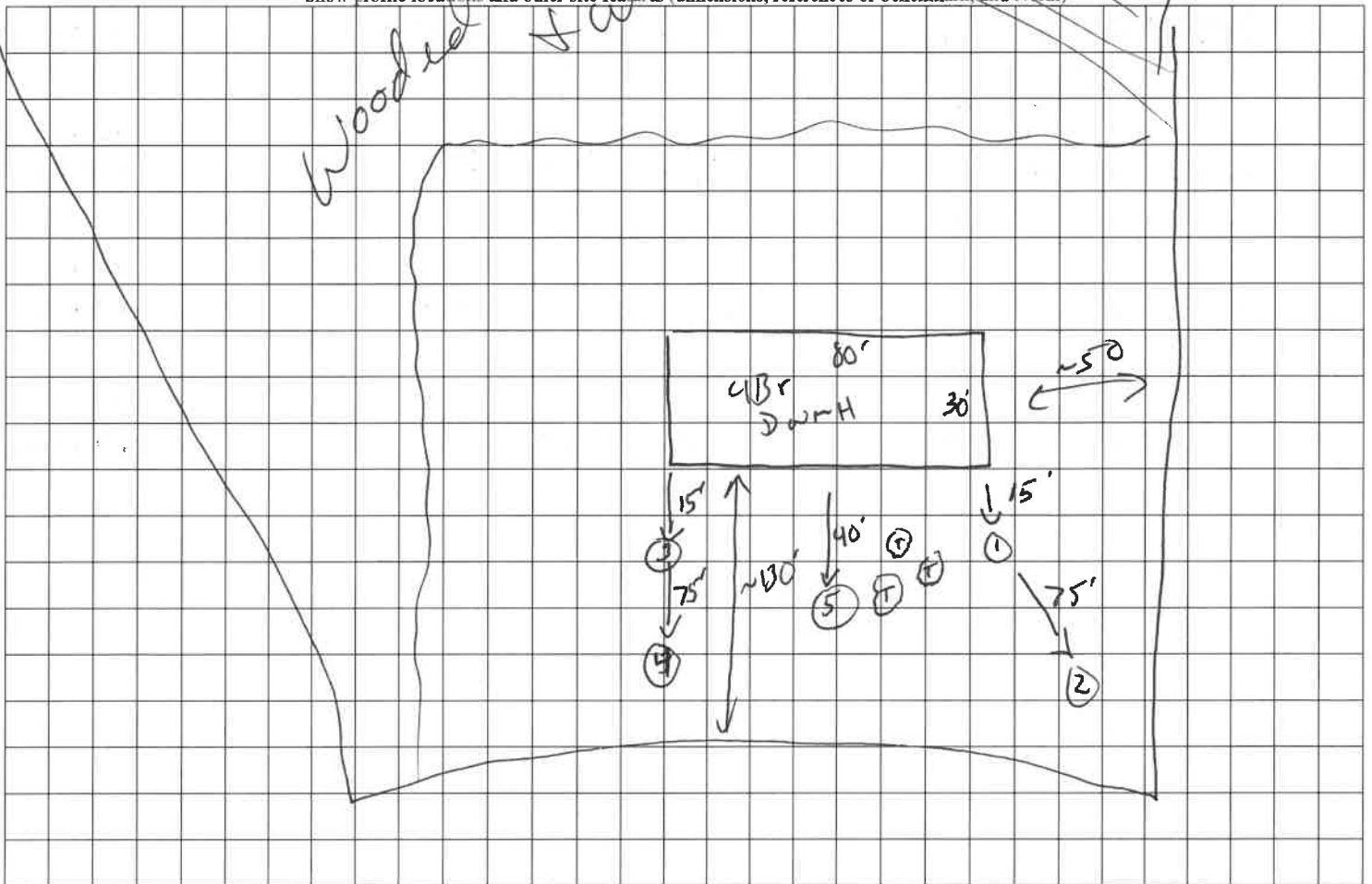

- Remove 3 trees in front yard

- Recommend move Drive way all the way left