

Legend

Foundation



Pipe Pier



Reference

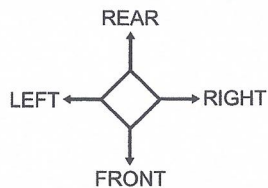

Note

-Footings are to be 12" below grade, 10" thick, 16"x16".

-Girder: (3) 2"x8" or steel I-beam 6"x 2"x 1/4".

12.18.20



2-7/8" PIPE PIERS
ON 16" x 16" x 10"
CONC. FTG. TYP.,
12" BELOW GRADE

(3) 2" x 8"
GIRDERS

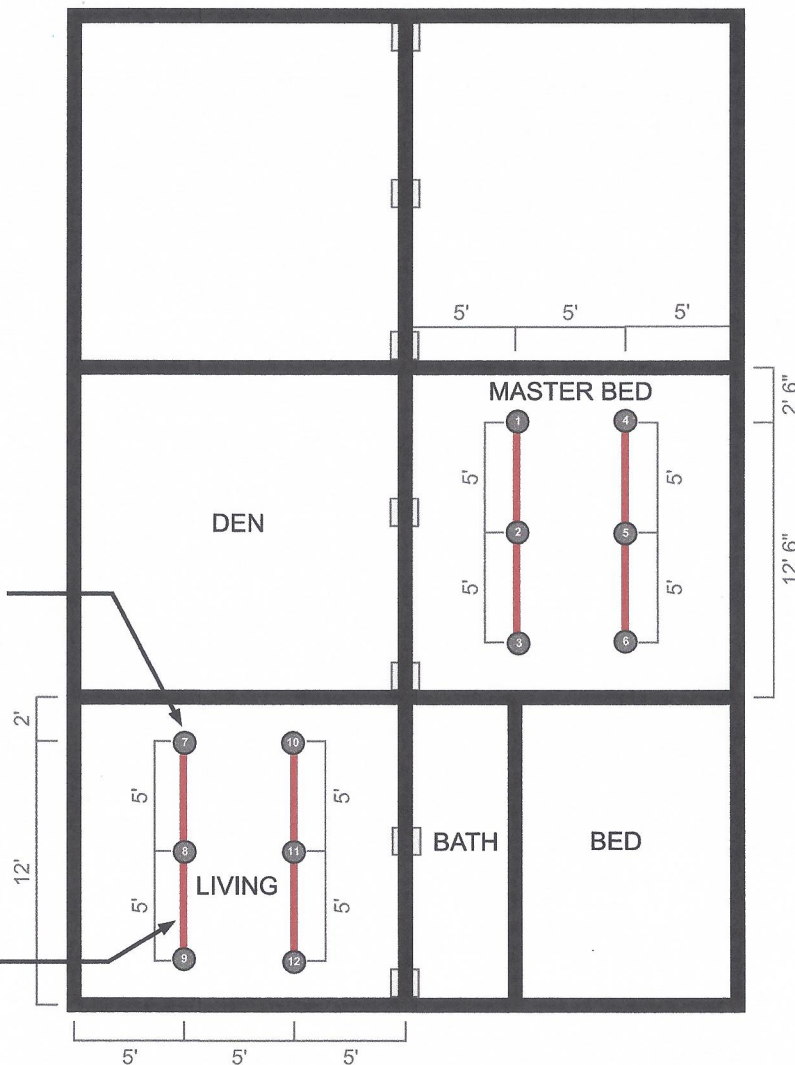

Job Number: GFE-20-216

Laura Santarelli - 3413 NC-210 Lillington, NC 27546



Ground Force Engineering, PLLC
4122 Bennett Memorial Rd Suite 300
Durham, NC 27705

Created By:
Clay Wagner - Engineering Technician
Phone: (984) 484-0495
Date: 12-18-20

Client:
Foundation Solutions LLC DBA Ram Jack
4122 Bennett Memorial Rd. Suite #304
Durham, NC 27705