

Harnett GIS

NOT FOR LEGAL USE



Harnett County GIS, Harnett County Public Utilities



GIS/E-911 Addressing
December 2, 2020

- | | | | |
|-------------------------------|-------------------------|--------------|---------|
| Recycle Center | Harnett County Boundary | NC | Parcels |
| Landfills | Address Numbers | US | |
| Surrounding County Boundaries | Airport | Roads | |
| Federal Property | Major Roads | Mile_Markers | |
| City Limits | Interstate | Railroad | |

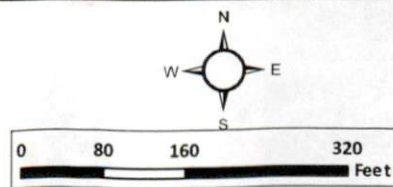

1 inch = 188 feet

LEGEND
 LINES NOT SURVEYED
 LINES SURVEYED
 EIP-----EXISTING IRON PIPE
 ECM-----EXISTING CONCRETE MONUMENT
 EIS-----EXISTING IRON STAKE
 EPN-----EXISTING P.N.NAIL
 ELS-----EXISTING LIGHTWOOD STAKE
 NIS-----NEW IRON STAKE NIP-----NEW IRON PIPE
 PMS-----P.N.NAIL SET
 ERSS-----EXISTING RAILROAD SPIKE
 NRRS-----NEW RAILROAD SPIKE
 EMN-----EXISTING MAGNETIC NAIL
 NMN-----NEW MAGNETIC NAIL
 ECS-----EXISTING COTTON SPINDLE
 NCS-----NEW COTTON SPINDLE
 EP/ES-----CONTROL CORNERS
 ECM/PMN/ECS (CONTROL CORNERS)
 C/L-----CENTER LINE N/T-----NOW OR FORMALLY
 CP-----CALCULATED POINT
 CBAD-----CHORD BEARING AND DISTANCE
 D.E-----DRAINAGE EASEMENT R/W-----RIGHT OF WAY
 EX-----EXISTING AC-----ACRES T-----TOTAL

NORTH REFERENCE MOP PLAT BK:2014,PG:213

A PORTION OF
 RANDY G. SMITH
 KELLY S. BAIN
 DEED BOOK 275,PAGE 319
 DEED BOOK 1280,PAGE 984
 92-E-187 11-E-235 13-E-322
 PIN 0632-48-3572.000
 PID 050633 0005

JAMIE T. SMITH
 CHRISTIAN BROOK SMITH
 DEED BOOK 3556,PAGE 0001
 MAP PLAT BOOK 2017,PAGE 273
 PIN 0633-41-6722.000
 PID 050600 0005 03

③
 1.74 AC.
 + 0.32 AC.
 2.06 AC.TOTAL
 - 0.26 AC.R/W
 1.80 AC.NET
 N 84°07'55"W
 276.97'
 0.32 AC.
 S 82°52'02"E
 149.80'

JAY R. SMITH
 MELISSA H. SMITH
 DEED BOOK 3245,PAGE 676
 MAP PLAT BOOK 2014,PAGE 213
 PIN 0633-41-9732.000
 PID 050633 0005 02

②
 2.41 AC.
 + 4.93
 7.34 AC.TOTAL
 - 0.42 AC.R/W
 6.92 AC.NET
 S 76°13'19"E
 217.76'

A PORTION OF
 RANDY G. SMITH
 KELLY S. BAIN
 DEED BOOK 275,PAGE 319
 DEED BOOK 1280,PAGE 984
 92-E-187
 11-E-235
 13-E-322
 PIN 0632-48-3572.000
 PID 050633 0005

4.93 AC.

RANDY G. SMITH & KELLY S. BAIN
 DEED BOOK 275,PAGE 319
 DEED BOOK 1280,PAGE 984
 92-E-187 11-E-235 13-E-322
 PIN 0632-48-3572.000 PID 050633 0005
 303 AC.+- RESIDUAL (GIS)

THE UNDERSIGNED HEREBY ACKNOWLEDGES THAT THE LAND SHOWN ON THIS PLAT IS WITHIN THE ZONING JURISDICTION OF HARNETT COUNTY AND THAT THIS PLAT AND ALLOTMENT IS (MY OR OUR) FREE ACT AND DEED, FOREVER ALL AREAS SHOWN OR INDICATED ON SAID PLAT.

THE UNDERSIGNED HEREBY ACKNOWLEDGES THAT THE LAND SHOWN ON THIS PLAT IS WITHIN THE ZONING JURISDICTION OF HARNETT COUNTY AND THAT THIS PLAT AND ALLOTMENT IS (MY OR OUR) FREE ACT AND DEED, FOREVER ALL AREAS SHOWN OR INDICATED ON SAID PLAT.



Mickey R. Bennett
 MICKEY R. BENNETT
 L - 1514

Mickey R. Bennett, hereby certify that this survey is of equal category, such as the recombination of existing parcels; a court ordered survey; a division of heirs or other exception to the definition of subdivision.

THIS PROPERTY IS EXEMPT FROM HARNETT COUNTY SUBDIVISION REGULATION.

Sarah J. Ribbar 11/5/2020
 HARNETT COUNTY PLANNER

STATE OF NORTH CAROLINA
 COUNTY OF HARNETT
 I, *Jammy Ward*, REVIEW OFFICER OF HARNETT COUNTY, CERTIFY THAT THE MAP OR PLAT TO WHICH THIS CERTIFICATION IS AFFIXED MEETS ALL STATUTORY REQUIREMENTS FOR RECORDING.
 DATE: 11-5-2020 REVIEW OFFICER: *Jammy Ward*

NORTH CAROLINA
 HARNETT COUNTY
 This Map/Plat was presented for registration and recorded in this office on Map Number 2020 - This 5th day of November 2020, at 11:03 o'clock A.M.

KIMBERLY S. HARGROVE, Register of Deeds
 By: *Melinda Wester*, Deputy Register of Deeds

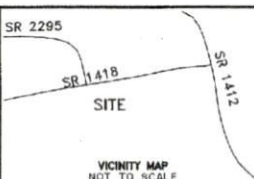

SURVEY FOR: JAY R. SMITH & MELISSA H. SMITH AND JAMIE T. SMITH & CHRISTIAN BROOK SMITH	
TOWNSHIP HECTOR'S CREEK	COUNTY HARNETT
STATE: NORTH CAROLINA	DATE: November 2, 2020
ZONED RA-30	WATERSHED DISTRICT WS-IV
PID #	SEE REFERENCE

BENNETT SURVEYS F-1304 1662 CLARK RD., LILLINGTON, N.C. 27546 (910) 893-5252	
30' 0' 60'	SURVEYED BY: RVB
SCALE: 1" = 60'	DRAWN BY: MRB & RVB
CHECKED & CLOSURE BY: MRB	FIELD BOOK 20751

