

PLANS FOR:
MARILYN BREWER
 1785 HOBSON RD. DUNN, NORTH CAROLINA

HEADER SCHEDULE

HEADER	SIZE	JACKS
H1	(2) 2X10	2
H2	(2) 2X6	1

DOOR SCHEDULE

DOOR NO.	DOOR SIZE	REMARKS
	WIDE HIGH	
D1	2'-0" 6'-8"	INTERIOR DOOR
D2	3'-0" 6'-8"	EXTERIOR DOOR
D3	6'-0" 6'-8"	EXTERIOR SWING DOOR
D4	2'-0" 6'-8"	INTERIOR DOOR

VERIFY ALL DOOR & WINDOW SIZES & STYLES WITH OWNER BEFORE ORDERING MATERIAL.

WINDOW SCHEDULE

DOOR NO.	WINDOW SIZE	REMARKS
	WIDE HIGH	
A	2'-8" 4'-6"	DOUBLE PANE, VINYL WINDOW
B	2'-0" 2'-0"	DOUBLE PANE, VINYL WINDOW (FROSTED GLASS)
C	2'-8" 3'-0"	DOUBLE PANE, VINYL WINDOW

VERIFY ALL DOOR & WINDOW SIZES & STYLES WITH OWNER BEFORE ORDERING MATERIAL.

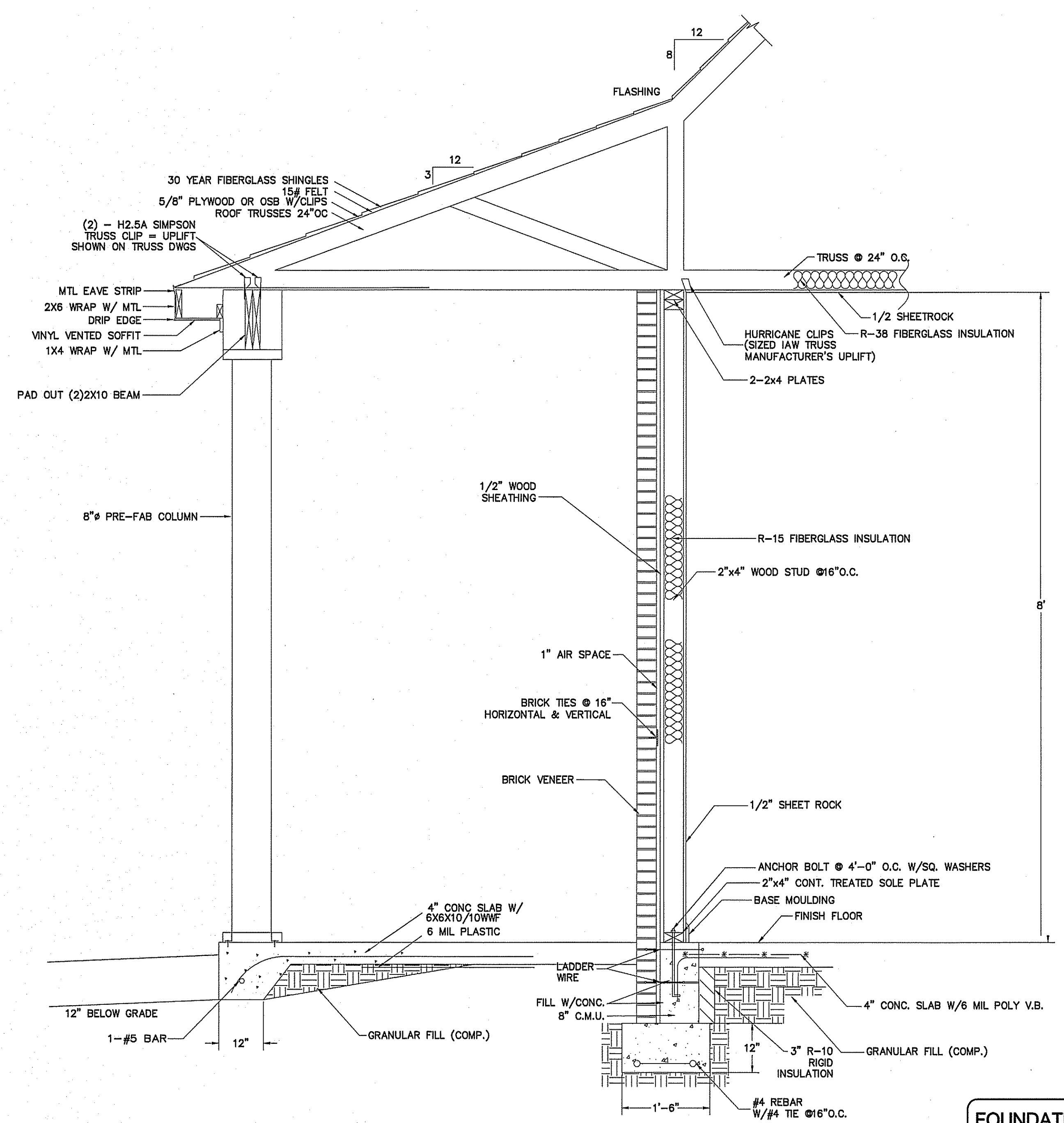

SECTION @ PORCH
NO SCALE

- NOTES:**
- ALLOWABLE SOIL BEARING CAPACITY OF 2000 PSF TO VERIFIED BY CONTRACTOR.
 - CONCRETE TO HAVE A MINIMUM COMPRESSIVE STRENGTH OF 3000 PSI AT 28 DAYS.
 - CONTROL JOINTS TO BE PLACED AS SHOWN ON PLAN.

- NOTE:**
- VERIFY ROOF PITCH WITH OWNER BEFORE ORDERING TRUSSES.
 - MAINTAIN 2" MINIMUM FOOTING PROJECTION EACH SIDE OF FOOTING.
 - TRUSSES BY OTHERS.
 - TRUSS DRAWINGS TO BE DESIGNED BY NORTH CAROLINA REGISTERED PROFESSIONAL ENGINEER.

- FOUNDATION NOTES:**
- FIELD VERIFY THE SIZE, LOCATIONS, ELEVATIONS, AND DETAILS OF ALL EXISTING CONSTRUCTION AND CONDITIONS THAT AFFECT THE WORK AND INFORM THE ENGINEER OF ANY DISCREPANCIES IN DIMENSION SIZES, LOCATIONS AND CONDITIONS BEFORE PROCEEDING WITH THE WORK.
 - PROVIDE ALL SHORING, SHEETING, UNDERPINNING, AND OTHER MEANS REQUIRED TO PROTECT AND MAINTAIN THE SAFETY, INTEGRITY, AND STABILITY OF ALL EXISTING AND NEW CONSTRUCTION THAT MAY BE AFFECTED BY THE WORK.
 - CONCRETE SHALL DEVELOP COMPRESSIVE STRENGTHS (F'C) AT 28 DAYS AS FOLLOWS: FOUNDATIONS, WALLS, FOOTING, ETC. **3000 PSI**
SLABS ON GRADE **3000 PSI**
 - ALL BUILDING FOOTINGS AND FOUNDATIONS ARE DESIGNED BASED UPON A MINIMUM ALLOWABLE SOIL BEARING PRESSURE OF 2000 PSF. IF SUITABLE SOIL CAPABLE OF SUSTAINING THIS CAPACITY IS NOT FOUND AT THE ELEVATIONS INDICATED, THE ENGINEER SHALL BE NOTIFIED AND THE FOUNDATIONS SHALL BE CHANGED IN ELEVATION AND/OR SIZE AS DETERMINED BY THE ENGINEER.
 - CONCRETE BAR REINFORCEMENT SHALL BE NEW BILLET STEEL CONFORMING TO THE STANDARD SPECIFICATION FOR DEFORMED BILLET STEEL BARS FOR CONCRETE REINFORCEMENT ASTM A-615, GRADE 60.
 - ALL STRUCTURAL FILL INSIDE THE BUILDING SHALL BE SELECTED FILL COMPACTED TO 95% MAXIMUM DENSITY AT OPTIMUM MOISTURE CONTENT (ASTM D-698).
 - ALL DETAILING, FABRICATION AND ERECTION OF REINFORCING STEEL SHALL CONFORM TO ACI "MANUAL OF STANDARD PRACTICE FOR DETAILING REINFORCED CONCRETE STRUCTURES" (ACI-315-80).
 - PROVIDE CORNER BARS AT ALL FOOTING CORNERS AND STEPS UNLESS OTHERWISE NOTED. BARS SHALL BE A MINIMUM OF 4'-0" LONG AND HAVE THE SAME SIZE AND SPACING AS HORIZONTAL REINFORCING.
 - WELDED WIRE FABRIC SHALL CONFORM TO ASTM A-185 AND A-82.
 - CONTINUOUS REINFORCING BARS SHALL BE LAPPED 48 BAR DIAMETERS AT ALL SPLICES UNLESS OTHERWISE NOTED.
 - STANDARD CONSTRUCTION JOINTS AND EXPANSION JOINTS SHALL BE LOCATED AS SHOWN ON THE PLANS.
 - ALL CONCRETE SHALL BE PROTECTED AGAINST FREEZING FOR SEVEN DAYS AFTER POURING.
 - FLOOR SLAB TO BE POURED ON 6 MIL POLYETHYLENE FILM OVER 4" THICK DRAINAGE FILL OR OVER EXISTING CONCRETE SLAB.
 - REFER TO MECHANICAL, ELECTRICAL, PLUMBING, AND ARCHITECTURAL DRAWINGS AND CONSULT ALL AFFECTED SUBCONTRACTORS FOR LOCATIONS AND SIZES OF REQUIRED OPENINGS AND CAST-IN-ITEMS IN CONCRETE WORK. ALL OPENINGS ON THE STRUCTURAL DRAWINGS SHALL BE SHOWN ON SHOP DRAWINGS FOR APPROVAL.

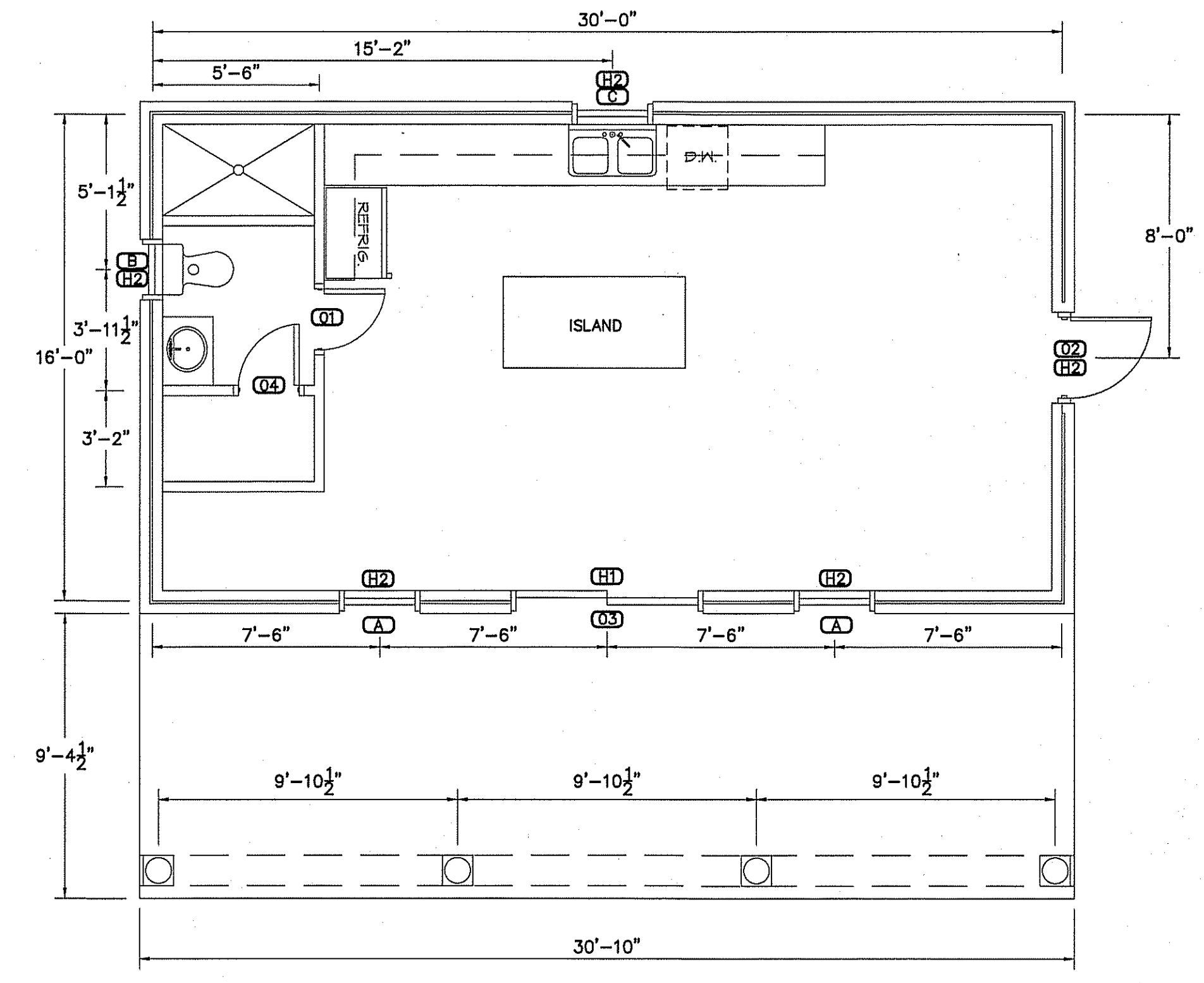

FLOOR PLAN
SCALE: 1/4" = 1'-0"

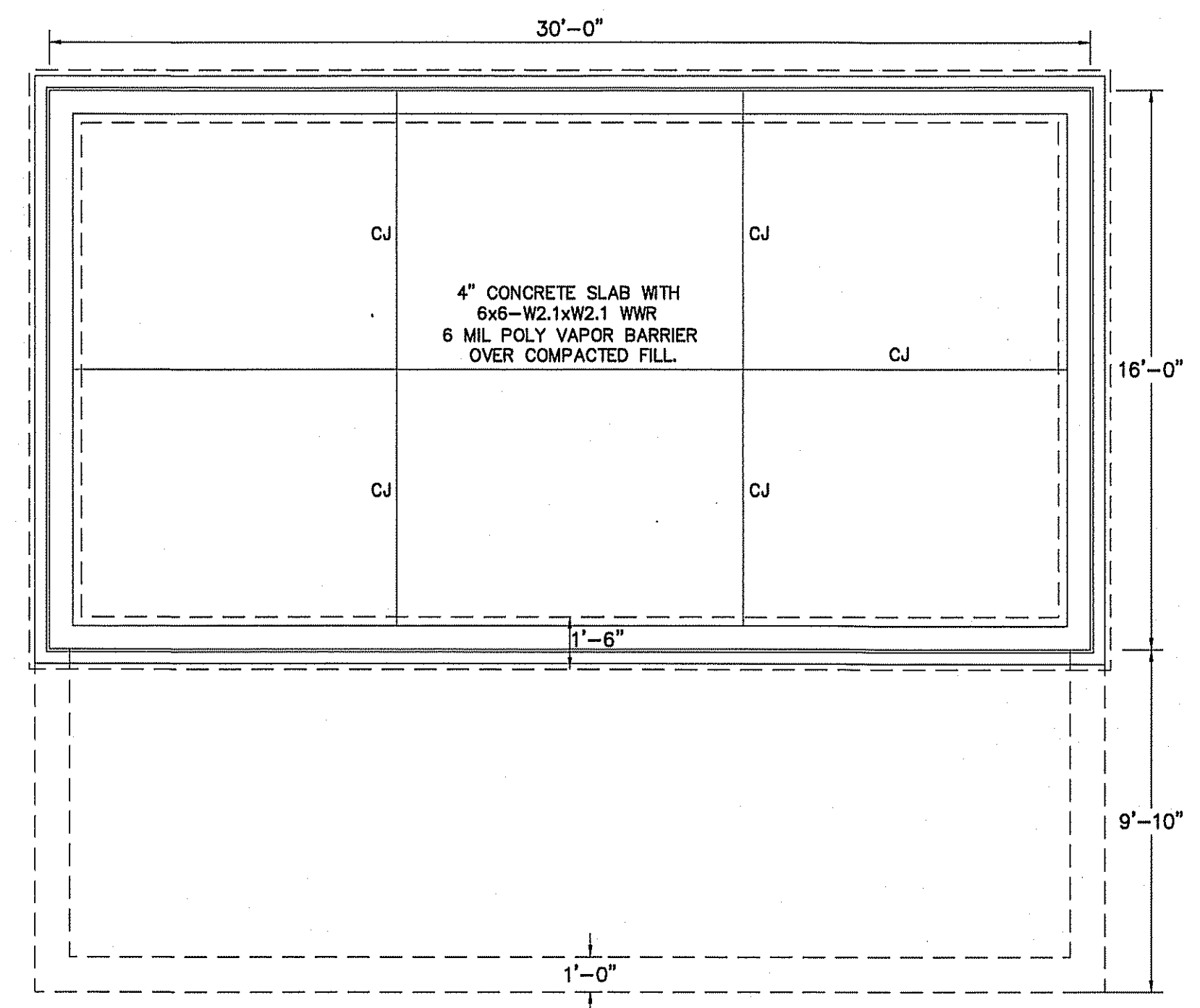

FOUNDATION PLAN
SCALE: 1/4" = 1'-0"

LINTEL SCHEDULE

OPENING	LINTEL	BEARING
0'-0" TO 1'-4"	1 PL-3-1/2 X 3/8 *	8"
1'-4" TO 4'-0"	1 L-3-1/2 X 3-1/2 X 5/16 *	8"
4'-0" TO 6'-8"	1 L-4 X 3-1/2 X 5/16 *	8"
6'-8" TO 8'-0"	1 L-5 X 3-1/2 X 5/16 *	8"

* PER 4" OF WALL THICKNESS

NOTE:
ALL UNSCHEDULED OPENINGS INCLUDING OPENINGS FOR MECHANICAL WORK SHALL BE PROVIDED WITH LINTELS IN ACCORDANCE WITH THIS SCHEDULE. USE THE FOLLOWING N.C. CONCRETE MASONRY ASSOCIATION STYLES OF OF LINTEL BLOCK: NCCMA - #6816-55, #8816-59, #12816-59.

OPENING	5-5/8" OR 7-5/8" WALL	11-5/8" WALL	BEARING
2'-0" TO 4'-0"	7-5/8" [Diagram] 2-#3 2-#3	[Diagram] 2-#3 2-#3	8"
4'-0" TO 5'-4"	7-5/8" [Diagram] 2-#4 2-#5	[Diagram] 2-#4 3-#4	8"
5'-4" TO 8'-0"	7-5/8" [Diagram] 2-#5 2-#6	[Diagram] 2-#5 3-#5	16"

REQUIRED LINTELS NOT OTHERWISE INDICATED ON THE DRAWINGS SHALL BE AS SHOWN IN THE ABOVE SCHEDULE.

REVISIONS

NO.	DESCRIPTION

Cruse And Associates, P.A.
 414 EAST BRUNSON STREET
 FLEMING, NC 27534
 TEL: (910) 932-4429
 FAX: (910) 932-5128
 LICENSE NO.: C-1721

THESE DOCUMENTS ARE INSTRUMENTS OF SERVICE AND AS SUCH THESE DRAWINGS, DESIGNS, AND DESIGN CONCEPTS PRESENTED REMAIN THE PROPERTY OF THE ENGINEER. PUBLISH OR DUPLICATE THE DRAWINGS OR DESIGNS ONLY WITH THE WRITTEN PERMISSION OF THE ENGINEER.
 © COPY RIGHT

DATE 12/23/20
 DRAWN BY BAM
 JOB NO. 20-63

SHEET NO.
F-1 OF 1