

- NOTES:
1. THIS CONCEPTUAL DETAIL IS A GUIDE FOR INSTALLATION OF NICHIIHA PRODUCTS. ARCHITECTS/ENGINEERS/CONTRACTORS ARE RESPONSIBLE FOR SUCCESSFUL APPLICATION WHICH DEPENDS UPON SUBSTRATE DESIGN AND CONSTRUCTION BUILT IN ACCORDANCE WITH BEST PRACTICES AND LOCAL BUILDING CODES.
  2. SHEATHING REPRESENTED HERE IS 1/2" PLYWOOD OR 7/16" OSB. IF USING OTHER THICKNESSES ADJUST ACCORDINGLY.
  3. NICHIIHA PANEL REPRESENTED HERE IS 5/8" NICHIIHA PRODUCT, ADJUST ACCORDINGLY FOR OTHER NICHIIHA PRODUCT THICKNESSES.

TOP OF PANEL  
DETAIL

SUPPORT CLIP  
DETAIL

STARTER TRACK  
DETAIL

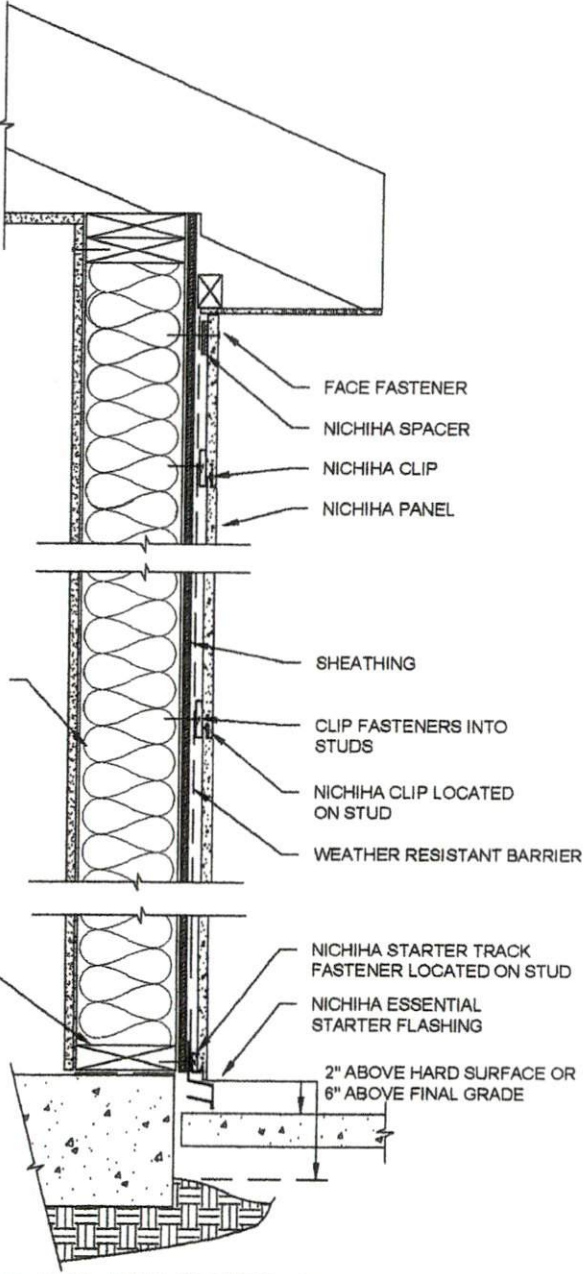

NICHIIHA HORIZONTAL AWP - WALL SECTION - SOFFIT

**WARNING!**

DO NOT CUT OR DAMAGE HEATIZON TUFF CABLE OR IT'S INSULATOR IN ANY WAY

HEATIZON HEATSINK BOARD

WATER PROOFING MEMBRANE - (BITUTHANE RECOMMENDED) TO COMPLETELY COVER HEATSINK BOARD

METAL ROOF SYSTEM

HEATIZON TUFF CABLE IN PRE-CUT GROOVES

HEATIZON CABLE ROTECTOR

ATTACHMENT

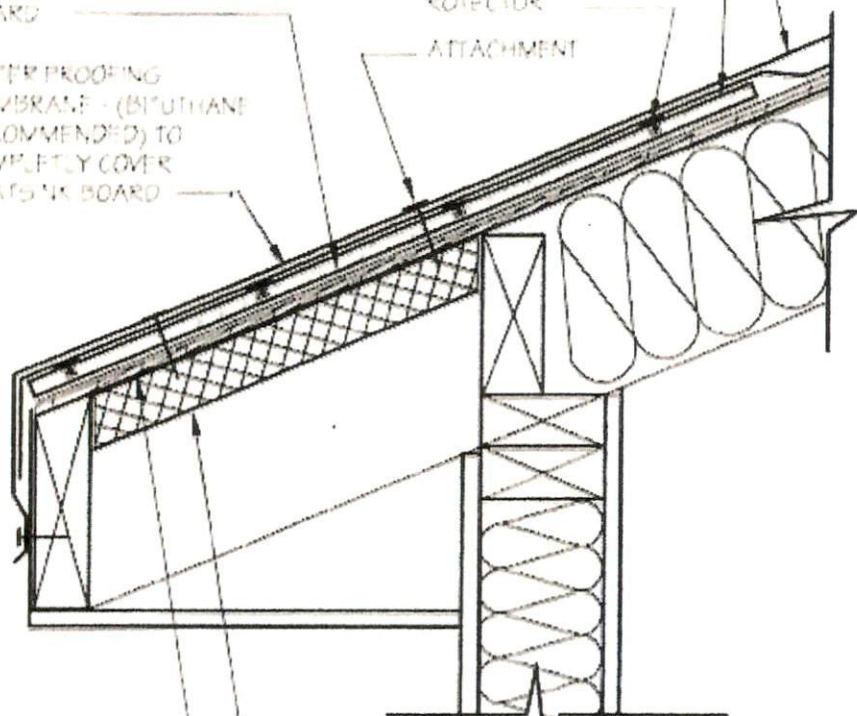

ROOF DECKING

INSULATION - MAI R-5

**NOTE**

ALL ATTACHMENTS FOR ROOFING SYSTEM OR OTHER COMPONENTS SHOULD BE MADE PRIOR TO INSTALLATION OF WATER PROOFING COVERING

DRAWING NO.

**RD-3**

**EAVE DETAIL - TUFF CABLE IN HEATSINK UNDER METAL ROOF**

DRAWING NO.

INC.

DATE

JAN 2009

**HEATIZON SYSTEMS**

*advanced floor heating • advanced ice removal systems*

4403 S. 200 W. • MURRAY, UTAH 84123 • For technical assistance call (801) 293-1232