

## Harnett County Department of Public Health Improvement Permit

A building permit cannot be issued with only an Improvement Permit

PROPERTY LOCATION: 41 Jessica Ct., Sanford NC  
 SUBDIVISION Five Ponds LOT # 27  
 ISSUED TO: Armetha Victoria Simpson  
 NEW  REPAIR  EXPANSION   
 Type of Structure: SFR(76'x28' DWMH)  
 Proposed Wastewater System Type: Pump to 25% reduction  
 Projected Daily Flow: 600 GPD  
 Number of bedrooms: 5 Number of Occupants: 10 max  
 Basement  Yes  No  
 Pump Required:  Yes  No  May be required based on final location and elevations of facilities  
 Type of Water Supply:  Community  Public  Well Distance from well \_\_\_\_\_ feet  
 Permit valid for:  Five years  No expiration  
 Permit conditions: \_\_\_\_\_

Authorized State Agent: *[Signature]* REHS Date: 11-30-2020 SEE ATTACHED SITE SKETCH  
 The issuance of this permit by the Health Department in no way guarantees the issuance of other permits. The permit holder is responsible for checking with appropriate governing bodies in meeting their requirements. This site is subject to revocation if the site plan, plat, or the intended use changes. The Improvement Permit shall not be affected by a change in ownership of the site. This permit is subject to compliance with the provisions of the Laws and Rules for Sewage Treatment and Disposal and to conditions of this permit.

### Construction Authorization (Required for Building Permit)

The construction and installation requirements of Rules .1950, .1952, .1954, .1955, .1956, .1957, .1958, and .1959 are incorporated by references into this permit and shall be met. Systems shall be installed in accordance with the attached system layout.

ISSUED TO: Armetha Victoria Simpson PROPERTY LOCATION: 41 Jessica Ct., Sanford NC  
 SUBDIVISION Five Ponds LOT # 27  
 Facility Type: SFR(76'x28' DWMH)  New  Expansion  Repair  
 Basement?  Yes  No Basement Fixtures?  Yes  No  
 Type of Wastewater System\*\* Pump to 25% reduction (Initial) Wastewater Flow: 600 GPD  
 (See note below, if applicable ) 25% to 50% reduction (Repair)  
**Installation Requirements/Conditions**  
 Septic Tank Size 1250 gallons Number of trenches 6  
 Pump Tank Size 1000 gallons Exact length of each trench 70 feet Trench Spacing: 9 Feet on Center  
 Trenches shall be installed on contour at a Soil Cover: 6 inches  
 Maximum Trench Depth of: 14 inches (Maximum soil cover shall not exceed  
 (Trench bottoms shall be level to +/-1/4" 36" above the trench bottom)  
 in all directions)  
 Pump Requirements: \_\_\_\_\_ ft. TDH vs. \_\_\_\_\_ GPM \_\_\_\_\_ inches below pipe  
 Aggregate Depth: \_\_\_\_\_ inches above pipe  
 Conditions: \_\_\_\_\_ 12 inches total

**WATER LINES (INCLUDING IRRIGATION) MUST BE 10FT. FROM ANY PART OF SEPTIC SYSTEM OR REPAIR AREA.  
 NO UTILITIES ALLOWED IN INITIAL OR REPAIR DRAIN FIELD AREA.**

\*\*If applicable: I understand the system type specified is different from the type specified on the application. I accept the specifications of this permit.

Owner/Legal Representative Signature: \_\_\_\_\_ Date: \_\_\_\_\_

This Construction Authorization is subject to revocation if the site plan, plat, or the intended use changes. The Construction Authorization shall not be transferred when there is a change in ownership of the site. This Construction Authorization is subject to compliance with the provisions of the Laws and Rules for Sewage Treatment and Disposal and to the conditions of this permit. SEE ATTACHED SITE SKETCH

Authorized State Agent: *[Signature]* REHS Date: 11-30-2020  
 Construction Authorization Expiration Date: 11-30-25

Application # BRES2011-0028

## Harnett County Department of Public Health Site Sketch

Property Location: 41 Jessica Ct, Sanford NC

Issued To: Armetha Victoria Simpson

Subdivision Five Ponds

Lot # 27

Authorized State Agent: *[Signature]* RCHS

Date: 11-30-2020

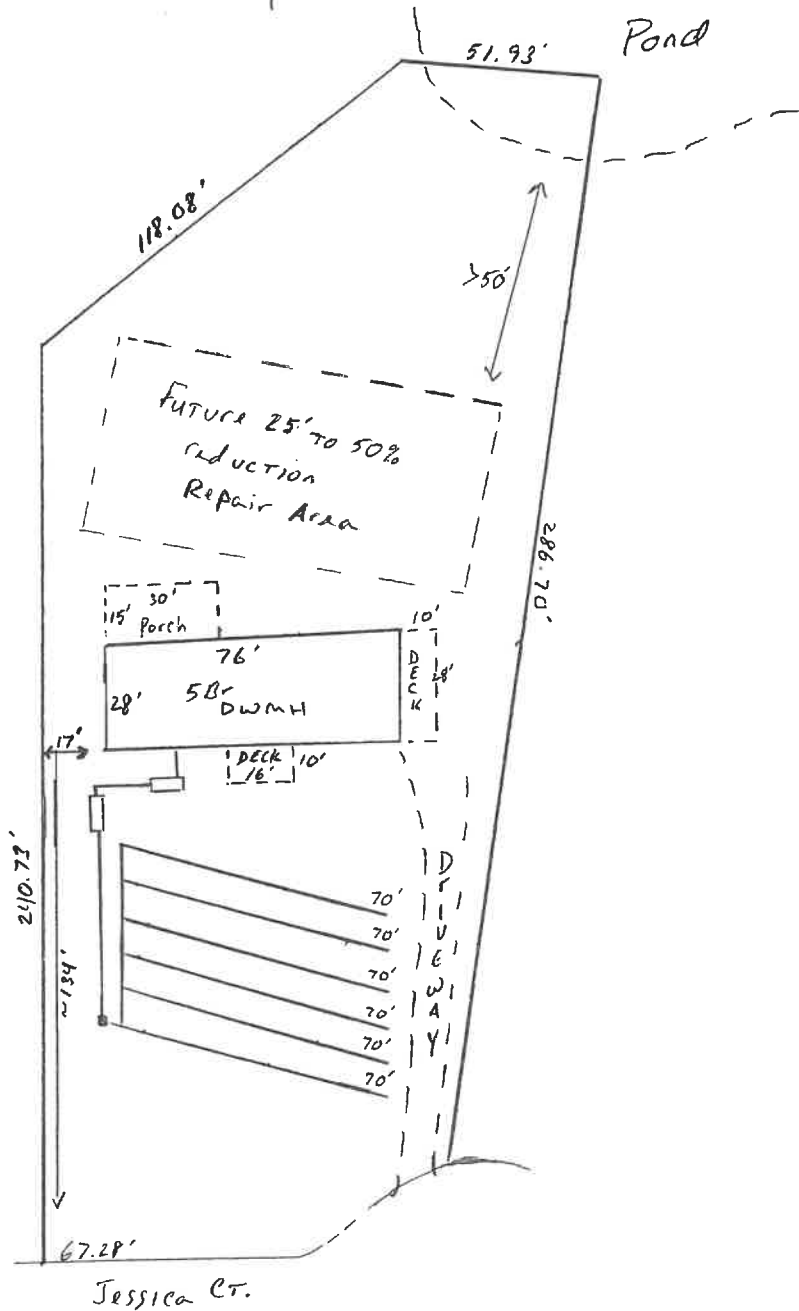

MUST Bring water line Down  
OPPOSITE side OF Driveway  
From septic lines.

This drawing is for illustrative purposes only. System installation must meet all pertinent laws, rules, and regulations.