

PERMIT # 25694

Operation Permit

New Installation  Septic Tank  Repair  Nitrification Liner  
PROPERTY LOCATION: LEMUEL BLACK RD

Name: (owner) QUEST DEV. CO. INC. SUBDIVISION GATEWAY

System Installer: OTIS STRICKLAND Registration # \_\_\_\_\_

Basement with plumbing:  Garage  Number of Bedrooms 3

Type of Water Supply:  Community  Public  Well Distance from well 100 feet

System Type: IIIb Types V and VI Systems expire in 5 years.

(In accordance with Table V a) Owner must contact Health Department 6 months prior to expiration for permit renew

This system has been installed in compliance with applicable North Carolina General Statutes, Rules for Sewage Treatment and Disposal, and all conditions of the Improvement Permit and Constructor

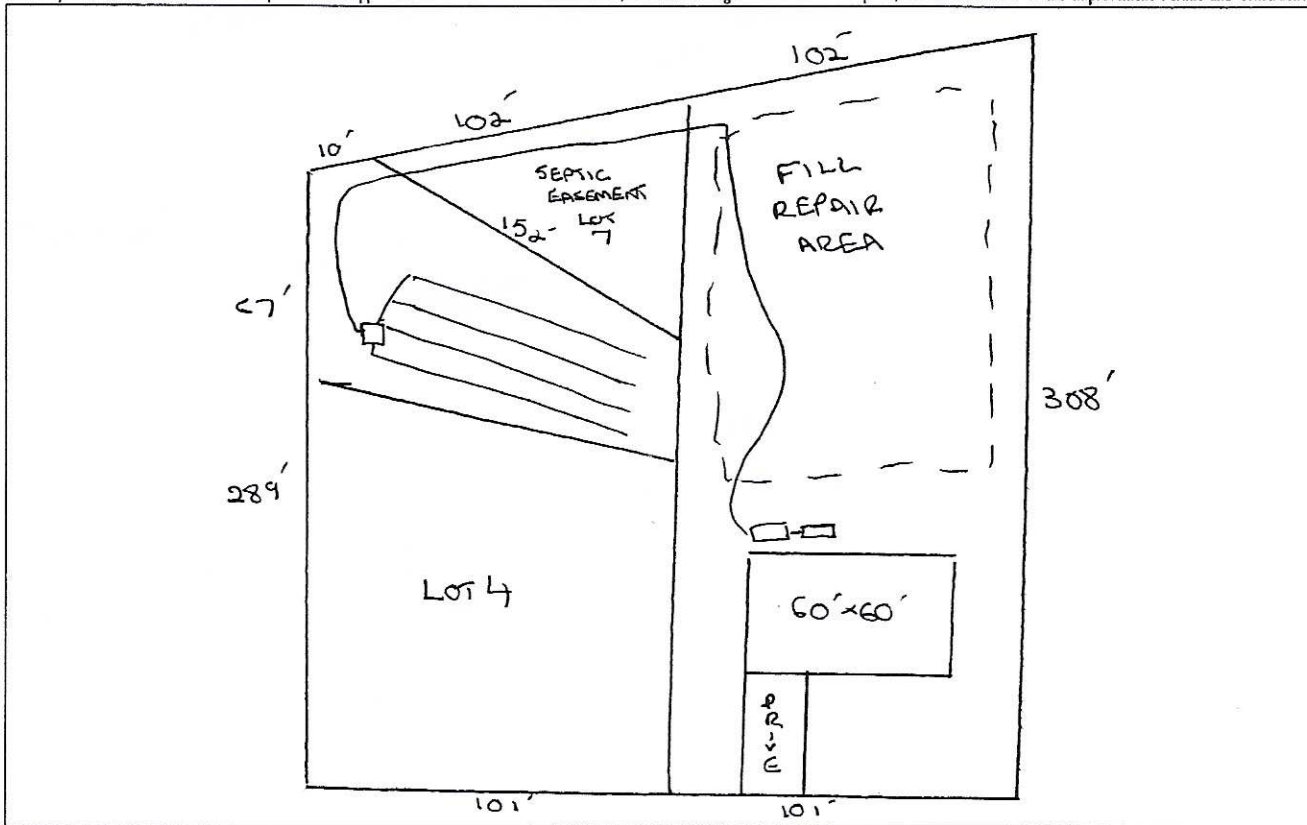

PERMIT CONDITIONS:

- I. Performance: System shall perform in accordance with Rule .1961.
- II. Monitoring: As required by Rule .1961.
- III. Maintenance: As required by Rule .1961. Other: \_\_\_\_\_  
Subsurface system operator required? Yes  No   
If yes, see attached sheet for additional operation conditions, maintenance and reporting.
- IV. Operation: \_\_\_\_\_
- V. Other: SEE RECORDED MAP BOOK 2009 PG 676-677 FOR ALL EASEMENT DIMENSIONS. (MAP ON FILE AT HCHD)

Following are the specifications for the sewage disposal system on the above captioned property.

Type of system:  Conventional  Other PUMP TO EZ FLOW Septic Tank: 1000 gallons Pump Tank: 15  
 Subsurface Drainage Field: No. of ditches 4 exact length of each ditch 60 feet width of ditches 3 feet depth of ditches 18  
 French Drain Required: \_\_\_\_\_ Linear feet

Authorized State Agent [Signature] REWS Date 10/6/09