

Adams Soil Consulting
1676 Mitchell Road
Angier, NC 27501
919-414-6761

September 9, 2020
Project #994

Stephen and Ashley Krol

RE: Preliminary soil/site evaluation for approximately 6.0 acre located adjacent to Jim Christian Road in Harnett County.

Mr. and Ms. Krol,

Adams Soil Consulting (ASC) conducted a preliminary soil evaluation on the above referenced parcel to determine the areas of soils which are suitable for subsurface wastewater disposal systems (conventional & LPP). The soil/site evaluation was performed using hand auger borings during moist soil conditions based on the criteria found in the State Subsurface Rules, 15ANCAC 18A .1900 "Laws and Rules for Sewage Treatment and Disposal Systems". The suitable soil boundary was sketched onto an aerial photograph taken from public data records.

The suitable soils shown on the accompanying soil map are potentially suitable for a conventional type initial and repair septic system for a single-family residence. The area of provisionally suitable soil contains greater than 12,000 ft² of suitable soils that consist of a sandy loam to sandy clay loam subsoil that can support a daily loading rate of 0.3-0.4 gallons/day/ft². The areas for the proposed septic and repair fields shall not be impacted by home sites, pools, garages and shall not be mechanically altered from the natural lay of the land.

The lot will require a detailed soil evaluation by the Harnett County Health Department prior to issuance of any permits related to the septic system. A septic system design may be required before a permit can be issued on the above referenced lot demonstrating available space for the initial and repair septic areas. Due to the subjective nature of the permitting process and the variability of naturally occurring soils, Adams Soil Consulting cannot guarantee that areas delineated as suitable for on-site wastewater disposal systems will be permitted by the governing agency. The lot may require a septic system utilizing pumps, shallow or ultra-shallow conventional trench placement, low pressure pipe system, and/or reductions system for final approval. The accompanying soil map is preliminary in nature, no further assumptions or subdivision should be made without a more detailed evaluation.

If you have any questions regarding the findings on the attached map or in this report, please feel free to contact me anytime. Thank you allowing me to perform this site evaluation for you.

Sincerely,



Alex Adams
NC Licensed Soil Scientist #1247

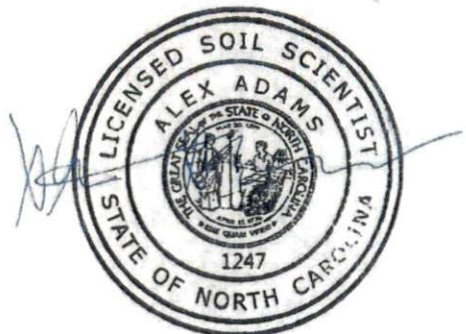

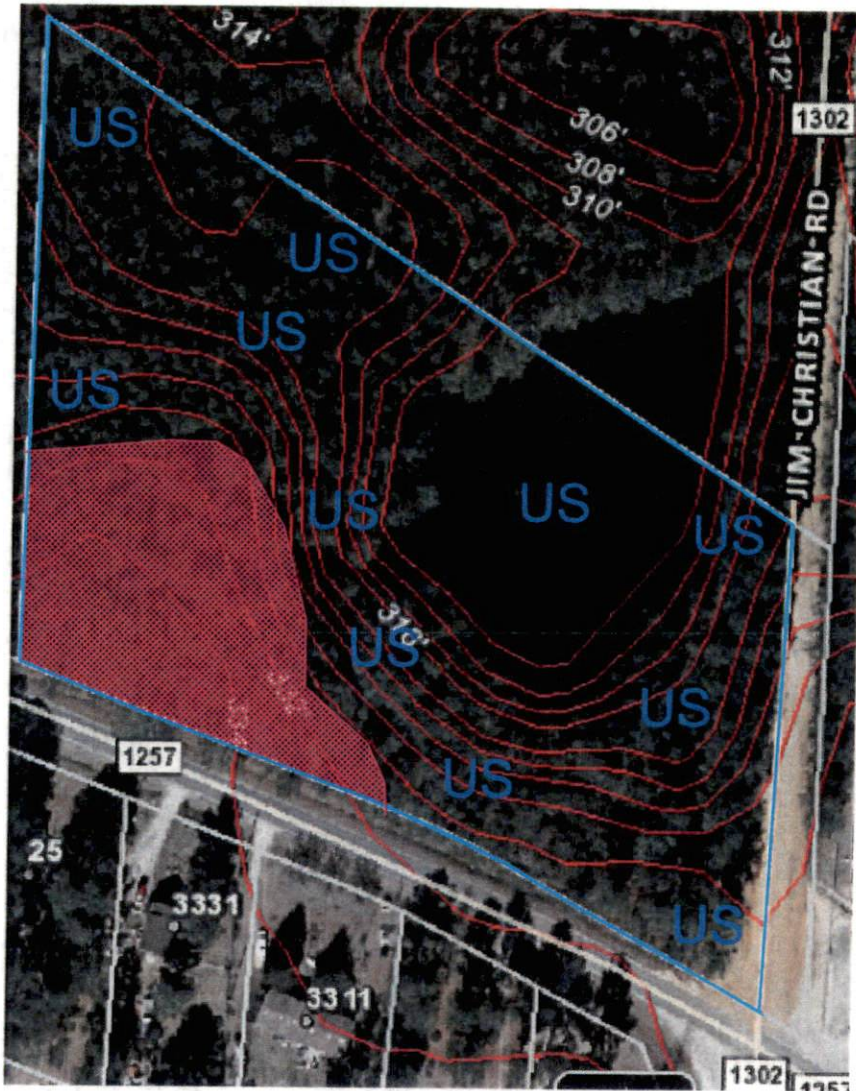

Preliminary Soils Evaluation
 Jim Christian and Joe Collins Road
 ~6.05 acre parcel - Harnett County



*Not a Survey
 (sketched from public records)

Legend

 Areas contain soils with 30 inches or more of useable material and have potential for conventional, modified conventional, LPP or ultra-shallow conventional septic systems. There may be inclusion of soils 24-29 inches to a restrictive horizon that will have potential for LPP septic systems.

 Unsuitable Areas

*Preliminary Soils Evaluation

*Soil boundary was sketched onto a preliminary map of the property taken from public records.

*Not a Survey.

*Septic system setbacks listed below for new lots.

- 1) 10' from property lines.
- 2) 100' from wells for primary systems.
- 3) 50' from surface waters (streams, ponds, lakes).

*Any mechanical disturbances such as grading, cutting and filling of the suitable soil areas can render areas unsuitable for future septic systems.

*See accompanying report for additional information.

*Due to Soil Variability, Adams soil consulting cannot guarantee that the areas shown as suitable will be permitted by the local Health Department.

GRAPHIC SCALE
 1" = 120'



Adams
 Soil Consulting
 919-414-6761
 Project #1004