

# OPERATIONS PERMIT

Name: (owner) DURANE CURRIN  New Installation  Septic Tank  
Property Location: SR# 1557 Silas Moore  Repairs  Nitrification Line  
Subdivision QUAIL Hollow Lot # 9  
TAX ID# \_\_\_\_\_ Quadrant # \_\_\_\_\_  
Contractor: Larry Sharpe Registration # \_\_\_\_\_

Basement with Plumbing:  Garage:

Water Supply:  Well  Public  Community

Distance From Well: 50' ft.

Following are the specifications for the sewage disposal system on above captioned property.

Type of system:  Conventional  Other \_\_\_\_\_

Size of tank: Septic Tank: 1000 gallons Pump Tank: \_\_\_\_\_ gallons

Subsurface Drainage Field No. of ditches 2 exact length of each ditch 150 ft. width of ditches 3 ft. depth of ditches 18-20 in.

French Drain: \_\_\_\_\_ Linear feet

Date: 2-5-99

PERMIT NO. 13079

Inspected by: James E. Mankin JR. P.E.  
Environmental Health Specialist

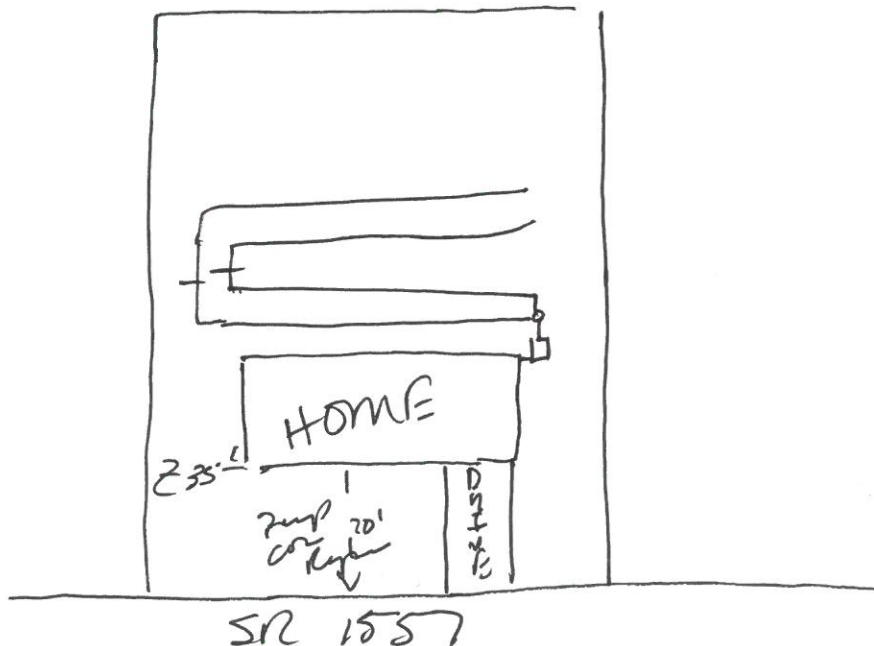

# IMPROVEMENT PERMIT

Be it ordained by the Harnett County Board of Health as follows: Section III, Item B. "No Person shall begin construction of any building at which a septic tank system is to be used for disposal of sewage without first obtaining a written permit from the Harnett County Health Department."

Name: (owner) DURANE CURRAN  New Installation  Septic Tank  
Property Location: SR# 1557 Silas Moore  Repairs  Nitrification Line

Subdivision Quail Hollow Lot # 9

Tax ID # \_\_\_\_\_ Quadrant # \_\_\_\_\_

Number of Bedrooms Proposed: 3 Lot Size: 0.60 Acre

Basement with Plumbing:  Garage:

Water Supply:  Well  Public  Community

Distance From Well: 50' ft.

Following is the minimum specifications for sewage disposal system on above captioned property. Subject to final approval.

Type of system:  Conventional  Other \_\_\_\_\_

Size of tank: Septic Tank: 1000 gallons Pump Tank: \_\_\_\_\_ gallons

Subsurface Drainage Field No. of ditches 2 exact length of each ditch 150 ft. width of ditches 3 ft. depth of ditches 18-20 in.

French Drain Required: - Linear feet

Date: 1-15-98

Signed: James E. Manhart, Esq.  
Environmental Health Specialist

*\*Maintain all setbacks  
\* STAY 50' off of any Well!*

**\*This permit is subject to revocation if site plans or intended use change.**

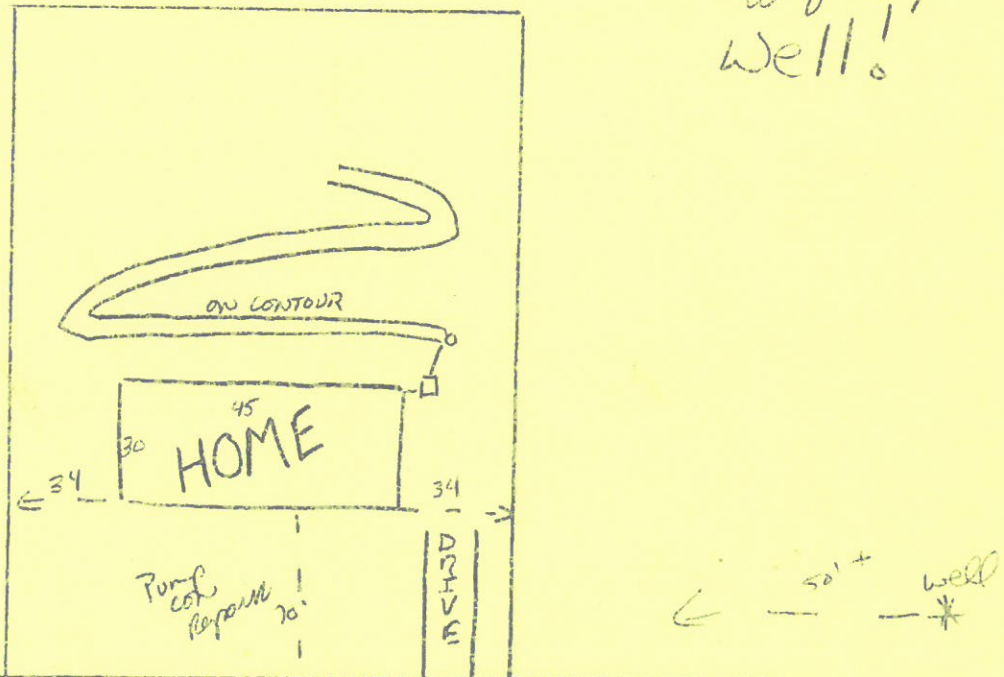

SR 1557