

Harnett County Department of Public Health

Improvement Permit

A building permit cannot be issued with only an Improvement Permit

PROPERTY LOCATION: 216 Clarks Corner Rd. (NC 42 W.)
 SUBDIVISION TATUM & WILKINS LOT # 3

ISSUED TO: Jeremy Taylor

NEW REPAIR EXPANSION RELOCATION Site Improvements required prior to Construction Authorization Issuance:

Type of Structure: Ext. 3-Bedroom SFD + Addition

Proposed Wastewater System Type: 25% Reduction Sys.

Projected Daily Flow: 360 GPD

Number of bedrooms: 3 Number of Occupants: 6 max

Basement Yes No

Pump Required: Yes No May be required based on final location and elevations of facilities

Type of Water Supply: Community Public Well Distance from well NA feet

Permit valid for: Five years No expiration

Permit conditions: _____

Authorized State Agent:  Date: 09/09/2020 SEE ATTACHED SITE SKETCH

The issuance of this permit by the Health Department in no way guarantees the issuance of other permits. The permit holder is responsible for checking with appropriate governing bodies in meeting their requirements. This site is subject to revocation if the site plan, plat, or the intended use changes. The Improvement Permit shall not be affected by a change in ownership of the site. This permit is subject to compliance with the provisions of the Laws and Rules for Sewage Treatment and Disposal and to conditions of this permit.

Construction Authorization

(Required for Building Permit)

The construction and installation requirements of Rules .1950, .1952, .1954, .1955, .1956, .1957, .1958 and .1959 are incorporated by references into this permit and shall be met. Systems shall be installed in accordance with the attached system layout.

PROPERTY LOCATION: 216 Clarks Corner Rd. (NC 42 W.)
 SUBDIVISION TATUM & WILKINS LOT # 3

ISSUED TO: Jeremy Taylor

Facility Type: Ext. 3-Bedroom SFD + Ac New Expansion Repair RELOCATION

Basement? Yes No Basement Fixtures? Yes No

Type of Wastewater System** 25% Reduction System (Initial) Wastewater Flow: 360 GPD

(See note below, if applicable 25% Reduction System (Repair))

Installation Requirements/Conditions	Number of trenches <u>1</u>	
Septic Tank Size <u>Ext.</u> gallons	Exact length of each trench <u>80 (Max)</u> feet	Trench Spacing: <u>9</u> Feet on Center
Pump Tank Size _____ gallons	Trenches shall be installed on contour at a	Soil Cover: <u>8</u> inches
	Maximum Trench Depth of: <u>20</u> inches	(Maximum soil cover shall not exceed
	(Trench bottoms shall be level to +/-1/4" in all directions)	36" above the trench bottom)
Pump Requirements: _____ ft. TDH vs. _____ GPM		Aggregate Depth: <u>NA</u> inches below pipe
		<u>NA</u> inches above pipe
Conditions: <u>Reference Site Plan</u>		<u>NA</u> inches total

**WATER LINES (INCLUDING IRRIGATION) MUST BE 10FT. FROM ANY PART OF SEPTIC SYSTEM OR REPAIR AREA.
 NO UTILITIES ALLOWED IN INITIAL OR REPAIR DRAIN FIELD AREA.**

**If applicable: I understand the system type specified is different from the type specified on the application. I accept the specifications of this permit.

Owner/Legal Representative Signature: _____ Date: _____

This Construction Authorization is subject to revocation if the site plan, plat, or the intended use changes. The Construction Authorization shall not be transferred when there is a change in ownership of the site. This Construction Authorization is subject to compliance with the provisions of the Laws and Rules for Sewage Treatment and Disposal and to the conditions of this permit. SEE ATTACHED SITE SKETCH

Authorized State Agent:  Date: 09/09/2020

Construction Authorization Expiration Date: 09/09/2025

ANDREW CURRAN

Harnett County Department of Public Health Site Sketch

Property Location: 216 Clarks Corner Rd. (NC 42 W.)

Issued To: Jeremy Taylor

Subdivision TATUM & WILKINS

Lot # 3

Authorized State Agent: *Andrew Collins*

ANDREW COLLINS

Date: 09/09/2020

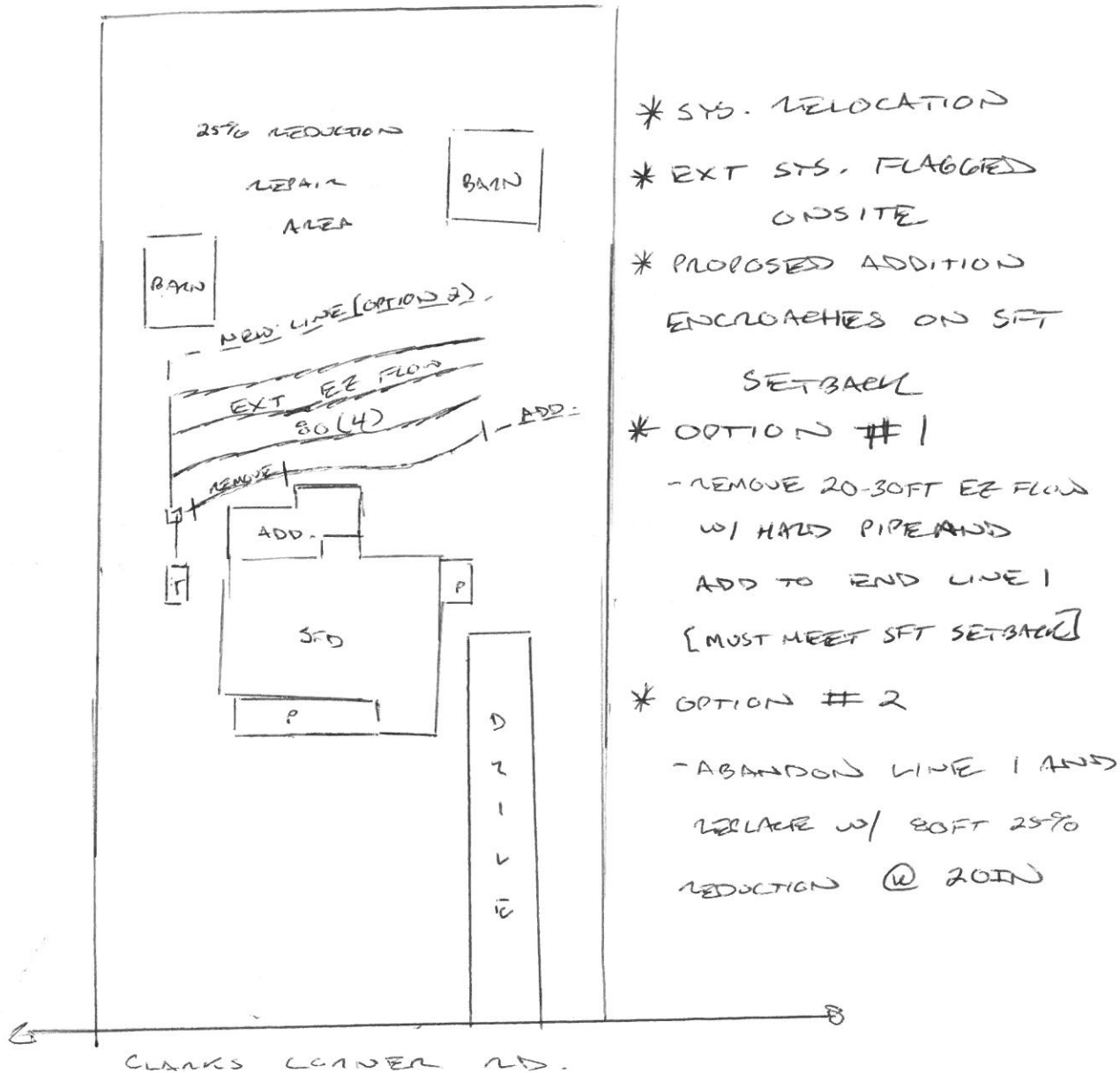

This drawing is for illustrative purposes only. System installation must meet all pertinent laws, rules, and regulations.