

## Harnett County Department of Public Health Improvement Permit

A building permit cannot be issued with only an Improvement Permit

521415

ISSUED TO: KENNON CONSTRUCTION PROPERTY LOCATION: 40 WINDHAM PL. DR. (LAUREL CH. ROAD)  
 SUBDIVISION: WINDHAM PLACE LOT # 3

NEW  REPAIR  EXPANSION  RELOCATION  Improvements required prior to Construction Authorization Issuance:

Type of Structure: 3-BEDROOM EXT SFD

Proposed Wastewater System Type: 25% REDUCTION SIS.

Projected Daily Flow: 366 GPD

Number of bedrooms: 3 Number of Occupants: 6 max

Basement  Yes  No

Pump Required:  Yes  No  May be required based on final location and elevations of facilities

Type of Water Supply:  Community  Public  Well Distance from well NA feet

Permit valid for:  Five years  No expiration

Permit conditions: \_\_\_\_\_

Authorized State Agent: [Signature] Date: 09/22/2020 SEE ATTACHED SITE SKETCH

The issuance of this permit by the Health Department in no way guarantees the issuance of other permits. The permit holder is responsible for checking with appropriate governing bodies in meeting their requirements. This site is subject to revocation if the site plan, plat, or the intended use changes. The Improvement Permit shall not be affected by a change in ownership of the site. This permit is subject to compliance with the provisions of the Laws and Rules for Sewage Treatment and Disposal and to conditions of this permit.

### Construction Authorization (Required for Building Permit)

The construction and installation requirements of Rules 1950, 1952, 1954, 1955, 1956, 1957, 1958, and 1959 are incorporated by references into this permit and shall be met. Systems shall be installed in accordance with the attached system layout.

521415

ISSUED TO: KENNON CONSTRUCTION PROPERTY LOCATION: 40 WINDHAM PL. DR. (LAUREL CH. ROAD)  
 SUBDIVISION: WINDHAM PLACE LOT # 3

Facility Type: EXT 3-BR SFD  New  Expansion  Repair  Relocation

Basement?  Yes  No Basement Fixtures?  Yes  No

Type of Wastewater System\*\* PUMP TO 25% REDUCTION (Initial) Wastewater Flow: 360 GPD  
 (See note below, if applicable )

PUMP TO 50% REDUCTION (Repair)

**Installation Requirements/Conditions**

Septic Tank Size <u>EXT</u> gallons	Number of trenches <u>3</u>	Trench Spacing: <u>9</u> Feet on Center
Pump Tank Size <u>1000</u> gallons	Exact length of each trench <u>80</u> feet	Soil Cover: <u>8</u> inches
	Trenches shall be installed on contour at a	(Maximum soil cover shall not exceed
	Maximum Trench Depth of: <u>20</u> inches	36" above the trench bottom)
	(Trench bottoms shall be level to +/-1/4"	
	in all directions)	

Pump Requirements: \_\_\_\_\_ ft. TDH vs. \_\_\_\_\_ GPM

Aggregate Depth: NA inches below pipe  
NA inches above pipe  
NA inches total

Conditions: PUMP TO MEDIUM D-BOX EQUAL DISTRIBUTION

**WATER LINES (INCLUDING IRRIGATION) MUST BE 10FT. FROM ANY PART OF SEPTIC SYSTEM OR REPAIR AREA.  
 NO UTILITIES ALLOWED IN INITIAL OR REPAIR DRAIN FIELD AREA.**

\*\*If applicable: I understand the system type specified is different from the type specified on the application. I accept the specifications of this permit.

Owner/Legal Representative Signature: \_\_\_\_\_ Date: \_\_\_\_\_

This Construction Authorization is subject to revocation if the site plan, plat, or the intended use changes. The Construction Authorization shall not be transferred when there is a change in ownership of the site. This Construction Authorization is subject to compliance with the provisions of the Laws and Rules for Sewage Treatment and Disposal and to the conditions of this permit. SEE ATTACHED SITE SKETCH

Authorized State Agent: [Signature] Date: 09/22/2020  
ANDREW CURRIN Construction Authorization Expiration Date: 09/22/2025

Application # BRES2008-0017

## Harnett County Department of Public Health Site Sketch

Property Location: 40 WYNDHAM PLACE DR LENOIR CHURCH RD - 521415

Issued To: KENNON CONSTRUCTION Subdivision WYNDHAM PLACE Lot # 3

Authorized State Agent: [Signature] Date: 09/22/2020

ANDREW CURVIN

\* ONSITE MEETING \*  
MAP BE REQUIRED

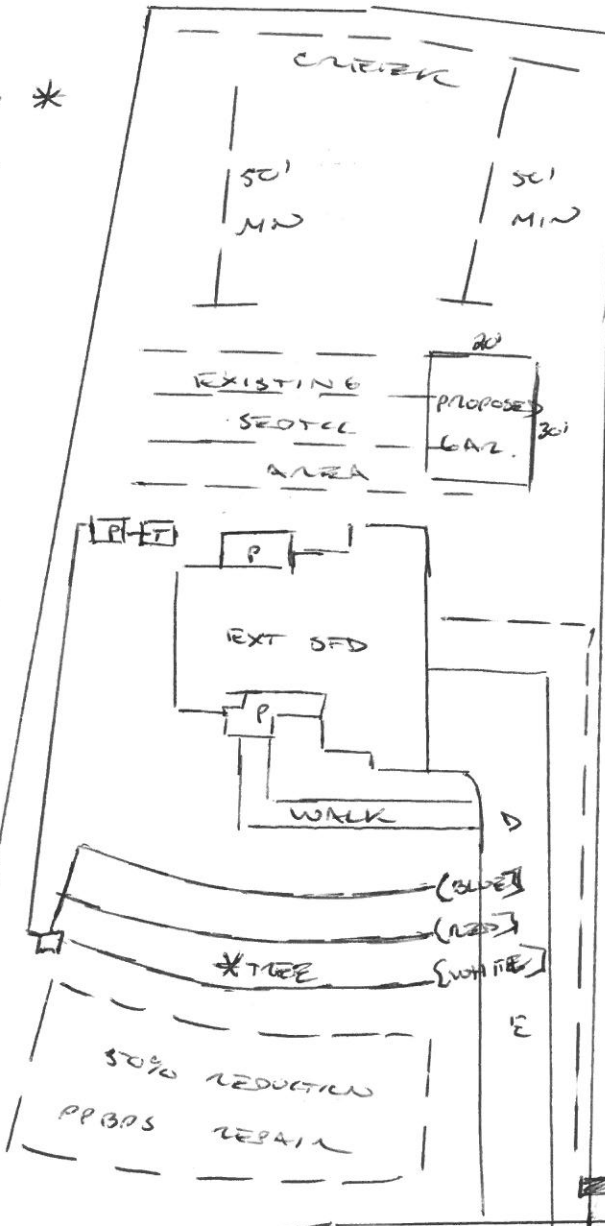

- \* PUMP TO MEDIUM D-BOX W/ EQUAL DISTRIBUTION
- \* SYS. FLAGGED ONSITE
- \* 50% REDUCTION PPBPS REPAIR AREA
- \* RELOCATION FOR GARAGE
- \* EXISTING SEPTIC TANK ADD PUMP TANK
- \* WATER NOT MARKED BY UTILITY PROVIDER - LIKELY WILL REQ. RELOCATION IF NOT ON PROPERTY LINE
- \* CABLE LINES REQ. RELOCATION

This drawing is for illustrative purposes only. System installation must meet all pertinent laws, rules, and regulations.

WYNDHAM PLACE DR.