

FOUNDATION WALL DETAIL

**NOTICE TO CONTRACTOR**  
 All construction must comply with current NC Building Codes and is subject to field inspection and verification.

**APPROVED**  
 Limited building only review  
 Permit holder responsible for full compliance with the code

08/20/2020



See highlighted text second page

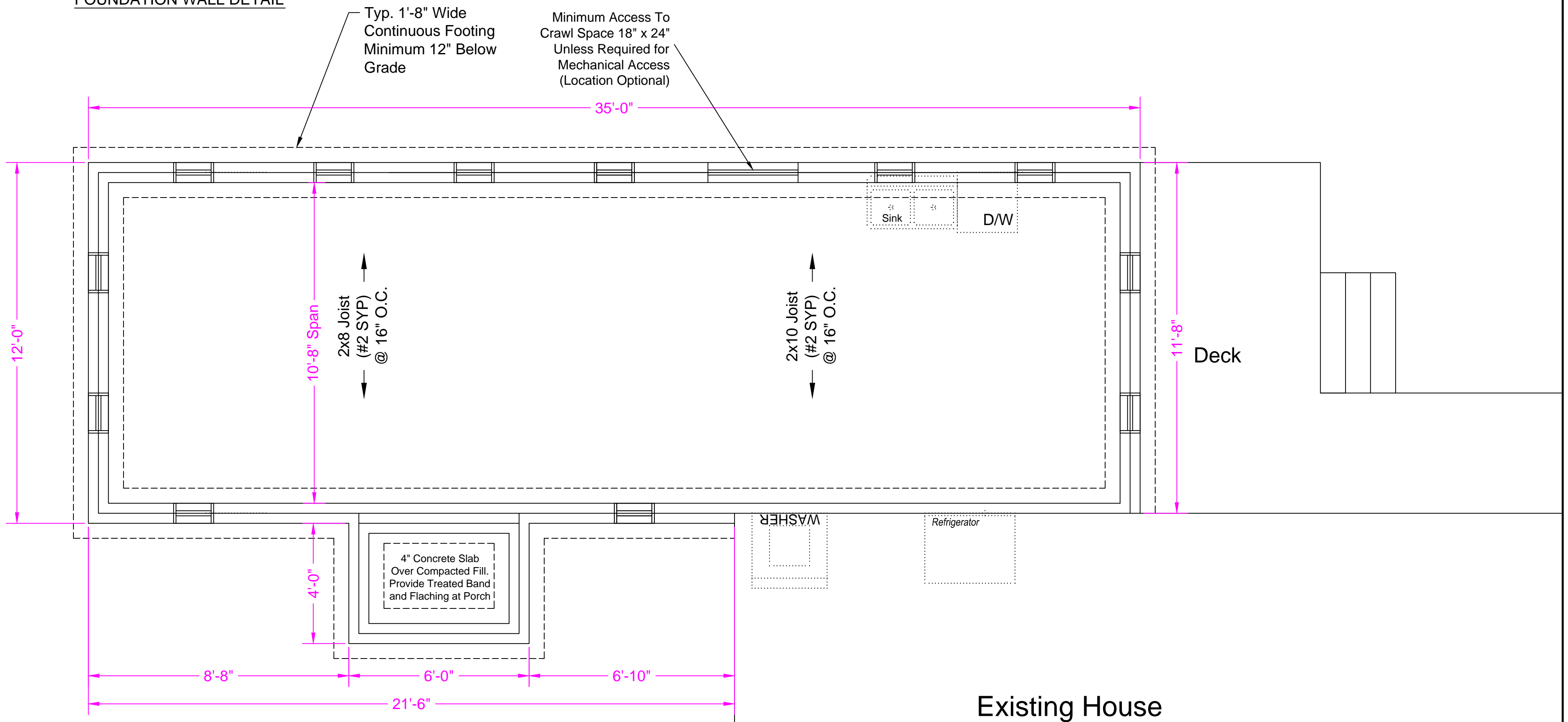

Foundation Plan

IT IS THE SOLE RESPONSIBILITY OF THE CONTRACTOR AND/OR BUILDER TO CONFORM TO ALL STANDARDS, PROVISIONS, REQUIREMENTS, METHODS OF CONSTRUCTION AND USES OF MATERIALS PROVIDED IN BUILDINGS AND/OR STRUCTURES REQUIRED OF THE NC STATE BUILDING CODE, ANY OTHER LOCAL AGENCIES AND IN ACCORDANCE WITH GOOD ENGINEERING AND CONSTRUCTION PRACTICE. VERIFY ALL DIMENSIONS AND CONTACT DESIGNER OF ANY DISCREPANCIES PRIOR TO CONSTRUCTION.



Diversified D-Zees  
 2794 Cone Cir.  
 Fayetteville, NC 28306  
 (910) 322-1401  
 Fax 910-424-2522

GENERAL NOTES:	MATERIAL FINISH:	DESCRIPTION
	REVISION	DATE

DRAWN BY: D. BEHAGG	DATE: 8/13/2020	SCALE: 3/8" = 1'-0"
	CHECKED BY:	
7916 Overhills Rd	FILE :	

REPRODUCTION OF THIS DOCUMENT IS NOT PERMITTED WITHOUT THE EXPRESSED CONSENT OF THE ABOVE COMPANY



Diversified D-Zees  
2794 Cone Cr.  
Fayetteville, NC 28306  
(910) 322-1401  
Fax 910-424-2522

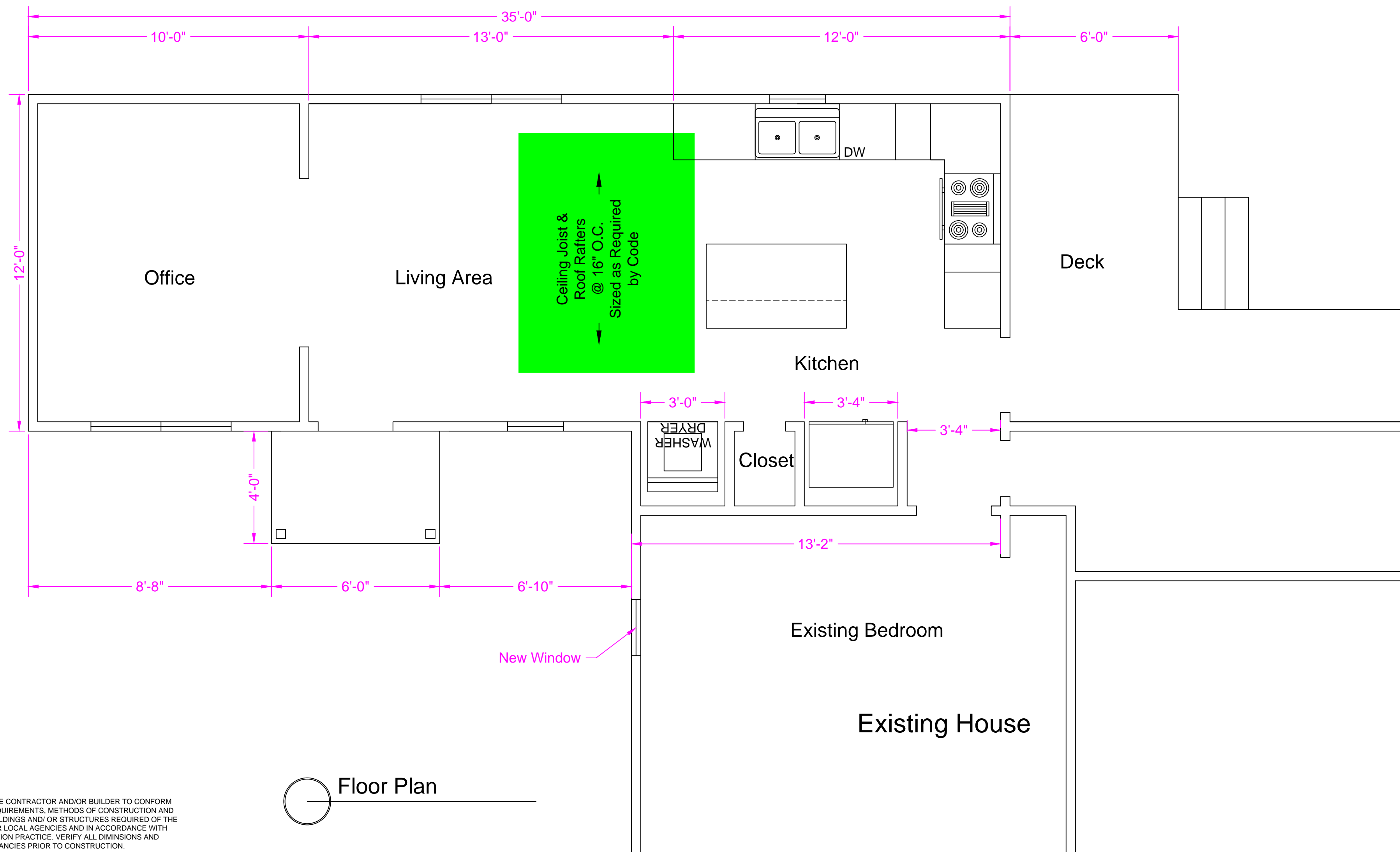

IT IS THE SOLE RESPONSIBILITY OF THE CONTRACTOR AND/OR BUILDER TO CONFORM TO ALL STANDARDS, PROVISIONS, REQUIREMENTS, METHODS OF CONSTRUCTION AND USES OF MATERIALS PROVIDED IN BUILDINGS AND/OR STRUCTURES REQUIRED OF THE NC STATE BUILDING CODE, ANY OTHER LOCAL AGENCIES AND IN ACCORDANCE WITH GOOD ENGINEERING AND CONSTRUCTION PRACTICE. VERIFY ALL DIMENSIONS AND CONTACT DESIGNER OF ANY DISCREPANCIES PRIOR TO CONSTRUCTION.

Floor Plan

GENERAL NOTES:	MATERIAL FINISH:	REVISION	DATE	DESCRIPTION
7916 Overhills Rd	DRAWN BY: D. BEHAGG	CHECKED BY:	DATE: 8/13/2020	SCALE: 3/8" = 1'-0"
				FILE :
REPRODUCTION OF THIS DOCUMENT IS NOT PERMITTED WITHOUT THE EXPRESSED CONSENT OF THE ABOVE COMPANY				
SHEET NUMBER				
G-3				
3 OF 3				