

MAP 98/418

State of North Carolina
County of Harnett

I, Bonnie A. Neighbors, Review Officer of Harnett
County, certify that the map or plat to which this certificate is affixed
meets all statutory requirements for recording.

Bonnie A. Neighbors 9-13-00
Review Officer Date

Certificate of Ownership and Dedication

I hereby certify that I am the owner of the property shown
and described hereon, which is located in the subdivision
jurisdiction of the county of Harnett and that I hereby adopt
this plan of subdivision with my free consent, established
minimum setback lines, and dedicate all streets, alleys, walks,
parks, and other sites and easements to the public or private
use as noted. Furthermore, I hereby dedicate all sanitary
sewer, storm sewer, and water lines to the county of
Harnett.

9/11/00 Date James R. Brafford Owner(s)

BELSMS
359/438

North Carolina, Harnett County
The foregoing certificate(s) of _____

Notary Public (Notaries Public) is/are certified to be
correct, this instrument was presented for registration

and recorded in the office at Book _____ Page _____

this _____ day of _____, 19____ at _____

_____ o'clock _____ m.

Register of Deeds - Ass't Deputy

COVINGTON
885/802

TRACT 2
10.06 ACRES

TRACT 1
10.05 ACRES

TRACT 3
27.47 ACRES

TRACT 4
28.59 ACRES

TRACT 5
21.45 ACRES

TRACT 6
17.42 ACRES

TRACT 7
22.01 ACRES

BELSMS
359/438

BELSMS
359/438

Existing House
Proposed Pool House

EVERGREEN MOBILE HOME PARK

PHASE 1, 2 and 3

67.64 ACRES

OWNER/DEVELOPER
JAMES R. BRAFFORD
DBA BRAFFORD CONSTRUCTION

This division of property is
exempt from the Harnett County
Subdivision Regulations,

Doni Jomarrillo 9-13-00
Planning Director Date

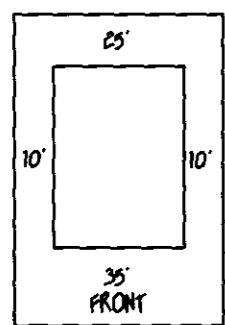

TYPICAL LOT SETBACKS

N15

I, ROBERT J. BRACKEN, REGISTERED LAND SURVEYOR NO. L-1373, CERTIFY TO ONE OR
MORE OF THE FOLLOWING AS INDICATED THUS: OR

- A. THAT THIS PLAT IS OF A SURVEY THAT CREATES A SUBDIVISION OF LAND
WITHIN THE AREA OF A COUNTY OR MUNICIPALITY THAT HAS AN
ORDINANCE THAT REGULATES PARCELS OF LAND.
- B. THAT THIS PLAT IS OF A SURVEY THAT IS LOCATED IN SUCH PORTION
OF A COUNTY OR MUNICIPALITY THAT IS UNREGULATED AS TO AN
ORDINANCE THAT REGULATES PARCELS OF LAND.
- C. THAT THIS PLAT IS OF A SURVEY OF AN EXISTING PARCEL OR PARCELS OF
LAND.
- D. THAT THIS PLAT IS OF A SURVEY OF ANOTHER CATEGORY, SUCH AS THE
RECOMBINATION OF EXISTING PARCELS, A COURT-ORDERED SURVEY OF OTHER
EXCEPTION TO THE DEFINITION OF SUBDIVISION.
- E. THAT THE INFORMATION AVAILABLE TO THIS SURVEYOR IS SUCH THAT I
AM UNABLE TO MAKE A DETERMINATION TO THE BEST OF MY PROFESSIONAL
ABILITY AS TO PROVISIONS CONTAINED IN (A) THROUGH (D) ABOVE.

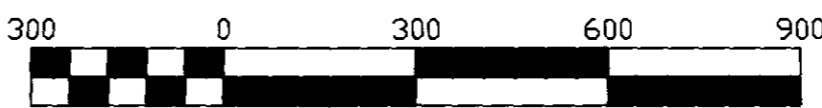

Scale 1" = 300'

OWNER/DEVELOPER
JAMES R. BRAFFORD
DBA BRAFFORD CONSTRUCTION
RT 6 - BOX 742
SANFORD, NC 27330
(919) 499-9750

DEED REF. 1037/49

I FURTHER CERTIFY THAT THIS PROPERTY
(DOES)
LIE WITHIN A SPECIAL FLOOD HAZARD AREA AS
DESIGNATED BY FIRM FLOOD INSURANCE RATE MAPS

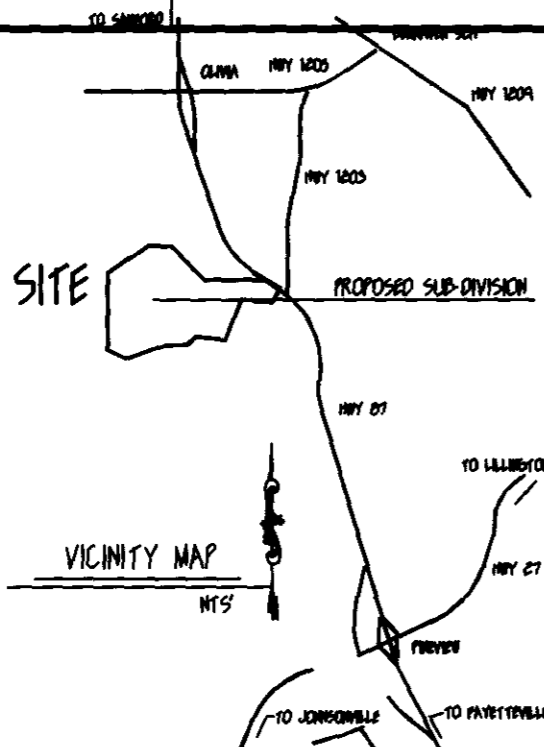

SURVEY FOR:

FINAL PLAT FOR:
**CYPRESS CREEK FARMS
PHASE 5**

TOWNSHIP:	BARBECUE	DATE:	AUGUST 15, 2000
COUNTY:	HARNETT	SCALE:	1" = 300'
STATE:	NORTH CAROLINA	PARCEL #	9567-03-0005

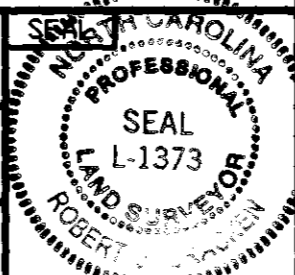

LEGEND		DATE:	REVISIONS:
S.I.P.	Set Iron Pipe		
F.I.P.	Found Iron Pipe		
F.C.M.	Found Concrete Monument		
F.P.K.	Found P.K. Nail		
F.R.R.	Found Railroad Spike		
R/W	Right of Way		
O.H.P.	Overhead Power		
P.P.	Power Pole		
C.L.	Centerline		
M.H.	Manhole		
C.P.	Calculated Point		

I, ROBERT J. BRACKEN, CERTIFY THAT THIS PLAT WAS
DRAWN UNDER MY SUPERVISION FROM AN ACTUAL SURVEY
MADE UNDER MY SUPERVISION; THAT THE BOUNDARIES NOT
SURVEYED ARE CLEARLY INDICATED; THAT THE RATIO OF
PRECISION AS CALCULATED IS 1:10,000; THAT THIS PLAT
WAS PREPARED IN ACCORDANCE WITH G.S. 47-30 AS
AMENDED. WITNESS MY ORIGINAL SIGNATURE, REGISTRATION
NUMBER AND SEAL THIS 13TH DAY OF SEPT., 2000.

Robert J. Bracken L-1373
REGISTERED LAND SURVEYOR
REGISTRATION NO. L-1373

BRACKEN & ASSOCIATES
ENGINEERING • SURVEYING
P. O. BOX 532 • SANFORD NC 27330
Off (919) 776-5622 Fax (919) 774-6717
E-MAIL ADDRESS: bracken@wavenet.net

Project # _____ Drawing # _____

MAP # 2000-553